

P	LTR	DESCRIPTION	DATE	DWN	APVD
H		REV PER ECR 09-025674	01DEC09	JR	TM
J		REVISED PER ECO-17-013200	07MAY2018	RS	DR

AMP
WIRE RANGE

14-12 AWG
SOLID OR STRANDED

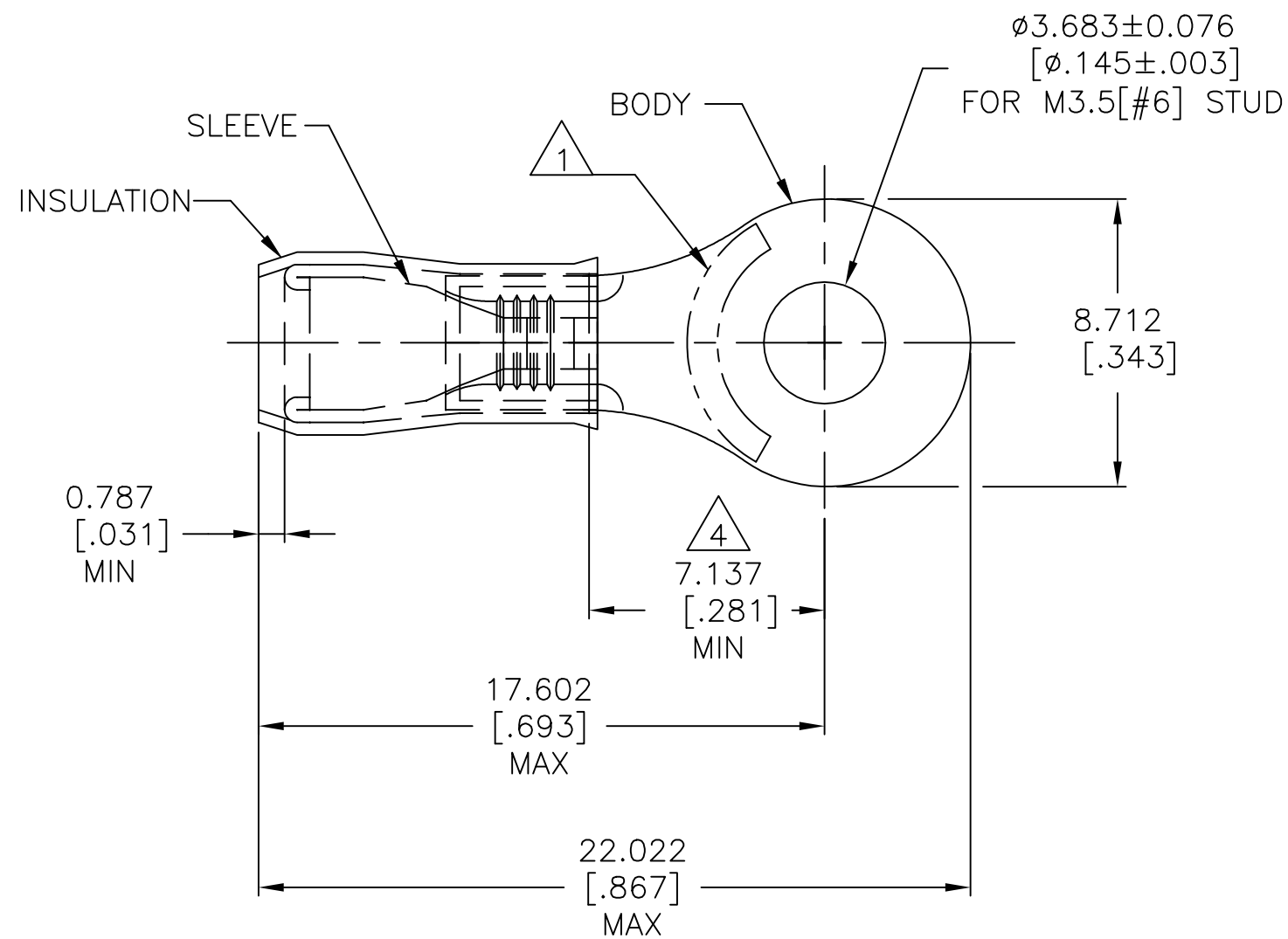

- 1 STAMP AMP 14-12, LOCATION AS SHOWN
- 2 WIRE INSULATION DIA RANGE IS $\phi 2.032 - \phi 3.175$ [$\phi .080 - \phi .125$]
- 3 BODY MATERIAL THK IS 0.787 ± 0.051 [$.031 \pm .002$]
- 4 APPLIES FROM CENTER OF STUD HOLE TO EDGE OF METAL WIRE BARREL
- 5 MATERIAL:
BODY & SLEEVE - COPPER PER ASTM B-152
INSULATION: NYLON
- 6 FINISH:
BODY & SLEEVE - TIN PLATE PER ASTM B-545
INSULATION: COLOR - WHITE
- 7 MAX RECOMMENDED OPERATING TEMP 105°C [221°F]
- 8 VOLTAGE RATING: 300 V MAX
- 9 WIRE CROSS SECTIONAL AREA RANGE:
 $1.65 - 3.45 \text{mm}^2$ [3,260 - 6,800] CMA

500	LOOSE PIECE	152874
QTY	PACKAGING TYPE	PART NO

THIS DRAWING IS A CONTROLLED DOCUMENT.		DWN jr ruth 05MAY06	STE TE Connectivity Ltd.														
DIMENSIONS: mm [INCHES]		CHK T MICHIELUTTI 05MAY06															
TOLERANCES UNLESS OTHERWISE SPECIFIED:		APVD T MICHIELUTTI 05MAY06	NAME														
<table border="0"> <tr><td>0 PLC</td><td>± -</td></tr> <tr><td>1 PLC</td><td>± -</td></tr> <tr><td>2 PLC</td><td>± -</td></tr> <tr><td>3 PLC</td><td>± 0.127[.005]</td></tr> <tr><td>4 PLC</td><td>± -</td></tr> <tr><td>ANGLES</td><td>± 5°</td></tr> </table>		0 PLC	± -	1 PLC	± -	2 PLC	± -	3 PLC	± 0.127[.005]	4 PLC	± -	ANGLES	± 5°	PRODUCT SPEC -	TERMINAL, RING TONGUE, PIDG, WIRE SIZE 14-12 AWG		
0 PLC	± -																
1 PLC	± -																
2 PLC	± -																
3 PLC	± 0.127[.005]																
4 PLC	± -																
ANGLES	± 5°																
MATERIAL		APPLICATION SPEC 114-2157	SIZE A3	CAGE CODE 00779	DRAWING NO C=152874												
FINISH		WEIGHT	RESTRICTED TO														
5		CUSTOMER DRAWING		SCALE 5:1	SHEET 1 OF 1												
6				REV J													