

THIS DRAWING IS UNPUBLISHED. RELEASED FOR PUBLICATION, 19 .  
 © COPYRIGHT 19 BY AMP INCORPORATED. ALL INTERNATIONAL RIGHTS RESERVED.

| LOC |    | DIST |     | REVISIONS   |                                |  |        | DATE    | APPD |
|-----|----|------|-----|-------------|--------------------------------|--|--------|---------|------|
| P   | F  | ZONE | LTR | DESCRIPTION |                                |  |        |         |      |
| G   | 14 |      |     | D           | REV & REDRAWN PER 0720-0040-93 |  | 4-5-93 | JAB/DAP |      |

**METRIC**  
 DIMENSIONS LISTED IN mm [ INCHES ]

|                               |                           |
|-------------------------------|---------------------------|
| <b>AMP</b><br>WIRE RANGE      | <b>UL</b> Listed          |
| 4 AWG<br>SOLID OR STRANDED    | 4 AWG<br>STRANDED         |
| <b>SR</b> LR7189<br>Certified | MILITARY P/N<br>AND CLASS |
| 4 AWG<br>SOLID OR STRANDED    | NOT<br>APPLICABLE         |

- ① STAMP AMP 4W\* APPROX AS SHOWN
- ② MAXIMUM LENGTH DOES NOT INCLUDE MANUFACTURING TABS

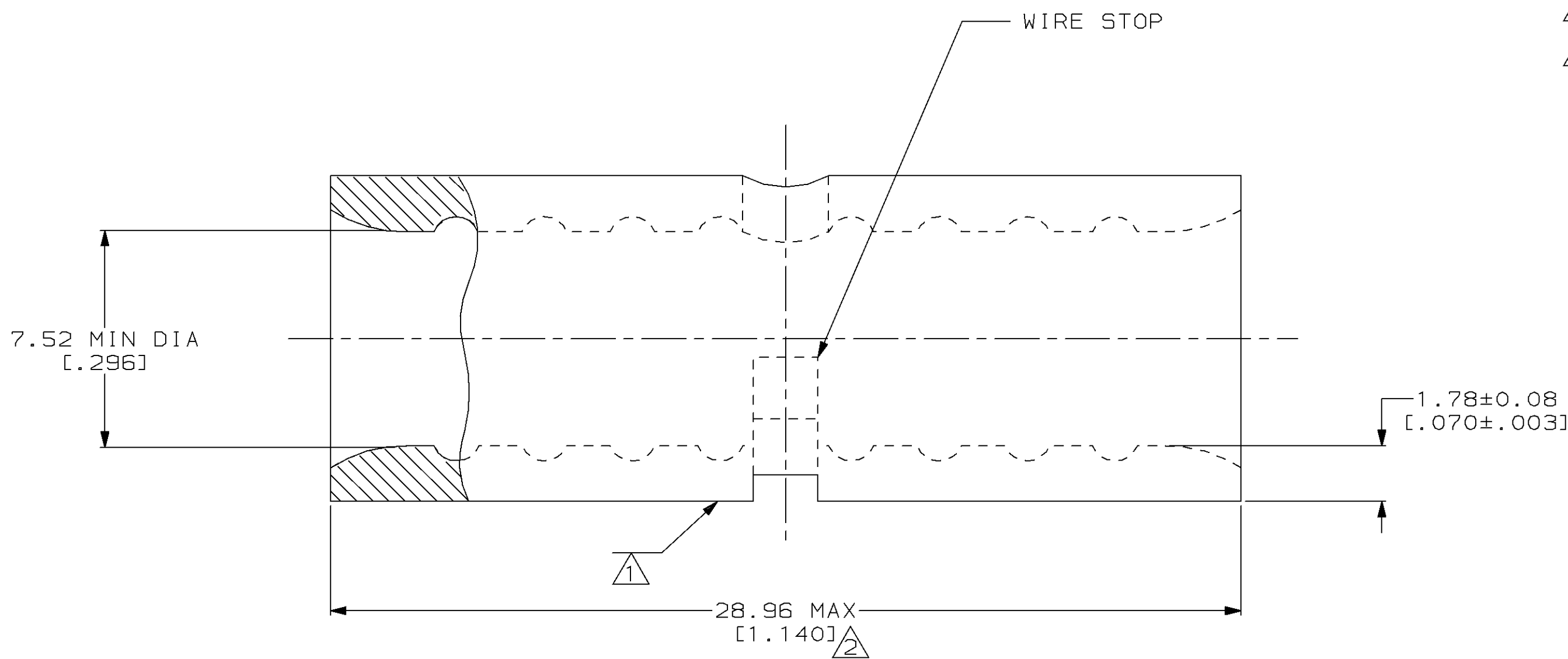
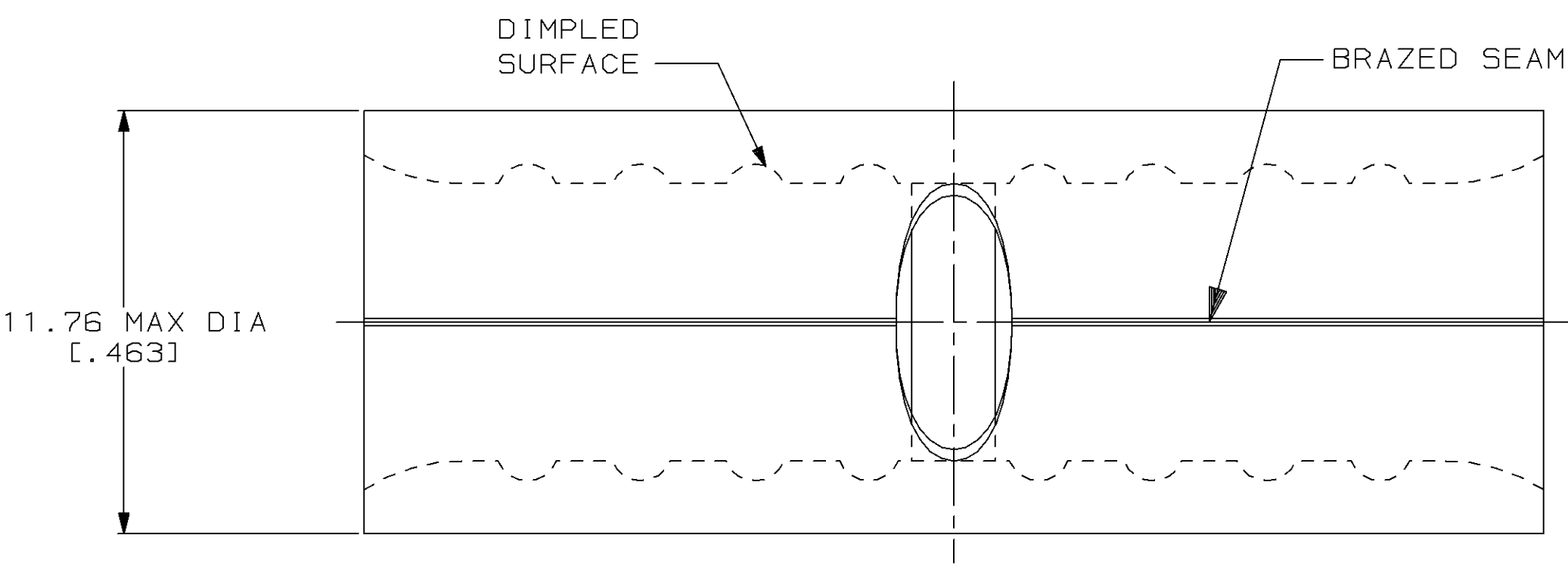

|  |  |   |   |                            |   |                        |
|--|--|---|---|----------------------------|---|------------------------|
| AMP INCORPORATED<br>CUSTOMER SERVICE SYSTEMS                                     |  | MAX RECOMMENDED OPERATING TEMPERATURE:<br>170°C MAX   | DO NOT SCALE PRINT. UNLESS SPECIFIED DIMENSIONS IN mm [INCHES] - TOLERANCES ON:<br>2 PLC DEC ± -<br>3 PLC DEC ± -<br>ANGLES ± - | DR 4-5-93<br>TA BRINKMAN   | 320238<br>PART NO                             |                        |
| FOR ADDITIONAL PRODUCT INFORMATION OR COPIES OF DRAWINGS AND TECHNICAL DOCUMENTS | PRODUCT INFORMATION CENTER<br>1-800-522-6752 | VOLTAGE RATING:<br>NOT APPLICABLE   | MATERIAL<br>COPPER PER ASTM B-152 ANNEALED  | CHK 4-5-93<br>DA PATTERSON | AMP Incorporated<br>Harrisburg, PA 17105-3608 |                        |
| FOR APPLICATION TOOLING INFORMATION  | TOOLING ASSISTANCE CENTER<br>1-800-722-1111  | WIRE CROSS SECTIONAL AREA RANGE:<br>16.8-26.7mm <sup>2</sup> [33,100-52,600] CIR MILS<br>SOLID OR STRANDED  | FINISH<br>TIN PLATE<br>0.00254 [0.00100] MIN THK PER MIL-T-10727  | APPD 4-5-93<br>DE MILLER   | NAME<br>SPLICE, BUTT, SIGHT HOLE, SOLISTRAND™ |                        |
| FOR ORDER ENTRY  | 1-800-526-5142                               | THIS DRAWING IS A CONTROLLED DOCUMENT FOR AMP INCORPORATED. IT IS SUBJECT TO CHANGE AND THE CONTROLLING ENGINEERING ORGANIZATION SHOULD BE CONTACTED FOR THE LATEST REVISION. |   | APPD 4-5-93<br>JL MECKLEY  | SIZE<br>③ 00779                               | DRAWING NO<br>③=320238 |
| AMP 1471-6 REV 3-92  |  |   |   | PRODUCT SPEC<br>-          | SCALE 8:1                                     | SHEET 1 OF 1           |