

NOTES:

1- ONLY THE ITEMS WITH QUANTITIES SPECIFIED ON PARTS LIST ARE USED ON THIS APPLICATOR

▲ USED IN PLACE OF ITEM 38 WHEN INSULATION CRIMP IS NOT USED

▲ GUARD MUST BE IN PLACE WHEN OPERATING APPLICATOR IN AMP-O-LECTRIC PRESS

4- ITEMS WITH QTY. OF REF. SPECIFIED (EXCEPT ITEM 79) ARE USED ON ITEM 46

KEY:
 ■ RECOMMENDED SPARE PARTS CUSTOMER RESPONSIBLE FOR REPLACEMENT
 ▲ LUBRICATE DAILY USING NO. 20 MACHINE OIL
 ● GREASE LIGHTLY

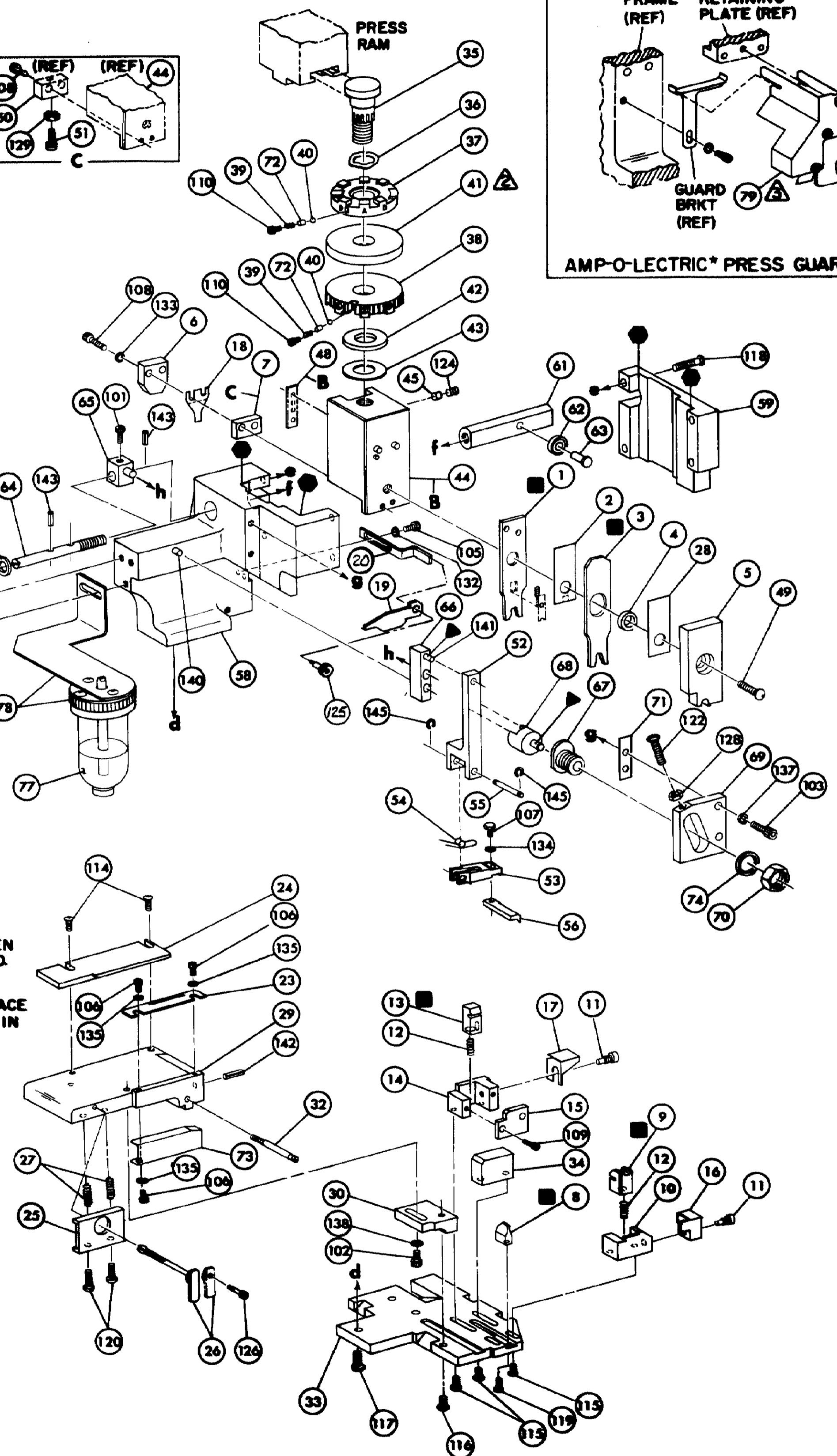

REF.	QTY	PART NO	DESCRIPTION	ITEM NO	REF.	QTY	PART NO	DESCRIPTION	ITEM NO
REF.		21045-3	RING, RETAINING 'C' (.187 DIA) FEED FINGER PIN	145	REF.	454220-1	CAP, HOUSING	58	
REF.		5-21028-1	PIN, SLOT SPR (.125 DIA X .50) ADJ ROD	143	REF.	454485-1	HOUSING	58	
1		4-21028-0	PIN, SLOT SPR (.093 DIA X .75) STR G PLATE	142	1	670542-2	PAWL, FEED	56	
REF.		1-21030-1	PIN, DOWEL (.187 DIA X .50) LEVER	141	REF.	240624-1	PIN, FEED FINGER	55	
REF.		1-21030-6	PIN, DOWEL (.187 DIA X 1.25) HOUSING	140	REF.	691499-1	SPRING, FEED FINGER	54	
1		21024-5	WASHER, LOCK (NO 10) LUB ASSY	139	REF.	690541-1	FINGER, FEED	53	
1		21024-5	WASHER, LOCK (NO 10) STRIP GUIDE ADJ BLOCK	138	REF.	455679-1	LEVER, TERMINAL FEED ARM	52	
REF.		21024-5	WASHER, LOCK (NO 10) ADJ PLATE	137			BUMPER, HOLDDOWN	51	
REF.		21024-5	WASHER, LOCK (NO 10) FEED GUIDE ROD	136			SPACER, TONKER	50	
3		21057-2	WASHER, LOCK (NO 4) FRONT STRIP GUIDE	135	1	7-21002-9	BOLT, CRIMPER	49	
1		21024-4	WASHER, LOCK (NO 8) FEED FINGER	134	1	670602-5	CAM PRE-FEED	48	
		21024-4	WASHER, LOCK (NO 8) DEPRESSOR	133				47	
1		21024-4	WASHER, LOCK (NO 8) STRIPPER	132	1	459456-1	APPLICATOR, BASIC (SUB ASSY)	46	
REF.		21899-4	WASHER, FLAT (5/16 DIA) SCREW ADJ	131	1	690191-1	PLUG, NYLON	45	
1		21899-2	WASHER, FLAT (NO 10) LUB ASSY	130	1	455673-1	RAM	44	
		21068-5	NUT, HEX MACH (6-32) HOLDDOWN	129	1	690125-1	WASHER, LAMINATED	43	
REF.		21068-5	NUT, HEX MACH (6-32) FEED ADJ	128	1	690124-1	WASHER, RAM	42	
				127			DISC, SPACER	41	
		22353-8	SCR, SHLD. (.187 DIA X .250 LG) DRAG LEVER	126	2	23241-6	BALL, STEEL	40	
1		45667-1	SCR, SHLD. (.188 DIA X .125 LG) STRIPPER	125	2	690170-1	SPRING, COMPRESSION	39	
1		21009-2	SCR, SKT SET (1/4-20 X .25) (LOC-WEL) RAM	124	1	670142-1	DISC, INSULATION	38	
				123	1	4-672155-0	BISC, WIRE	37	
REF.		3-21064-2	SCR, RD HD MACH (6-32 X 1.50) FEED ADJ	122	1	22480-5	WASHER, SPRING	36	
				121	1	690212-1	POST, RAM	35	
2		2-21002-9	SCR, BUT HD SKT CAP (10-32 X .75) DRAG	120			SUPPORT, TERMINAL	34	
1		22733-8	SCR, BUT HD SKT CAP (8-32 X .38) (LOC-WEL) ANVIL	119	REF.	455675-1	PLATE, BASE	33	
REF.		2-21002-9	SCR, BUT HD SKT CAP (10-32 X .75) CAP	118	1	690432-3	SCREW, ADJUSTMENT	32	
REF.		1-24073-9	SCR, BUT HD SKT CAP (1/4-20 X .75) HOUSING	117				31	
REF.		2-21002-7	SCR, BUT HD SKT CAP (10-32 X .50) SG ADJ BLOCK	116	REF.	455689-1	BLOCK, STRIP GUIDE ADJ	30	
2		2-21002-2	SCR, BUT HD SKT CAP (8-32 X .50) SHEAR	115	1	455671-1	PLATE, STRIP GUIDE	29	
2		2-21002-2	SCR, BUT HD SKT CAP (8-32 X .50) R STRIP GUIDE	114	1	1-455888-6	SPACER, FRONT SHEAR DEPRESSOR	28	
				113	2	1-22284-0	SPRING, DRAG	27	
1		2-21003-0	SCR, FLAT HD SKT CAP (6-32 X .50) CAM	112	1	670546-1	LEVER, DRAG RELEASE	26	
1		3-21000-4	SCR, SKT HD CAP (10-32 X .38) LUBRICATOR ASSY	111	1	240792-1	DRAG, STOCK	25	
2		23030-1	SCR, SKT HD CAP (6-32 X .25) (LOC-WEL) CP DISC	110	1	2-670504-5	GUIDE STRIP (REAR)	24	
				109	1	670438-1	GUIDE, STRIP (FRONT)	23	
2		2-21000-6	SCR, SKT HD CAP (8-32 X .38) DEPRESSOR	108				22	
1		2-22603-0	SCR, HEX HD MACH (8-32 X .31) FEED FINGER	107	REF.	4-22284-9	SPRING, FEED RETURN	21	
3		1-21000-3	SCR, SKT HD CAP (4-40 X .25) F STRIP GUIDE	106	1	458950-1	ARM, STRIPPER	20	
1		2-21000-7	SCR, SKT HD CAP (8-32 X .50) STRIPPER	105	1	458949-1	STRIPPER	19	
REF.		3-21000-7	SCR, SKT HD CAP (10-32 X .75) FEED ROD GUIDE	104	1	1-690518-2	HOLDER, TERMINAL	18	
REF.		3-21000-6	SCR, SKT HD CAP (10-32 X .62) FEED ADJ BLOCK	103			GUARD, CHIP (REAR)	17	
1		3-21000-4	SCR, SKT HD CAP (10-32 X .38) SG ADJ BLOCK	102	1	670667-1	GUARD, CHIP (FRONT)	16	
REF.		3-21000-4	SCR, SKT HD CAP (10-32 X .38) PIVOT BLOCK	101			PLATE, SHEAR (REAR)	15	
REF.		455749-1	GUARD, WINDOW	79			HOLDER, SHEAR (REAR)	14	
1		1-465184-0	LUBRICATOR ASSY	78			SHEAR, FLOAT (REAR)	13	
REF.		852931-2	OIL, LUBRICATING	77	1	5-22280-0	SPRING, SHEAR	12	
				76	1	690461-1	STOP, SHEAR	11	
				75	1	670459-1	HOLDER, SHEAR (FRONT)	10	
REF.		458109-1	WASHER, SPECIAL	74	1	454276-1	SHEAR, FLOAT (FRONT)	9	
1		454877-3	PLATE, STRIP GUIDE COVER	73	1	6-670471-6	ANVIL	8	
2		690603-1	SPRING, ASSIST	72			SPACER, DEPRESSOR (REAR)	7	
REF.		690517-1	SPACER	71			DEPRESSOR, SHEAR (REAR)	6	
		22594-8	NUT, HEX	70	1	455889-9	DEPRESSOR, SHEAR (FRONT)	5	
		240628-1	PLATE, ADJUSTMENT	69	1	238011-6	SPACER, TUBULAR, INS CRIMPER	4	
		240626-1	SHAFT, PIVOT	68	1	4-456135-7	CRIMPER, INSULATION	3	
		240633-1	BUSHING	67	1	1-455888-0	SPACER, CRIMPER	2	
		455680-1	LEVER, INTERMEDIATE	66	1	1-456402-9	CRIMPER, WIRE	1	
		240629-1	BLOCK, PIVOT	65					
		240632-2	SCREW, ADJUSTMENT FEED ROD	64					
		240659-3	PIN, CAM ROLLER	63					
		240658-1	ROLLER, CAM	62					
		454398-2	ROD, FEED	61					
REF.		454178-1	GUIDE, FEED ROD	60					

CRIMPING DATA				APPLICATOR WILL APPLY	
PAD LTR	CRIMP HEIGHT	WIRE SIZE	WIRE LENGTH		
A	.028	22			61613
B	.025	24			61941
C	.023	26			62584
D	NOT USED				

REMARKS	NO	REV
APPL USED ON MACHINE PART NO	MACH SERIAL NO	DISTRIBUTION
CUSTOMER NAME	APPL SERIAL NO	ORIGINAL
ADDRESS	PURCHASE ORDER	CUSTOMER COPY
CITY	ENG APP	FIELD ENG COPY

WIRE NAMES: 26-22 INSULATION RANGE: .030-.105 PRESS NO: 525435-5

REMARKS: PRE-FEED AMP-O-LECTRIC

I.D. PLATE (REF): 461264-1

DATE: 10-10-90 SET UP GAGE: 10-1

REV: 10-10-90

APP: 10-10-90

NO: 466487-2

AMP INCORPORATED Harrisburg, Pa.

THIS INFORMATION IS CONFIDENTIAL AND IS TO BE KEPT AS SUCH UNLESS OTHERWISE SPECIFIED BY THE USER. IT IS TO BE DESTROYED WHEN NO LONGER REQUIRED FOR OPERATIONAL PURPOSES. WRITTEN AUTHORIZATION FROM AMP INCORPORATED, HARRISBURG, PA.