

WITH MOUNTING CLIPS

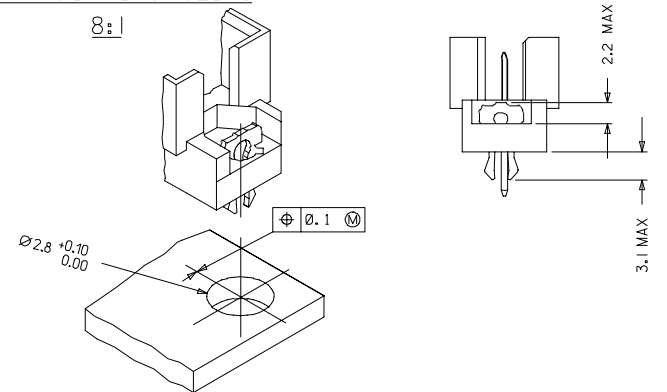

- NOTES:
- MATERIALS: THERMOPLASTIC POLYESTER, GLASS FILLED, UL94V-0, COLOUR: PEBBLE GREY RAL 7032
TERMINAL - PHOSPHOR BRONZE
MOUNTING CLIP: STEEL
 - FINISH: TERMINAL:-
CONTACT AREA
1. PERFORMANCE LEVEL 1: SELECTIVE GOLD (Au), THICKNESS = 1.1 MICROMETER OVER NICKEL, THICKNESS = 1.25 MICROMETER MIN
2. PERFORMANCE LEVEL 2: SELECTIVE GOLD (Au), THICKNESS = 0.6 MICROMETER OVER NICKEL, THICKNESS = 1.25 MICROMETER MIN
3. PERFORMANCE LEVEL 3: SELECTIVE GOLD (Au), THICKNESS = 0.3 MICROMETER OVER NICKEL, THICKNESS = 1.25 MICROMETER MIN
PRESS-IN AREA: NICKEL, THICKNESS 4.25 MICROMETER MIN OVERALL
WRAP AREA: NICKEL, THICKNESS = 1.25 MICROMETER MIN OVERALL
ADAPTER INSERTION AREA: PERFORMANCE LEVEL 3: SELECTIVE GOLD (Au), THICKNESS = 0.3 MICROMETER OVER NICKEL, THICKNESS = 1.25 MICROMETER MIN
 - MOUNTING CLIP:-
TIN (Sn), THICKNESS = 5-10 MICROMETER,
OVER NICKEL (Ni), THICKNESS = 2.5 MICROMETER
 - FOR NON MOUNTING CLIP OPTION, CONNECTOR TO BE SECURED WITH RIVETS: 2 TUBULAR RIVETS 2.5 x 0.3 ... DIN 7340
SCREWS: 2 CHEESEHEAD SCREWS M2.5 x ... DIN 84 AND 2 HEXAGONAL NUTS M2.5 DIN 934
 - MATERIAL NUMBER, BATCH CODE, UL AND CSA MARKING TO BE PRINTED ON THE CONNECTOR
 - CUT FACE OF TIP WITHOUT PLATING PERMITTED
 - PRODUCT SPECIFICATION PS-36515-001

RECOMMENDED PCB LAYOUT
COMPONENT SIDE

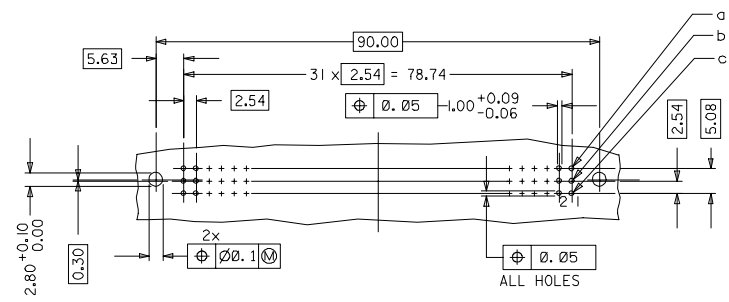

RoHS COMPLIANT

EC No: 2007-0044 DRWNSATTI/MAR/D 2006/10/10 CHK/SS/SUB/IR 2006/10/11 APPR/SS/SUB/IR 2006/10/15	QUALITY SYMBOLS ▽=0 ▽=0	GENERAL TOLERANCES (UNLESS SPECIFIED)		DIMENSION STYLE MM ONLY		SCALE 2:1	DESIGN UNITS METRIC	THIRD ANGLE PROJECTION	
		4 PLACES ± 0.15 ± ---	3 PLACES ± 0.1 ± ---	2 PLACES ± 0.05 ± ---	1 PLACE ± 0.05 ± ---	DRAWN BY SS	DATE 1999/09/24	CHECKED BY G J LOWE	DATE 1999/09/24
C1	DESCRIPTION	DRAFT WHERE APPLICABLE MUST REMAIN WITHIN DIMENSIONS		MATERIAL NO. SEE CHART	DOCUMENT NO. SD-36515-006	MOLEX INCORPORATED		SHEET NO. 1 OF 2	
		THIS DRAWING CONTAINS INFORMATION THAT IS PROPRIETARY TO MOLEX INCORPORATED AND SHOULD NOT BE USED WITHOUT WRITTEN PERMISSION							

MATERIAL No.	MOLEX ENG No.	PERF LEVEL	PLATING	CONTACT SEQUENCE/ROW	DIM "L" MM	MOUNTING CLIP	FMLB
36515-0121	MM-B1467-R960	1	Au + Ni	1,2,3...32 a+b+c	17	NO	NO
36515-0122	MM-B1567-R960	2	Au + Ni	1,2,3...32 a+b+c	17	NO	NO
36515-0123	MM-B1667-R960	3	Au + Ni	1,2,3...32 a+b+c	17	NO	NO
36515-0127	MM-B1467-R910	1	Au + Ni	1,2,3...32 a+b+c	17	YES	NO
36515-0128	MM-B1567-R910	2	Au + Ni	1,2,3...32 a+b+c	17	YES	NO
36515-0129	MM-B1667-R910	3	Au + Ni	1,2,3...32 a+b+c	17	YES	NO
36515-0133	MM-B1467-R930	1	Au + Ni	1,2,3...32 a+b+c	17	NO	1,32a 1,32b 1,32c
36515-0134	MM-B1567-R930	2	Au + Ni	1,2,3...32 a+b+c	17	NO	1,32a 1,32b 1,32c
36515-0135	MM-B1667-R930	3	Au + Ni	1,2,3...32 a+b+c	17	NO	1,32a 1,32b 1,32c
36515-0139	MM-B1467-R950	1	Au + Ni	1,2,3...32 a+b+c	17	YES	1,32a 1,32b 1,32c
36515-0140	MM-B1567-R950	2	Au + Ni	1,2,3...32 a+b+c	17	YES	1,32a 1,32b 1,32c
36515-0141	MM-B1676-R950	3	Au + Ni	1,2,3...32 a+b+c	17	YES	1,32a 1,32b 1,32c

DETAILY DETAILX

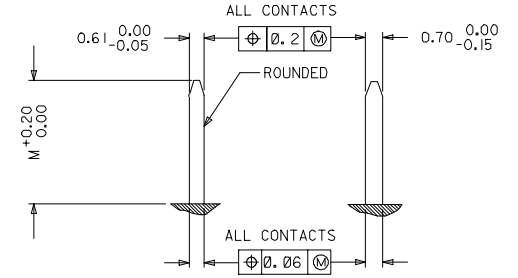

PRE MATING CONTACTS	5.4
NORMAL CONTACTS	4.8
	M

RoHS COMPLIANT

EC No: 2007/0044 DRAWING APPROVED 2006/10/10 CHECKED BY APPRESSOR 2006/10/11 APPROVED BY APPRESSOR 2006/10/15	QUALITY SYMBOLS	GENERAL TOLERANCES (UNLESS SPECIFIED)	DIMENSION STYLE	SCALE	DESIGN UNITS	THIRD ANGLE PROJECTION															
	$\nabla=0$ $\nabla=0$	<table border="1"> <thead> <tr> <th></th> <th>mm</th> <th>INCH</th> </tr> </thead> <tbody> <tr> <td>4 PLACES</td> <td>± 0.1</td> <td>± 0.004</td> </tr> <tr> <td>3 PLACES</td> <td>± 0.05</td> <td>± 0.002</td> </tr> <tr> <td>2 PLACES</td> <td>± 0.1</td> <td>± 0.004</td> </tr> <tr> <td>1 PLACE</td> <td>± 0.15</td> <td>± 0.006</td> </tr> </tbody> </table>		mm	INCH	4 PLACES	± 0.1	± 0.004	3 PLACES	± 0.05	± 0.002	2 PLACES	± 0.1	± 0.004	1 PLACE	± 0.15	± 0.006	MM ONLY	2:1	METRIC	
		mm	INCH																		
	4 PLACES	± 0.1	± 0.004																		
3 PLACES	± 0.05	± 0.002																			
2 PLACES	± 0.1	± 0.004																			
1 PLACE	± 0.15	± 0.006																			
					ASSY, DIN 41612, R MALE 96P, PRESS-IN, WIRE WRAP																
		DRAFT WHERE APPLICABLE MUST REMAIN WITHIN DIMENSIONS	DRAWN BY SS 1999/09/24 CHECKED BY GJLOWE 1999/09/24 APPROVED BY GJLOWE 1999/09/24			MOLEX INCORPORATED															
			MATERIAL NO. SEE CHART SIZE A 1		DOCUMENT NO. SD-36515-006	SHEET NO. 2 OF 2															