



## HS L1.5 Door Stop Extension Spacer for Egress Doors

### Required Tools and Components

**PROVIDED BY MANUFACTURER**

(per module set)

[1] Door Stop Extension Plate  
**Part. No. 1524**

**PROVIDED BY INSTALLER**

Phillip screwdriver or a Phillips bit  
for use in the drill/bit-driver

Blade screwdriver or a blade bit  
for use in the drill/bit-driver

1/6" SPACERS (4/BAG -  
MAGNASPHERE P/N 1270)

HS-L1.5 Switch Module

HS-L1.5 Magnet Module

[2] #8 Flat-head self-tapping screws

[2] #8 Pan-head screws

[1] #8-32 Pan-head screw

[1] #8-32 Flat-head screw

#8 Tap drill

Power drill

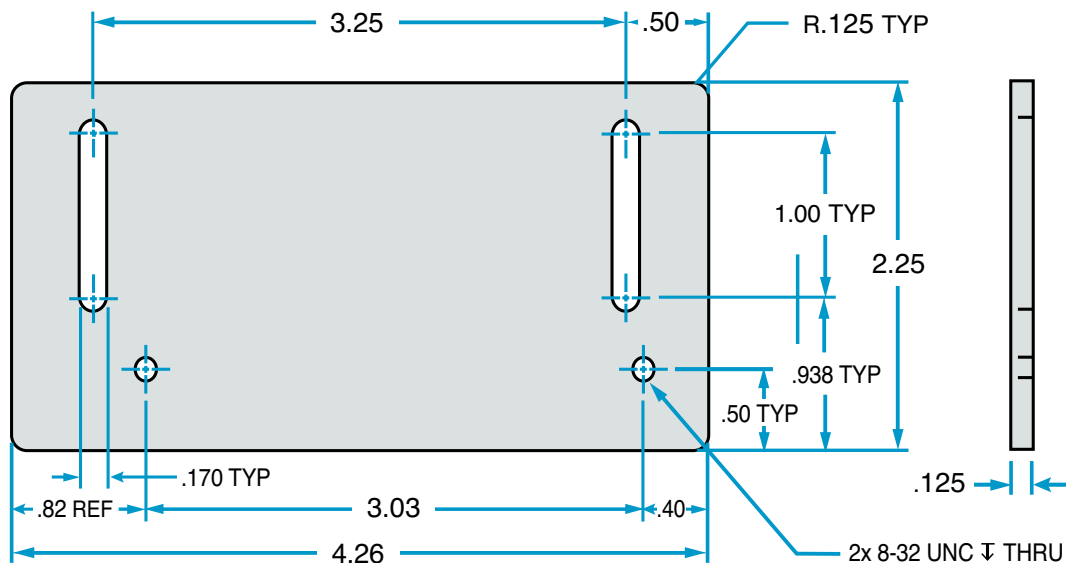



## HS L1.5 Door Stop Extension Spacer for Egress Doors

### MAGNET MODULE ORDER OF ASSEMBLY

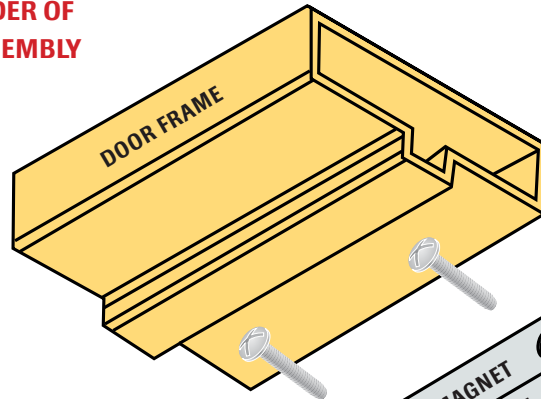

NOTE: 1/16" spacers (P/N 1270 can be used if necessary to achieve the proper operational gap of 0.25".

### SWITCH MODULE ORDER OF ASSEMBLY

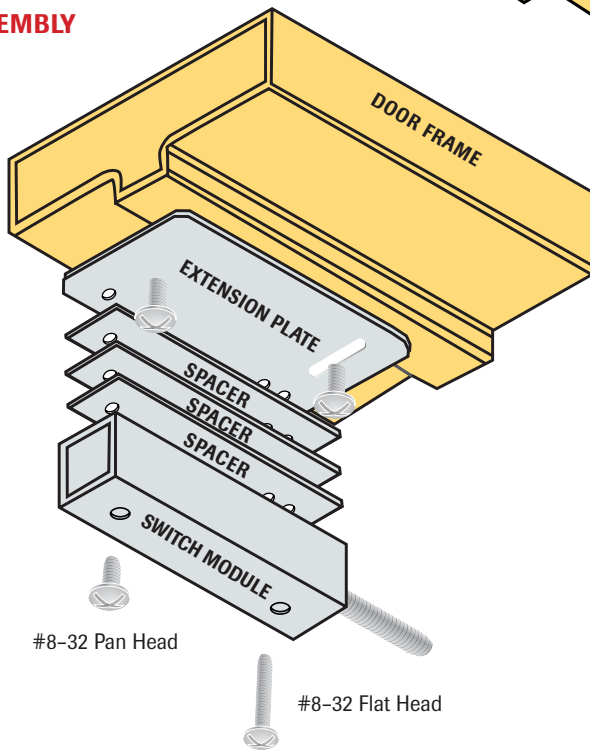

#8-32 Pan Head

#8-32 Flat Head

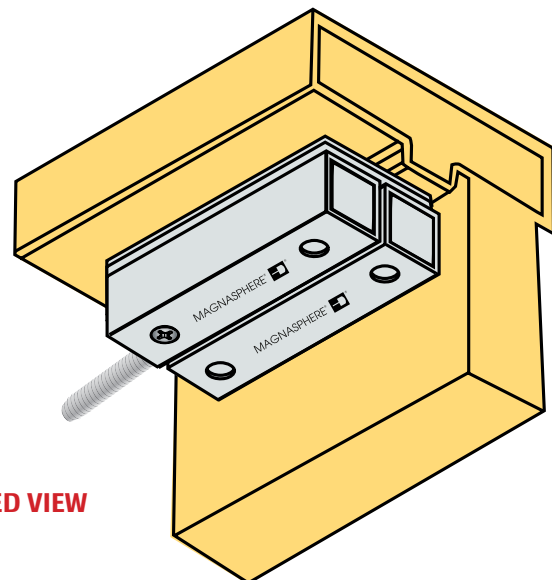
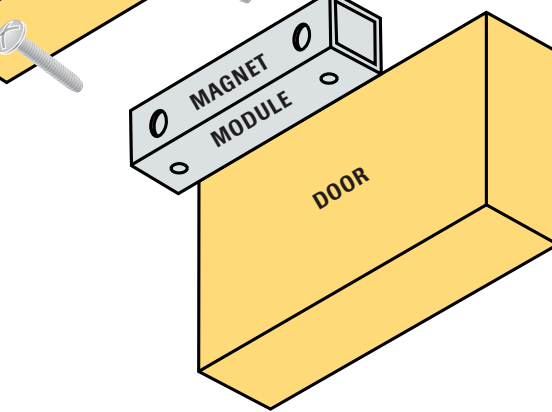

### ASSEMBLED VIEW

**DO NOT** over-torque the switch mount screws, doing so will strip the threads.



### HS L1.5 Door Stop Extension Spacer for Egress Doors

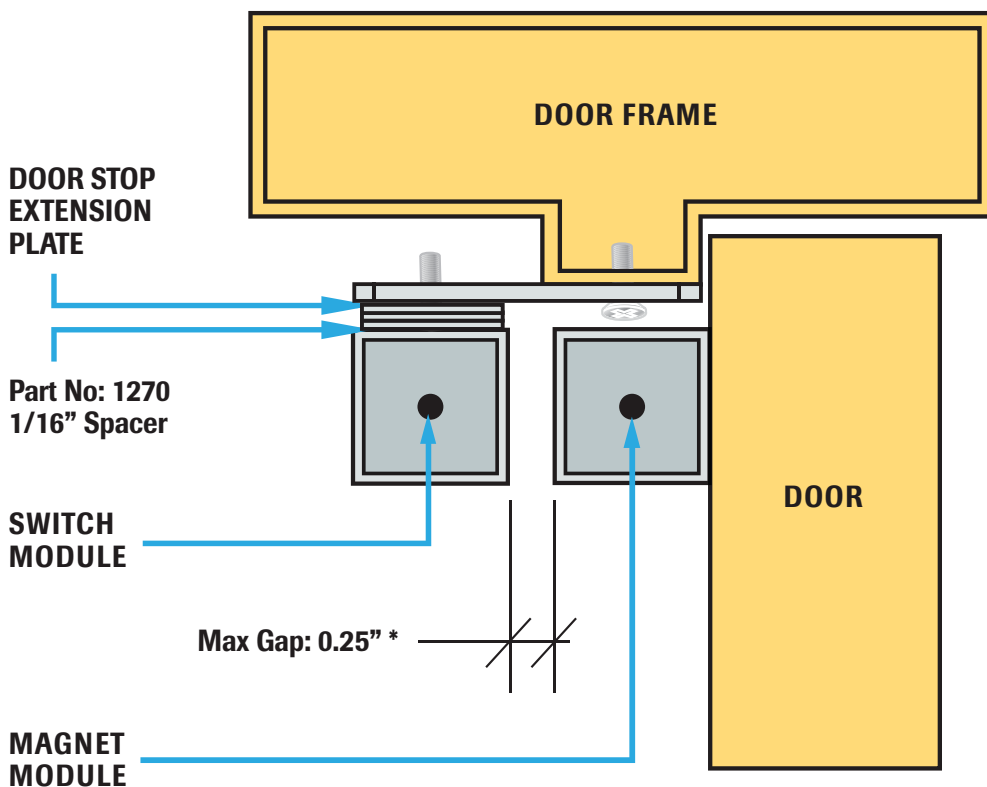

Extension plate is suitable for egress door set-up with a door stop/jam smaller than 2 inches. No plate should be necessary for most door stops which are at least 2 inches thick.

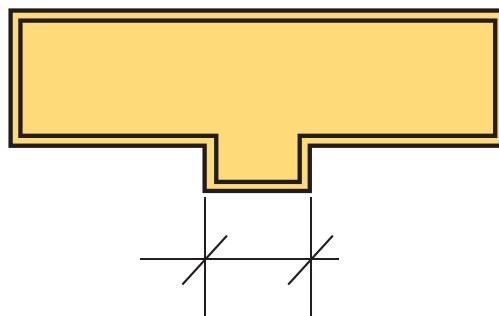

Less than 2"



Please refer to the HS-L1.5 instructions manual for detailed installation and orientation instructions.