

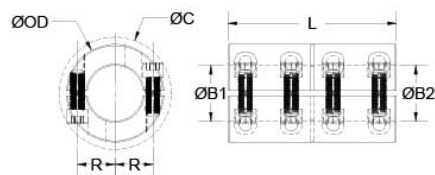

SPX-8-8-F

Ruland SPX-8-8-F, 1/2" x 1/2" Rigid Coupling, Black Oxide Steel, Two-Piece
Clamp Style, 1 1/8" OD, 1 3/4" Length



Description

Ruland SPX-8-8-F is a two-piece rigid coupling with 0.5000" x 0.5000" bores, 1 1/8" OD, and 1 3/4" length. It has precision honed bores to ensure they are collinear and do not introduce misalignment or vibration into the system making it suitable for high precision servo applications as well as shaft to shaft connections. SPX-8-8-F has opposing hardware for a balanced design. Proprietary Nypatch® anti-vibration coating on hardware allows for even seating of the screw, repeated screw installations, prevents galling, and maintains high holding power. It eliminates the need to treat screws upon receipt greatly reducing installation time. Forged screws test beyond ANSI standards to ensure maximum holding power. Tightly controlled bore tolerance of +.002"/+.0005" is maintained. SPX-8-8-F is made from 1215 lead-free steel with a proprietary black oxide finish that produces a fine glossy finish while increasing holding power and resisting corrosion. It is machined from solid bar stock that is sourced exclusively from North American mills and is RoHS3 and REACH compliant. SPX-8-8-F is manufactured in our Marlborough, MA factory under strict controls using proprietary processes.

Product Specifications

Bore (B1)	0.5000 in	Small Bore (B2)	0.5000 in
B1 Max Shaft Penetration	0.875 in	B2 Max Shaft Penetration	0.875 in
Outer Diameter (OD)	1 1/8 in	Bore Tolerance	+0.0020 in / +0.0005 in
Length (L)	1 3/4 in	Clearance Diameter (C) MAX	1.328 in
Recommended Gap	0.063 in	Recommended Shaft Tolerance	+0.0000 in / -0.0005 in
Forged Clamp Screw	#8-32	Screw Material	Alloy Steel with Nypatch®
Hex Wrench Size	9/64 in	Screw Finish	Black Oxide
Seating Torque	49 lb-in	Screw Location (R)	0.430 in
Number of Screws	8 ea	Rated Torque	950 in-lb
Moment of Inertia	0.0681 lb-in ²	Maximum Speed	4,000 RPM
Full Bearing Support Required?	No	Nypatch® Anti-Vibration Hardware?	Yes
Precision Honed Bores?	Yes	Zero-Backlash?	Yes
Balanced Design	Yes	Material Specification	1215 Carbon Steel Bar
Temperature	-40°F to 350°F (-40°C to 176°C)	Finish Specification	Hot Process Black Oxide, Impregnated with Naphthenic Oil, Centrifugally Dried
Manufacturer	Ruland Manufacturing	Country of Origin	USA
Weight (lbs)	0.356200	UPC	634529026519
Tariff Code	8483.60.8000	UNSPC	31163009
Note 1	Performance ratings are for guidance only. The user must determine suitability for a particular application.		
Prop 65	⚠ WARNING This product can expose you to the chemical Ethylene Thiourea, known to the State of California to cause cancer and birth defects or other reproductive harm. For more information go to www.P65Warnings.ca.gov .		

Installation Instructions

1. Align the SPX-8-8-F two-piece rigid coupling on the two shafts to be connected. There should be no misalignment.
2. Tighten the Nypatch® screws in two stages, starting with the inside screws. Using a 9/64 in torque wrench, tighten the inside screws to 24.5 lb-in which is half the recommended seating torque. Repeat the process for the outside screws, tightening to half the recommended seating torque.
3. Be sure to maintain the gap of 0.063 in between the two halves during installation.

4. Tighten the screws to the full recommended seating torque of 49 lb-in following the same pattern, starting with the inside screws first.
 5. For optimum results do not exceed the shaft penetration length of 0.875 in.
-