

6

5

4

3

2

1

APPROVED: _____
DATE: _____ TITLE: _____

Rev	AWO #	Description	Date	Appr
-		RELEASED	5/10/19	
A		UPDATE DRAWING	6/17/19	OW/RC
B		UPDATE DRAWING	7/21/20	OW/RC
C		UPDATE DRAWING	6/15/22	WX/TY

3.30mm Length

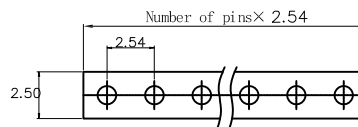
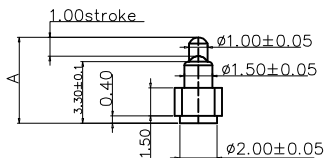

3.30mm Length

ADAM P/N	Initial Height
PH1-3B-XX-MVF-3345	4.5mm
PH1-3B-XX-MVF-3350	5.0mm

4.30mm Length

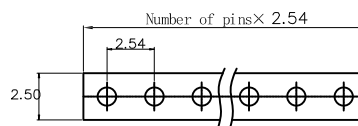
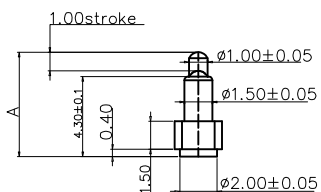

4.30mm Length

ADAM P/N	Initial Height
PH1-3B-XX-MVF-4355	5.5mm
PH1-3B-XX-MVF-4360	6.0mm

5.30mm Length

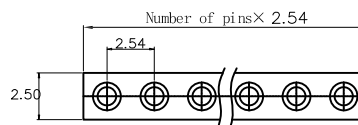
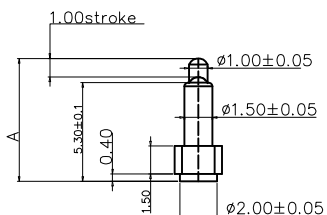

5.30mm Length

ADAM P/N	Initial Height
PH1-3B-XX-MVF-5365	6.5mm
PH1-3B-XX-MVF-5370	7.0mm
PH1-3B-XX-MVF-5375	7.5mm
PH1-3B-XX-MVF-5380	8.0mm

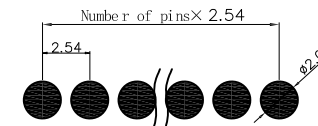

RECOMMENDED PCB LAYOUT

SPECIFICATIONS:

Material:
 Insulator: PA46, rated UL 94V-0, Color: Black
 Contacts: Copper Alloy, Gold flash plated
 Contact solder area plating: Copper Alloy, 5u" Gold plated
 Spring: SUS304
 Electrical:
 Voltage rating: 12 Volts
 Current rating: 1A max (3.30mm), 3A max (4.30&5.30mm)
 Contact resistance @ working stroke: 20 mohms max. before test
 60 mohms max. after test

Insulation resistance: 100 Mohms min
 Dielectric withstanding voltage: 100 VRMS @ 60HZ

Mechanical:

Spring force: 90±20gf @ 1.0mm working stroke (3.30mm)
 70±20gf @ 1.0mm working stroke (4.30 & 5.30mm)

Full stroke: 1.40mm
 Life test: 10,000 Cycles Min
 Temperature Rating:

Operating temperature: -30°C to +85°C

Environmental:

Lead free, RoHS compliant.



UNLESS OTHERWISE SPECIFIED ALL DIMENSIONS ARE MILLIMETERS. TOLERANCES: EXCEPT AS NOTED		
MM	ANGLE	
.X ± .20	X ± 2°	
.XX ± .15	.X ± .5°	
.XXX ± .10		



909 Rahway Avenue,
 Union, NJ 07083
 Phone: 908-687-5000
 Fax: 908-687-5710

DRAWN	OW	5/10/19
CHECKED	AC	5/10/19
APPROVED		

TITLE: CUSTOM LENGTH TUBE SINGLE ROW STRIPS
 1.50MM INSULATOR HEIGHT, SMT LOADED

THIS DRAWING CONTAINS INFORMATION THAT IS PROPRIETARY AND SHOULD NOT BE USED WITHOUT PRIOR WRITTEN PERMISSION FROM ADAM TECH

SIZE	PART NO.	REV.
X	PH1-3B-XX-MVF-XXXX	C
REF: S00185C	SCALE: NTS	SHEET 1 OF 1

6

5

4

3

2

1