

10 9 8 7 6 5 4 3 2 1

MATERIALS AND FINISHES:

BODY & SMA COUPLING NUT ST. STEEL  
PASSIVATED

BNC COUPLING NUT BRASS  
PLATED NICKEL

CENTER CONTACT BRASS  
PLATED GOLD

INSULATOR TEFLON

SNAP RING BERYLLIUM COPPER

GASKET SILICONE RUBBER

SPRING WASHER PHOSPHOR BRONZE

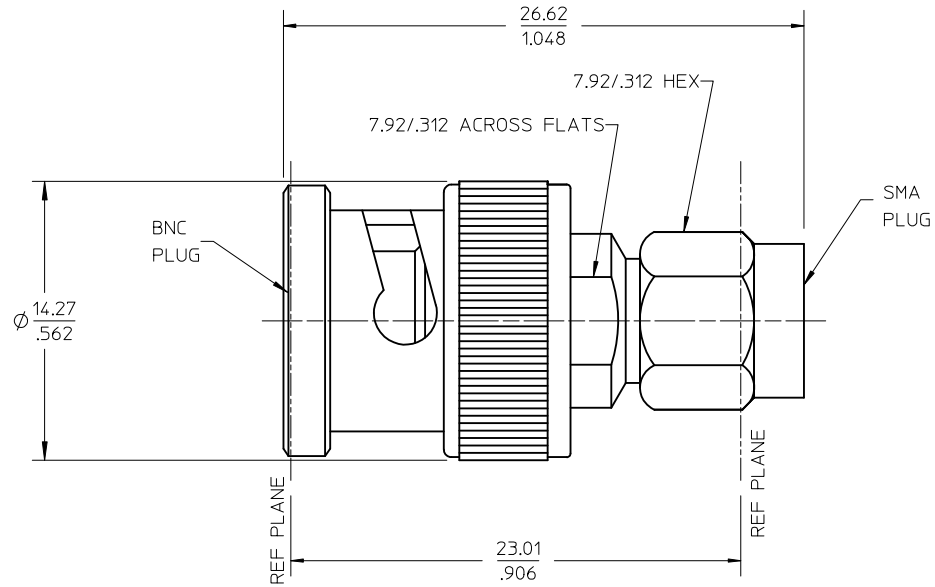

PS-89675-2700	ELECTRO/MECH PERF
MIL-STD-348A, FIG. 310-1	INTERFACE (BNC)
MIL-STD-348A, FIG. 310-1	INTERFACE (SMA)
SPECIFICATION	DESCRIPTION

CHG: UPDATED BORDER, CONTACT MATERIAL WAS BERYLLIUM COPPER	EC NO: URF2011-0666	2011/05/12
	DRWN:SSHAH	2011/05/12
A1	CHKD:AROBERTSON	2011/05/12
	APPR:JWIENER	2011/05/12

QUALITY SYMBOLS	DESCRIPTION
▽=0	
▽=0	

GENERAL TOLERANCES (UNLESS SPECIFIED)	
	mm INCH
4 PLACES ± --- ± ---	
3 PLACES ± --- ± ---	
2 PLACES ± --- ± ---	
1 PLACE ± --- ± ---	
ANGULAR ±1/2°	
DRAFT WHERE APPLICABLE MUST REMAIN WITHIN DIMENSIONS	

DIMENSION STYLE	
IN/MM	
DRAWN BY	DATE
EDC	1997/12/29
CHECKED BY	DATE
DHG	1998/01/05
APPROVED BY	DATE
	1997/12/29
MATERIAL NO.	733860013
SIZE	B

SCALE	DESIGN UNITS	THIRD ANGLE PROJECTION
	INCH	
TITLE		
BSA BNC P/SMA P 50 OHMS BSA-BNC/SMA		
molex MOLEX INCORPORATED		
DOCUMENT NO.	SD-73386-001	SHEET NO.
		1 OF 1
THIS DRAWING CONTAINS INFORMATION THAT IS PROPRIETARY TO MOLEX INCORPORATED AND SHOULD NOT BE USED WITHOUT WRITTEN PERMISSION		