

PART NUMBER	POSITION	REMARK	DIM A
10053363-203LF	2X32	WITHOUT KEY	2.60±0.25

NOTES:

- ①) PRODUCT MARK:  
PART NUMBER AND DATE CODE TO BE MARKED ON THIS SURFACE .  
THE MARK CAN BE OMITTED IF THERE IS NOT ENOUGH SPACE ON THIS SURFACE.
- 2) MATERIALS:  
-HOUSING : HIGH TEMPERATURE THERMOPLASTIC WITH GLASS FIBER, UL94V-0, BLACK.  
-CONTACT : HIGH CONDUCTIVITY COPPER ALLOY.
- 3) CONTACT FINISH REF: GS-12-259 SECTION 4.2.
- ④) ALL HOLE DIAMETERS ARE FINISHED HOLE SIZES.
- 5) THE HOUSING WILL WITHSTAND EXPOSURE TO 245°C PEAK TEMPERATURE FOR 10 SECONDS  
IN A WAVE SOLDER APPLICATION.
- 6) THE PRODUCT IS COMPLIANT WITH LOW HALOGEN FREE ADN RED PHOSPHORUS FREE.
- 7) THIS PRODUCT MEETS EUROPEAN UNION DIRECTIVES AND OTHER COUNTRY  
REGULATIONS AS DESCRIBED IN GS-47-0004.
- 8) PRODUCT SPECIFICATION : GS-12-259.  
PACKAGING SPECIFICATION: GS-14-937.

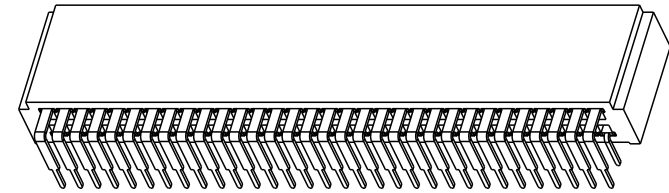
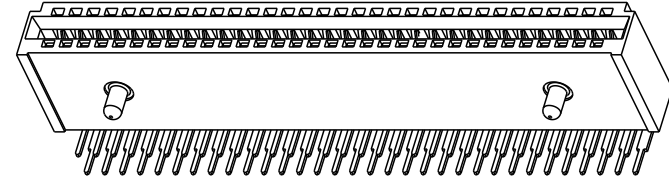

spec ref		*		dr	Sunny2 Liu	2016/04/28	projection 	MM 	size	A4	scale	1.000
tolerance std		TOLERANCES UNLESS OTHERWISE SPECIFIED		eng	Sunny2 Liu	2016/08/29			ecn no	-		
				chr	Terris Liu	2016/08/29				rel level		Released
surface		linear	0.X	±0.50	Amphenol FCi	title		PEC RA CONNECTOR	dwg no	10053363-203	rev	A
			0.XX	±0.25		+ 2x32P						
			0.XXX	±0.10		cat. no.						
		angular	0°	±2°	Product - Customer Drw		sheet 1 of 3					

A

B

C

D

A

B

C

D

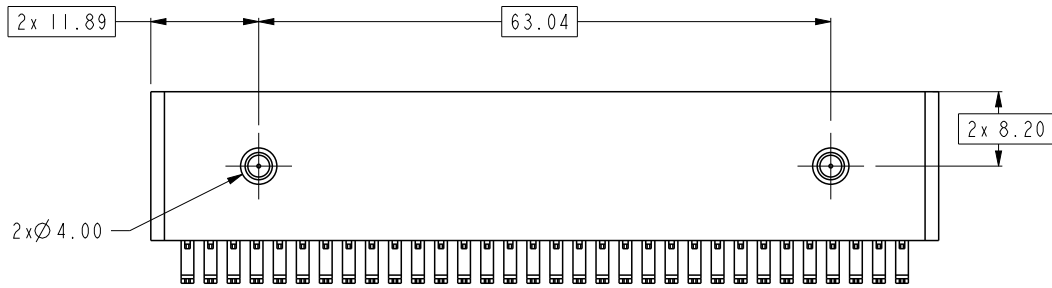
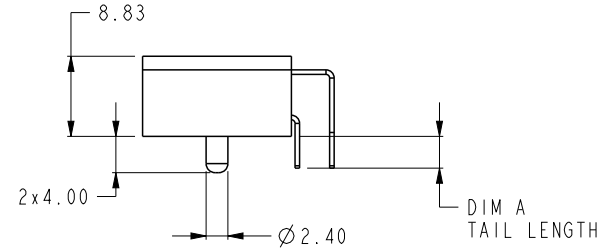
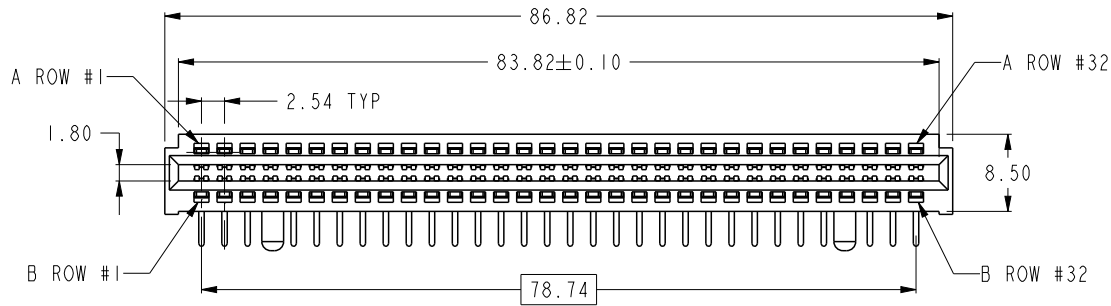
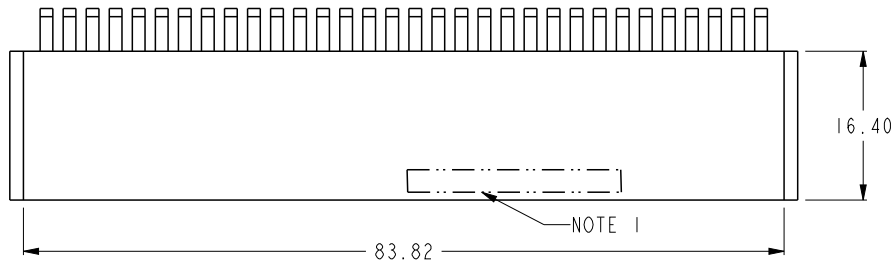

spec ref	*	dr	Sunny2 Liu	2016/04/28	projection 	MM ←→	size	A4	scale	1.000				
tolerance std	TOLERANCES UNLESS OTHERWISE SPECIFIED	eng	Sunny2 Liu	2016/08/29			ecn no	-						
		chr	Terris Liu	2016/08/29				rel level	Released					
surface	linear	0.X	±0.50	Amphenol FCI	product family	cat. no.	*		Product - Customer Drw	sheet 2 of 3				
✓	angular	0.XX	±0.25					PEC RA CONNECTOR			dwg no	10053363-203	rev	A
		0.XXX	±0.10											
		0°	±2°											

A

B

C

D

A

B

C

D

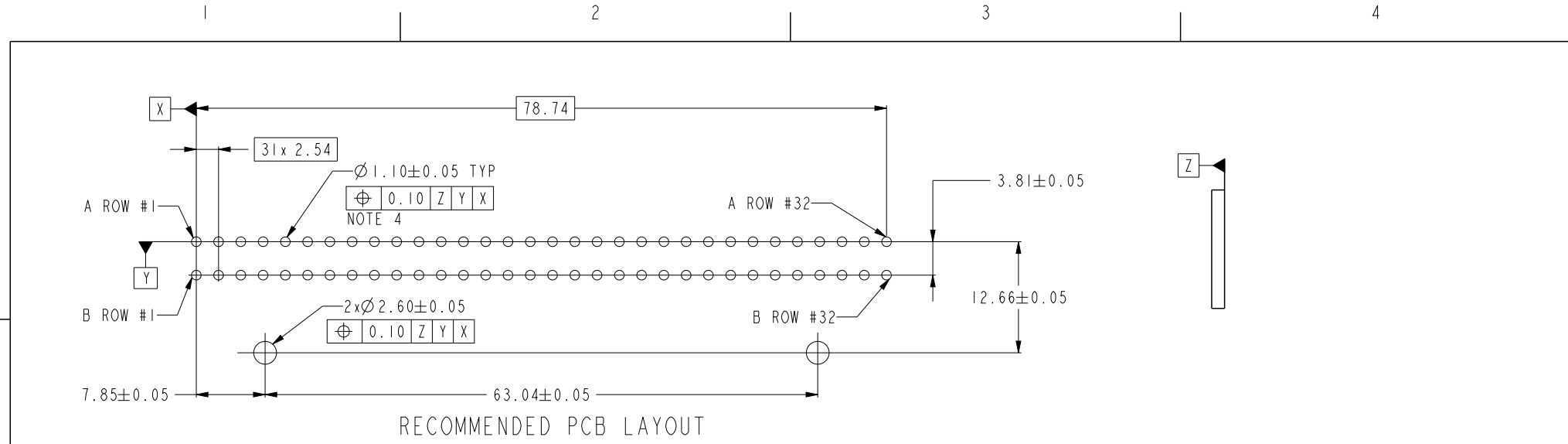

RECOMMENDED PCB LAYOUT

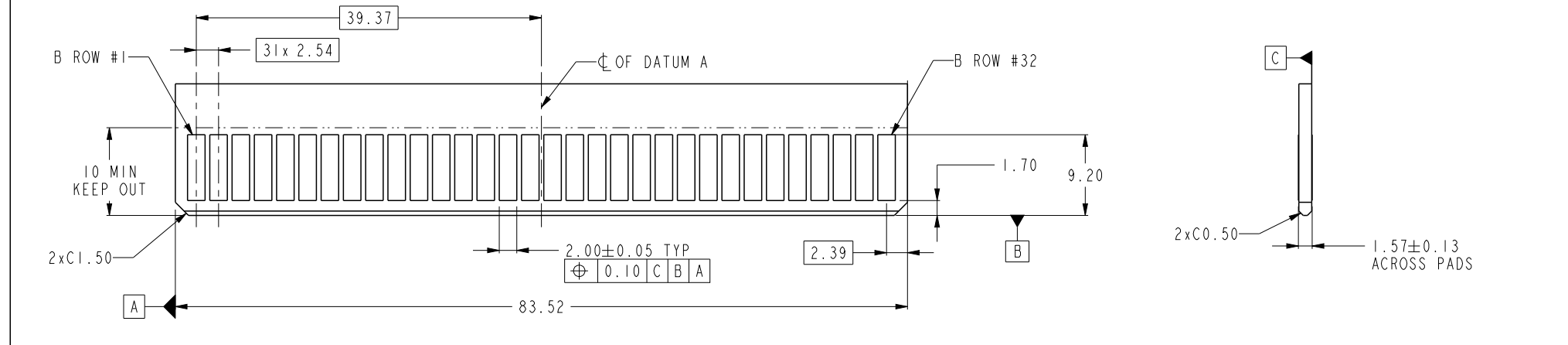

RECOMMENDED DAUGHTER CARD LAYOUT (TOP SIDE)

spec ref	*	dr	Sunny2 Liu	2016/04/28	projection 	MM ←→	size	A4	scale	1.000			
tolerance std	TOLERANCES UNLESS OTHERWISE SPECIFIED	eng	Sunny2 Liu	2016/08/29			ecn no	-					
		chr	Terris Liu	2016/08/29				rel level	Released				
surface	linear	0.X	±0.50	Amphenol FCi	product family	dwg no	10053363-203	rev	A				
		0.XX	±0.25							cat. no.	*	Product - Customer Drw	sheet 3 of 3
		0.XXX	±0.10										
	angular	0°	±2°										

Creo File - REV E - 2016-02-12