

REVISIONS					
P	LTR	DESCRIPTION	DATE	DWN	APVD
	H7	REVISED PER ECR-22-153250	21OCT2022	RK	MT

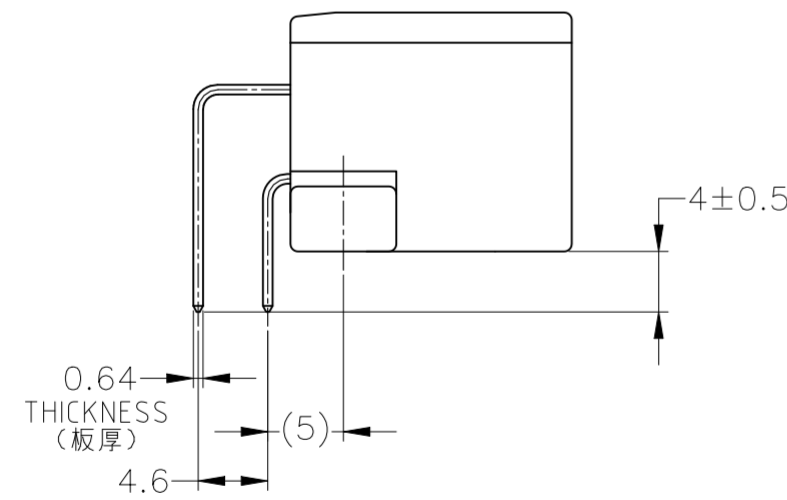

- ① A 面より2mmの範囲で測定。
- ② 相手ハウジングと所定の機能を満足して嵌合できること。
- ③ プリント基板への取付は、JIS B1115又は1122, M3×6ナベ (2種又は4種) のタッピンネジで締付けた後ハンダ付する。(締付けトルク4kg-cm以下)
- ④ 回路番号：下図参照のこと。

- ① TO BE MEASURED BETWEEN [A] AND 2.
- ② TO BE MATE WITH PLUG HSG SMOOTHLY.
- ③ TO BE USE M3 TAPPING SCREW JIS B1115 OR 1122 (TYPE 2 OR 4) BEFORE SOLDER.
- ④ CIRCUIT NUMBER.

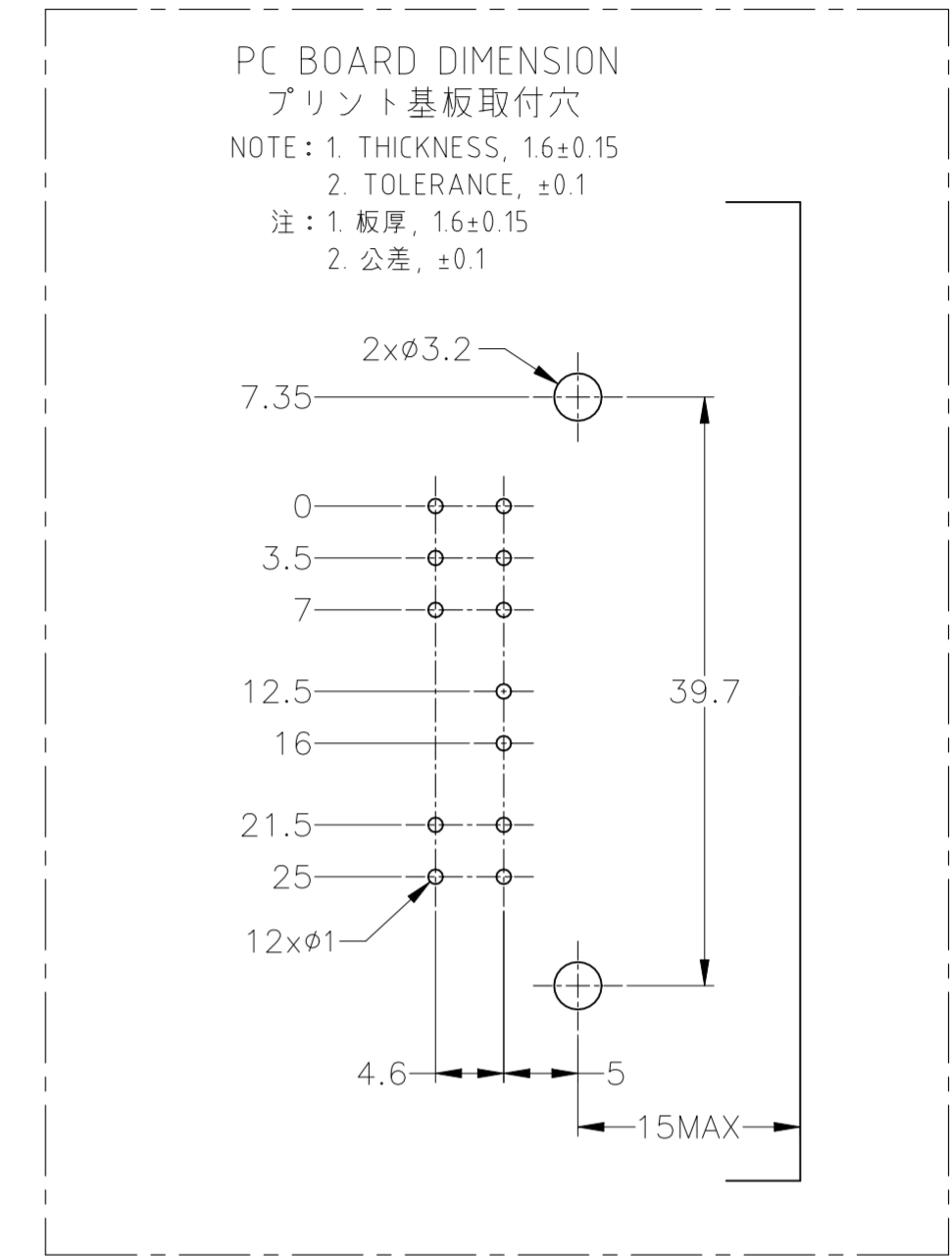
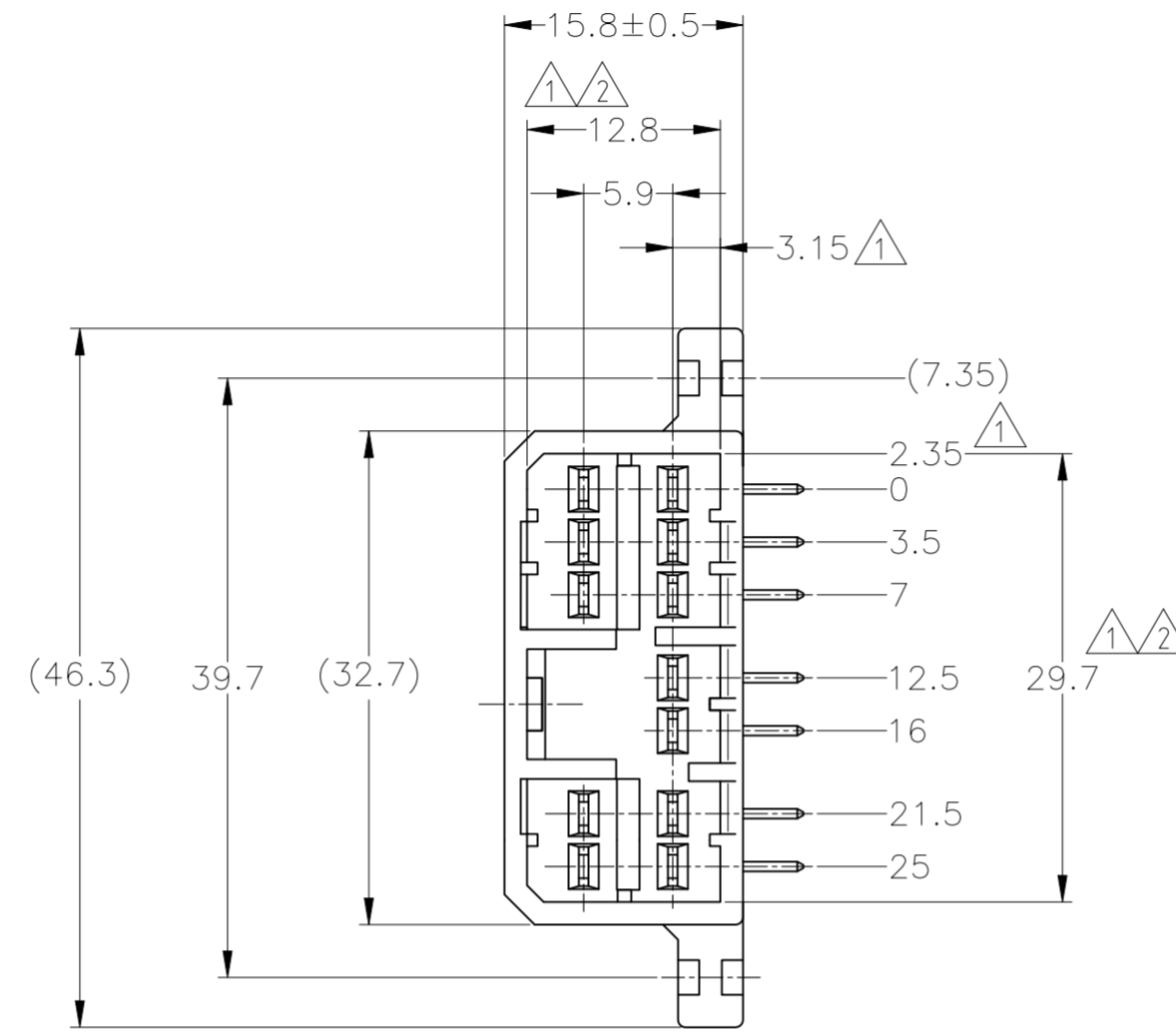
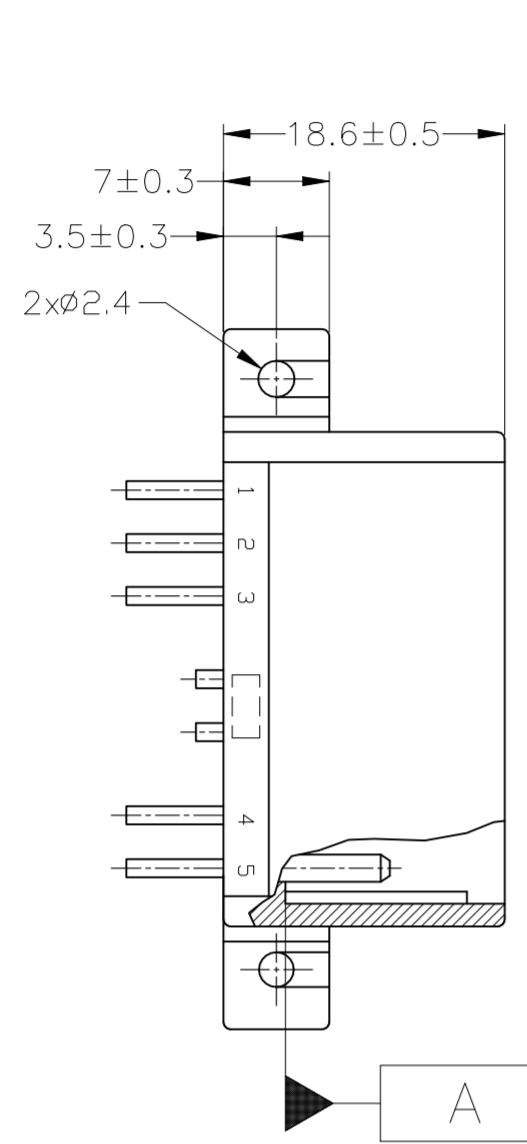
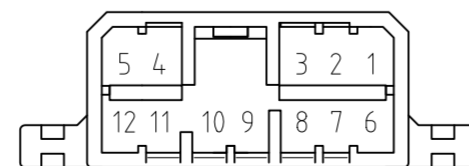

	HB	SELECTIVE-TIN (MATTE)	SELECTIVE-TIN (BRT) x 12	-	1~12 (全極)	NATURAL 自然色	173858-7	
OBSOLETE	HB	SELECTIVE-TIN (MATTE)	SELECTIVE-GOLD x 12	1~12 (全極)	-	GREEN 緑色	2-5173858-4	
	HB	SELECTIVE-TIN (MATTE)	SELECTIVE GOLD x 12	1~12 (全極)	-	NATURAL 自然色	2-5173858-1	
OBSOLETE	HB	PRE-TIN x 7		-	1,3,5,6,8,10,12 (7極)	GRAY 灰色	2-173858-6	
OBSOLETE	-	SELECTIVE-TIN	PRE-TIN x 12	-	1~12 (全極)	GRAY 灰色	3-173858-2	
OBSOLETE	-	SELECTIVE-TIN	PRE-TIN x 12	-	1~12 (全極)	NATURAL 自然色	3-173858-1	
OBSOLETE	HB	TIN LEAD	SELECTIVE-GOLD x 12	1~12 (全極)	-	GREEN 緑色	2-173858-4	
OBSOLETE	V-2	PRE-TIN x 12		-	1~12 (全極)	NATURAL 自然色	9-173858-1	
	HB	PRE-TIN x 12		-	1~12 (全極)	GRAY 灰色	173858-6	
OBSOLETE	HB	TIN LEAD	SELECTIVE-GOLD x 12	1~12 (全極)	-	NATURAL 自然色	2-173858-1	
	HB	PRE-TIN x 12		-	1~12 (全極)	GREEN 緑色	173858-4	
	HB	PRE-TIN x 12		-	1~12 (全極)	NATURAL 自然色	173858-1	
	USED MATERIAL		SOLDERING SIDE 半田付け面	CONTACT SIDE 接触部側	GOLD PLATED CIRCUIT NO. ④ 金めっき回路番号	PRE-TIN OR SELECTIVE-TIN CIRCUIT NO. ④ 錫めっき回路番号	COLOR 色	PART NUMBER 製品型番
	FLAMMABILITY		CONTACT FINISH コンタクト仕上					

THIS DRAWING IS A CONTROLLED DOCUMENT.

DWN	T.SHINOHARA	06FEB07
CHK	K.BETSUI	06FEB07
APVD	K.BETSUI	06FEB07
PRODUCT SPEC	製品規格	
APPLICATION SPEC	取付適用規格	

TE Connectivity

070 SERIES MULTI-LOCK I/O CONNECTOR
12POSITION CAP HOUSING ASSEMBLY (H-TYPE)

SIZE	A2	CAGE CODE	00779	DRAWING NO	C=173858	RESTRICTED TO	-
WEIGHT	7.4 g	SCALE	2:1	SHEET	1 OF 1	REV	H7

CUSTOMER DRAWING

TOLERANCES UNLESS OTHERWISE SPECIFIED: 一般公差

10±	±0.2
30±	>10 : ±0.25
100±	>30 : ±0.3
ANGLE	±3°

TOLERANCES UNLESS OTHERWISE SPECIFIED: 一般公差

0 PLC	±
1 PLC	±
2 PLC	±
3 PLC	±
4 PLC	±
ANGLES	±

FINISH 仕上 SEE TABLE