

PC card drilling dimensions(after plating)  
(thickness 1.60±0.20mm)

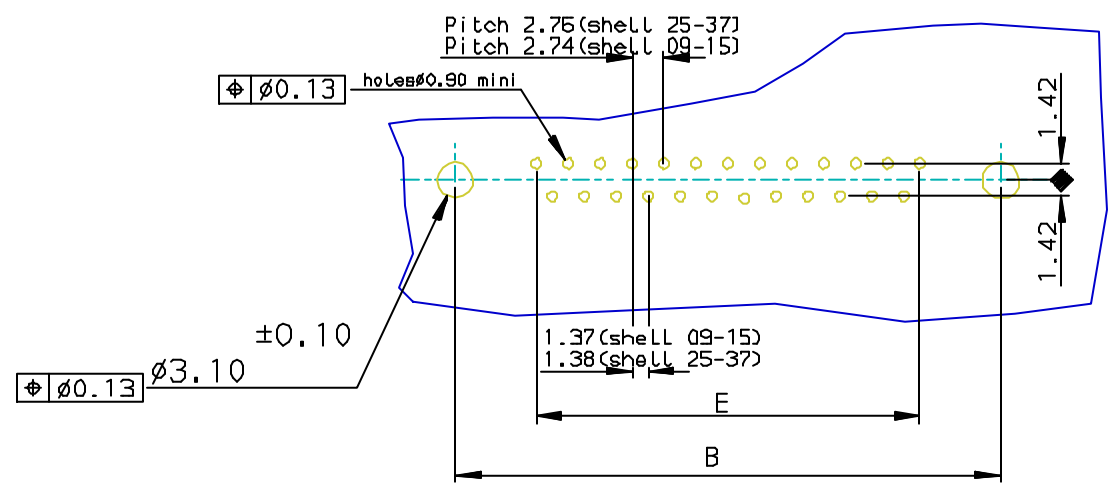

SHELL	A±0.38	B±0.12	C±0.10	D $\begin{matrix} +0.25 \\ 0 \end{matrix}$	E±0.07	G $\begin{matrix} +0.25 \\ 0 \end{matrix}$	PART NUMBER	PART NUMBER
09	30.81	24.99	16.96	16.79	10.96	5.90	D09P33E4PV00**	D09P33E6PV00**
15	39.14	33.32	25.18	25.12	19.18	5.90	D15P33E4PV00**	D15P33E6PV00**
25	53.03	47.04	39.12	38.84	33.12	5.70	D25P33E4PV00**	D25P33E6PV00**
37	69.32	63.50	55.68	55.30	49.68	5.70	D37P33E4PV00**	D37P33E6PV00**
							Gold Flash	0,76 $\mu$ gold

LF FOR LEAD FREE

**REQUIREMENTS**

**Technical characteristics:**  
 Shell: steel tin/Zinc Cr3 plated  
 Insulators: self-extinguishing thermoplastic, ULClass94V0  
 Contacts: brass, gold (For thickness see table) over 2 $\mu$  mini nickel on active area and flash to 1.5 $\mu$  maxi SnPb over 1 $\mu$  mini nickel on termination  
 Cycles: 200 for plating 4  
 :500 For plating 5

**Accessories:**

Screwlock: brass, tin/Zinc Cr3 plated

**Electrical characteristics:**  
 max. current rating: 5A  
 Test voltage: 1000V  
 Rated voltage: 300V  
 Contact resistance: <25m $\Omega$   
 Shell resistance: <5m $\Omega$   
 Insulation resistance: >5000M $\Omega$

**Climatic characteristics:**  
 Operating temperature range: -55 $^{\circ}$ C +125 $^{\circ}$ C

**Dimensions:**  
 In accordance with MIL-C-24308B and DIN41652

FOR ROHS DETAILS REFER DWG. NO: C01-8646-0000

European Views

rev	ecn no	dr	date
B	105-0124	JS	2005/07/27
C	106-0074	SK	2006/06/08
-	-	-	-
-	-	-	-
-	-	-	-
-	-	-	-

www.fciconnect.com		surface ISO 1302 ✓	tolerance std ISO 406 ISO 1101	projection mm
TOLERANCES UNLESS OTHERWISE SPECIFIED				
Dr	JOHN SLEEBA	2001/08/13	ANGULAR	0.X ±0.1
Eng	GEORGE VJ	2001/08/13	LINEAR	0.XX ±0.1
Chr	GEORGE VJ	2005/07/27	0.XX* ±1*	0.XXX ±0.1
Appr	KVSD	2005/07/27	Product family	D-SUB
title MALE CONNECT.DELTA D right angle screwlock				size A3
catalog no DELTA-D				Scale 1:1
dwg no C01-8646-0769				Rev. C
CUSTOMER				sheet 1 of 1



Copyright FCI.