

MATERIALS & SPECIFICATIONS

PART NO.	A79041-001	REV	ECO	DATE	APP
		D	105215	01-22-19	HV

INSULATOR:
THERMOPLASTIC PER MIL-M-24519, TYPE GLCP-30F OR GST-40F NATURAL

CONTACT:
COPPER ALLOY PER MIL-DTL-32139. GOLD PLATED PER ASTM B488, (HARD GOLD) TYPE II CODE C CLASS 1.27

TERMINATION:
SOLDER COATED PER J-STD-006 OR PLATED PER AMS-P-81728

GUIDE POST:
BERYLLIUM COPPER ALLOY PER ASTM B196. ELECTROLESS NICKEL (100 MICRO INCHES MINIMUM) PER SAE-AMS-2404

CURRENT CAPACITY:
1 AMP MAX PER MIL-DTL-32139

CONTACT RESISTANCE:
71 MILLIOHMS (71mV) MAX @ 1.0 AMPS PER MIL-DTL-32139

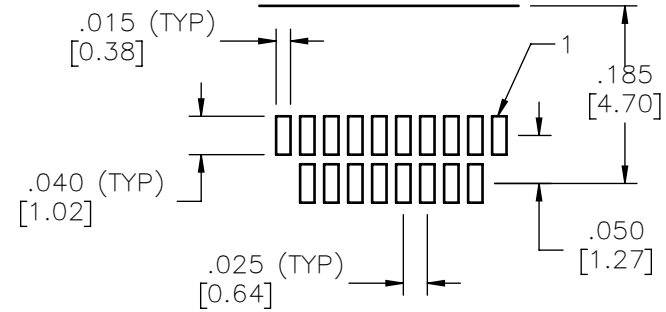
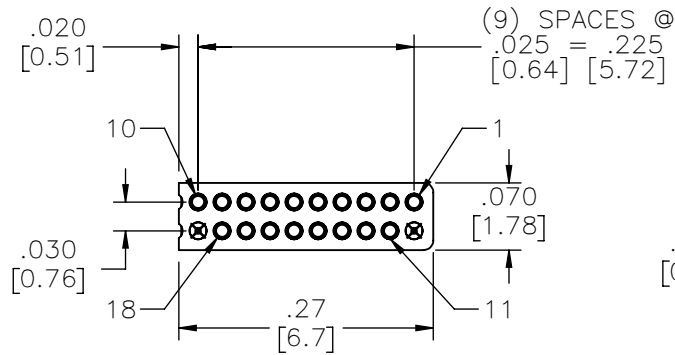

SUGGESTED PAD LAYOUT

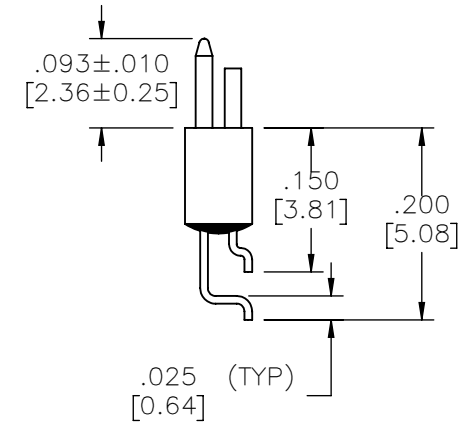
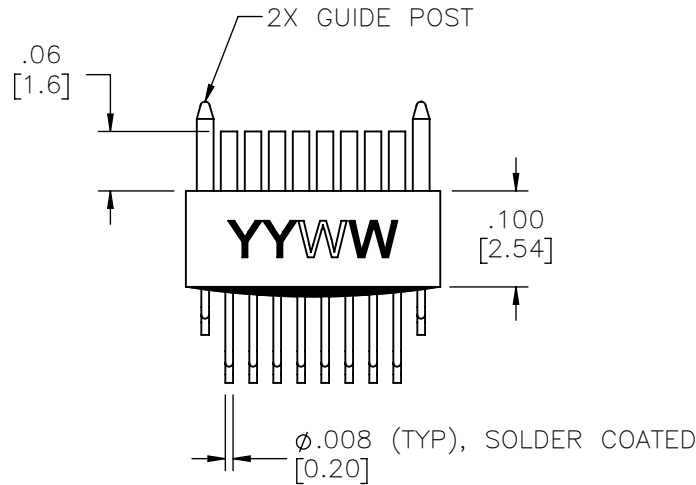

ACTUAL SIZE

NOTE:

DIMENSIONS IN [] ARE IN MILLIMETERS UNLESS OTHERWISE NOTED AND ARE FOR REFERENCE ONLY

MCTS	CSN	THIRD ANGLE ϕ ∇	THIS DRAWING CONTAINS CONFIDENTIAL AND PROPRIETARY INFORMATION WHICH IS THE PROPERTY OF OMNETICS CONNECTOR CORP. THIS DOCUMENT MAY NOT, IN WHOLE OR IN PART, BE DUPLICATED, OR DISCLOSED FOR ANY PURPOSE, WITHOUT WRITTEN PERMISSION FROM OMNETICS CONNECTOR CORP.		OMNETICS CONNECTOR CORPORATION 7260 COMMERCE CIRCLE EAST MINNEAPOLIS, MN 55432 WWW.OMNETICS.COM	CAGE CODE 61873	
		-TOLERANCES-	DFTM. TLM	DATE		TITLE:	DWG NO.
		UNLESS OTHERWISE NOTED	DATE	DATE		(18) SOCKET FEMALE	A79041-001
		DIMENSIONS IN INCHES	DATE	DATE		DUAL ROW NANO	SHEET 1 OF 1
2 PL DEC \pm .01	DATE	DATE	CONNECTOR W/ GUIDE POSTS	REV			
3 PL DEC \pm .005	DATE	DATE		D			
4 PL DEC \pm .0005	DATE	DATE					
ANGLES \pm 1°							