

RECOMMENDED PCB LAYOUT AND KEEP-OUT ZONE

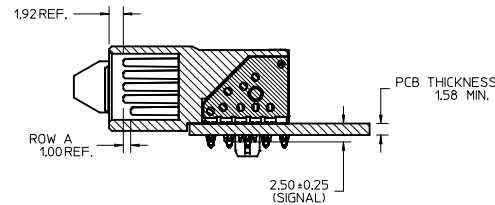

SECTION Z-Z

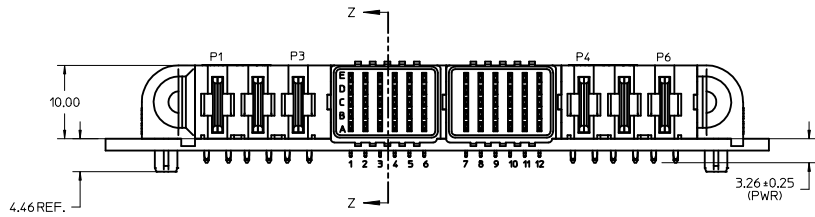
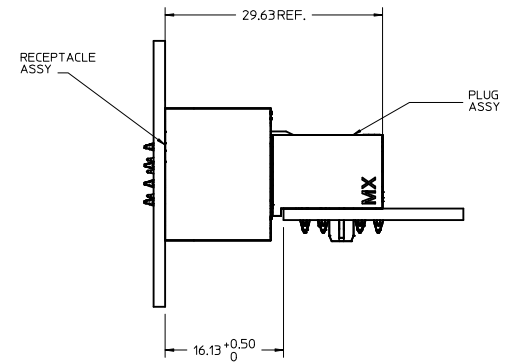

NOTES:

- MATERIAL:
-HOUSINGS: LCP UL94 V-0, COLOR: BLACK.
-TERMINALS: COPPER ALLOY.
-PLATING: 0.000127 NICKEL OVERALL WITH 0.00254 SELECTIVE MATTE TIN ON TAILS, AND 0.000762 SELECTIVE MATTE TIN ON CONTACT AREA.
- PACKAGING ASSEMBLIES TO BE TRAY PACKED, STD. QUANTITY: TBD.
- PC BOARD REQUIRES SOLDER THRU HOLES. REFER TO PS-46436-100 FOR DETAILS.
- PRODUCT SPEC: PS-46436-100.
- APPLICATION SPEC: AS-46436-100.
- SEE PRODUCT SPEC. FOR RoHS REQUIREMENTS.
- ASSEMBLY MATES WITH MOLEX RECEPTACLE ASSEMBLY, P/N 46562-1235.

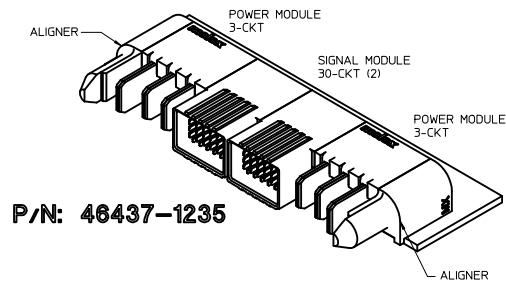

P/N: 46437-1235

| | | | | | | | | | |
|---|-----------------|--|---------------------------------------|------------------|-----------------|---|--|---------------|------------------------|
| RELEASED IEC NO. UCP2011-3212 DRAWN BY CHYD/BKOSTIC 2011/04/18 CHECKED BY APPR:RNELSON 2011/05/18 REV DESCRIPTION | QUALITY SYMBOLS | | GENERAL TOLERANCES (UNLESS SPECIFIED) | | DIMENSION STYLE | | SCALE | DESIGN UNITS | THIRD ANGLE PROJECTION |
| | | | | | MM ONLY | | 3:1 | METRIC | ☉ |
| | | | | | DRAWN BY DATE | | TITLE | | |
| | | | | | CHECKED BY DATE | | RA PLUG ASSY 3P-60S-3P, PRESS-FIT TEN60 POWER FAMILY | | |
| | | | | APPROVED BY DATE | | MATERIAL NO. | | DOCUMENT NO. | |
| | | | | ANGULAR ±1/2° | | 46437-1235 | | SD-46437-1235 | |
| | | DRAFT WHERE APPLICABLE MUST REMAIN WITHIN DIMENSIONS | | SIZE D | | THIS DRAWING CONTAINS INFORMATION THAT IS PROPRIETARY TO MOLEX INCORPORATED AND SHOULD NOT BE USED WITHOUT WRITTEN PERMISSION | | | |

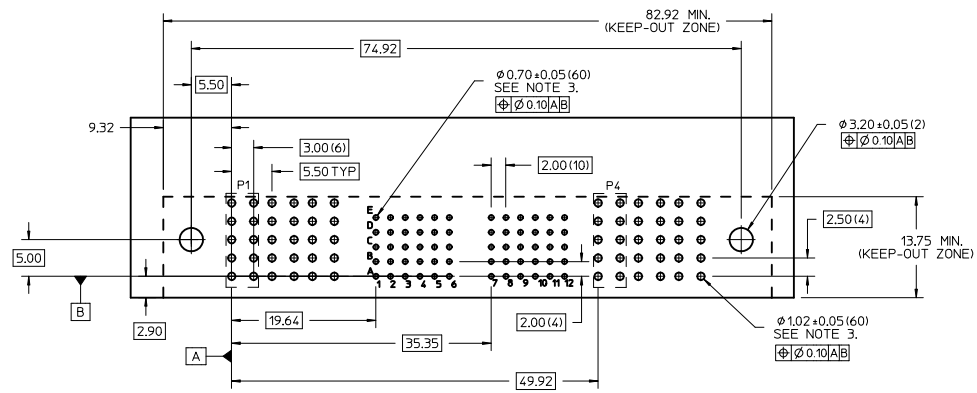
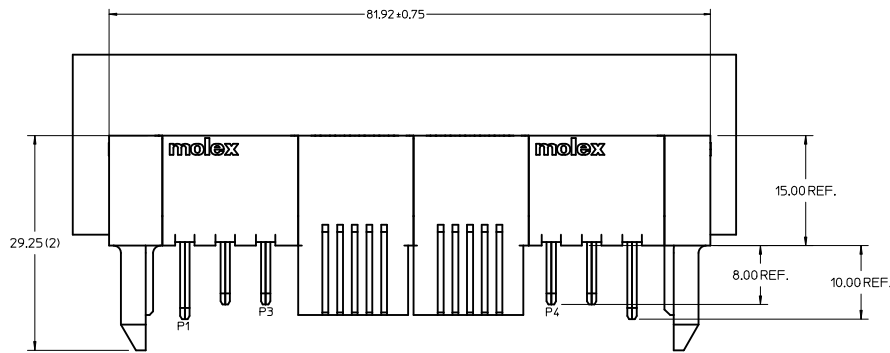

RECOMMENDED PCB LAYOUT AND KEEP-OUT ZONE

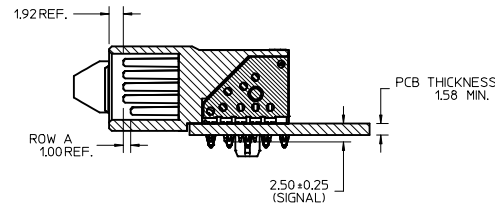
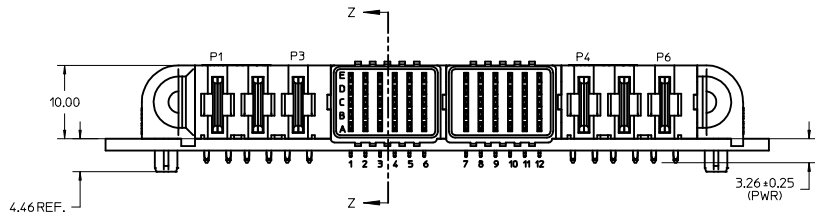

SECTION Z-Z

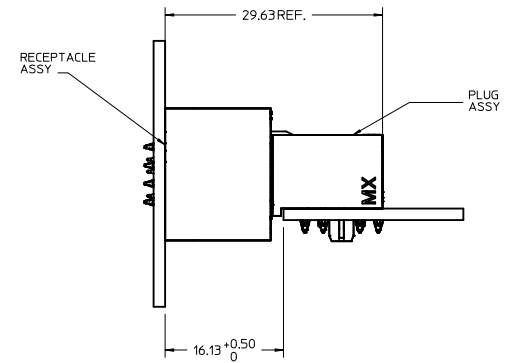

NOTES:

- MATERIAL:
-HOUSINGS: LCP UL94 V-0, COLOR: BLACK.
-TERMINALS: COPPER ALLOY.
-PLATING: 0.000127 NICKEL OVERALL WITH 0.00254 SELECTIVE MATTE TIN ON TAILS, AND 0.000762 SELECTIVE MATTE TIN ON CONTACT AREA.
- PACKAGING ASSEMBLIES TO BE TRAY PACKED, STD. QUANTITY: TBD.
- PC BOARD REQUIRES SOLDER THRU HOLES. REFER TO PS-46436-100 FOR DETAILS.
- PRODUCT SPEC: PS-46436-100.
- APPLICATION SPEC: AS-46436-100.
- SEE PRODUCT SPEC. FOR RoHS REQUIREMENTS.
- ASSEMBLY MATES WITH MOLEX RECEPTACLE ASSEMBLY, P/N 46562-1235.

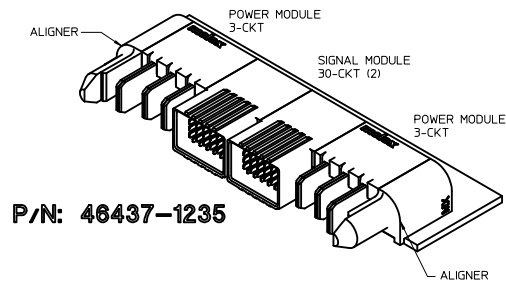

P/N: 46437-1235

| | | | | | | | | | |
|---|-----------------|------|---------------------------------------|---------|----------------------------|--------------------|--|------------------------|--|
| RELEASED IEC NO. UCP2011-3212 DRAWN BY CHYD/BKOSTIC 2011/04/18 CHECKED BY APPR:RNELSON 2011/05/18 REV DESCRIPTION | QUALITY SYMBOLS | | GENERAL TOLERANCES (UNLESS SPECIFIED) | | DIMENSION STYLE MM ONLY | | SCALE 3:1 | DESIGN UNITS METRIC | THIRD ANGLE PROJECTION |
| | | | mm | INCH | DRAWN BY BKOSTIC | DATE 2011/04/18 | TITLE | | |
| | 4 PLACES | ±--- | ±--- | ±--- | CHECKED BY BKOSTIC | DATE 2011/04/18 | RA PLUG ASSY 3P-60S-3P, PRESS-FIT TEN60 POWER FAMILY | | |
| | 3 PLACES | ±--- | ±--- | ±--- | APPROVED BY RNELSON | DATE 2011/05/18 | MOLEX INCORPORATED | | |
| | | | | 1 PLACE | ±0.25 | ±--- | ±--- | ANGULAR ±1/2° | DRAFT WHERE APPLICABLE MUST REMAIN WITHIN DIMENSIONS |
| | | | | | | | | | WATER MATERIAL NO. 46437-1235 |
| | | | | | | | | | DOCUMENT NO. SD-46437-1235 |
| | | | | | | | | | SHEET NO. 1 OF 1 |