

Single Port RJ45 Connector

AR11-4296I

- 10/100 Base-T for LAN and other Ethernet Applications
- Designed to meet IEEE802.3
- RJ45 jack cavity conforms to FCC rules and regulations Part 68, SUB Part F
- Industrial Temp: -40°C to +85°C

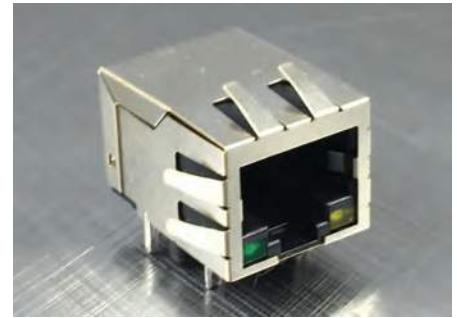

Electrical Specifications @ 25°C

Part Number	OCL(uH Min) @ 100kHz	Turns Ratio @ 100kHz, 0.1V		Cross Talk (dB Min) 1-100MHz	HI-POT 1mA,60S 1500
	With 0.1V 8mA DC Bias	P1-P2: J1-J2	P3-P6: J3-J6		
AR11-4296I	350	1:1±5%	1:1±5%	-30	

Electrical Specifications @ 25°C

Part Number	Insertion Loss (dB Max) 1-100MHz	Return Loss (dB Min)				CMR (dB Min) 1-100MHz
		1-30MHz	30-60MHz	60-100MHz	80-100MHz	
AR11-4296I	-1.0	-18	-16	-12	-10	-30

All specifications subject to change without notice.

MECHANICAL

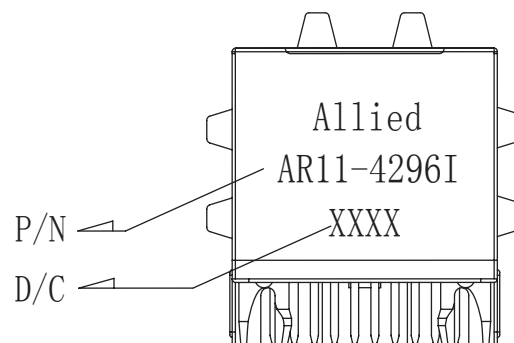
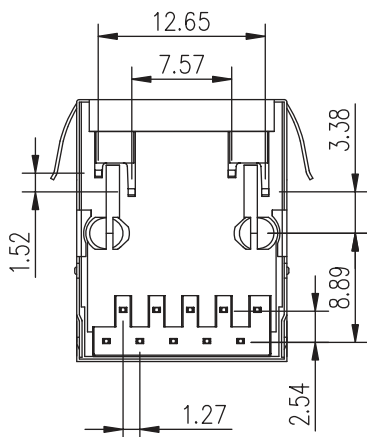
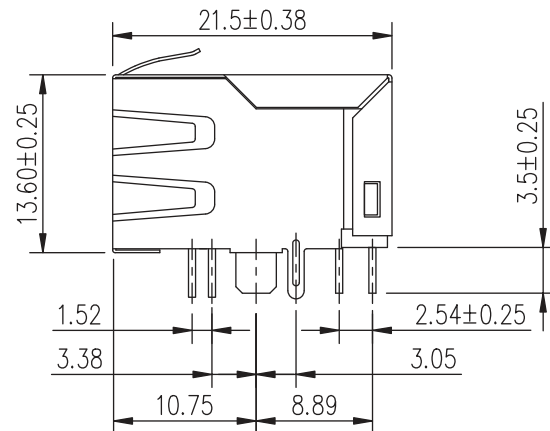
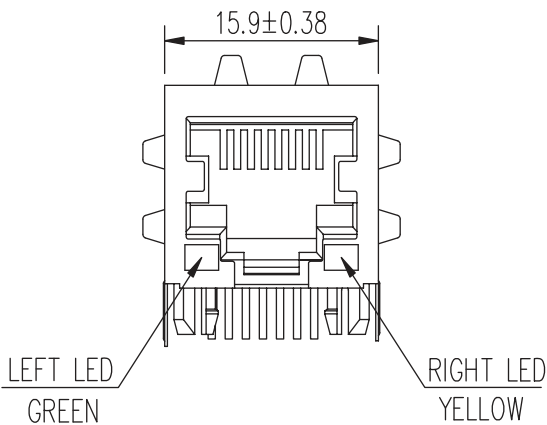

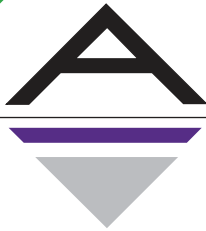

SCHEMATICS

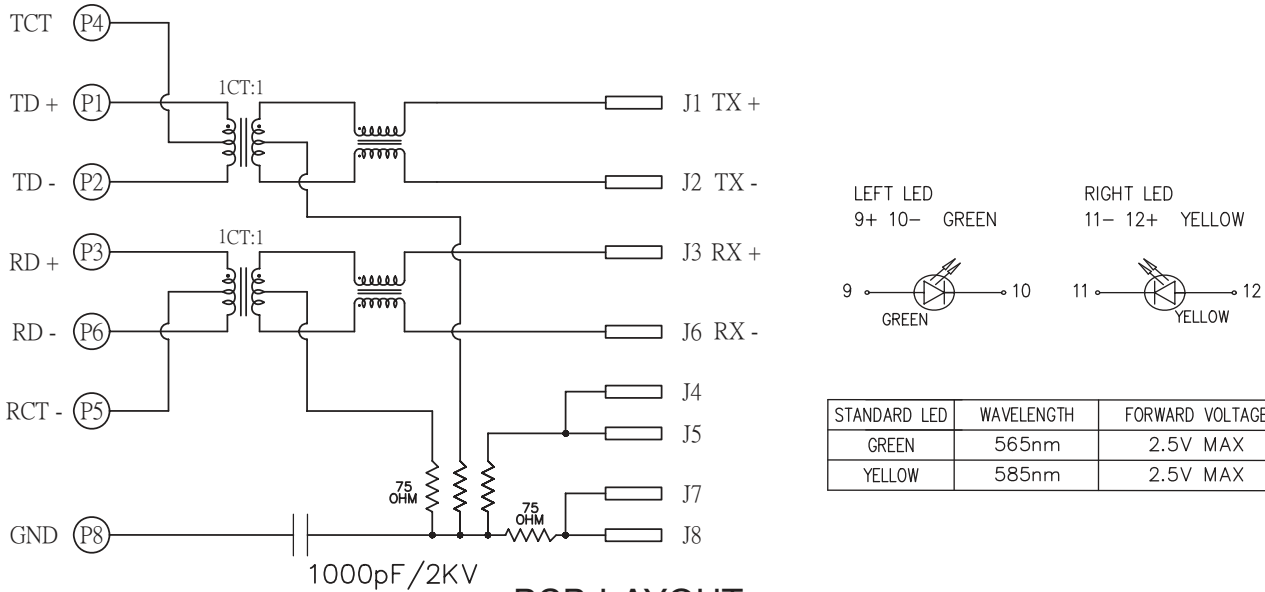

PCB LAYOUT

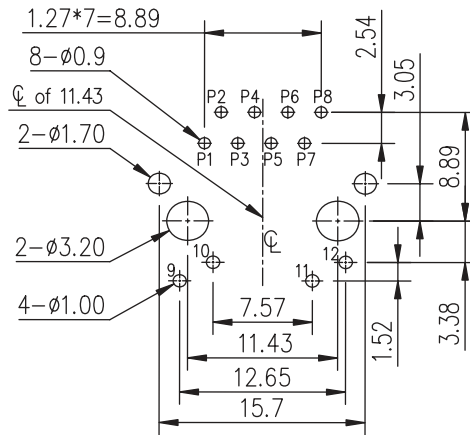

RECOMMENDED PCB LAYOUT
TOLERANCE ±0.05mm(T=1.6mm)

NOTES

- Shielded – 0.20mm THICKNESS BRASS C2680 H. PLATING NICKEL 20u"MIN.
- Housing– Standard Material PA66,Glass Filled Polyester UL94V-0 Standed Color Black.
- Insert Pin– Plastic:PA66 UL94V-0,Standard Color Black. Pin:0.35mm Thickness Phos-Bronze C5210 EH. Plating:Nickel 30u"~60u" for all and Sn 100%, and Gold Plating 15u".
- Contact Pin– Plastic:PA66 ,Glass Filled,UL94V-0, Standard Color Black. Pin:0.35mm Thickness SUS430. Plating:Nickel 30u"~60u" for all and Sn 100%.