

# MR. | Adjustable handles

Technopolymer

INCH

RoHS

PA

+266 °F  
-22 °F

- 1
- 2
- 3
- 4
- 5
- 6
- 7
- 8
- 9
- 10
- 11
- 12
- 13
- 14
- 15
- 16
- 17
- 18

## LEVER BODY

Glass-fibre reinforced polyamide based (PA) technopolymer, black colour matte finish.

## STANDARD EXECUTION

Glass-fibre reinforced technopolymer clamping element, black colour, with knurling on the protruding part to make initial tightening easier. Black-oxide steel boss, plain or threaded blind hole. Black-oxide steel retaining screw, AISI 302 stainless steel return spring.

## FEATURES AND APPLICATIONS

Particularly suitable when the lever turning angle is limited owing to lack of space.

MR. adjustable handles can be quickly screwed during assembly by means of electric or pneumatic screwdrivers with controlled tightening torque system.

## STRESS RESISTANCE

See ERX. on page 324.

## INSTRUCTIONS OF USE

For clamping, lift the lever to disengage the clamping device teeth and bring it back to start position. By releasing the lever, the return spring automatically engages the teeth.

If the lever cannot make a 360° rotation, the clamping element can be easily screwed by means of the hexagon socket front head screw (after having disengaged the lever).



ELESA Original design 

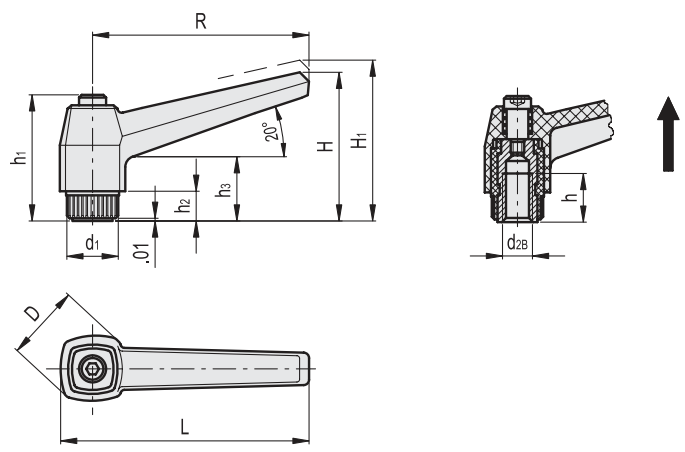

INCH

Code	Description	R	d2B	L	D	H	H1	h	h1	h2	h3	d1	Teeth nr	$\Delta$
940511	MR.40 A-10-24	1.65	10-24	1.97	0.71	1.26	1.44	0.39	1.14	0.24	0.55	0.47	18	0.04
940541	MR.40 A-1/4-20	1.65	1/4-20	1.97	0.71	1.26	1.44	0.39	1.14	0.24	0.55	0.47	18	0.03
940611	MR.63 A-1/4-20	2.48	1/4-20	2.87	0.91	1.69	1.85	0.59	1.42	0.31	0.67	0.59	20	0.06
940641	MR.63 A-5/16-18	2.48	5/16-18	2.87	0.91	1.69	1.85	0.59	1.42	0.31	0.67	0.59	20	0.06
940711	MR.80 A-3/8-16	3.15	3/8-16	3.62	1.1	2.13	2.34	0.79	1.77	0.39	0.87	0.75	24	0.13
940741	MR.80 A-1/2-13	3.15	1/2-13	3.62	1.1	2.13	2.34	0.79	1.77	0.39	0.87	0.75	24	0.12
940811	MR.100 A-1/2-13	3.94	1/2-13	4.49	1.3	2.56	2.78	0.98	2.09	0.47	0.98	0.98	28	0.27
940841	MR.100 A-5/8-11	3.94	5/8-11	4.49	1.3	2.56	2.78	0.98	2.09	0.47	0.98	0.98	28	0.23

Clamping levers

350

