

RECOMMENDED PC BOARD LAYOUT

NOTES:

1. RECOMMENDED P.C.B THICKNESS 1.60 MM
2. HOUSING MAT'L: NYLON 66, 25% G.F UL 94V-0, BLACK.
3. CONTACTS: PHOS BRONZE ALLOY UNS-C51000, ϕ 0.460 ROUND WIRE, PLATING SEE TABLE.
4. METAL SHELL MATERIAL:
COPPER ALLOY. 0.20mm THICK
FINISH:
FOR 94152-XXX TIN-LEAD 100u" THICK MIN.
FOR 94152-XXXLF PURE TIN 80u" THICK MIN.
5. PACKAGING: GES-14-351, USE TRAY
6. ALL DIMENSIONS IN MILLIMETER.
7. IF LF P/N THE PRODUCT MEETS EUROPEAN UNION DIRECTIVES AND OTHER COUNTRY REGULATIONS AS DESCRIBED IN GS-22-008.
8. THE HOUSING WILL WITHSTAND EXPOSURE TO 260°C PEAK TEMPERATURE FOR 10 SECONDS IN A WAVE SOLDER APPLICATION WITH A 1.60mm MINIMUM THICK CIRCUIT BOARD.
9. IF LF P/N PACKAGING MEETS GS-14-920 SPECIFICATION.

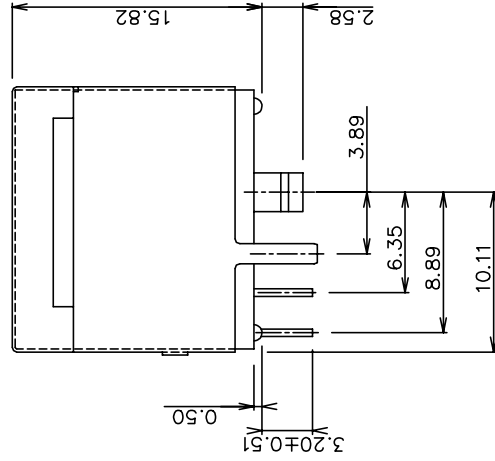
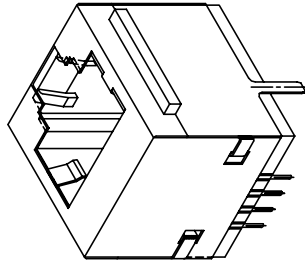
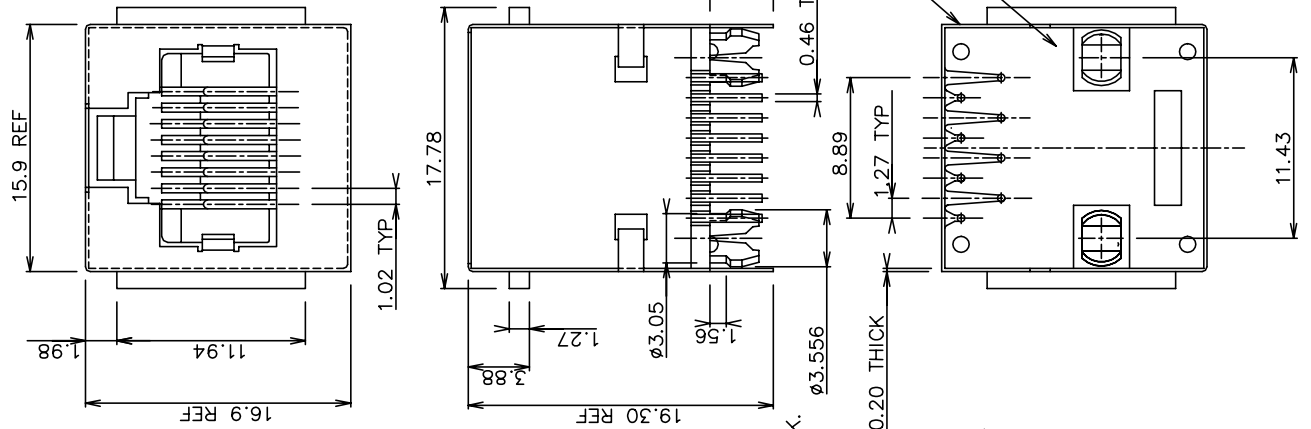

P/N	WIRE NUMBERS LOADED	PLATING
94152-088	ALL	5u" Au + high performance lubricant
94152-088LF	ALL	6u" GXT
94152-188LF	ALL	15u" GXT
94152-288LF	ALL	30u" GXT
94152-388LF	ALL	50u" GXT

mat'l. code	surface	tolerance	projection	product family
ISI1302	ISI1302	ISI1302	ISI1302	MOD JACK
tolerances unless otherwise specified				
B T50378 CL 12/18/95	angle	0.XX±0.3	mm	
C T03-0443 WL 10/06/03	angle	0.XX±0.15	mm	
D N05-0030 YS 02/05/05	0°±2'	0.XXX±0.05	scale 2.0	
E N06-0319 WG 12/28/08	chr	KCHOU	09/16/93	
F ELX-N-010990 SH MM 03/14/12	eng	TONY CHIEN	09/16/93	8 POS VERT P.C.B. M/J ASSY SHIELDED
G ELX-N-15847 Henry	09/13/13	chr	TONY CHIEN	09/16/93
appd	JENN TSAO	09/16/93		
sheet	revising			
index	Sheet	1		



type	Product	Customer Drawing
8 POS VERT P.C.B. M/J ASSY SHIELDED	94152	
awg no	sheet	tof 1 size
		A4