

LOC	DIST	REVISIONS			
P	LTN	DESCRIPTION	DATE	DWN	APVD
GP	00	A	RELEASED PER ECO-12-013192	10OCT2012	BMM MRS

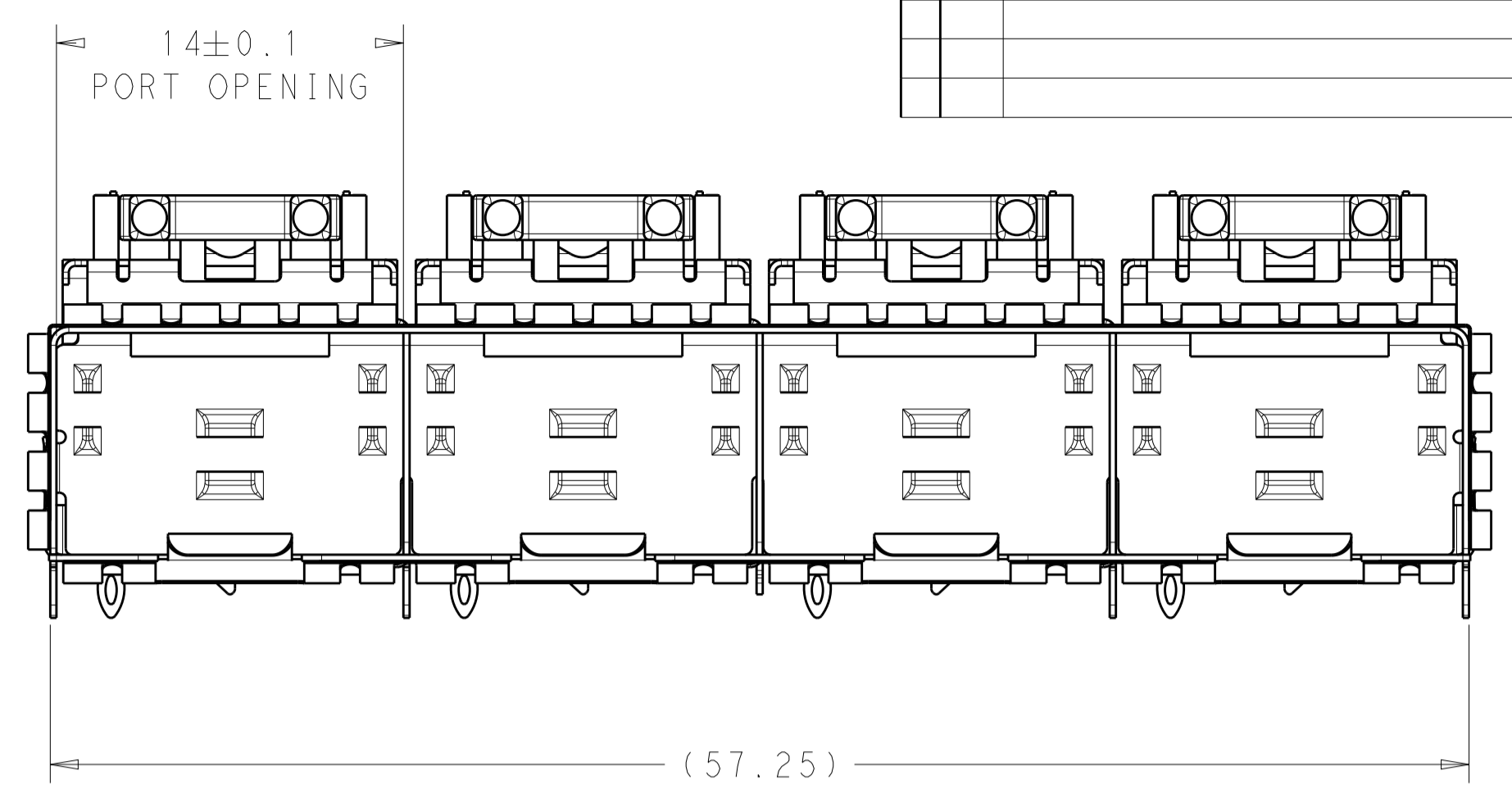

- △ MATERIAL:  
CAGE ASSEMBLY: 0.25mm THICK NICKEL SILVER ALLOY.  
LIGHTPIPE/HEATSINK CLIP: STAINLESS STEEL  
LIGHT PIPE: POLYCARBONATE, CLEAR  
HEATSINK: ALUMINUM
- △ FINISH:  
SPRINGS: MINIMUM OF 0.8um TIN PLATE OVER A MINIMUM OF 0.8um NICKEL UNDERPLATE.  
NON-PLATED EDGES PERMISSIBLE.  
LIGHTPIPE/HEATSINK CLIP: PASSIVATE.  
HEATSINK: ELECTROLESS NICKEL
- 3. MATES WITH SFP MSA COMPLIANT TRANSCEIVERS.
- △ PADS AND VIAS CHASSIS GROUND.
- 5. INTERPRETATION OF DATUM REFERENCE FRAME IN ACCORDANCE WITH SECT 4.4.1.1 OF ASME Y14.5M-1994.
- △ MINIMUM PCB THICKNESS:  
SINGLE SIDED = 1.50mm  
DOUBLE SIDED = 2.25mm
- △ HOLE PATTERN REPEATS FOR EACH PORT. SPACING BETWEEN PORTS IS 14.25mm.
- △ DATUM AND BASIC DIMENSION ESTABLISHED BY CUSTOMER.
- △ REFERENCE APPLICATION SPEC. 114-13120, HOLE A, FOR RECOMMENDED DRILL HOLE DIAMETER AND PLATING THICKNESS.
- △ REFERENCE APPLICATION SPEC. 114-13120, HOLE B, FOR RECOMMENDED DRILL HOLE DIAMETER AND PLATING THICKNESS.
- 11. CERTAIN MATING TRANSCEIVERS MAY REQUIRE ADDITIONAL PCB THICKNESS THAT WOULD BE DETERMINED BY THE CUSTOMER.
- 12. PRODUCT COMPLIES WITH SPECIFICATION SFF-8433 IMPROVED PLUGGABLE FORM FACTOR FOR SFP+ GANGED CAGES.
- △ DIMENSION APPLIES PRIOR TO INSERTION OF SFP MODULE.
- △ PACKAGED AS A COMPLETE ASSEMBLY.

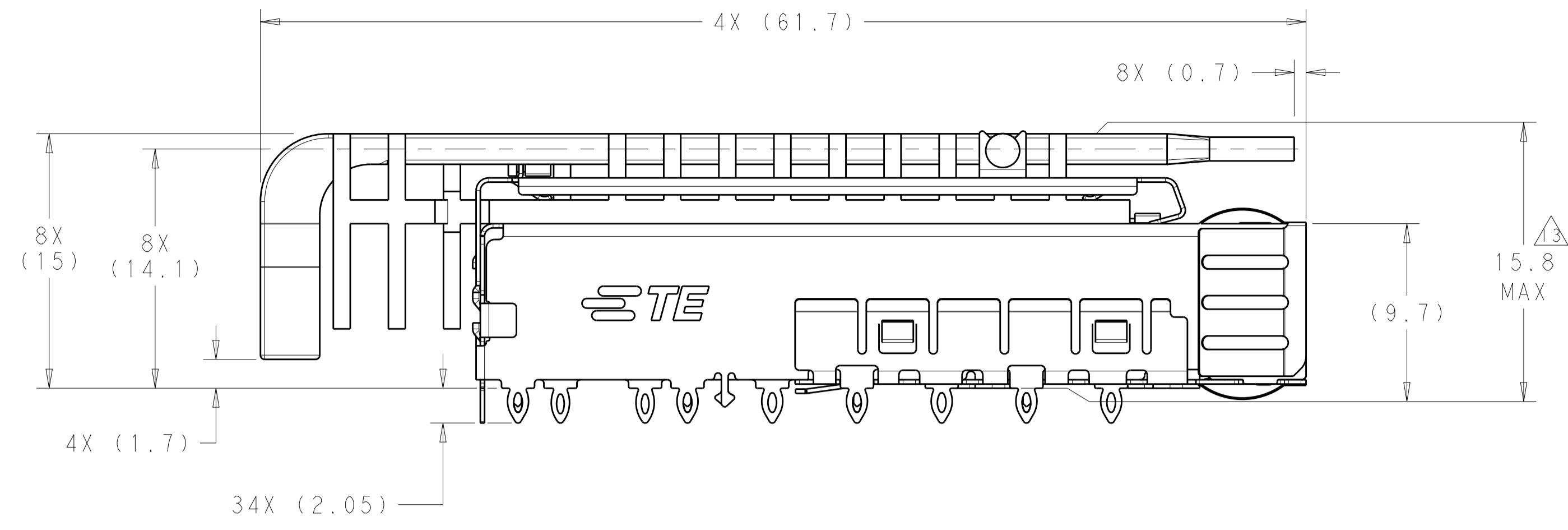
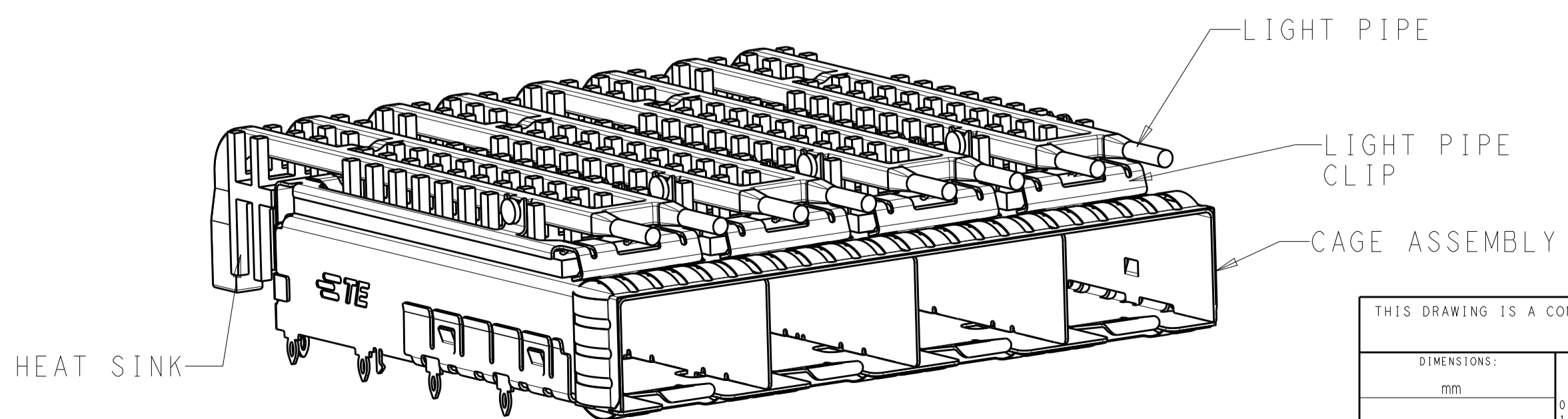
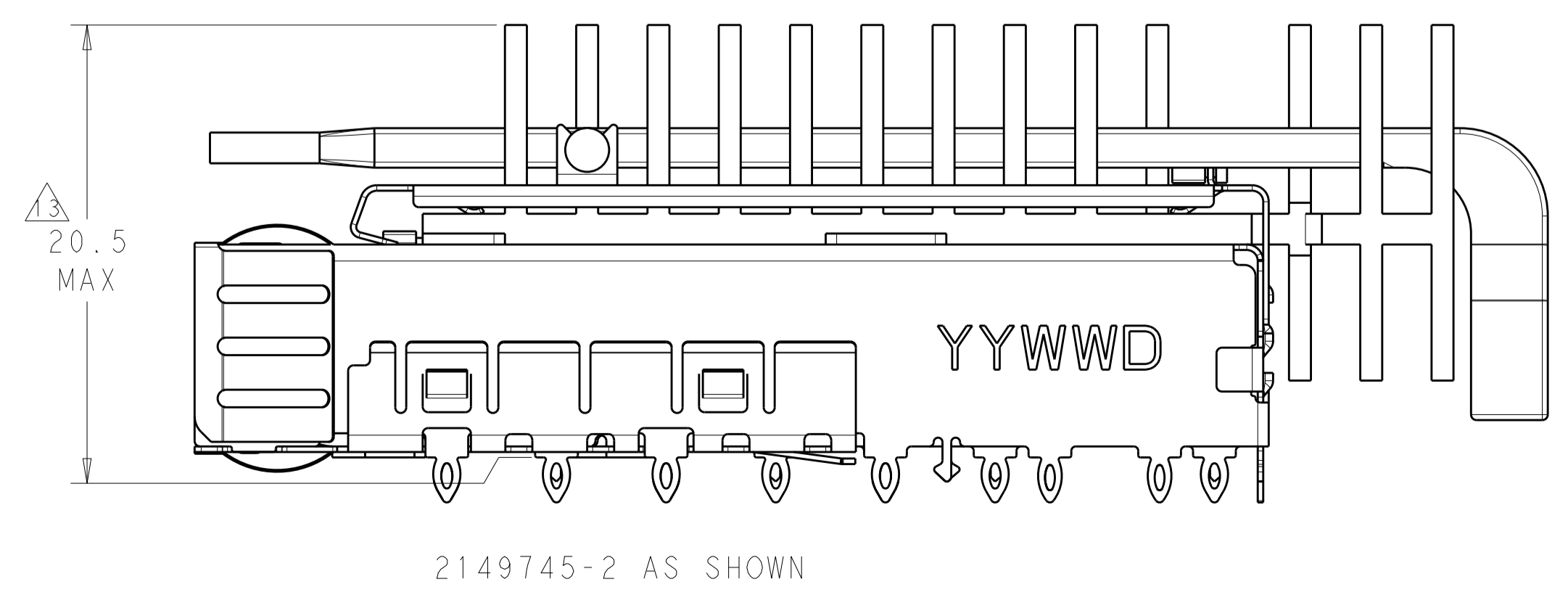
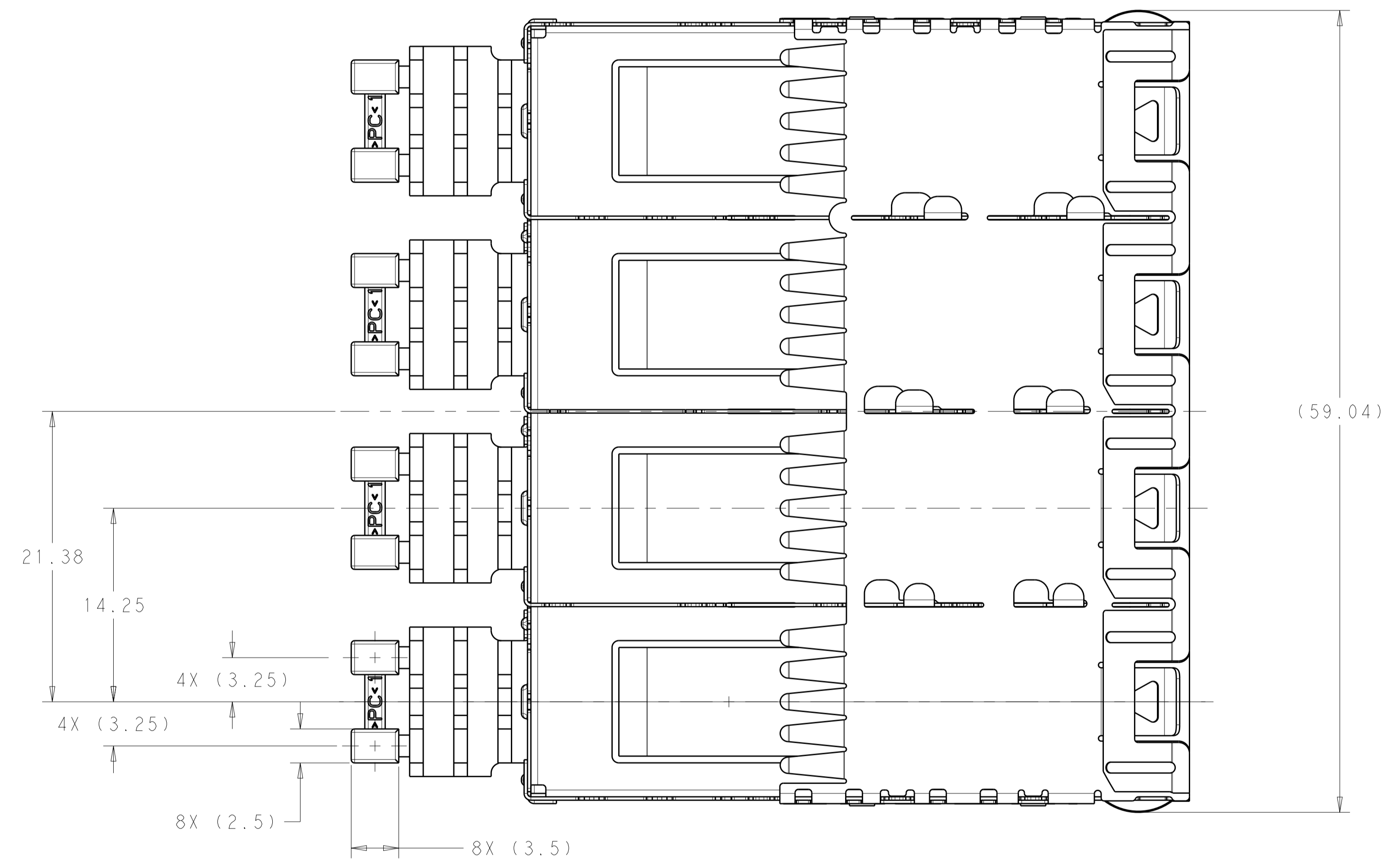

2149745-2 AS SHOWN

2149745-1  
FINISHED ASSEMBLY  
SCALE 5:2

△	2149745-2
△	2149745-1
PART NUMBER	

THIS DRAWING IS A CONTROLLED DOCUMENT.		DWN: B. MATTHEWS 17AUG2010	TE Connectivity
DIMENSIONS: mm		CHK: M. SCHMITT 17AUG2010	
TOLERANCES UNLESS OTHERWISE SPECIFIED:		APVD: M. SCHMITT 17AUG2010	NAME: SFP+ ENHANCED 1X4 CAGE ASSEMBLY PRESS FIT, EXTERNAL EMI SPRINGS
0 PLC ±0.1		PRODUCT SPEC: 108-2364	
1 PLC ±0.1		APPLICATION SPEC: 114-13120	SIZE: A1
2 PLC ±0.1		WEIGHT: -	CAGE CODE: 00779
3 PLC ±0.1		RESTRICTED TO: -	DRAWING NO: 2149745
4 PLC ±0.1		SCALE: 4:1	SHEET 1 OF 4
ANGLES ±0.1		REV: A	
FINISH: -			
MATERIAL: -			

LOC		DIST		REVISIONS			
GP	00	P	LTN	DESCRIPTION	DATE	DMN	APVD
		-		SEE SHEET 1			

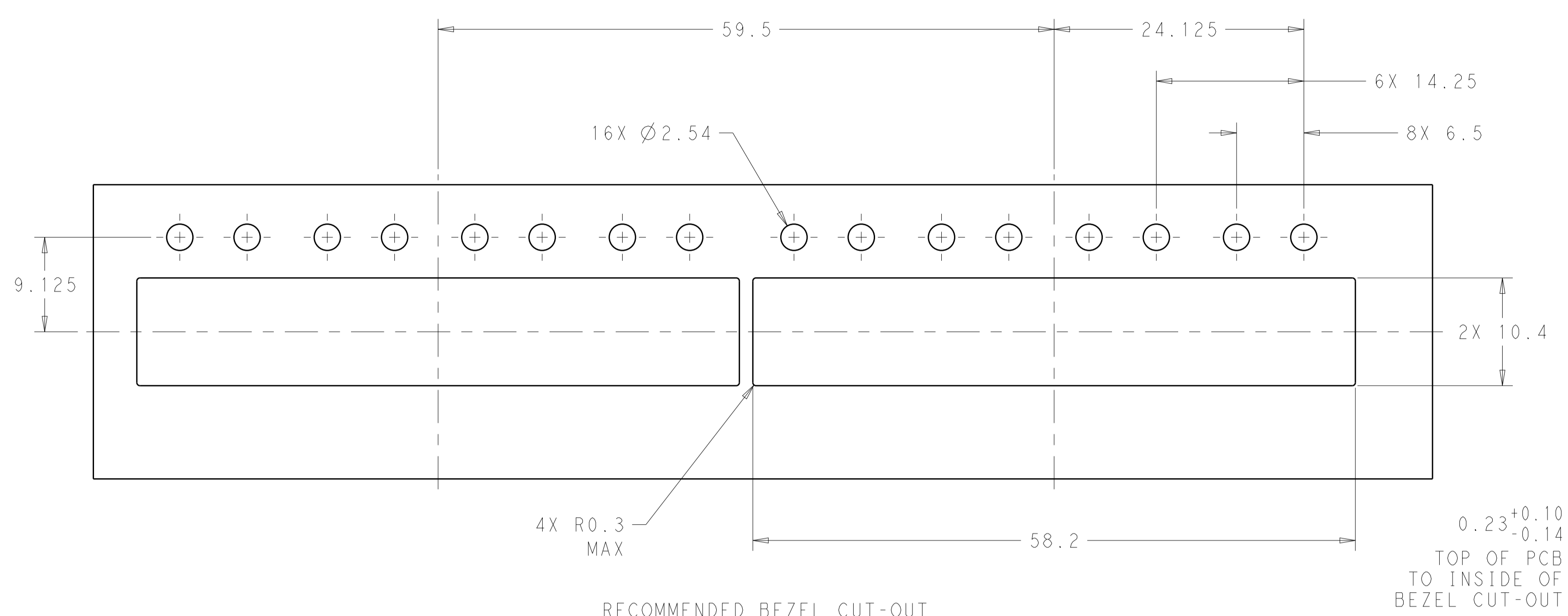

RECOMMENDED BEZEL CUT-OUT  
SINGLE SIDED APPLICATIONS  
SCALE 3:1

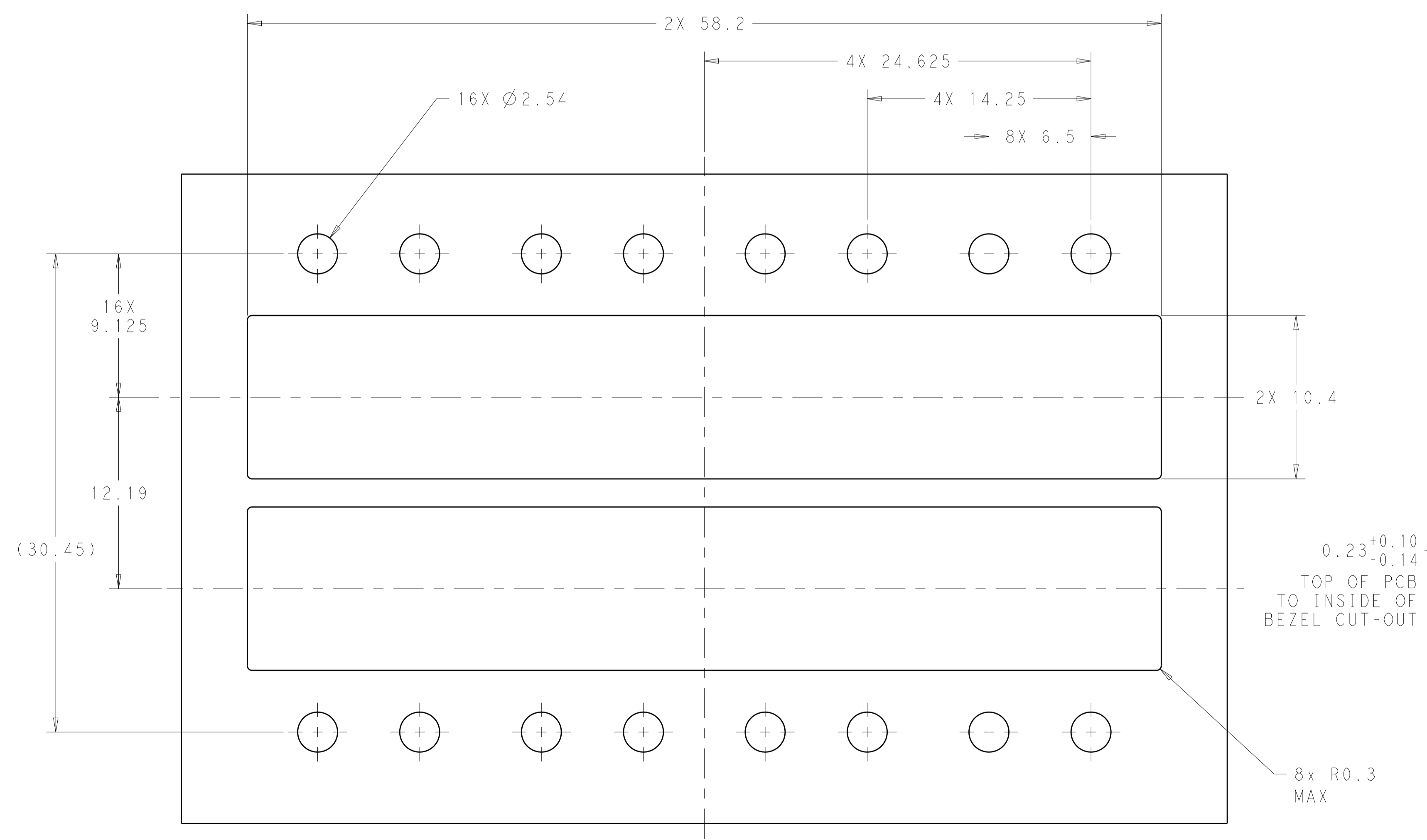

RECOMMENDED BEZEL CUT-OUT  
BELLY TO BELLY APPLICATIONS

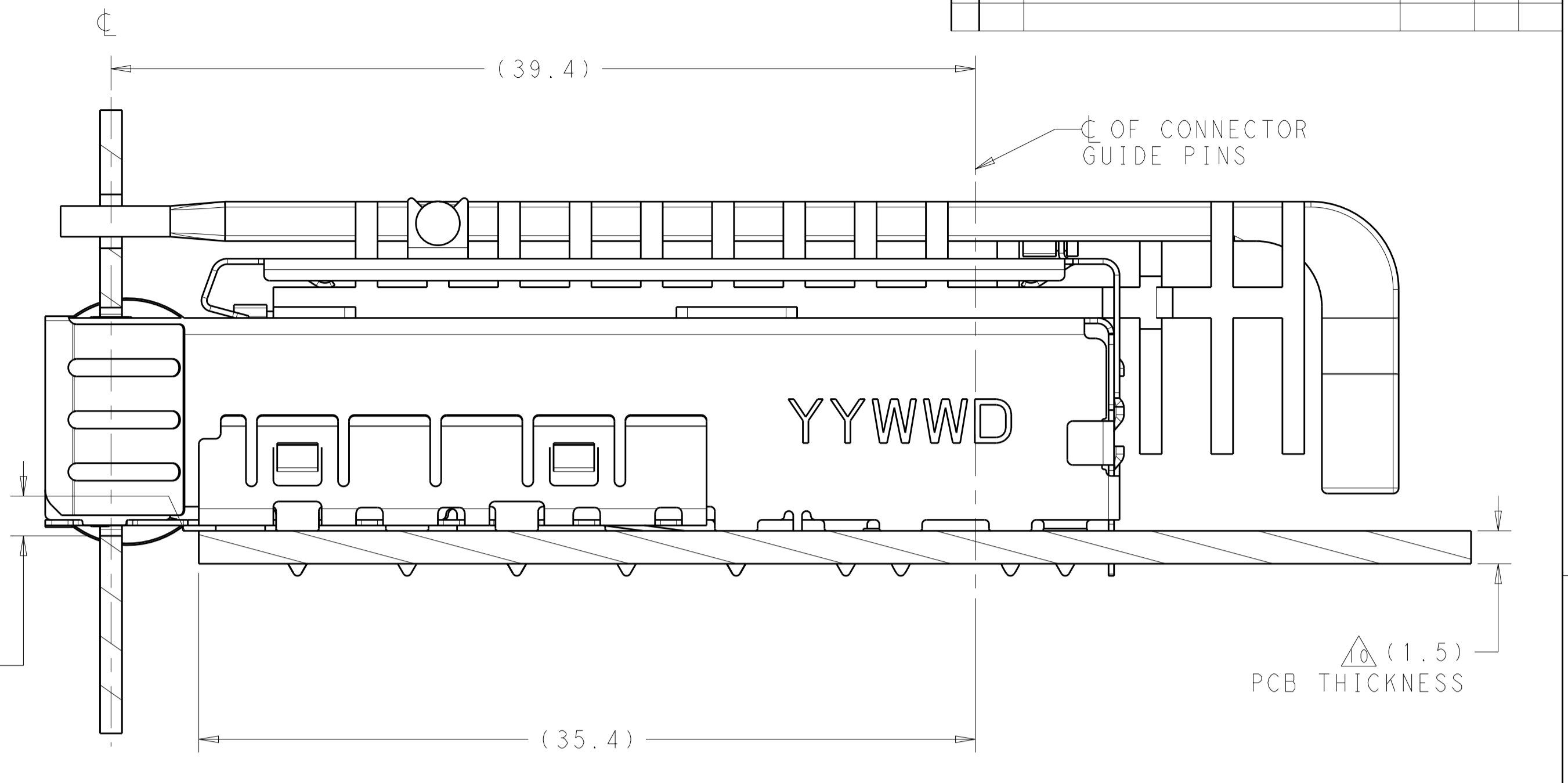

2149745-1  
MOUNTED ON PC BOARD  
SHOWN THRU RECOMMENDED BEZEL

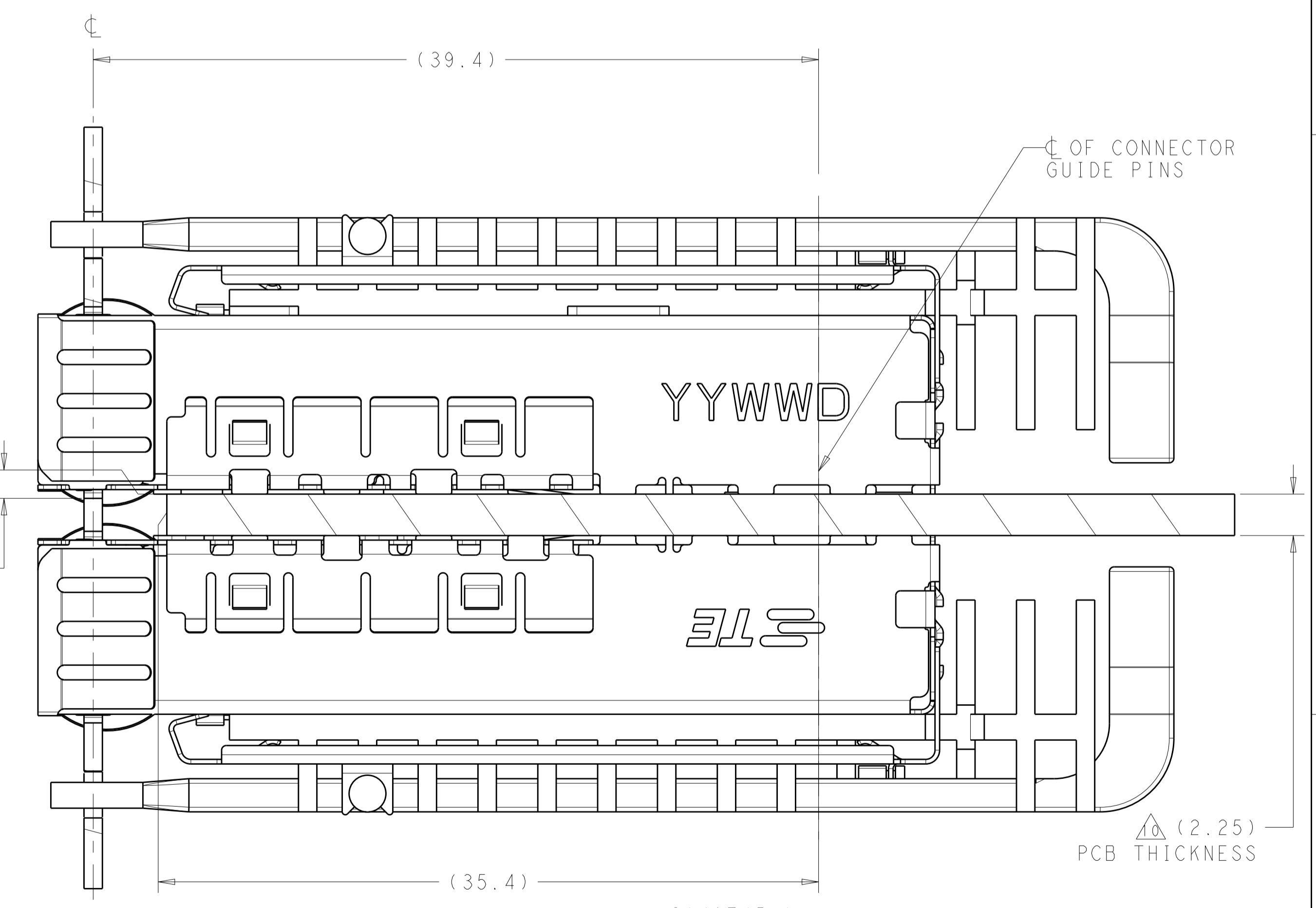

2149745-1  
MOUNTED BELLY TO BELLY ON PC BOARD  
SHOWN THRU RECOMMENDED BEZEL

THIS DRAWING IS A CONTROLLED DOCUMENT.		DMN: B. MATTHEWS 17AUG2010	 TE Connectivity
DIMENSIONS: mm		CHK: M. SCHMITT 17AUG2010	
TOLERANCES UNLESS OTHERWISE SPECIFIED:		APVD: M. SCHMITT 17AUG2010	NAME: SFP+ ENHANCED 1X4 CAGE ASSEMBLY PRODUCT SPEC: 108-2364 APPLICATION SPEC: 114-13120
0 PLC ±0.1 2 PLC ±0.1 3 PLC ±0.1 4 PLC ±0.1 ANGLES ±0.1 FINISH: #1*		SIZE: CAGE CODE DRAWING NO WEIGHT: A100779C=2149745 Customer Drawing	
MATERIAL:		RESTRICTED TO: -	SCALE: 4:1 SHEET 2 OF 4 REV A

LOC	DIST	REV	DATE	APPD	REV	DATE	APPD
GP	00						

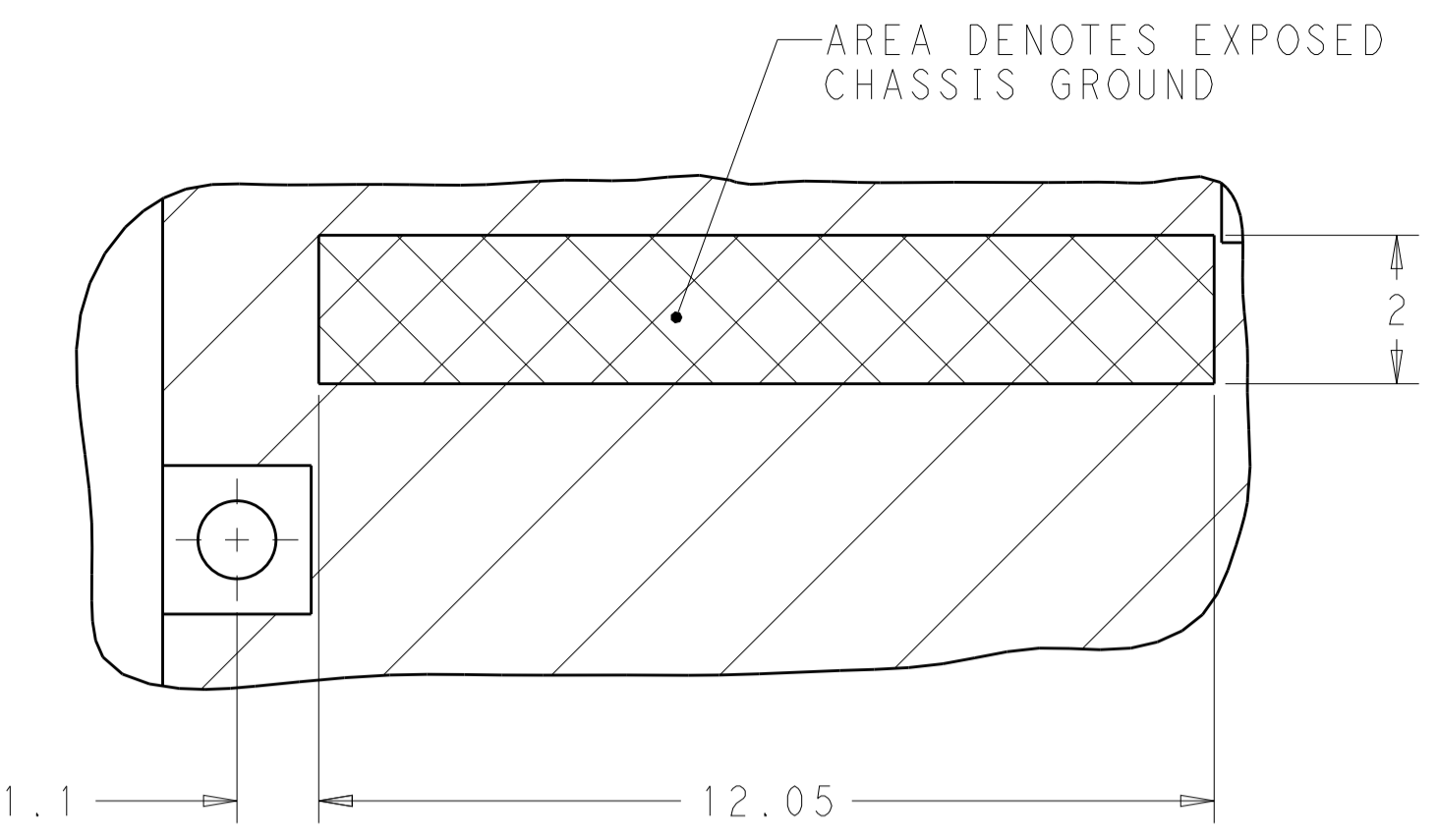

DETAIL A  
4X INDIVIDUALLY  
SCALE 10:1

8X  $\phi$  FOR LED PLACEMENT AND LIGHT PIPE COVERAGE AREA

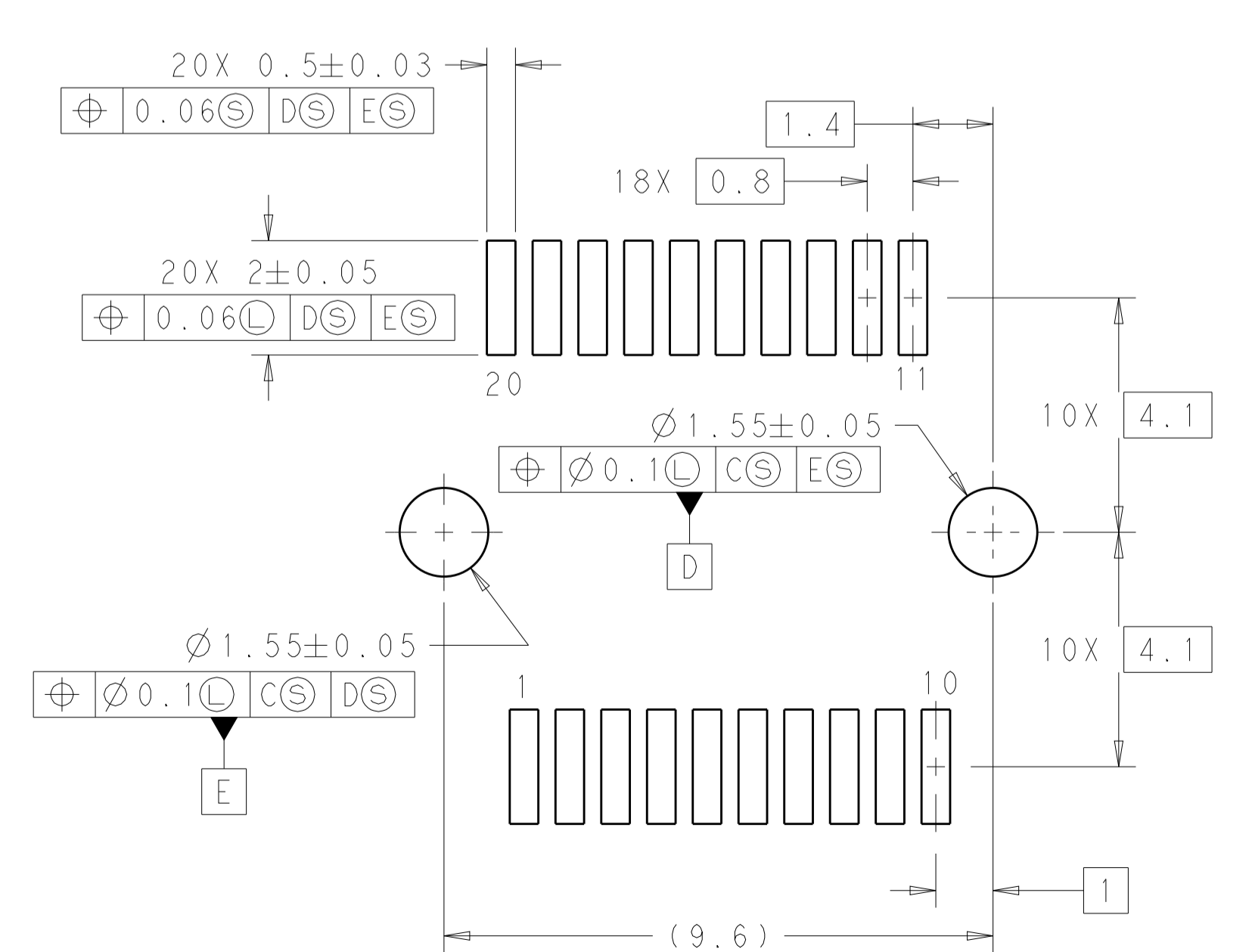
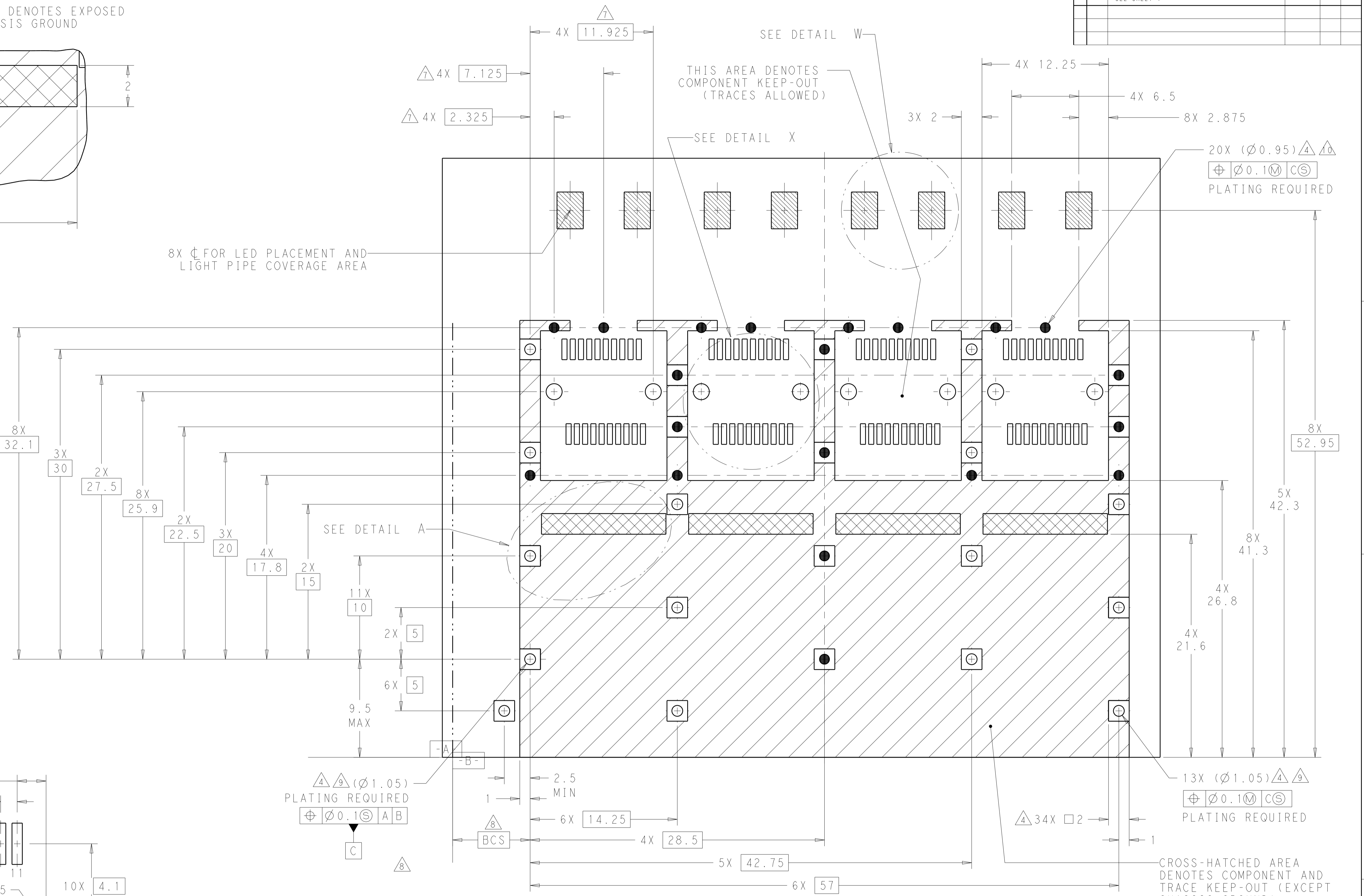

DETAIL X  
RECOMMENDED PT CONNECTOR LAYOUT  
4X INDIVIDUALLY  
SCALE 10:1

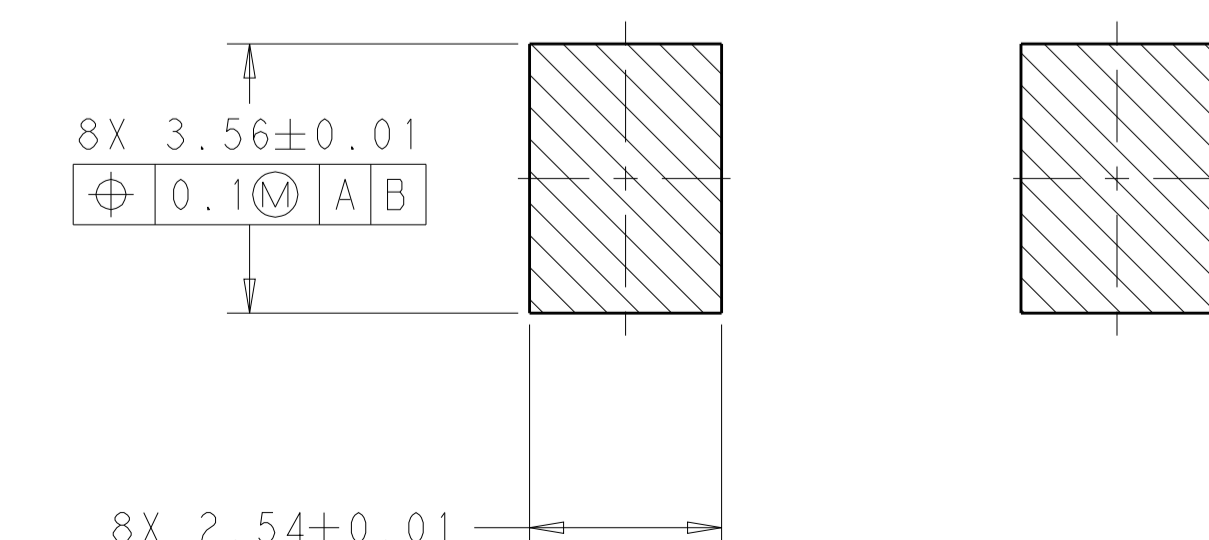

DETAIL W  
SCALE 10:1

THIS DRAWING IS A CONTROLLED DOCUMENT.		OWN: B. MATTHEWS 17AUG2010	TE Connectivity
DIMENSIONS: mm		CHK: M. SCHMITT 17AUG2010	
TOLERANCES UNLESS OTHERWISE SPECIFIED:		APVD: M. SCHMITT 17AUG2010	NAME: SFP+ ENHANCED 1X4 CAGE ASSEMBLY PRESS FIT, EXTERNAL EMI SPRINGS
0 PLC +/-0.1		PRODUCT SPEC: 108-2364	
1 PLC +/-0.1		APPLICATION SPEC: 114-13120	SIZE: CAGE CODE DRAWING NO: A100779C=2149745
2 PLC +/-0.1		WEIGHT: -	
3 PLC +/-0.1		Customer Drawing	RESTRICTED TO: -
4 PLC +/-0.1		SCALE: 4:1	SHEET: 3 OF 4
ANGLES +/-0.1		REV: A	

