

PRODUCT NO
10046971-043LF

REV.	ECN	REV'D BY	DATE
A	---	JW	2013-11-27

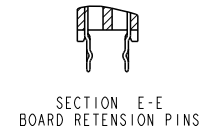
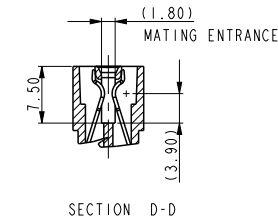
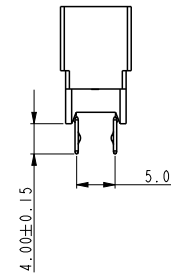
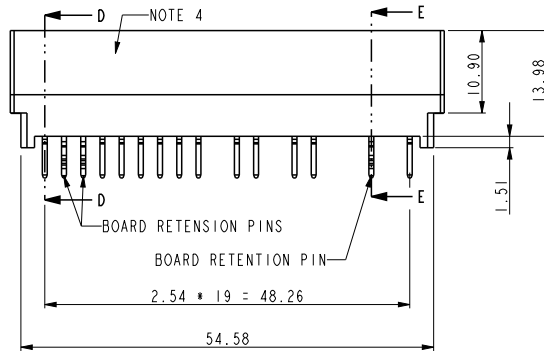
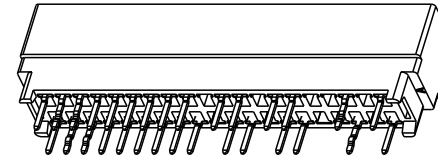
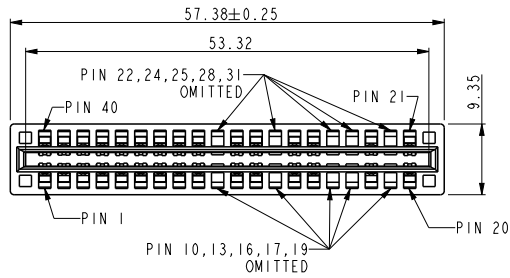

- NOTE:
- MATERIAL:
HOUSING: HIGH TEMPERATURE THERMOPLASTIC,
UL 94 V-0 FLAME RETARDANT.
TERMINAL: HIGH CONDUCTIVITY COPPER ALLOY.
PLATING SPEC AS BELOW:
Ni 50u" UNDER PLATED.
Au 30u" OVER CONTACT AREA. (ONE SIDE)
MATTE PURE TIN 120u" OVER SOLDERING AREA.
 - PACKING SPEC. GS-14-937
 - PRODUCT SPEC. GS-12-338.
 - MANUFACTURER'S NAME, P/N AND DATE CODE TO APPEAR ON THIS SURFACE AS PER GS-24-007.

- PART NUMBER 10046971-043LF MEETS EUROPEAN UNION DIRECTIVE AND OTHER COUNTRY REGULATIONS AS DESCRIBED IN GS-22-008.
- THE HOUSING WILL WITHSTAND EXPOSURE TO 260°C PEAK TEMPERATURE FOR 10 SECONDS IN A WAVE SOLDER APPLICATION WITH A CIRCUIT BOARD.
- THE PINS 10, 13, 16, 17, 19, 22, 24, 25, 28, 31 ARE OMITTED.

spec ref	*	dr	Julia Wang	2013/11/25	projection	MM	size	A4	scale	1.000
tolerance std	TOLERANCES UNLESS OTHERWISE SPECIFIED	eng	Julia Wang	2013/12/06			ecn no	-	rel level	Released
ISO 406 ISO 1101		chr	-	-						
surface	linear	appr	Pei-Ming Zheng	2013/12/06	product family	Power Edge Card	rev		10046971-043	A
ISO 1302	angular	www.fci.com		cat. no.	*	Product - Customer Drw	sheet 1 of 2			
	0.X ±0.50	FCI		title	VERTICAL TYPE		dwg no			
	0.XX ±0.25				2X20P(10P OMITTED)					
	0.XXX ±0.13									
	0° ±2°									

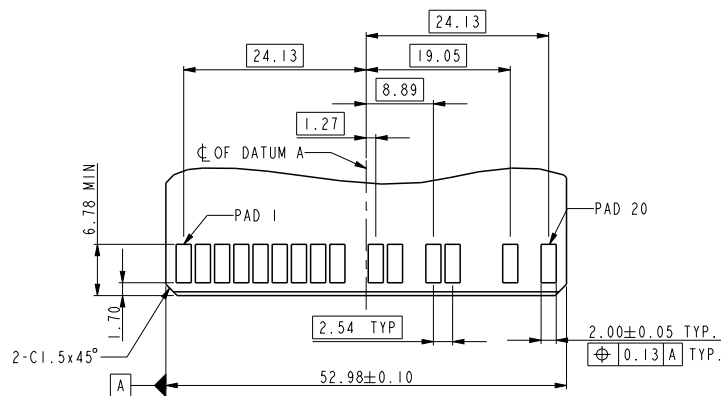

RECOMMENDED MATING BOARD

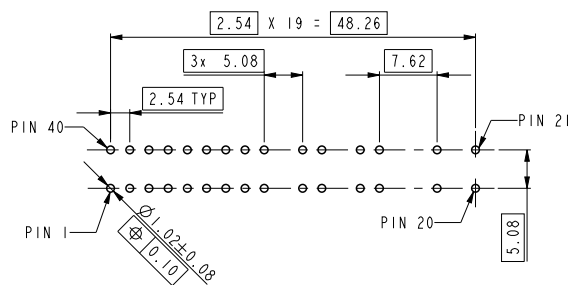
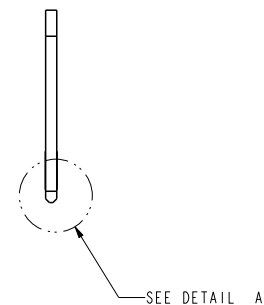

RECOMMENDED PC BOARD LAYOUT
AND THE THICKNESS IS 3.18mm

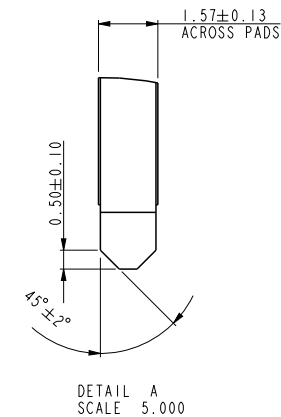

DETAIL A
SCALE 5.000

dr	Julia Wang	2013/11/25	projection 	MM ←→	size	A4	scale	1.000	
eng	Julia Wang	2013/12/06			ecn no	-			
chr	-	-			rel level	Released			
appr	Pei-Ming Zheng	2013/12/06	product family	Power Edge Card					
		title	VERTICAL TYPE 2X20P(10P OMITTED)		dwg no	10046971-043		rev	A
www.fci.com		cat. no.	*	Product - Customer Drw			sheet 2 of 2		