

HC-STA-A03PT-BWS-HS-M20-PLRBK - Connector set



1424447

<https://www.phoenixcontact.com/us/products/1424447>

Please be informed that the data shown in this PDF document is generated from our online catalog. Please find the complete data in the user documentation. Our general terms of use for downloads are valid.



Connector set, number of positions: 3, material: PA, connection method: Push-in connection, connection cross section: AWG 26- 16

Commercial data

| | |
|--------------------------------------|---------------|
| Item number | 1424447 |
| Packing unit | 1 pc |
| Minimum order quantity | 1 pc |
| Sales key | BF63 |
| Product key | BF7AFX |
| GTIN | 4055626372761 |
| Weight per piece (including packing) | 91.8 g |
| Weight per piece (excluding packing) | 22.22 g |
| Customs tariff number | 85366990 |
| Country of origin | CN |

HC-STA-A03PT-BWS-HS-M20-PLRBK - Connector set



1424447

<https://www.phoenixcontact.com/us/products/1424447>

Set consists of

HC-A03-I-PT-M - Contact insert

1585252

<https://www.phoenixcontact.com/us/products/1585252>



Contact insert, number of positions: 3+PE, size: D7, number of connections per position: 1, Pin, Push-in connection, 230 V/400 V, 10 A, 0.14 mm² ... 1.5 mm²

HC-A03-I-PT-F - Contact insert

1585265

<https://www.phoenixcontact.com/us/products/1585265>



Contact insert, number of positions: 3+PE, size: D7, number of connections per position: 1, Socket, Push-in connection, 230 V/400 V, 10 A, 0.14 mm² ... 1.5 mm²

HC-STA-A03PT-BWS-HS-M20-PLRBK - Connector set



1424447

<https://www.phoenixcontact.com/us/products/1424447>

HC-STA-D07-BWS-PL-BK - Housing

1419265

<https://www.phoenixcontact.com/us/products/1419265>



Panel mounting base D7, with single locking latch, material: PA, height: 25.5 mm, cable gland: none, Standard

HC-STA-D07-HHFS-1SGM20-PL-BK - Housing

1419257

<https://www.phoenixcontact.com/us/products/1419257>



Sleeve housing D7, for single locking latch, material: PA, cable outlets: 1, lateral, M20, height: 54.5 mm, cable gland: with, Standard

1424447

<https://www.phoenixcontact.com/us/products/1424447>

Technical data

Product properties

| | |
|----------------------|------------------|
| Type | D7 |
| Product type | Connector set |
| Number of positions | 3 |
| Application | Standard |
| No. of cable outlets | 1 |
| Housing type | Complete housing |
| Protective cover | no |

Insulation characteristics

| | |
|----------------------|-----|
| Overvoltage category | III |
| Degree of pollution | 3 |

Electrical properties

| | |
|----------------------------------|-----------------------------|
| Rated voltage (III/3) | 230 V (Conductor-PE) |
| | 400 V (Conductor-Conductor) |
| Rated voltage for power contacts | 230/400 V |
| Rated surge voltage | 4 kV |
| Rated current | 10 A |

Connection data

| | |
|---|---|
| Connection method | Push-in connection |
| Connection technology | Push-in connection |
| Conductor cross section | 0.14 mm ² ... 1.5 mm ² (with ferrule) |
| | 0.14 mm ² ... 1.5 mm ² (with ferrule) |
| Connection cross section AWG | 26 ... 16 (with ferrule) |
| Stripping length of the individual wire | 10 mm |

Dimensions

Installation dimensions

| | |
|-------------------------------|-------|
| Width of the assembly cutout | 21 mm |
| Length of the assembly cutout | 21 mm |

Material specifications

| | |
|--|-----------------|
| Flammability rating according to UL 94 | V0 |
| Seal material | NBR, conductive |
| Contact material | Copper alloy |
| Contact surface material | Ag |
| Contact carrier material | PC |
| Locking latch material | PA |
| Impact strength | IK06 |
| Housing material | PA |

1424447

<https://www.phoenixcontact.com/us/products/1424447>

Cable/line

| | |
|---|----------------|
| External cable diameter () | 4 mm ... 10 mm |
| Stripping length of the individual wire | 10 mm |

Environmental and real-life conditions

Ambient conditions

| | |
|---------------------------------|-------------------|
| Degree of protection | IP66 |
| Degree of protection (NEMA) | 12 (UL 50e) |
| Impact strength | IK06 |
| Ambient temperature (operation) | -40 °C ... 125 °C |

Mounting

| | |
|-------------------|--------------------|
| Connection method | Push-in connection |
|-------------------|--------------------|

Drawings

Diagram

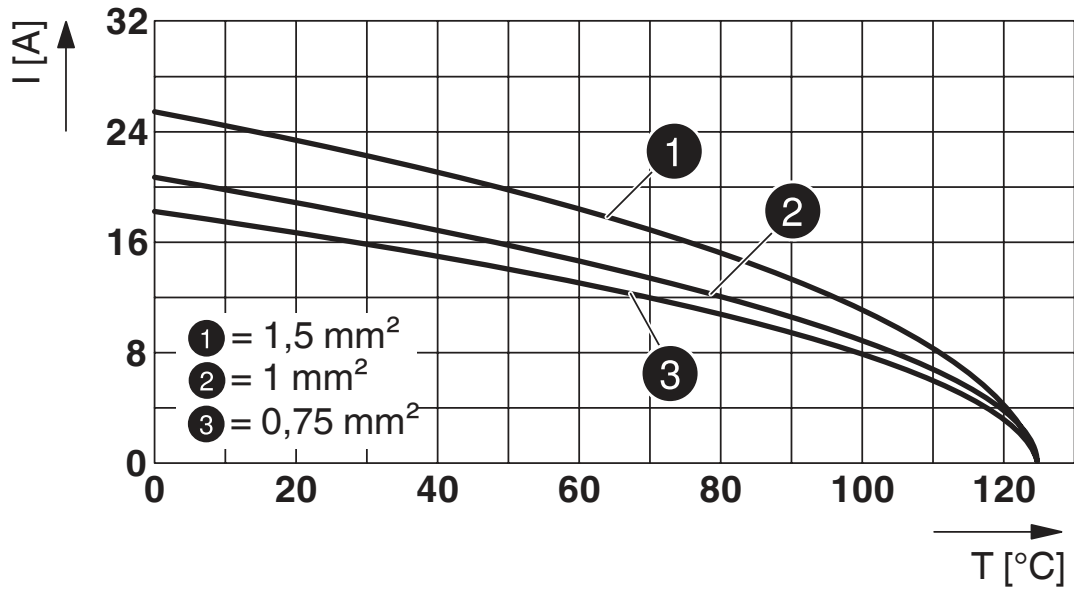

Derating diagram

1424447

<https://www.phoenixcontact.com/us/products/1424447>

Dimensional drawing

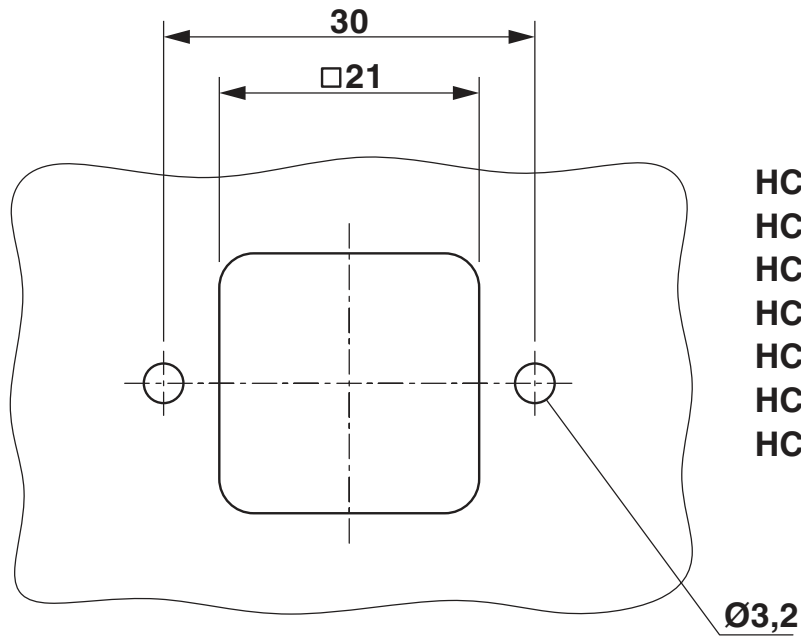

- HC-A03
- HC-A04
- HC-D07
- HC-D08
- HC-Q05
- HC-Q07
- HC-Q12

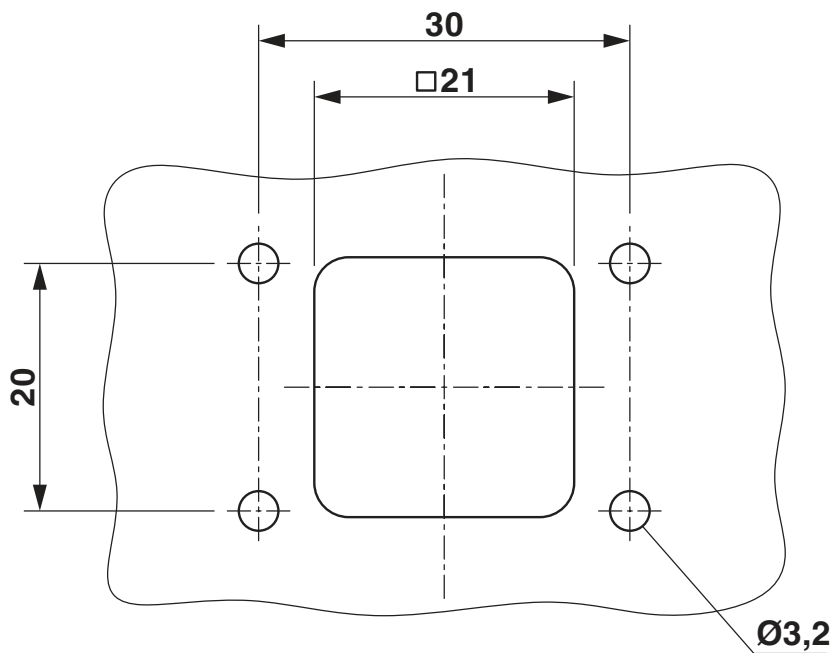

- HC-Q02
- HC-Q03
- HC-Q04

Mounting cutout

1424447

<https://www.phoenixcontact.com/us/products/1424447>

Schematic diagram

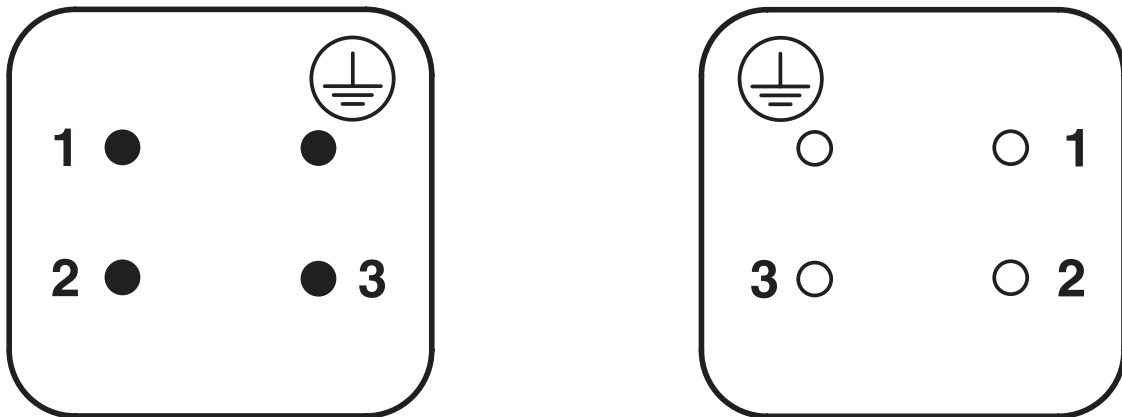

Pin assignment, connection side, pin left, socket right

1424447

<https://www.phoenixcontact.com/us/products/1424447>

Approvals

🔗 To download certificates, visit the product detail page: <https://www.phoenixcontact.com/us/products/1424447>

DNV

Approval ID: TAE000037S

ENEC

EAC

Approval ID: RU C-DE.BL08.B.00511

1424447

<https://www.phoenixcontact.com/us/products/1424447>

Classifications

ECLASS

| | |
|-------------|----------|
| ECLASS-11.0 | 27440101 |
| ECLASS-12.0 | 27440113 |
| ECLASS-13.0 | 27440113 |

ETIM

| | |
|----------|----------|
| ETIM 8.0 | EC002636 |
|----------|----------|

UNSPSC

| | |
|-------------|----------|
| UNSPSC 21.0 | 39121400 |
|-------------|----------|

1424447

<https://www.phoenixcontact.com/us/products/1424447>

Environmental product compliance

| | |
|------------|---|
| China RoHS | Environmentally friendly use period: unlimited = EFUP-e No hazardous substances above threshold values |
|------------|---|

Phoenix Contact 2023 © - all rights reserved
<https://www.phoenixcontact.com>

Phoenix Contact USA
586 Fulling Mill Road
Middletown, PA 17057, United States
(+717) 944-1300
info@phoenixcon.com