

Electrical diagram printed in white

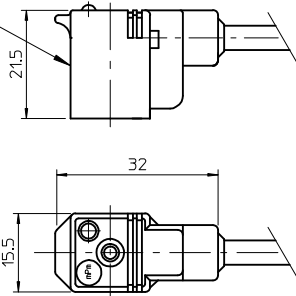

PN's List

Engineering number	SAP Part Number	Cable Length [mm]	Cable type
H85AB0P82M006	1210360626	600	IRR PUR Orange 0.34mm ²
H85AB0P12M010	1210360927	1000	PUR Black 0.5mm ²

Table of length tolerances

Over	Up to and including	Tolerance (+)
0	305	+19
305	915	+45
915	1830	+56
1830	3660	+89
3660	7320	+165
7320	14640	+317
14640	30500	+610
30500	>	+2% of length

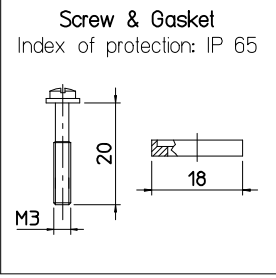

PART No MATRIX - PN KEY

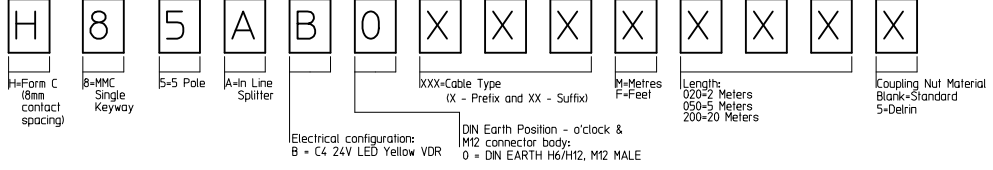

Notes:
1. Dimensions without tolerance are referential.

ORIGINAL RELEASE EC NO: IPG2014-1345 DRWN: JMARSZALEK 2014/01/29 CHKD: MSZWAJKOWSKI 2014/01/29 APPR: MIWASIECZKO 2014/01/30	QUALITY SYMBOLS	GENERAL TOLERANCES (UNLESS SPECIFIED)	DIMENSION STYLE	SCALE	DESIGN UNITS	THIRD ANGLE PROJECTION	
	DESCRIPTION	mm INCH	MM ONLY	-	METRIC		
	REV	4 PLACES ± --- ± --- 3 PLACES ± --- ± --- 2 PLACES ± --- ± --- 1 PLACE ± --- ± --- 0 PLACE ± --- ± ---	DRAWN BY DATE JMARSZALEK 2014/01/29	CHECKED BY DATE MSZWAJKOWSKI 2014/01/29	APPROVED BY DATE MIWASIECZKO 2014/01/30	TITLE H85AB0XXXXXXXXX ILS - 2XDIN-C H6/H12 C4H M12 5P AC MA	
		ANGULAR ± --- ° DRAFT WHERE APPLICABLE MUST REMAIN WITHIN DIMENSIONS	MATERIAL NO. SEE PN KEY	DOCUMENT NO. SD-121036-015	SHEET NO. 1 OF 1		

THIS DRAWING CONTAINS INFORMATION THAT IS PROPRIETARY TO MOLEX INCORPORATED AND SHOULD NOT BE USED WITHOUT WRITTEN PERMISSION