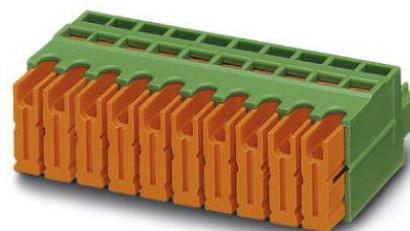

## QC 0,5/12-ST-3,81

Order No.: 1897490

The figure shows a 10-position version of the product

<http://eshop.phoenixcontact.de/phoenix/treeViewClick.do?UID=1897490>

Plug component, Nominal current: 6 A, Nom. voltage: 320 V, Pitch:  
3.81 mm, Number of positions: 12, Connection type: Insulation  
displacement connection QUICKON, Color: green

| Commercial data          |                    |
|--------------------------|--------------------|
| EAN                      | 4017918164997      |
| Pack                     | 50 pcs.            |
| Customs tariff           | 85366990           |
| Weight/Piece             | 0.01054 KG         |
| Catalog page information | Page 156 (CC-2009) |

**Product notes**WEEE/RoHS-compliant since:  
01/01/2003

<http://www.download.phoenixcontact.com>  
Please note that the data given here has been taken from the online catalog. For comprehensive information and data, please refer to the user documentation. The General Terms and Conditions of Use apply to Internet downloads.

| Technical data                |          |
|-------------------------------|----------|
| <b>Dimensions / positions</b> |          |
| Pitch                         | 3.81 mm  |
| Dimension a                   | 41.91 mm |
| Number of positions           | 12       |

**Technical data**

|                                    |  |
|------------------------------------|--|
| Insulating material group          | I  |
| Rated surge voltage (III/3)        | 4 kV   |
| Rated surge voltage (III/2)        | 4 kV   |
| Rated surge voltage (II/2)         | 4 kV   |
| Rated voltage (III/2)              | 320 V  |
| Rated voltage (II/2)               | 630 V  |
| Connection in acc. with standard   | EN-VDE   |
| Nominal current $I_N$              | 6 A  |
| Nominal voltage $U_N$              | 320 V  |
| Nominal cross section              | 0.5 mm <sup>2</sup>                                    |
| Maximum load current               | 6 A (with 0.5 mm <sup>2</sup> conductor cross section) |
| Insulating material                | PA   |
| Inflammability class acc. to UL 94 | V0   |

**Connection data**

|  |                      |
|--|----------------------|
| Conductor cross section stranded min.  | 0.34 mm <sup>2</sup> |
| Conductor cross section stranded max.  | 0.5 mm <sup>2</sup>  |
| Conductor cross section AWG/kcmil min. | 22                   |
| Conductor cross section AWG/kcmil max  | 20                   |

**Certificates / Approvals**



Certification CB, CUL, GOST, UL, VDE-PZI

**CUL**

|                       |       |
|-----------------------|-------|
| Nominal voltage $U_N$ | 300 V |
| Nominal current $I_N$ | 6 A   |
| AWG/kcmil             | 24-20 |

**UL**

|                       |       |
|-----------------------|-------|
| Nominal voltage $U_N$ | 300 V |
| Nominal current $I_N$ | 6 A   |
| AWG/kcmil             | 24-20 |

**Accessories**

| Item           | Designation              | Description  |
|----------------|--------------------------|--|
| <b>Marking</b> |                          |  |
| 0804109        | SK 3,81/2,8:FORTL.ZAHLEN | Marker card, printed horizontally, self-adhesive, 10-section marker strip, 14 identical decades marked 1-10, 11-20 etc. up to 91-(99)100, sufficient for 140 terminal blocks |
| <b>Tools</b>   |                          |  |
| 1205202        | SZS 0,4X2,0              | Screwdriver, bladed, matches all screw terminal blocks up to 1.5 mm <sup>2</sup> connection cross section, blade width: 2.5 mm, without approvals                            |

**Additional products**

| Item           | Designation          | Description   |
|----------------|----------------------|---|
| <b>General</b> |                      |   |
| 1897908        | EMC 1,5/12-G-3,81    | Header, Nominal current: 8 A, Nom. voltage: 160 V, Pitch: 3.81 mm, Number of positions: 12, Color: green, Assembly: Press-in                        |
| 1860744        | EMCV 1,5/12-G-3,81   | Header, Nominal current: 8 A, Nom. voltage: 160 V, Pitch: 3.81 mm, Number of positions: 12, Color: green, Assembly: Press-in                        |
| 1857980        | IMC 1,5/12-ST-3,81   | Plug component, Nominal current: 8 A, Nom. voltage: 160 V, Pitch: 3.81 mm, Number of positions: 12, Connection type: Screw connection, Color: green |
| 1803374        | MC 1,5/12-G-3,81     | Header, Nominal current: 8 A, Nom. voltage: 160 V, Pitch: 3.81 mm, Number of positions: 12, Color: green, Assembly: Soldering                       |
| 1908868        | MC 1,5/12-G-3,81 THT | Header, Nominal current: 8 A, Nom. voltage: 160 V, Pitch: 3.81 mm, Number of positions: 12, Color: black, Assembly: SMD/THT/THR                     |
| 1830059        | MCD 1,5/12-G-3,81    | Header, Nominal current: 8 A, Nom. voltage: 160 V, Pitch: 3.81 mm, Number of positions: 12, Color: green, Assembly: Soldering                       |
| 1843172        | MCD 1,5/12-G1-3,81   | Header, Nominal current: 8 A, Nom. voltage: 160 V, Pitch: 3.81 mm, Number of positions: 12, Color: green, Assembly: Soldering                       |
| 1830509        | MCDV 1,5/12-G-3,81   | Header, Nominal current: 8 A, Nom. voltage: 160 V, Pitch: 3.81 mm, Number of positions: 12, Color: green, Assembly: Soldering                       |
| 1847835        | MCDV 1,5/12-G1-3,81  | Header, Nominal current: 8 A, Nom. voltage: 160 V, Pitch: 3.81 mm, Number of positions: 12, Color: green, Assembly: Soldering                       |
| 1803523        | MCV 1,5/12-G-3,81    | Header, Nominal current: 8 A, Nom. voltage: 160 V, Pitch: 3.81 mm, Number of positions: 12, Color: green, Assembly: Soldering                       |
| 1837531        | MCVDU 1,5/12-G-3,81  | Header, Nominal current: 8 A, Nom. voltage: 160 V, Pitch: 3.81 mm, Number of positions: 12, Color: green, Assembly: Soldering                       |

|         |                    |  |
|---------|--------------------|--|
| 1832837 | MCVK 1,5/12-G-3,81 | Plug component, Nominal current: 8 A, Nom. voltage: 160 V, Pitch: 3.81 mm, Number of positions: 12, Assembly: DIN rail, Color: green |
| 1827376 | SMC 1,5/12-G-3,81  | Header, Nominal current: 8 A, Nom. voltage: 160 V, Pitch: 3.81 mm, Number of positions: 12, Color: green, Assembly: Soldering        |

**Diagrams/Drawings**

Dimensioned drawing

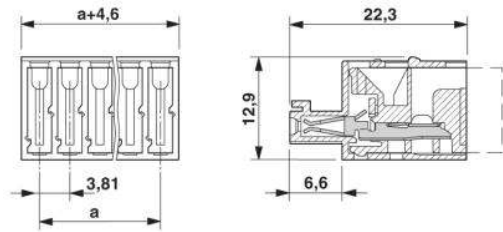

**Address**

PHOENIX CONTACT Inc., USA  
586 Fulling Mill Road  
Middletown, PA 17057, USA  
Phone (800) 888-7388  
Fax (717) 944-1625  
<http://www.phoenixcon.com>



© 2010 Phoenix Contact  
Technical modifications reserved;