

STRAIGHT SQUARE FLANGE PLUG SOLDER TYPE

R143.257.450

CABLE .085

Series : TNC

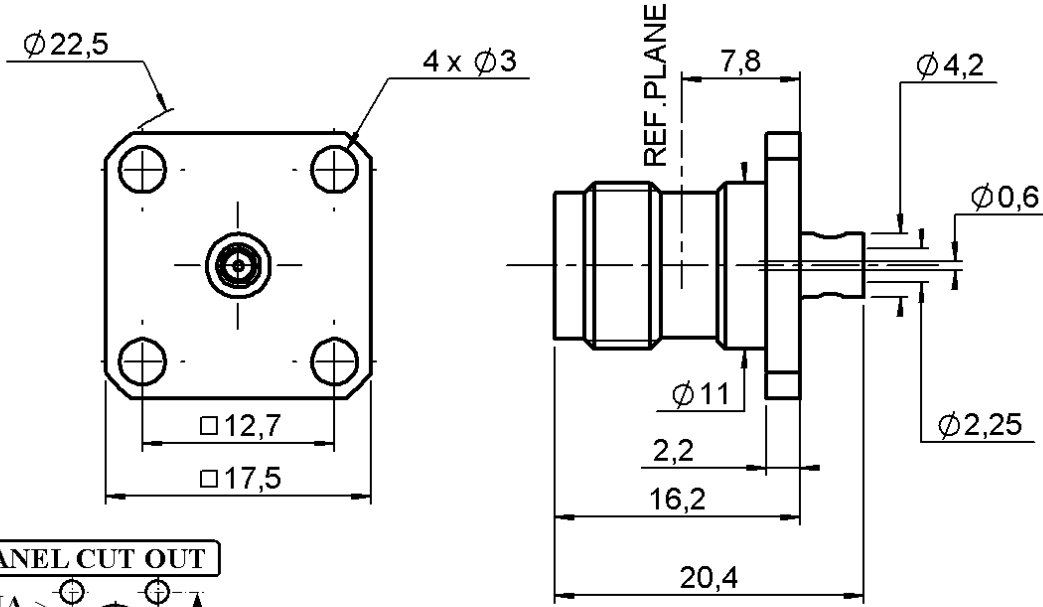

PANEL CUT OUT

A DIA
B DIA
4 holes
C

	mm	
	Maxi	mini
A	11.3	11.2
B	3.1	2.9
C	12.75	12.65

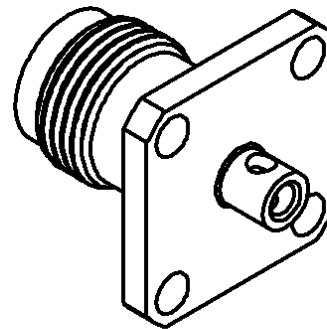
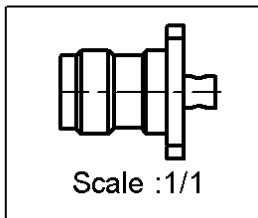

All dimensions are in mm.



COMPONENTS	MATERIALS	PLATINGS (µm)
BODY	BRASS	NICKEL 2
CENTER CONTACT	BERYLLIUM COPPER	GOLD 0.5 OVER NICKEL 2
OUTER CONTACT		
INSULATOR	PTFE	
GASKET		
OTHERS PARTS		
-	-	-
-	-	-

Issue : 0340 A

In the effort to improve our products, we reserve the right to make changes judged to be necessary.



STRAIGHT SQUARE FLANGE PLUG SOLDER TYPE

R143.257.450

CABLE .085

Series : TNC

PACKAGING

Standard	Unit	Other
100	'W' option	Contact us

SPECIFICATION

ELECTRICAL CHARACTERISTICS

Impedance		50	Ω
Frequency		0-6	GHz
VSWR	1.35 +	0.000	x F(GHz) Maxi
Insertion loss		0.2	\sqrt{F} (GHz) dB Maxi
RF leakage	- (57	- F(GHz)) dB Maxi
Voltage rating		335	Veff Maxi
Dielectric withstanding voltage		1000	Veff mini
Insulation resistance		5000	M Ω mini

CABLE ASSEMBLY

Stripping	a	b	c	d	e	f
mm	4.00	0.00	0.00	0.00	0.00	0.00

Assembly instruction :

Recommended cable(s)
KS 1
RG 405

Cable retention
- pull off **200** N mini
- torque **NA** N.cm

MECHANICAL CHARACTERISTICS

Center contact retention		
Axial force – Mating end	NA	N mini
Axial force – Opposite end	NA	N mini
Torque	NA	N.cm mini

TOOLING

Part Number	Description	Hexagon
.	.	.
R282.744.400		

Recommended torque		
Mating	NA	N.cm
Panel nut	NA	N.cm
Clamp nut	NA	N.cm
A/F clamp nut	0.000	mm

Mating life	500	Cycles mini
Weight	9.800	g

OTHERS CHARACTERISTICS

ENVIRONMENTAL

Operating temperature	-65/+105	$^{\circ}$ C
Hermetic seal	NA	Atm.cm3/s
Panel leakage	NA	

Issue : 0340 A

In the effort to improve our products, we reserve the right to make changes judged to be necessary.



STRAIGHT SQUARE FLANGE PLUG SOLDER TYPE

R143.257.450

CABLE .085

Series : TNC



We recommend a thermal preconditioning cable .

1

Strip the dielectric of the cable.
Clean the cable.



3

Screw the positioner onto the soldering jig.
Slide the cable assembly until it bottoms against positioner.
Tighten and solder the contact.

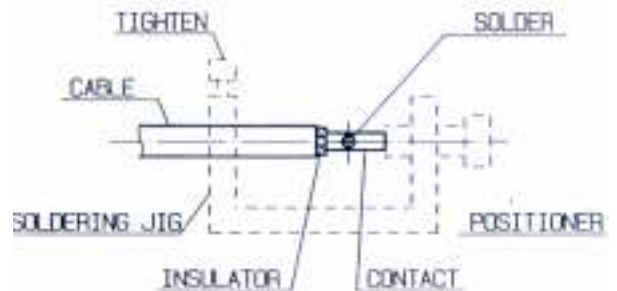

2

Slide the insulator and the center contact onto the cable inner conductor



4

After cooling remove cable assembly from the jig.
Slide positioner into the connector.
Get in connector assembly onto the soldering jig and slide the cable until it bottoms against positioner.
Tighten.
Put 3 rings of solder around the cable and solder.

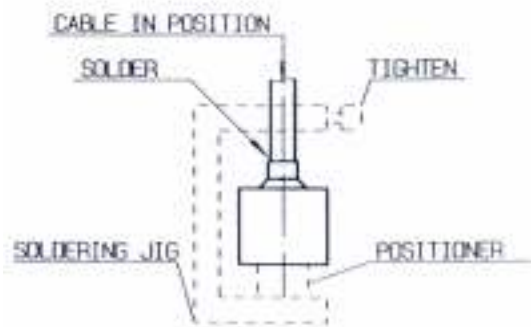

Issue : 0340 A

In the effort to improve our products, we reserve the right to make changes judged to be necessary.

