

EISA/ISA or PCI

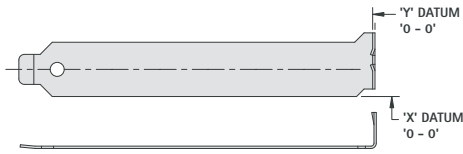

- CAT. NO. 9200**
- CAT. NO. 9201** (Ribbed)
- CAT. NO. 9230**

EISA/ISA with TABS

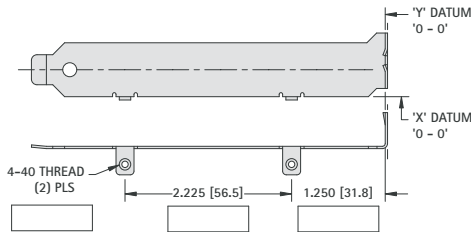

- CAT. NO. 9202**

EISA/ISA with TABS

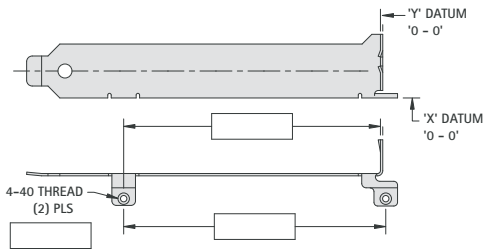

- CAT. NO. 9205**
- CAT. NO. 9207**

LOW PROFILE with TABS

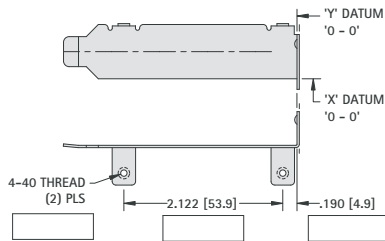

- CAT. NO. 9231**

PCI with TABS

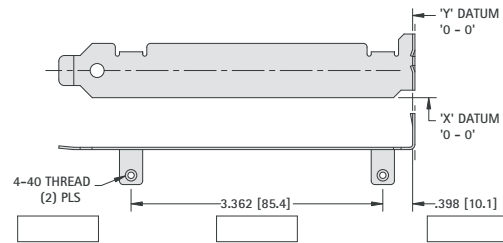

- CAT. NO. 9203**

EISA/ISA with TABS

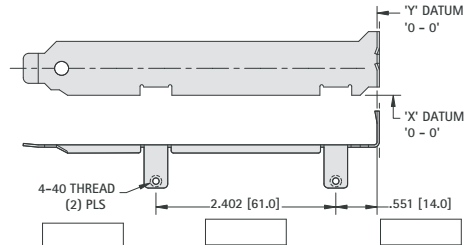

- CAT. NO. 9206**

EISA/ISA with TABS

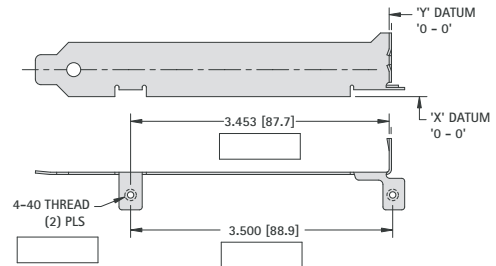

- CAT. NO. 9208**

PCI with TAB

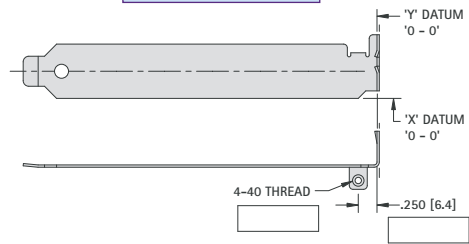

- CAT. NO. 9204**

NOTE: Refer to pages 114 and 115 for overall blank dimensions

If you do not have your own drawing, please use the worksheet provided.

- STEP 1:** Select a standard blank configuration PCI or EISA/ISA, with or without tabs.
- STEP 2:** If you've selected a standard blank with tabs and the tab locations do not meet your requirements, indicate the dimensions in the boxes.
- STEP 3:** Place your standard panel cutouts (Ex: DB9) on your selected drawing.
- STEP 4:** Use Datum's X and Y on drawing, to indicate the precise location of the center lines of the cutout(s).
- STEP 5:** For stamped identification markings indicate the approximate location(s).
- STEP 6:** Quantities Required: _____
If you have any questions, please contact our application engineers.

Name: _____ Title: _____

Company: _____

Address: _____

Phone: _____ Fax: _____

For prompt quotations fax, mail or e-mail this worksheet.