

REVISIONS					
REV	DATE	DESCRIPTION	BY	CHK	APP'D
A1	26OCT2021	REVISED PER ECN-21-122181	RZ	WK	

1. USE INSTRUCTION SHEET 408-2299-5.

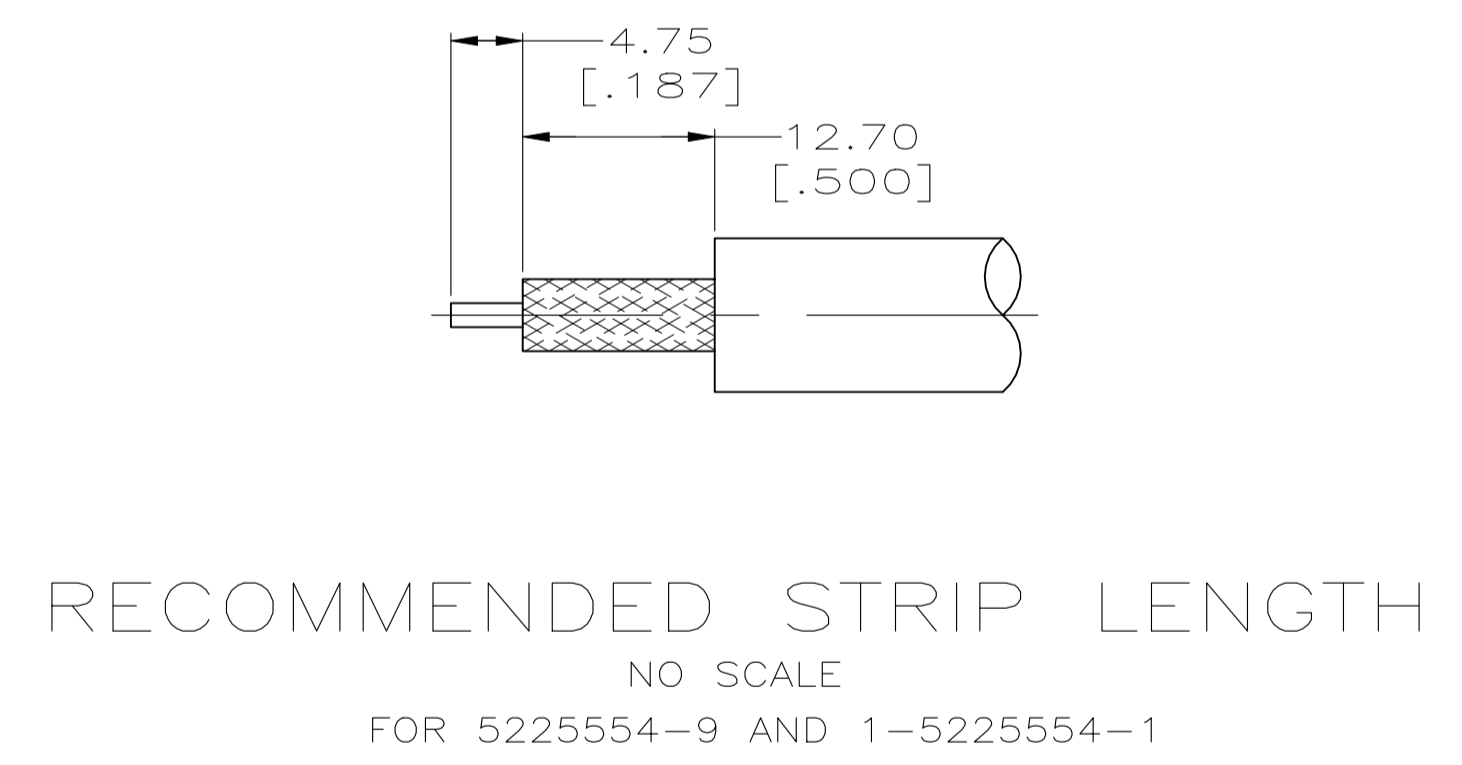
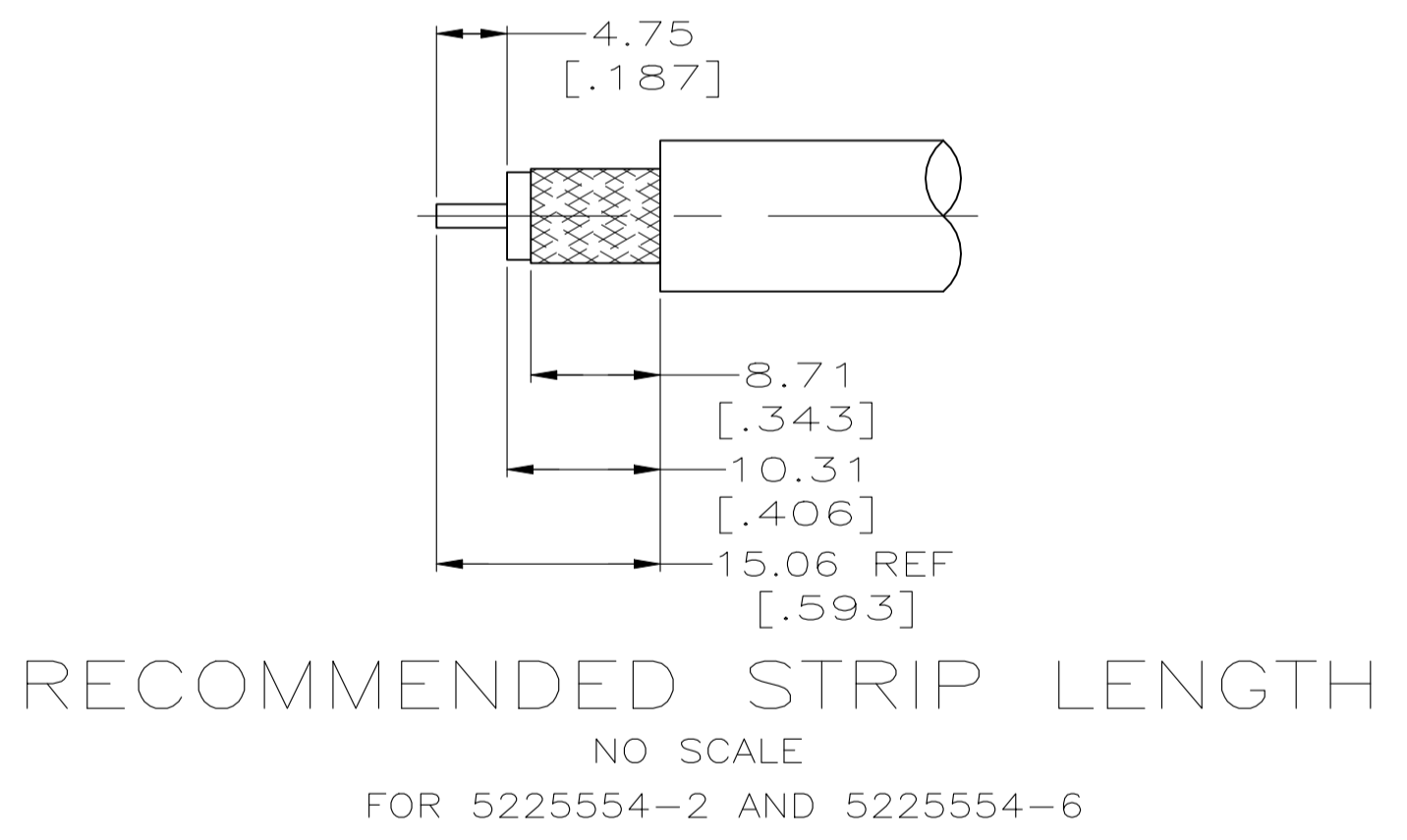
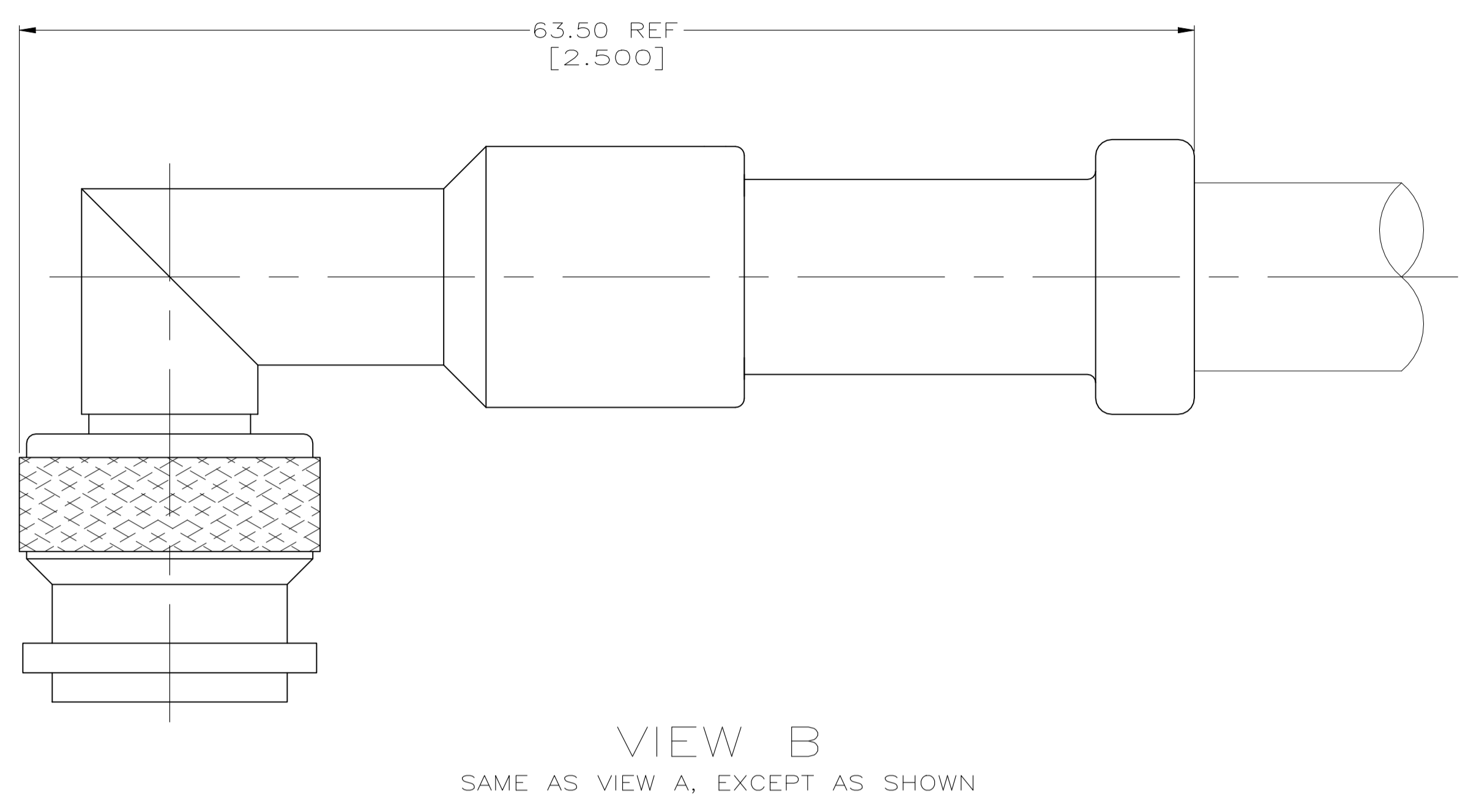
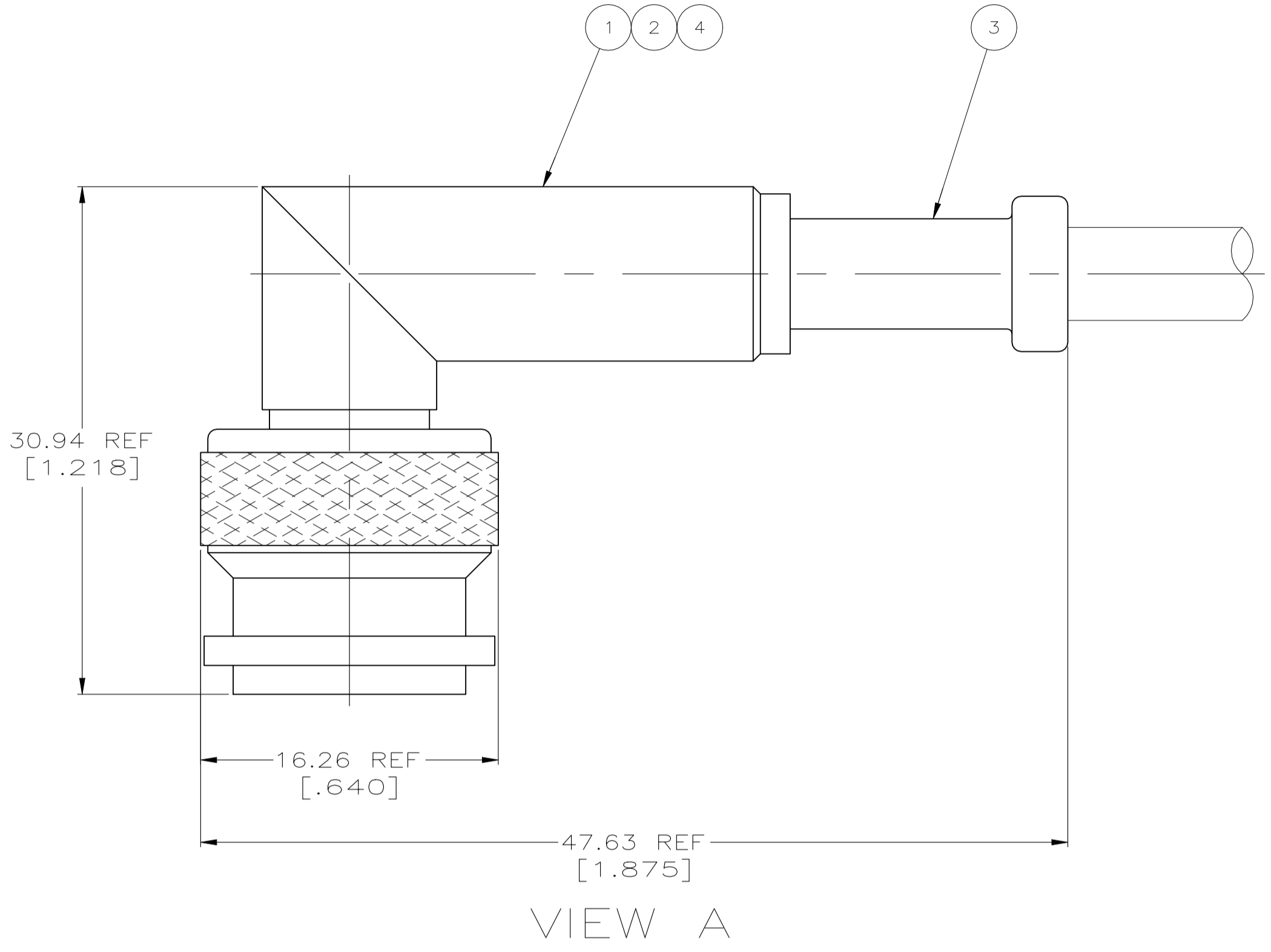

RG-393/U	220015-1	332022	9-225490-1	225471-7	9-225518-0	B	1-5225554-1
RG-9/U, 9A/U & 214/U	220015-1	332022	9-331987-3	225599-1	9-225518-0	B	5225554-9
RG-142/U, 142A/U, 142B/U	220045-2	-	9-225560-4	225471-3	9-225518-2	A	5225554-6
RG-58A/U, 58C/U	220045-2	-	9-225560-5	225471-1	9-225518-1	A	5225554-2
CABLE	CRIMP TOOL	④ SEAL QTY=1	③ FERRULE QTY=1	② CONTACT QTY=1	① PLUG ASSEMBLY QTY=1	VIEW	PART NUMBER

THIS DRAWING IS A CONTROLLED DOCUMENT.

DIMENSIONS: mm [INCHES]	TOLERANCES UNLESS OTHERWISE SPECIFIED:	DIN 18412	APPROVED	DATE	BY	CHK	APP'D
0. PLC ± -	1. PLC ± -	18412	J. HAVENER	18APR2005	J. LIPPERT	J. HAVENER	18APR2005
2. PLC ± 0.41 [0.016]	3. PLC ± -	18412	NAME				
4. PLC ± -	ANGLES ± -	18412	PRODUCT SPEC				
MATERIAL	FINISH	18412	108-12001				
		18412	APPLICATION SPEC				
		18412	408-2299-5				
		18412	WEIGHT 0.000000				
		18412	A1 00779 C=5225554				
		18412	CUSTOMER DRAWING				

SCALE 4:1 SHEET 1 OF 1 REV A1