

PART NUMBER	REV	FIRST USED
466877-2	E	565435-5

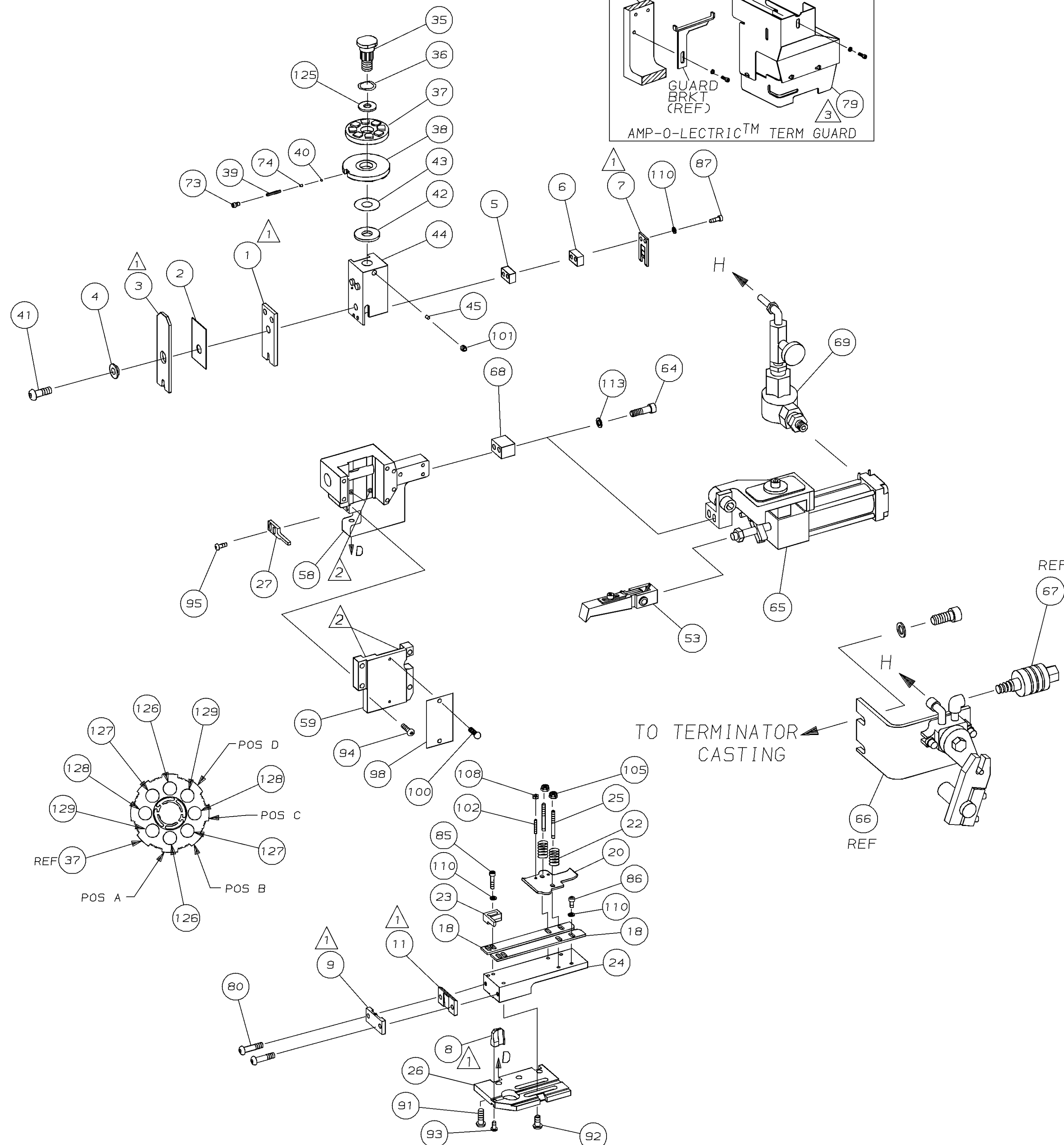
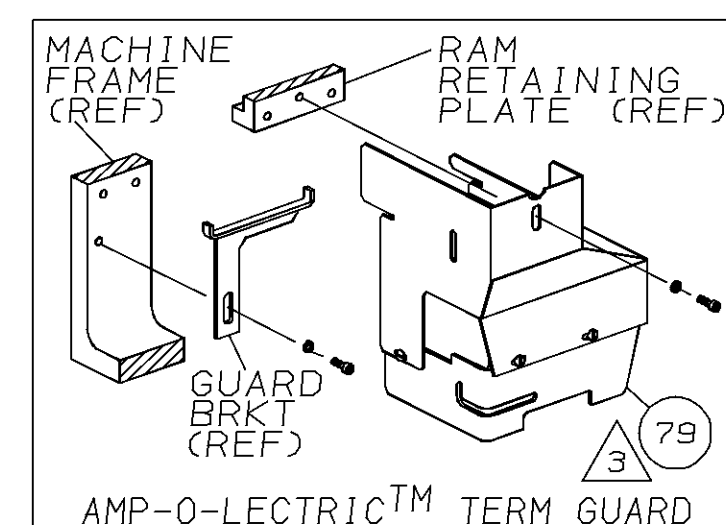

- ① RECOMMENDED SPARE PARTS.
- ② GREASE LIGHTLY.
- ③ GUARD MUST BE IN PLACE WHEN OPERATING APPLICATOR IN A BENCH MACHINE.
- ④ SEE DRAWING FOR COMPONENTS.
- ⑤ CUT TO LENGTH AT ASSEMBLY.

TERMINAL NAME: .375 FASTIN-FASTON™ TAB					
280074					
CRIMPING DATA			WIRE SIZE		
PAD LTR	CRIMP HEIGHT		WIRE SIZE		
A	.121 ±.002 [3.07 ±0.05mm]		7		
B	.114 ±.002 [2.9 ±0.05mm]		8		
C	.105 ±.002 [2.67 ±0.05mm]		9		
D	.098 ±.002 [2.49 ±0.05mm]		10		
CRIMP	SIZE	TYPE	RANGE		
WIRE	.250 [6.35mm]	F	10-7		
INSUL	.320 [8.13mm]	0	.200-.275		
WIRE STRIP LENGTH	TERM APPL SPEC	FEED	APPL INSTRUCTION	SET UP GAGE	LAYOUT
-	114-0021	1.550	408-8039	458638-1	1110

QTY	REV	TER	APPL SPEC	DESCRIPTION	ITEM NO	
2	-	C	8-354778-5	PIN, WIRE DISC (.2920)D	129	
2	-	C	7-354778-1	PIN, WIRE DISC (.2850)C	128	
2	-	C	5-354778-3	PIN, WIRE DISC (.2760)B	127	
2	-	C	3-354778-9	PIN, WIRE DISC (.2690)A	126	
1	-	A	986950-1	WASHER, FLAT PRECISION	125	
					124	
					123	
					122	
					121	
					120	
					119	
					118	
					117	
					116	
					115	
					114	
2	-	A	21024-5	WASHER, LOCK (#10) AIR ASSY	113	
					112	
7	-	A	21024-4	WASHER, LOCK (NO. 8) SHEAR BL	111	
					110	
2	-	A	21018-4	NUT, HEX (4-40) DRAG	109	
					108	
					107	
					106	
2	-	A	21022-2	NUT, HEX SL (8-32) DRAG STUD	105	
					104	
					103	
2	-	A	2-21006-6	SCR, SKT SET (4-40x.62) DRAG	102	
1	-	A	21009-2	SCR, SKT SET (1/4-20x.25) RAM	101	
2	-	A	21017-2	SCR, DRIVE (#2x.19) ID PLATE	100	
					99	
1	-	B	461264-1	PLATE, IDENTIFICATION	98	
					97	
					96	
2	-	A	2-21002-2	SCR, BHC (8-32x.50) STRIPPER	95	
4	-	A	2-21002-9	SCR, BHC (10-32x.75) CAP	94	
1	-	A	22733-8	SCR, BHC (8-32x.38 LW) ANVIL	93	
4	-	A	3-21002-3	SCR, BHC (1/4-20x.50) ST 6D PL	92	
3	-	A	2-22733-8	SCR, BHC (1/4-20x.62) HSG	91	
					90	
					89	
					88	
⑤	2	-	A	3-21000-2	SCR, SHC (8-32x1.16) SLUG BLADE	87
	3	-	A	2-21000-6	SCR, SHC (8-32x.38) STRIP GUIDE	86
	2	-	A	2-21000-9	SCR, SHC (8-32x.75) R STRIP GUIDE	85
					84	
					83	
					82	
					81	
					80	
③	2	-	A	3-21002-0	SCR, BHC (10-32x.88) SHEAR PL	79
	1	-	A	455750-7	GUARD ASSY	78
					77	
					76	
					75	
	1	-	A	690603-1	SPRING, ASSIST	74
	1	-	A	23030-1	SCR, SKT CAP (6-32x.25) CP DSC	73
					72	
					71	

QTY REQD PER ASSY	U/M	DWG SIZE	PART NO	DESCRIPTION	ITEM NO
PARTS LIST					

QTY	REV	TER	APPL SPEC	DESCRIPTION	ITEM NO	
					70	
④	1	-	C	692655-5	AIR FEED VALVE ASSY	69
	1	-	A	461690-1	SPACER, AIR FEED	68
REF	-	A	24042-2	VALVE, SHUT OFF	67	
④	REF	-	C	692655-6	AIR FEED VALVE ASSY	66
④	1	-	B	1-460277-5	AIR FEED ASSY (2 INCH)	65
	2	-	A	4-21000-3	SCR, SHC (10-32x2.00) AIR ASSY	64
					63	
					62	
					61	
					60	
					59	
					58	
					57	
					56	
					55	
					54	
④	1	-	B	460680-2	FEED FINGER ASSY	53
					52	
					51	
					50	
					49	
					48	
					47	
					46	
					45	
					44	
					43	
					42	
					41	
					40	
					39	
					38	
					37	
					36	
					35	
					34	
					33	
					32	
					31	
					30	
					29	
					28	
					27	
					26	
					25	
					24	
					23	
					22	
					21	
					20	
					19	
					18	
					17	
					16	
					15	
					14	
					13	
					12	
					11	
①	1	-	B	240644-5	PLATE, REAR SHEAR	10
					9	
①	1	-	B	1-690482-8	PLATE, FRONT SHEAR	8
①	1	-	D	683452-2	ANVIL	7
①	1	-	B	3-690474-6	BLADE, SLUG	6
①	1	-	C	5-240641-3	SPACER, SLUG BLADE	5
①	1	-	C	5-240641-6	SPACER, SLUG BLADE	4
①	1	-	B	238009-3	SPACER, BLOCK CRIMPER	3
①	1	-	C	683454-3	CRIMPER, INSULATION	2
①	1	-	B	1-455888-2	SPACER, CRIMPER	1
①	1	-	C	456432-2	CRIMPER, WIRE	1

QTY REQD PER ASSY	U/M	DWG SIZE	PART NO	DESCRIPTION	ITEM NO
PARTS LIST					
REVISION OF EACH ASSY NO (WHEN BLANK, USE DWG REVISION)					
DIMENSIONS IN INCHES. DO NOT SCALE PRINT. TOLERANCES UNLESS OTHERWISE SPECIFIED.			MATERIAL		
2 PLC DEC ±.25			HT TR		
3 PLC DEC ±			FIN		
4 PLC DEC ±					
ANGLES ±					
REMOVE BURRS, BREAK SHARP EDGES R.015 MAX					
SURF TEXTURE: ✓					
DR D.SALTZER 11-1-95 APP T.BEDDICK 11-14-95			AMP Incorporated		
CHK 11-14-95 REL 11/16/95			Harrisburg, PA 17105-3608		
C.ERISMAN B. MORGAN					
NAME: END FEED HDM APPLICATOR			MACHINE REF: MINI APPL		
SCALE: -			SHEET: 1 OF 1		
DWG NO: 466877			REV: E		

THIS DRAWING IS A CONTROLLED DOCUMENT FOR AMP INCORPORATED. IT IS SUBJECT TO CHANGE AND THE CONTROLLING ENGINEERING ORGANIZATION SHOULD BE CONTACTED FOR THE LATEST REVISION.

THIS INFORMATION IS CONFIDENTIAL AND IS DISCLOSED TO YOU ON CONDITION THAT NO FURTHER DISCLOSURE IS MADE BY YOU TO OTHER THAN AMP PERSONNEL WITHOUT WRITTEN AUTHORIZATION FROM AMP INCORPORATED, HARRISBURG, PA.

LOC A  
DIST 66