

MARKETING SALES DRAWING

DIMENSIONS IN INCHES - DO NOT SCALE THIS DRAWING
DIMENSIONS IN METRIC - []

Electrical Testing
 per Tusonix standard
 test plans and Mil-Std-202
 Test Methods.

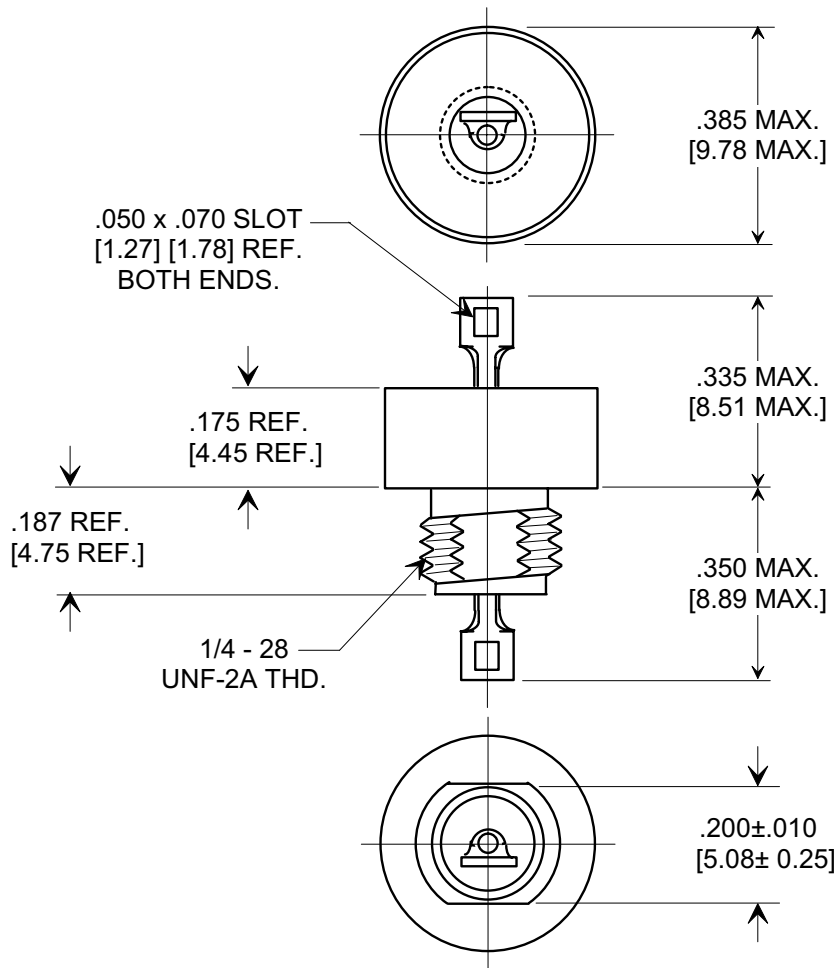
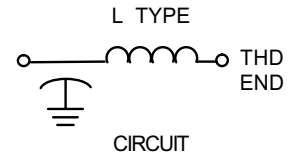
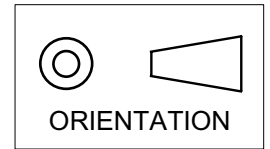

NOTES:

MATERIALS:

- BUSHING - TIN PLATED STEEL
- LEAD - SOLDER PLATED COPPER
- NUT - TIN PLATED BRASS
- L'WASHER - TIN PLATED PHOSPHOR BRONZE
- MOUNTING TORQUE: 8 lb - ins. max
- SEAL TESTED PER MIL-STD-202 METHOD 112 CONDITION A.
- DCR - .01Ω max.
- MAX. SOLDER TEMPERATURE 500°F

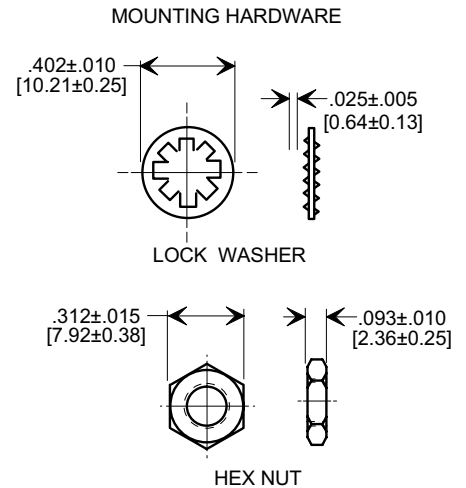

MIN. CAP. (μF)	I.R. MIN. @ 100 (VDC.)	DWV (VDC)	WORKING VOLTAGE DC		CURRENT D.C.	MINIMUM NO LOAD INSERTION LOSS (dB) AT 25°C PER MIL-STD-220					
			85°C	125°C		30 KHz	100 KHz	300 KHz	1 MHz	10 MHz	1 GHz
1.4	500 M Ω	250	100	50	15 A	15	25	34	44	60	70

X-2015 Rev-0	REVISION RECORD							--TOLERANCES-- Unless Otherwise Specified	Title COAXIAL BROADBAND - "L" HERMETICALLY SEALED		
	0	Original Release C.O.	5	RDN TO COMP FMP. STYLE DWG SPLIT FOR EACH VAR. S.M. 06-20-02	6	TABLE REVISED 50 WVDC @ 125° WAS 70WVDC @ 125° L.E. 01-17-03	7		ADDED IR & DWV. SM 03-06-03	DECIMAL ± // //	Drawn S.M. 06-20-02
	2002		20030106-1-10		20030304-2-13			ANGLES ± // //	Approved J.Mc 06-20-02	A	
								TUSONIX TUCSON, ARIZONA	4601-053		