

SCHMATIC DIAGRAM

| MINIMUM INSERTION LOSS | | 50 Ω CIRCUIT | |
|------------------------|-----------|-------------------|-----------|
| COMMON MODE | | DIFFERENTIAL MODE | |
| mHz | I.L. (dB) | mHz | I.L. (dB) |
| .05 | -- | min. | -- |
| .15 | 12 | min. | 20 |
| 0.5 | 20 | min. | 30 |
| 1.0 | 25 | min. | 35 |
| 5.0 | 35 | min. | 40 |
| 10 | 40 | min. | 45 |
| 20 | -- | min. | -- |
| 30 | 35 | min. | 40 |

TEST SPECIFICATIONS

HI-POT (1 min.) L/G 1500 VAC
 L/L 1768 VDC

RATED VOLTAGE: 250 VAC MAXIMUM
 RATED CURRENT: at 115 VAC 15 A MAXIMUM
 at 250 VAC 10 A MAXIMUM
 LINE FREQUENCY 50/60 Hz
 CURRENT OVERLOAD 6X FOR 8 SECONDS
 INSULATION RESISTANCE 9000 MEGOHMS MINIMUM
 LEAKAGE CURRENT at 120 VAC, 60Hz .25 mA MAXIMUM
 at 250 VAC, 50Hz .40 mA MAXIMUM

ENVIRONMENTAL SPECIFICATIONS
 AMBIENT TEMPERATURE RANGE 0 deg.C to 40 deg.C
 (OPERATING AT RATED CURRENT)
 HUMIDITY RANGE 0 % to 95 % R.H.

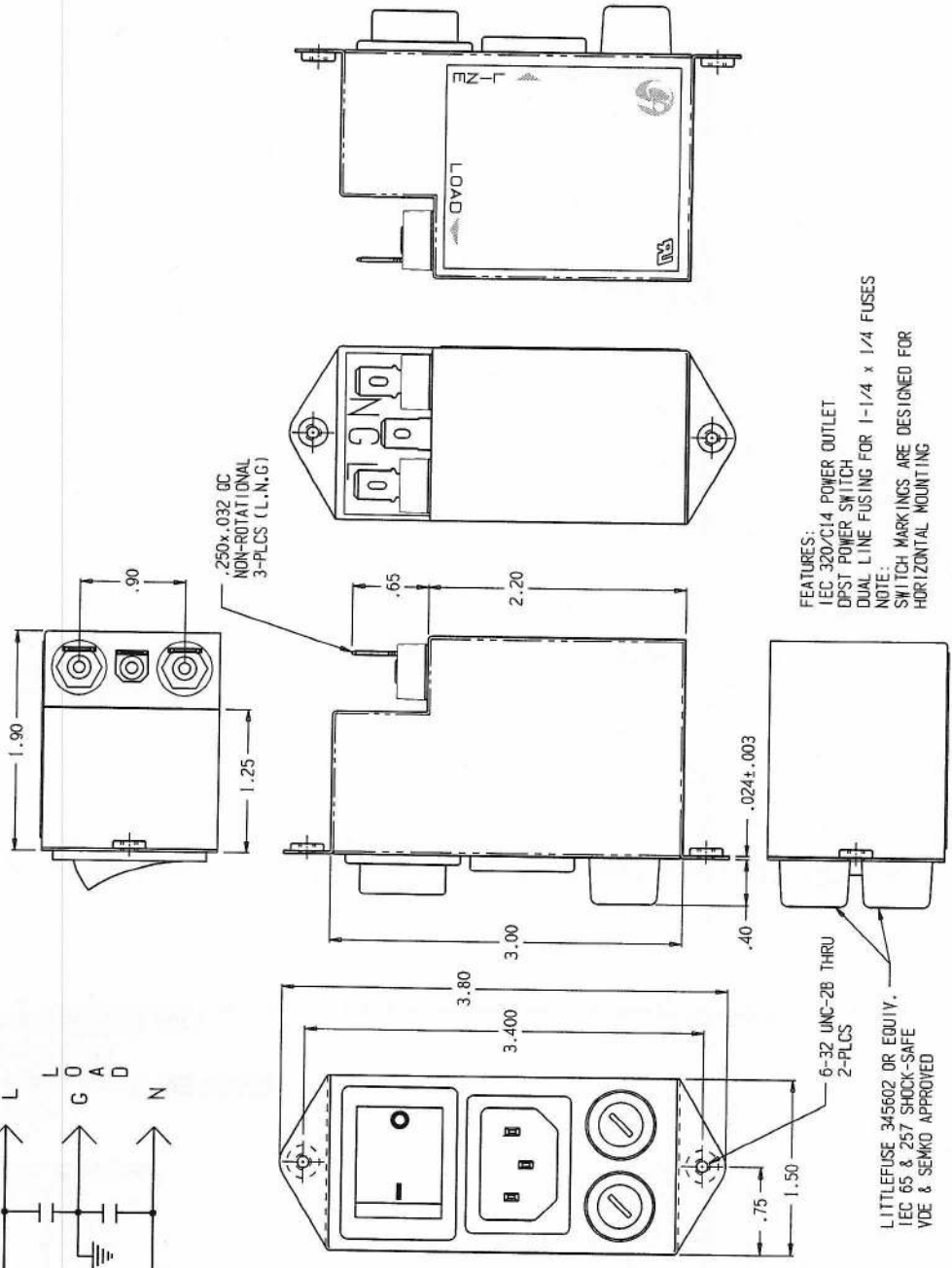

FEATURES:
 IEC 320/C14 POWER OUTLET
 DPST POWER SWITCH
 DUAL LINE FUSING FOR 1-1/4 x 1/4 FUSES
 NOTE:
 SWITCH MARKINGS ARE DESIGNED FOR
 HORIZONTAL MOUNTING

CONFIDENTIAL-PROPRIETARY TO CURTIS INDUSTRIES. NOT TO BE SHARED WITH THIRD PARTY WITHOUT WRITTEN PERMISSION FROM CURTIS INDUSTRIES

CAD FILENAME: FPE280215 Rev G B 2-pr t SCALE 1:1 DRAWN SRS CHECKED KEP DATE 12-16-98

FOR TOLERANCE AND CHANGE INFORMATION B OF 4 DWG NO. FPE280215 REV. G