

PRODUCT No.  
SEE TABLE

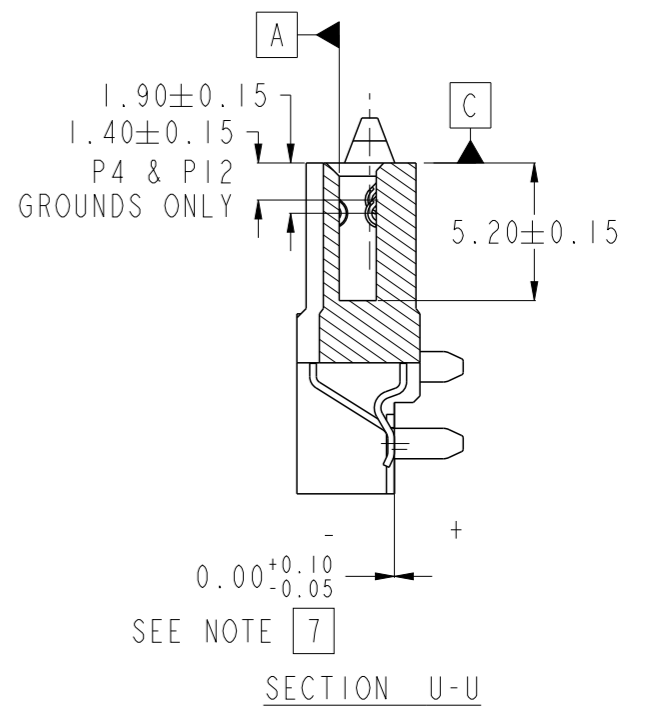
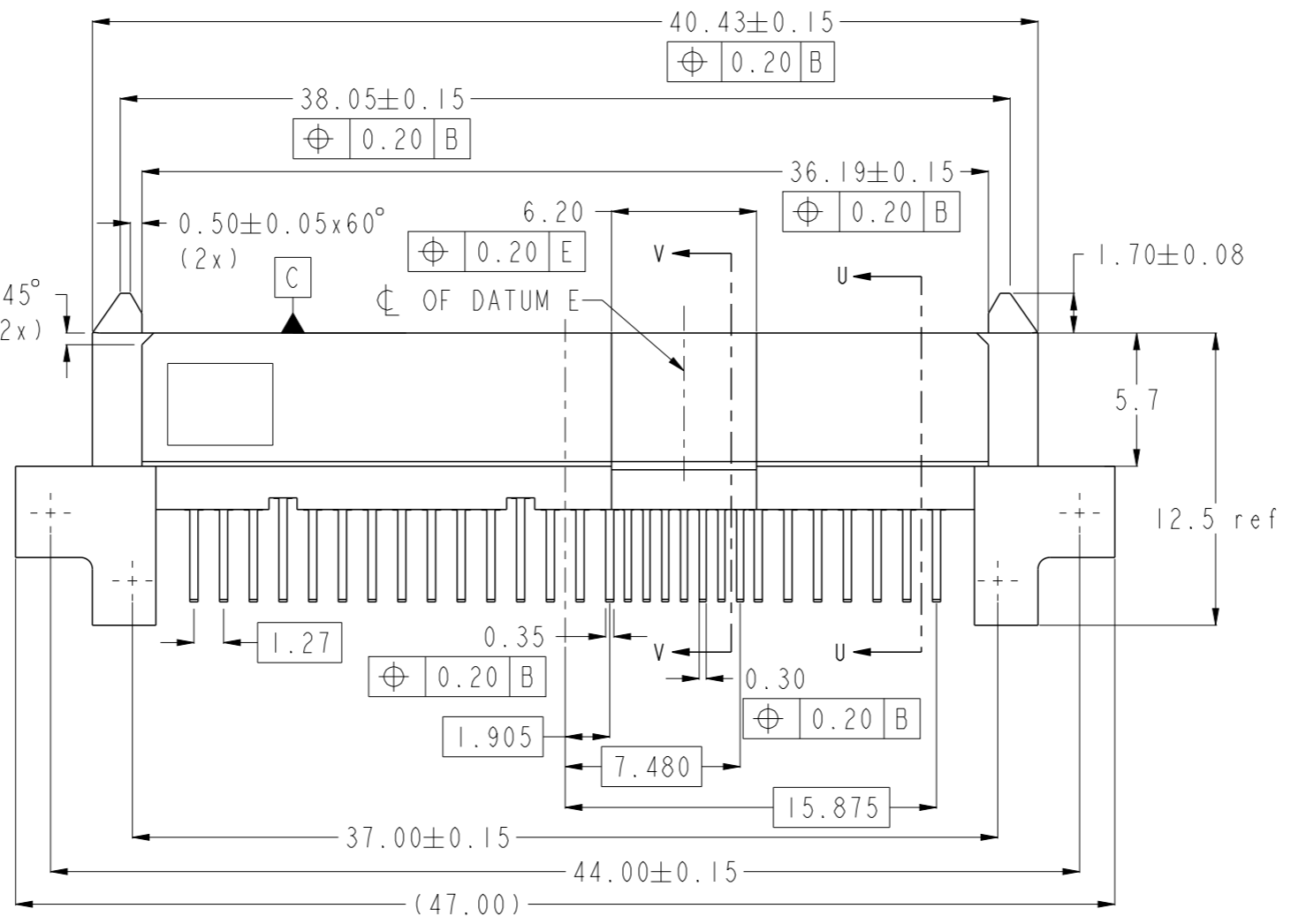
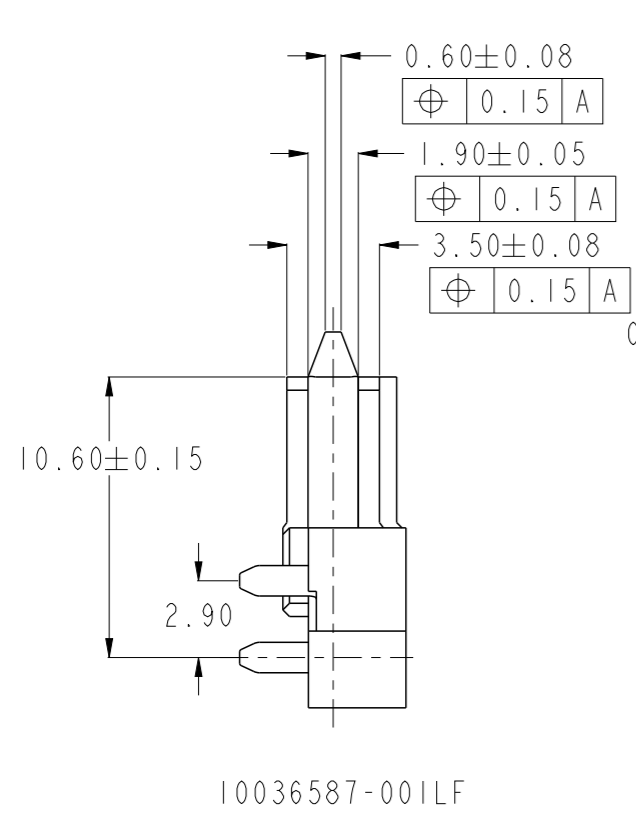
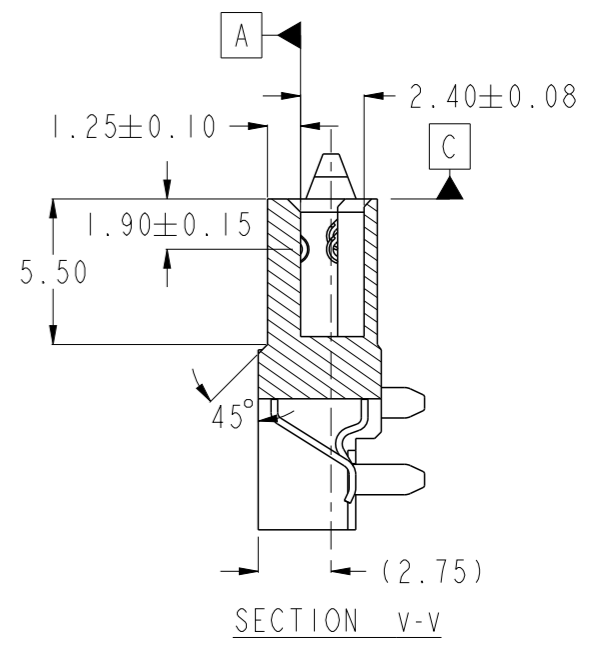
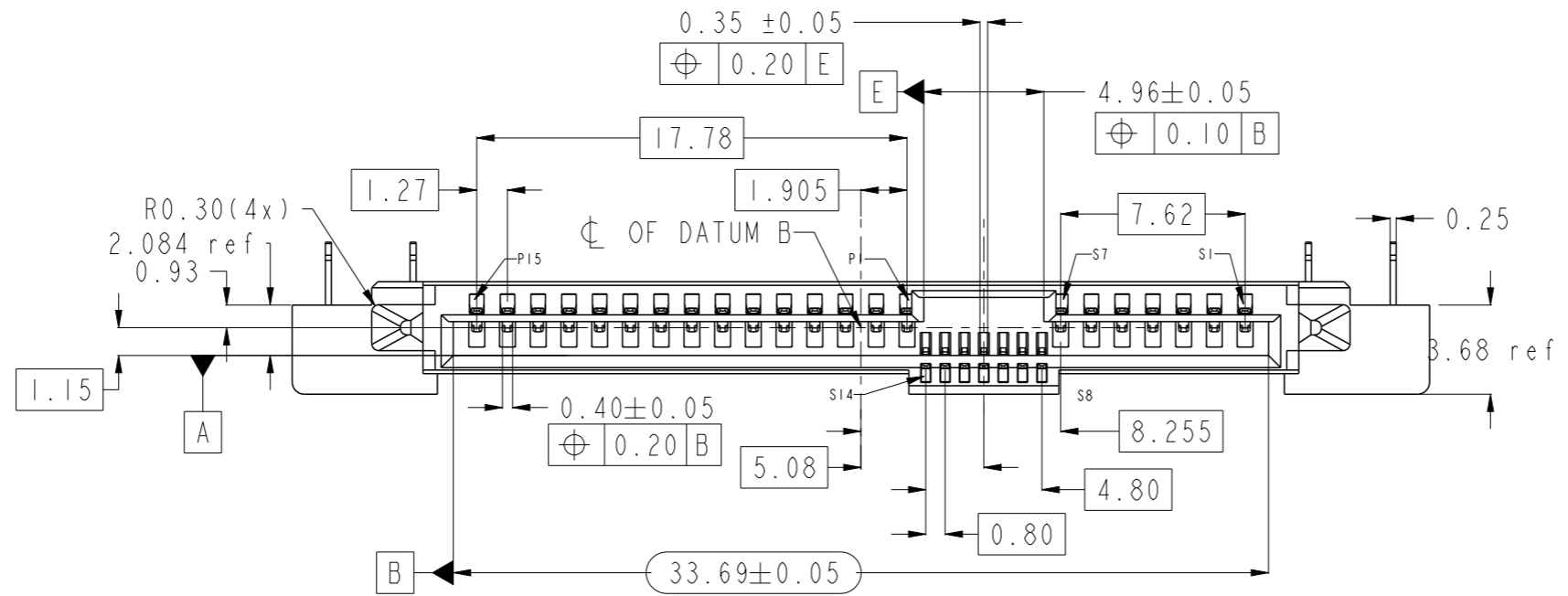

Copyright FCI.

spec ref	dr	wcadmin	2006/03/08
tolerance std	eng	Koon-Poh Tay	2012/06/20
ASME Y14.5	chr	-	-
	appr	Chen-Hong Tan	2012/06/20

projection	MM	size	A3	scale	2:1
		ecn no	ELX-S-011973-1		
product family		rel level	Released		



SAS RECEPTACLE  
R/A SMT ASSY

dwg no	10036587	rev	N
Product - Customer Drw		sheet 1 of 3	

PRODUCT No.	RECOMMENDED PCB THICKNESS	TYPE OF CLIP	DIM 'A'	PACKAGING
10036587-001LF	1.60	METAL BLADE	2.60	TRAY
10036587-001TRLF				TAPE & REEL
10036587-002LF	1.60	FORK LOCK	2.40	TRAY
10036587-002TRLF				TAPE & REEL
10036587-003LF	1.60	METAL BLADE	2.60	TRAY
10036587-003TRLF				TAPE & REEL
10036587-004LF	2.60	METAL BLADE	3.60	TRAY



10036587-001LF

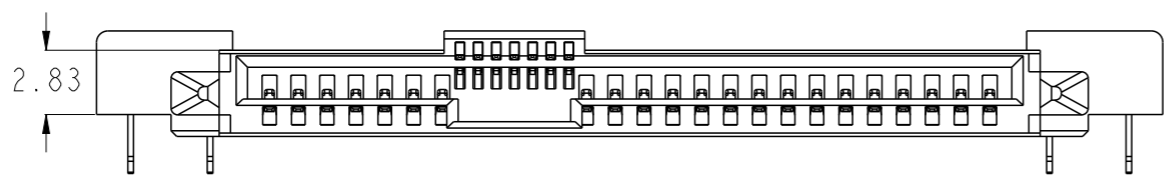

2.83

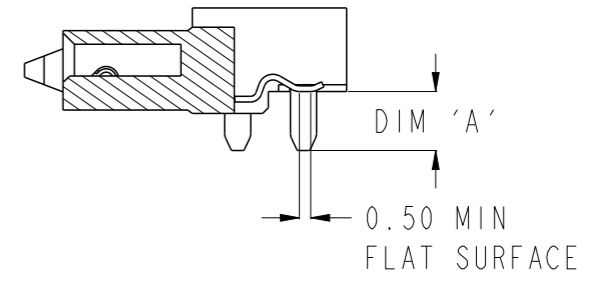

DIM 'A'

0.50 MIN  
FLAT SURFACE

10036587-002LF

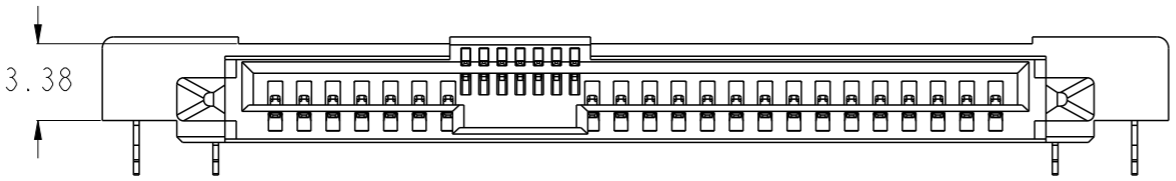

3.38

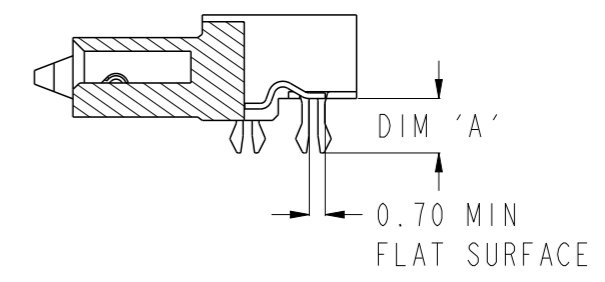

DIM 'A'

0.70 MIN  
FLAT SURFACE

10036587-003LF  
10036587-004LF

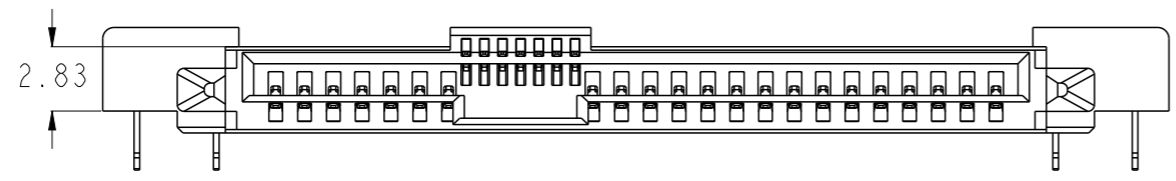

2.83

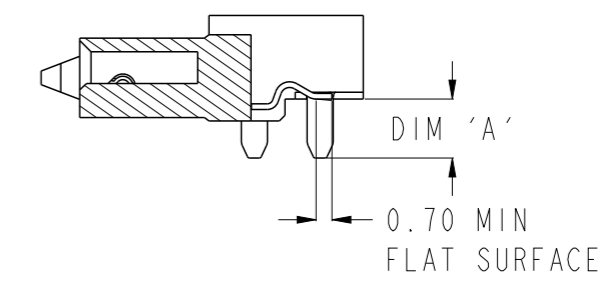

DIM 'A'

0.70 MIN  
FLAT SURFACE

UNSPECIFIED DIMENSIONS PLEASE REFER TO PAGE 1 & 2



Copyright FCI.

spec ref	dr	wcadmin	2006/03/08	projection	MM	size	A3	scale	2:1
tolerance std	eng	Koon-Poh Tay	2012/06/20			ecn no	ELX-S-011973-1	rel level	Released
ASME Y14.5	chr	-	-						
surface <input checked="" type="checkbox"/> linear ASME Y14.5 angular	appr	Chen-Hong Tan	2012/06/20	product family		rel level			
	linear	0.X	±0.25		SAS RECEPTACLE R/A SMT ASSY	dwg no 10036587	rev N		
	0.XX	±0.2							
0.XXX	±								
ASME Y14.5	angular	0°	±0.2°	www.fci.com	cat. no.	Product - Customer Drw	sheet 2 of 3		

PRODUCT No.  
SEE TABLE

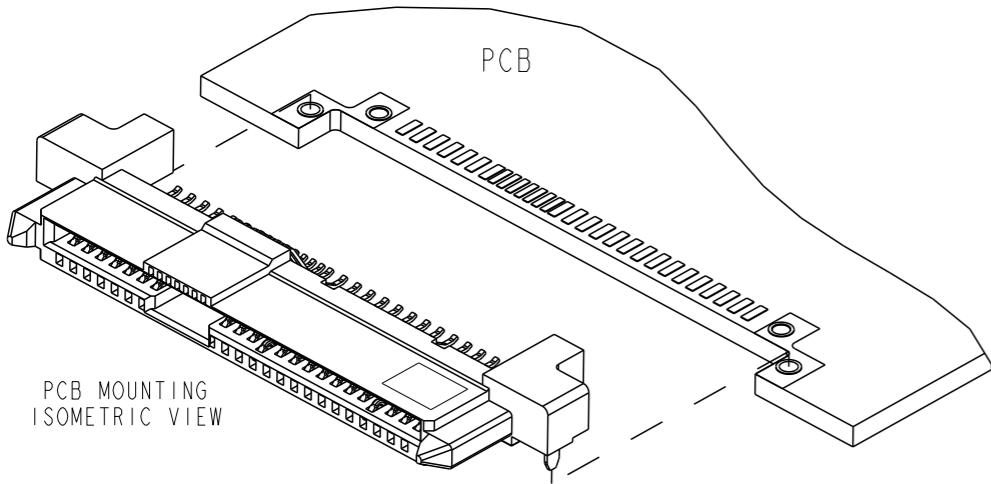
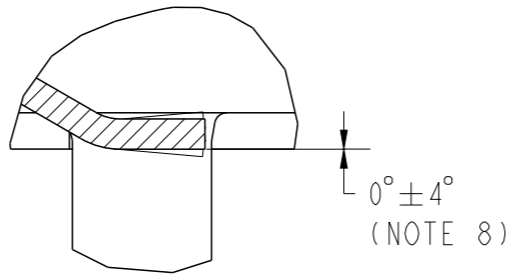

PCB MOUNTING  
ISOMETRIC VIEW

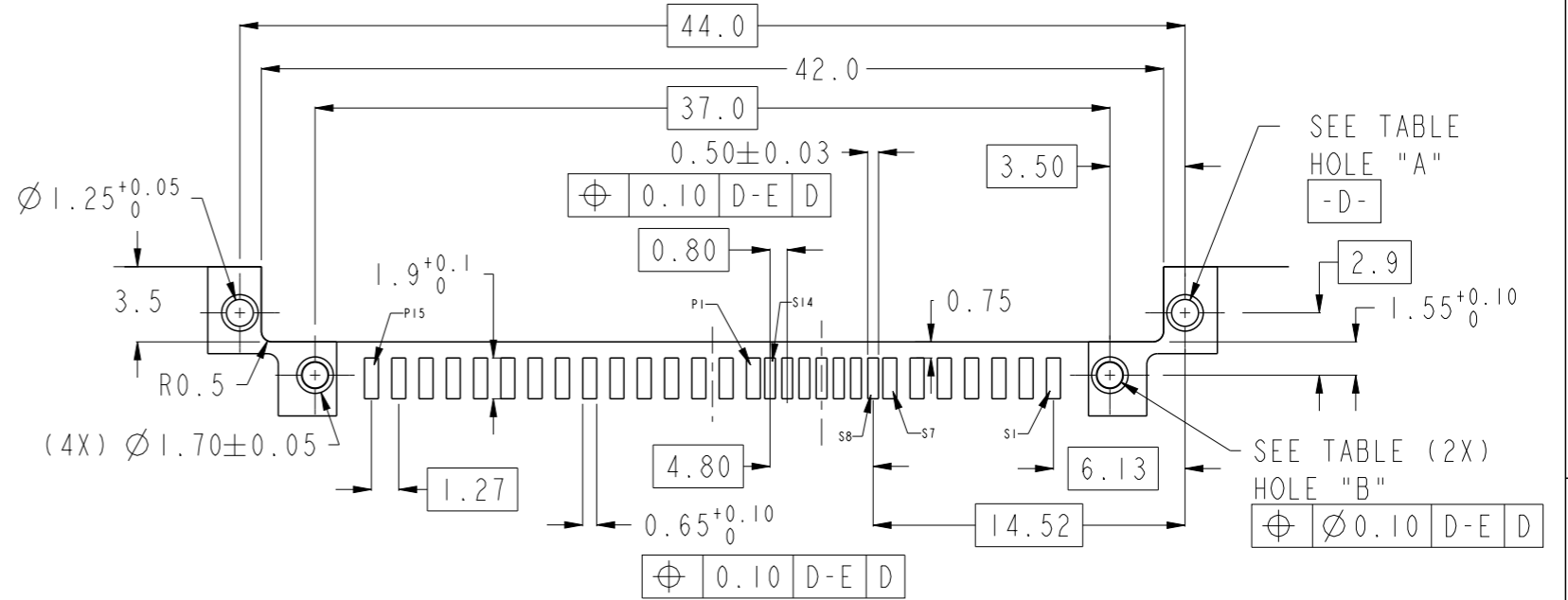

**RECOMMENDED PCB LAYOUT**

RECOMMENDED PCB T: 1.6mm  
TOLERANCE UNLESS OTHERWISE: ±0.1

	HOLE "A"	HOLE "B"	REMARKS
RECOMMENDED 1	Ø 1.25 <sup>+0.05</sup> / <sub>-0</sub>	Ø 1.20 <sup>+0.05</sup> / <sub>-0</sub>	STD
RECOMMENDED 2	Ø 1.20 ± 0.05	Ø 1.20 ± 0.05	CUSTOMISE

**NOTES:-**

- MATERIAL:  
1) HOUSING : HIGH TEMP. THERMOPLASTIC, 94V-0, COLOR: BLACK  
2) TERMINAL : COPPER ALLOY  
3) HOLD DOWN: COPPER ALLOY
- FINISH:  
1) TERMINAL : 30u" Au PLATING (CONTACT PONT) OVER 50u" MIN NICKEL  
2) SOLDER TAIL: 100u" MIN TIN OVER 50u" MIN NICKEL  
3) HOLD DOWN : 100u" MIN TIN OVER 50u" MIN NICKEL
- PACKAGING:  
a) 10036587-XXXLF : REFER TO STANDARD PACKAGING IN TRAY  
b) 10036587-XXXTRLF: REFER TO TAPE AND REEL PACKAGING
- THE HOUSING WILL WITHSTAND EXPOSURE TO 260 DEGREES CELSIUS PEAK TEMPERATURE FOR 10 SECONDS IN A CONVECTION, INFRE-RED OR VAPOUR PHASE REFLOW OVEN
- THIS PRODUCT MEETS EUROPEAN UNION DIRECTIVES AND OTHER COUNTRY REGULATIONS AS DESCRIBED IN GS-22-008
- PART NUMBERS ENDING IN 'LF' MEANS FOR NOTE 5 LEAD FREE IDENTIFICATION, P/N XXXXXXXXX-XXXLF IS EQUIVALENT TO PREVIOUS P/N XXXXXXXXX-XXX
- ALL SOLDER TAIL TO BE WITHIN 0.10mm, MAX COPLANARITY.
- ALL SOLDER TAILS ANGLE CONTROL SHALL BE 0° ± 4° AND APPLIED TO P/n 10036587-XXXLF.
- A SYMBOL BE NEXT TO ANY DIMENSION, VIEW, OR NOTE WHICH HAS BEEN MODIFIED WITH THE CURRENT DRAWING REVISION.

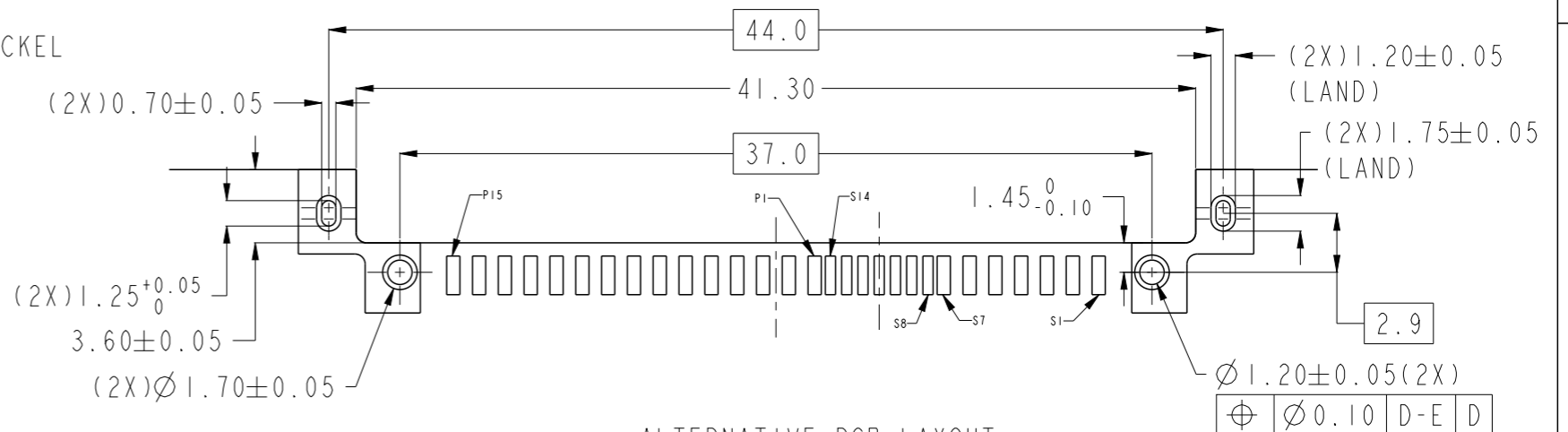

**ALTERNATIVE PCB LAYOUT**

REFER TO ABOVE RECOMMENDED PCB LAYOUT FOR UNSPECIFIED DIMENSIONS  
RECOMMENDED PCB T: 1.6mm  
TOLERANCE UNLESS OTHERWISE: ±0.1

spec ref	dr	wcadmin	2006/03/08	projection	MM	size	A3	scale	2:1
tolerance std	eng	Koon-Poh Tay	2012/06/20		← →	ecn no	ELX-S-011973-1	rel level	Released
ASME Y14.5	chr	-	product family						
	appr	Chen-Hong Tan	2012/06/20						
surface	linear	0.X	±0.25		SAS RECEPTACLE	dwg no	10036587	rev	N
		0.XX	±0.2	www.fci.com	R/A SMT ASSY	Product - Customer Drw	sheet 3 of 3		
ASME Y14.5	angular	0°	±0.2°	cat. no.					



Copyright FCI.