

THIS DRAWING IS UNPUBLISHED.

RELEASED FOR PUBLICATION

ALL RIGHTS RESERVED.

© COPYRIGHT - By -

REVISIONS

P	LTR	DESCRIPTION	DATE	DWN	APVD
C		REV PER ECO 16-003598	3-10-16	CT	DW

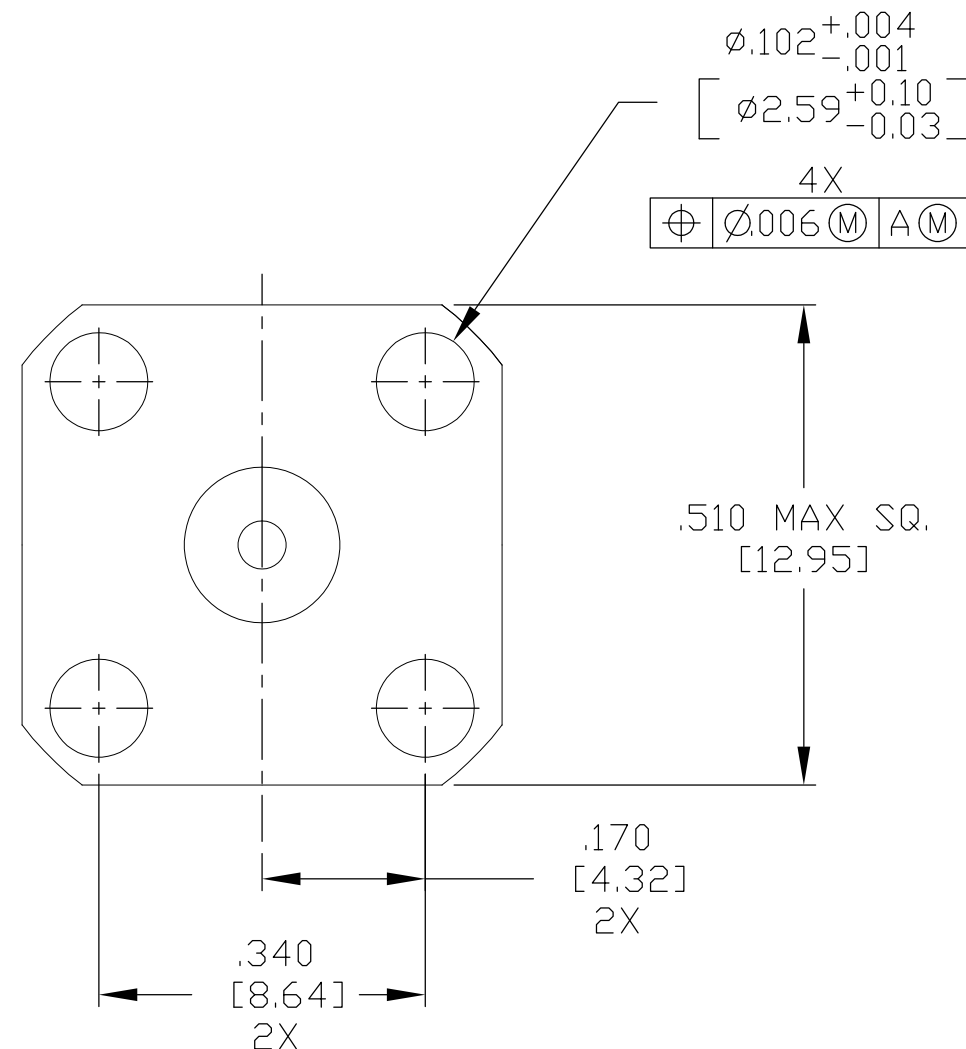
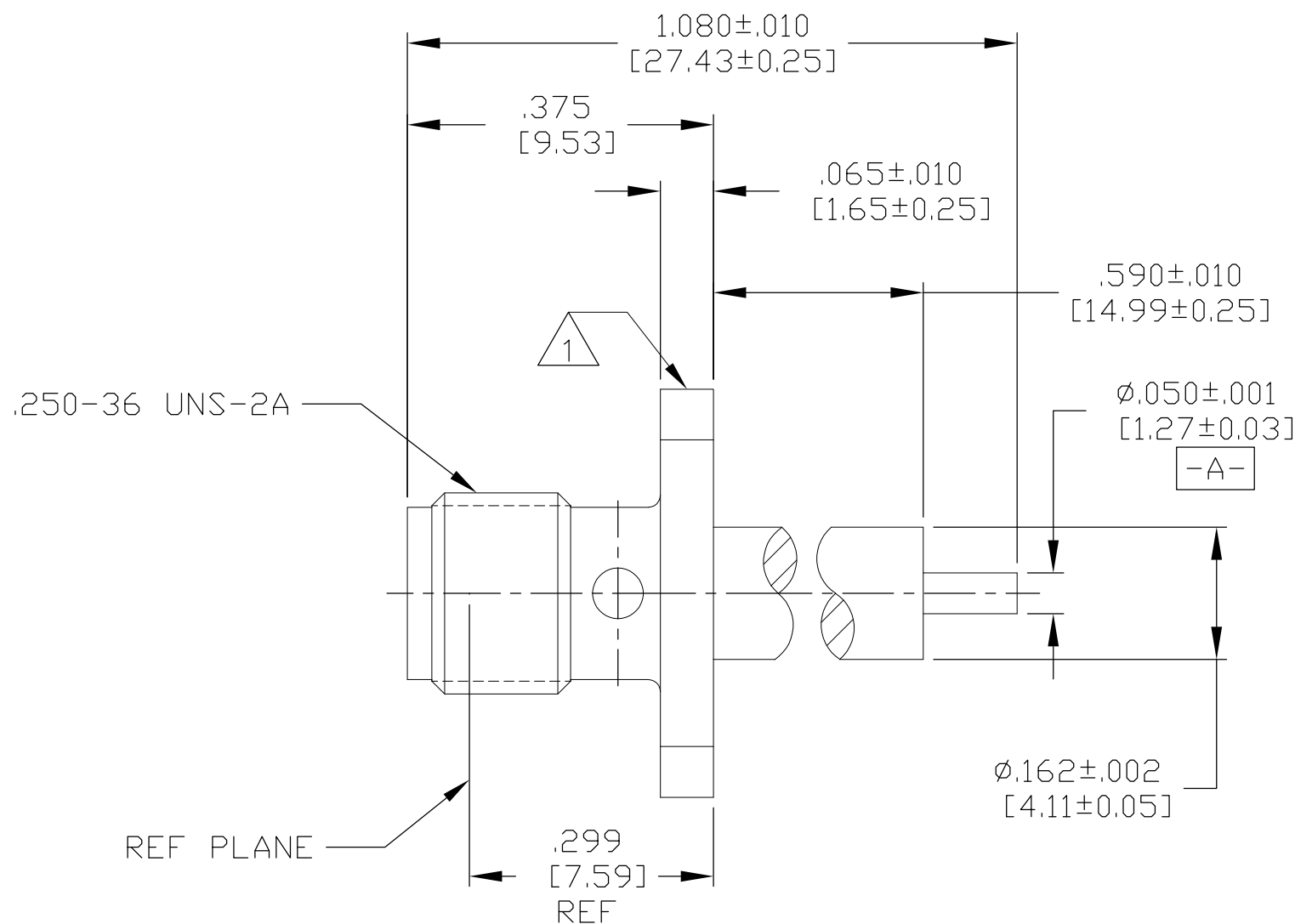

1 MARKED WITH CAGE CODE AND MILITARY PART NUMBER (M83517/04-31005)

COMPONENT	MATERIAL	FINISH
HOUSING	STAINLESS STEEL PER ASTM-A484 AND ASTM-A582, TYPE 303	PASSIVATE PER QQ-P-35
DIELECTRIC	TFE FLUOROCARBON PER ASTM-D-1457	N/A
CENTER CONTACT	BERYLLIUM COPPER PER ASTM-B-196 OR ASTM-B-197, ALLOY C17300, CONDITION H	GOLD PLATE PER MIL-G-45204

THIS DRAWING IS A CONTROLLED DOCUMENT.

DIMENSIONS: INCHES [mm]	TOLERANCES UNLESS OTHERWISE SPECIFIED:
	0 PLC ± -
	1 PLC ± -
	2 PLC ± -
	3 PLC ± .005 [0.13]
	4 PLC ± -
	ANGLES ± 1°

MATERIAL	FINISH
SEE TABLE	SEE TABLE

DWN	C.C.THOMAS	30NOV2015
CHK	D.WILSON	11-30-15
APVD	D.WILSON	11-30-15
PRODUCT SPEC	-	
APPLICATION SPEC	-	
WEIGHT	0	

		TE Connectivity	
		NAME	
SMA JACK RECEPTACLE		SIZE	A3
RESTRICTED TO		CAGE CODE	00779
-		DRAWING NO	C-1052958-1
CUSTOMER DRAWING		SCALE	5:1
		SHEET	1 OF 1
		REV	C