

SEE NOTE 8

**NOTES:**

1. METALSHELLS: STEEL; min. 315µin TIN over 40-80µin NICKEL
2. INSULATORS: HIGH TEMPERATURE PLASTIC UL 94 V-0; BLACK
3. SIGNAL CONTACTS: COPPER ALLOY; PLATING (SEE PART NO.):
  - (b) □ PLEASE ADD A for GOLD FLASH over NICKEL (PREFERRED TYPE)
  - PLEASE ADD B for 20µin HARD GOLD over min. 50µin NICKEL
  - PLEASE ADD C for 30µin HARD GOLD over min. 50µin NICKEL
4. THREADED LOCK AND SPACER CLIPS: COPPER ALLOY; min. 200µin TIN over 80µin NICKEL  
PCB-HOLES:  $\varnothing 3,1 \pm 0,1$ ; PCB THICKNESS 1,6mm
5. COLLARS: COPPER ALLOY; min. 200µin NICKEL
6. P.C.B. HOLE DRILLINGS ON SHEET 2
7. MAXIMUM TORQUE VALUE FOR THREAD: 6 in.LB
8. CONNECTOR IS PART MARKED: **164□16689X CONEC ABC** (see note 3)

Directive 2002/95/EC RoHS compliant

THIS DRAWING MAY NOT BE COPIED OR REPRODUCED IN ANY WAY, AND MAY NOT BE PASSED ON TO A THIRD PARTY WITHOUT WRITTEN PERMISSION. OWNERSHIP AND COPYRIGHT OF CONEC GmbH DO NOT ALTER CAD DRAWING BY HAND					tolerance	dim. in mm	scale:	2:1 (5:1)	
					date		name	material:	SEE NOTES
					drawn	04.07.13	Henneboel	title: <b>D-SUB FEMALE</b> 25pos. SOLDER PIN STRAIGHT with threaded lock and spacer clip	
					appd.	08.07.13	Fischer		
					norm				
				d-old	16K1IKWA/16K2IKWA		dwg no:		
3 x b	A4824	04.07.2013	K.H.				(b)	16K1A3271	DIN-A3
a	Original						sh: 1/2		
rev.	description	date	name	part no:				164□16689X (see note 3)	

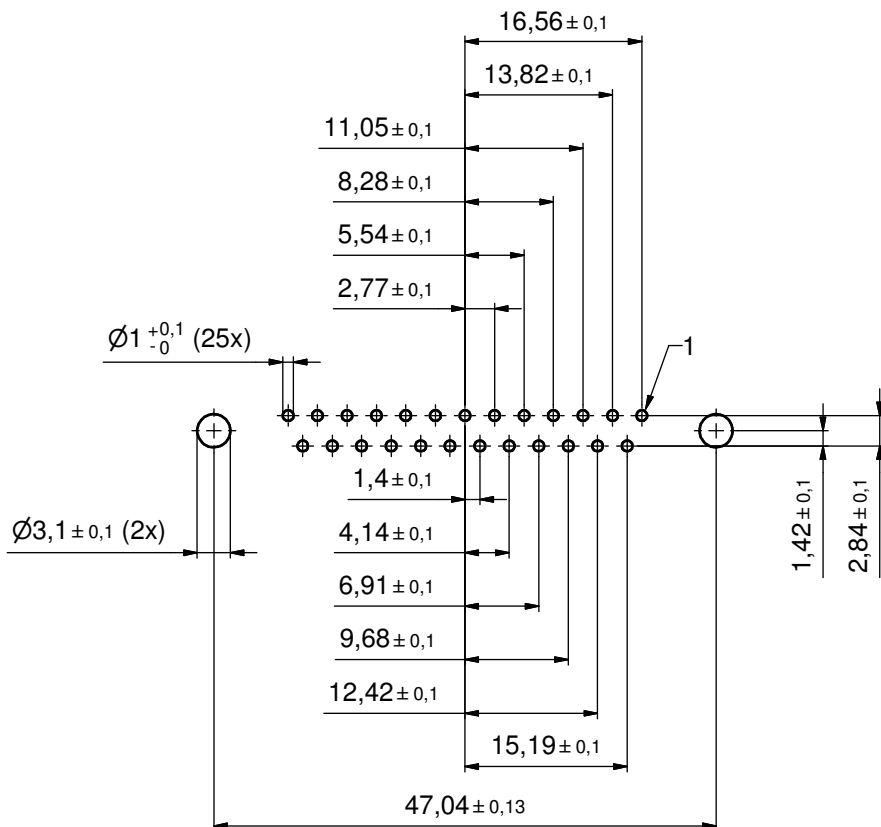

P.C.B. HOLE DRILLINGS  
(P.C.B. TOP SIDE)

THIS DRAWING MAY NOT BE COPIED OR REPRODUCED IN ANY WAY, AND MAY NOT BE PASSED ON TO A THIRD PARTY WITHOUT WRITTEN PERMISSION. OWNERSHIP AND COPYRIGHT OF CONEC GmbH DO NOT ALTER CAD DRAWING BY HAND					tolerance		scale: 2:1
					date	name	material: SEE SHEET 1
					drawn	04.07.13 Henneboel	title: P.C.B. HOLE DRILLINGS D-SUB FEMALE 25pos. SOLDER PIN with threaded lock and spacer clip
					appd.	08.07.13 Fischer	
					norm		
					d-old	(b) 16K11IUA	dwg no:
	1 x b	Ä4824	04.07.2013	K.H.			16K1A3271
a	Original			sh: 2/2			
rev.	description	date	name			part no: SEE SHEET 1	