

SPECIFICATION CONTROL DRAWING

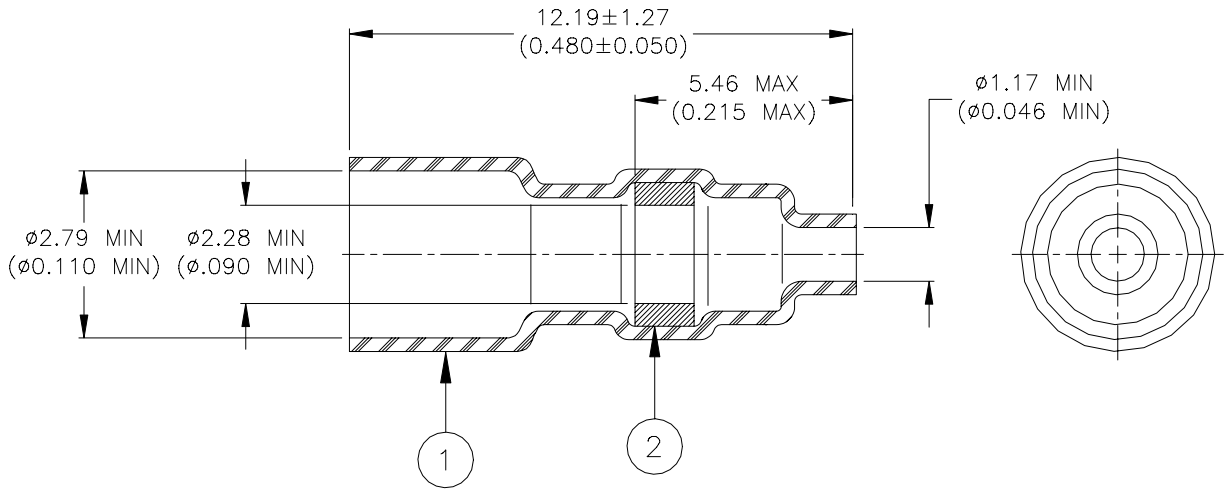

MATERIALS

1. INSULATION SLEEVE: Heat-shrinkable, transparent blue, radiation cross-linked polyvinylidene fluoride.
2. SOLDER PREFORM WITH FLUX:
 SOLDER: TYPE Sn63 per ANSI-J-STD-006.
 FLUX: TYPE ROL1 per ANSI-J-STD-004.

APPLICATION

1. This sleeve is designed to terminate wire combinations from a single 26 AWG to two 20 AWG wires to a 0.64 x 0.64 x 8.00 (0.025 x 0.025 x 0.315) pin.
2. Sleeve will recover to 1.27 (0.050) I.D. max.

| | | | | | | | |
|--|---|---|---|-------------------------|-------------------|-------------------------|--|
| tyco / Electronics / Raychem 307 Constitution Drive Menlo Park, CA 94025, USA | | Wire and Harnessing Products | TITLE : SOLDERSLEEVE, PCB THROUGH TERMINALS | | | | |
| UNLESS OTHERWISE SPECIFIED DIMENSIONS ARE IN MILLIMETERS. INCHES DIMENSIONS ARE BETWEEN BRACKETS. | | | DOCUMENT NO.: D-141-24 | | | | |
| TOLERANCES: 0.00 N/A 0.0 N/A 0 N/A | ANGLES: N/A ROUGHNESS IN MICRON | Tyco Electronics reserves the right to amend this drawing at any time. Users should evaluate the suitability of the product for their application. | DCR NUMBER: D010100 | REPLACES: N/A | | | |
| DRAWN BY: M. FORONDA | DATE: 04-Apr.-01 | PROD. REV. G | DOC ISSUE: 1 | SCALE: None | SIZE: A | SHEET: 1 of 1 | |

If this document is printed it becomes uncontrolled. Check for the latest revision.