

RECOMMENDED PCB LAYOUT

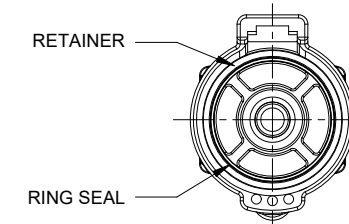
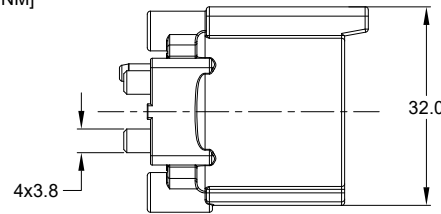
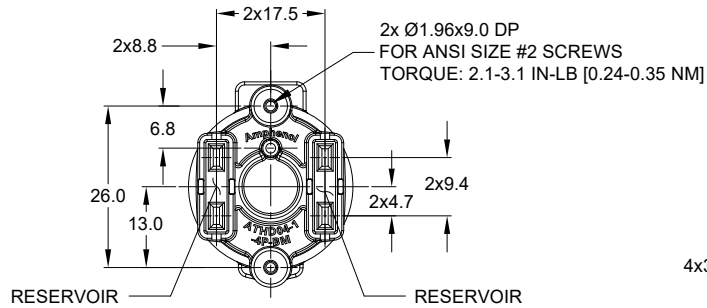
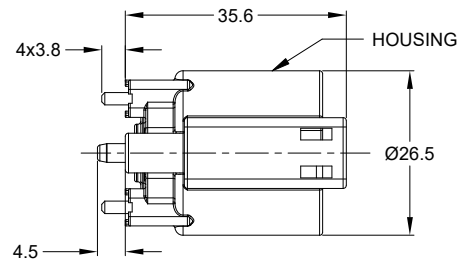

REVISIONS					
REV	ECO	DESCRIPTION	DATE	BY	APPR
A1	-	RELEASED DRAWING	JUN-15-22	VITO	TOMMY

NOTES: UNLESS OTHERWISE SPECIFIED

- MATERIAL:
HOUSING, RETAINER: THERMOPLASTIC; COLOR: BLACK
CONTACT: COPPER ALLOY
SEAL: SILICONE RUBBER
- MODIFICATIONS: BOARDLOCK,SELF-THREADING
- SPECIFICATIONS:
3.1 CURRENT RATING:100 AMPS
3.2 OPERATING TEMPERATURE: -55°C TO +125°C
3.3 DIELECTRIC WITHSTANDING VOLTAGE: LESS THAN 2 MILLIAMPS CURRENT LEAKAGE @ 1500 VOLTS AC.
3.4 INSULATION RESISTANCE: 1000 MEGOHMS MIN @ 25°C.
3.5 MOISTURE RESISTANCE:
IP68(1M OF WATER FOR A PERIOD OF 24 HOURS,MATED CONDITION);
IP69K (MATED CONDITION)
3.6 MATING CYCLE DURABILITY: 100 CYCLES
3.7 RoHS COMPLIANT
- MATING PART: ATHD06-1-4S-XX PLUG(XX = MODIFICATIONS)
- ALL DIMENSIONS ARE FOR REFERENCE USE ONLY.

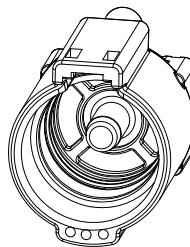
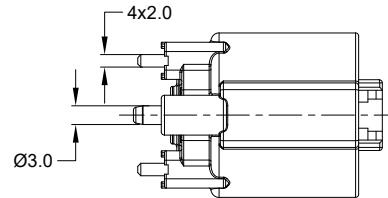

ATHD04-1-4P-BM1X VARIANTS			
CONTACT PLATING	POTTING OR NOT IN RESERVOIR	PART NUMBER	WEIGHT (GRAMS)
MATING END: GOLD PCB END: TIN	NO POTTING	ATHD04-1-4P-BM11	23.8
MATING END: GOLD PCB END: TIN	POTTING	ATHD04-1-4P-BM12	25.6
MATING END: NICKEL PCB END: TIN	NO POTTING	ATHD04-1-4P-BM13	23.8
MATING END: NICKEL PCB END: TIN	POTTING	ATHD04-1-4P-BM14	25.6

QUANTITY	ATHD04-1-4P-BM1X PART NUMBER	DESCRIPTION	ITEM

MATERIALS LIST			
UNLESS OTHERWISE SPECIFIED 1) All dimensions are in metric(mm). 2) Tolerances are as follows: 1 PL DEC ±0.30 Fractions ±1/64 2 PL DEC ±0.15 Angles ±1° 3 PL DEC ±0.08 3) Note reference =		SIGNATURES DATE DRAWN: VITOLJ JUN-15-22 CHECKED: SULLENZHANG JUN-16-22 ENGINEER: APPROVAL: TOMMYXIE JUN-17-22	
MATERIAL SPECIFICATIONS: PROCESS SPECIFICATIONS: NEXT ASSY:		Amphenol Sine Systems - www.amphenol-sine.com 44724 Morley Drive Clinton Township, MI 48036 SINGLE POS, RECEPTACLE, PIN, SIZE 4, BOARDLOCK,ATHD SERIES,SELF-THREADING	
SIZE	TYPE	DWG NO.	REVISION
B	C-	ATHD04-1-4P-BM1X	A1
SCALE: NONE		SHEET 1 OF 1	

TITLE: SINGLE POS, RECEPTACLE, PIN, SIZE 4, BOARDLOCK,ATHD SERIES,SELF-THREADING
DWG NO.: ATHD04-1-4P-BM1X
REV: A1
SH: 1
OF: 1