

THIS DRAWING IS A CONTROLLED DOCUMENT.

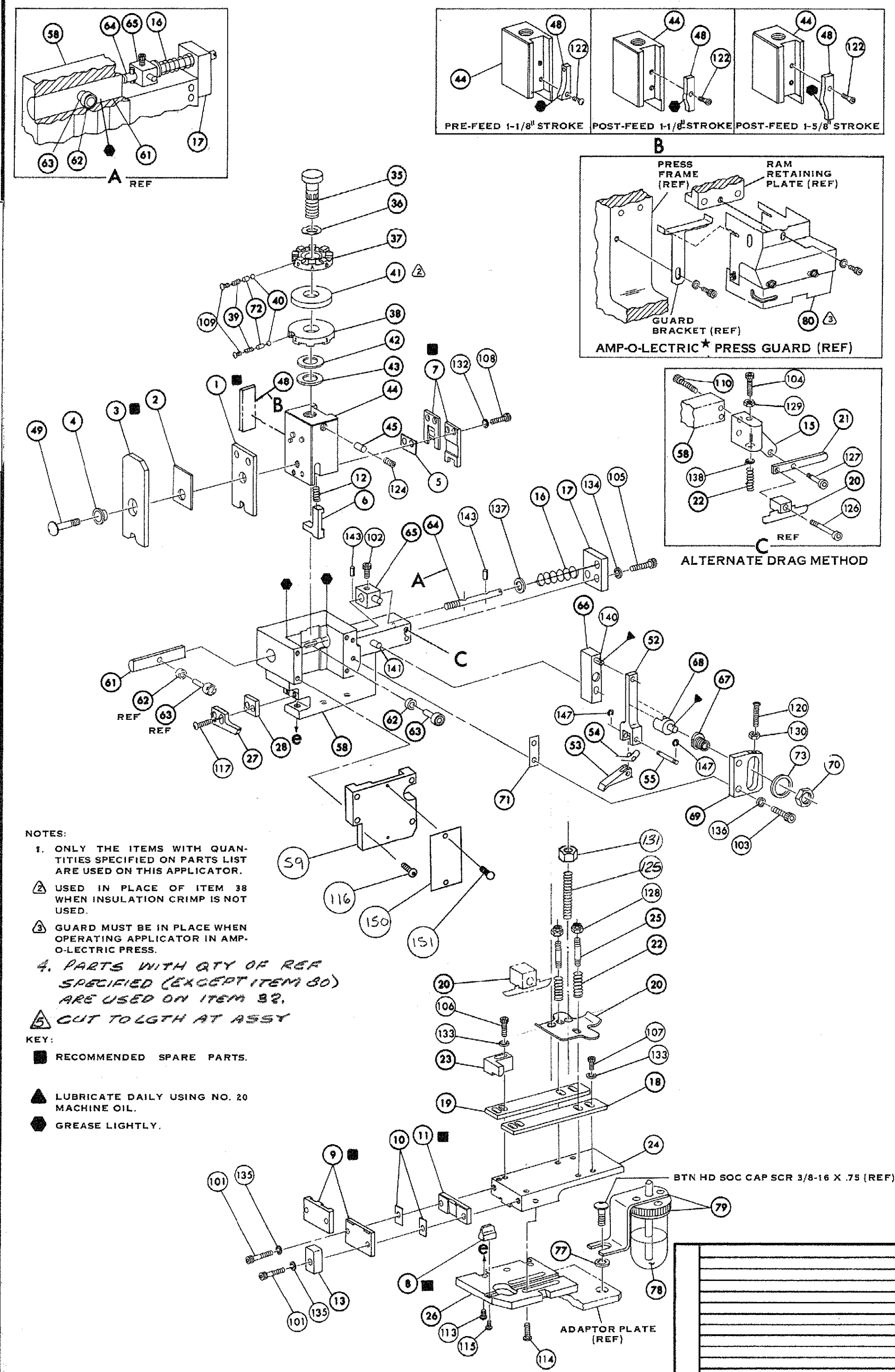

- NOTES:**
- ONLY THE ITEMS WITH QUANTITIES SPECIFIED ON PARTS LIST ARE USED ON THIS APPLICATOR.
 - USED IN PLACE OF ITEM 38 WHEN INSULATION CRIMP IS NOT USED.
 - GUARD MUST BE IN PLACE WHEN OPERATING APPLICATOR IN AMP-O-LECTRIC PRESS.
 - PARTS WITH QTY OF REF SPECIFIED (EXCEPT ITEM 80) ARE USED ON ITEM 82.
 - CUT TO LGTH AT ASSY
- KEY:**
- RECOMMENDED SPARE PARTS.
 - LUBRICATE DAILY USING NO. 20 MACHINE OIL.
 - GREASE LIGHTLY.

REQ.	PART NO.	DESCRIPTION	NO.	REQ.	PART NO.	DESCRIPTION	NO.
			162	REF	690517-1	SPACER	71
			161		22594-8	HEX. NUT	70
			160		240628-1	PLATE, ADJ	69
			159		240626-1	SHAFT, PIVOT	68
			158		240633-1	BUSHING	67
			157		455680-1	LEVER, INTERMEDIATE	66
			156		240629-1	BLOCK, PIVOT	65
			155		240632-2	SCREW, ADJ	64
			154		240659-3	PIN, CAM ROLLER	63
			153		240658-1	CAM, ROLLER	62
			152	REF	454398-1	ROD, FEED	61
			151				60
			150	REF	454220-1	CAP. RAM	59
			149	REF	453736-1	HOUSING	58
			148				57
			147				56
			146	REF	240624-1	PIN, FEED FINGER	55
			145	REF	691999-1	SPRING, FEED FINGER	54
			144	REF	240635-1	FINGER, FEED	53
			143	REF	240634-1	LEVER, TERMINAL	52
			142				51
			141				50
REF	21045-3	RING, RETAINING 'C' (.187 DIA) FEED PIN	140				49
			139				48
			138				47
			137				46
			136				45
			135				44
			134				43
			133				42
			132				41
			131				40
			130				39
			129				38
			128				37
			127				36
			126				35
			125				34
			124				33
			123				32
			122				31
			121				30
REF	3- 21064-2	SCR, RDH HD MACH (6-32 x 1.50) FEED ADJ	120				29
			119				28
			118				27
			117				26
			116				25
			115				24
			114				23
			113				22
			112				21
			111				20
			110				19
			109				18
			108				17
			107				16
			106				15
			105				14
			104				13
			103				12
			102				11
			101				10
			100				9
			99				8
			98				7
			97				6
			96				5
			95				4
			94				3
			93				2
			92				1
REF	458109-1	WASHER, FLAT (SPECIAL)	71				
2	690603-1	SPRING, ASSIST	72				

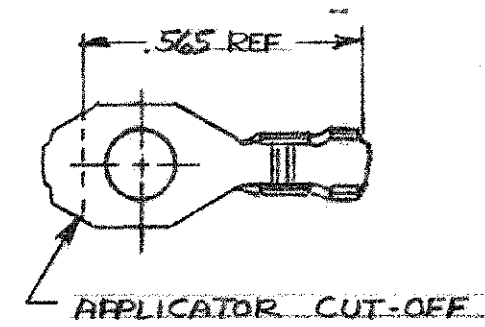

TERM APPL SPEC 114-2084

CRIMPING DATA				THIS APPLICATOR WILL APPLY
PAD LETTER	CRIMP HEIGHT	WIRE SIZE	WIRE STRIP LENGTH	
A	.055	#20		42156
B	.053	#22		42445
C	.050	#24		60123
D	.048	#26		60124
				60968
CRIMP WIRE	SIZE	TYPE	FEED	PRESS REF.
	.080	F		61272
INSULATION	.110	F	.656	61346
INSULATION RANGE	WIRE RANGE	APPLICATOR INSTRUCTION		
.048-.078	26-20	#8039		
REMARKS	AMPOMATOR			

REV.	DATE	DESCRIPTION	BY	CHK	DATE	DESCRIPTION	BY	CHK	DATE
G	0158-0919-04								
F	0158-0656-03								
E	0150-2337-99								
D	0150-7877-97								
C	0150-7491-37								
C	0150-6987-96								
B	ECN A160483								
A	REV. PER ECN R-5525								

SET UP GAGE	LAYOUT NO.	AMP INCORPORATED
458636-1	226	HARRISBURG, PENNA.
APPROVED	LOC	NO.
11/16/73	A	C 687962-1
SCALE NONE	NAME	REV.
	MINIATURE QUICK CHANGE APPLICATOR	G
	END-FEED (SPADE)	