

Electronic housing - ME MAX 17,5 G U-U1 KMGY - 2713515

Please be informed that the data shown in this PDF Document is generated from our Online Catalog. Please find the complete data in the user's documentation. Our General Terms of Use for Downloads are valid (<http://download.phoenixcontact.com>)



Electronic housing consisting of: Housing shells left and right, front plate, transparent cover, metal foot catch and spring, enclosed housing, 3-pos. (1 x 3 pos.), width: 17.5 mm, color: Light gray

The illustration shows the version ME MAX 17,5 2-2 KMGY (open housing) with DIN rail connector plugged in

Product Features

- DIN rail bus connector as an option
- Labels for additional labeling as an option
- Plug-in connection with screw, spring-cage or fast connection technology
- Large front surface for high-pos. plugs or operating and setting elements
- Large PCB surface despite compact housing dimensions
- Easy module replacement without interrupting the contact chain
- The fitted cover is easy to adapt and print
- Transparent front cover can be swiveled
- Fixed or plug-in connection technology can be combined on up to three connection levels, with different pitches
- Functional earth ground contact as an option



Key commercial data

| | |
|--------------------------------------|-----------|
| Packing unit | 1 1 |
| Minimum order quantity | 10 1 |
| Weight per Piece (excluding packing) | 57.21 GRM |
| Custom tariff number | 85369010 |
| Country of origin | Germany |

Technical data

General

| | |
|--------------|------------------|
| Housing type | Complete housing |
|--------------|------------------|

Electronic housing - ME MAX 17,5 G U-U1 KMGY - 2713515

Technical data

General

| | |
|------------------|------------|
| Housing material | Polyamide |
| Color | light gray |

Ambient conditions

| | |
|---------------------------------|-------------------|
| Ambient temperature (operation) | -40 °C ... 105 °C |
|---------------------------------|-------------------|

Dimensions

| | |
|-----------------------|----------|
| Length | 99 mm |
| Constructional height | 114.5 mm |
| Width | 17.5 mm |

Technical data

| | |
|---------------------------------------------------------------|-------------|
| Inflammability class according to UL 94 | V0 |
| Power dissipation at 20°C in the horizontal mounting position | 4.9 W 8.9 W |
| Number of positions | 3 |

Classifications

eCl@ss

| | |
|------------|----------|
| eCl@ss 4.0 | 27180401 |
| eCl@ss 4.1 | 27180401 |
| eCl@ss 5.0 | 27180506 |
| eCl@ss 5.1 | 27180506 |
| eCl@ss 6.0 | 27180802 |
| eCl@ss 7.0 | 27182702 |
| eCl@ss 8.0 | 27182702 |

ETIM

| | |
|----------|----------|
| ETIM 2.0 | EC001031 |
| ETIM 3.0 | EC001031 |
| ETIM 4.0 | EC001031 |
| ETIM 5.0 | EC001031 |

UNSPSC

| | |
|---------------|----------|
| UNSPSC 6.01 | 31261501 |
| UNSPSC 7.0901 | 31261501 |
| UNSPSC 11 | 31261501 |
| UNSPSC 12.01 | 31261501 |
| UNSPSC 13.2 | 31261501 |

Electronic housing - ME MAX 17,5 G U-U1 KMGY - 2713515

Approvals

Approvals

Approvals

UL Recognized / cUL Recognized / cULus Recognized

Ex Approvals

Approvals submitted

Approval details

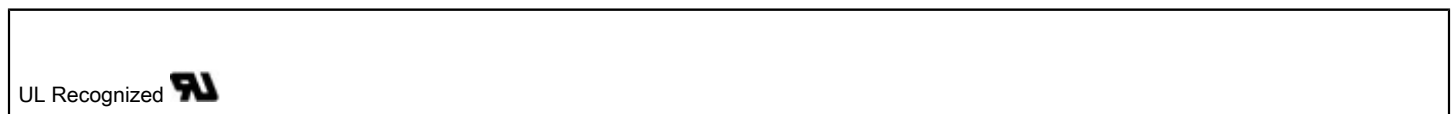

Accessories

Accessories

Ground contact

Electronic housing - ME FE-CONTACT - 2908294



Functional earth ground contact, for intermediate elements.

Drawings

Electronic housing - ME MAX 17,5 G U-U1 KMGY - 2713515

Dimensioned drawing

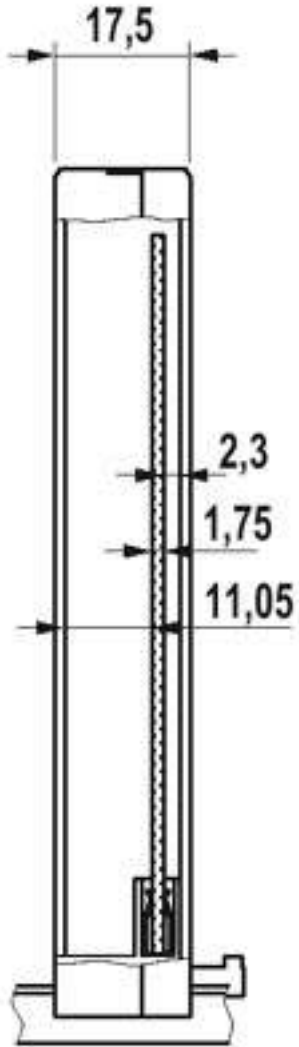

Dimensioned drawing

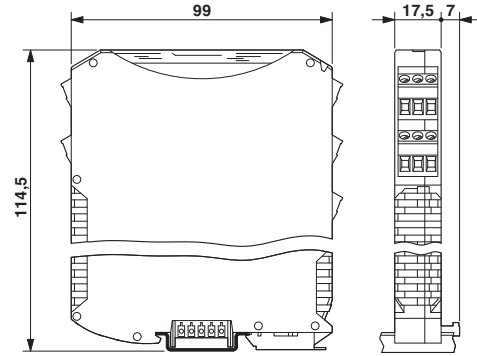

Electronic housing - ME MAX 17,5 G U-U1 KMGY - 2713515

Drilling diagram

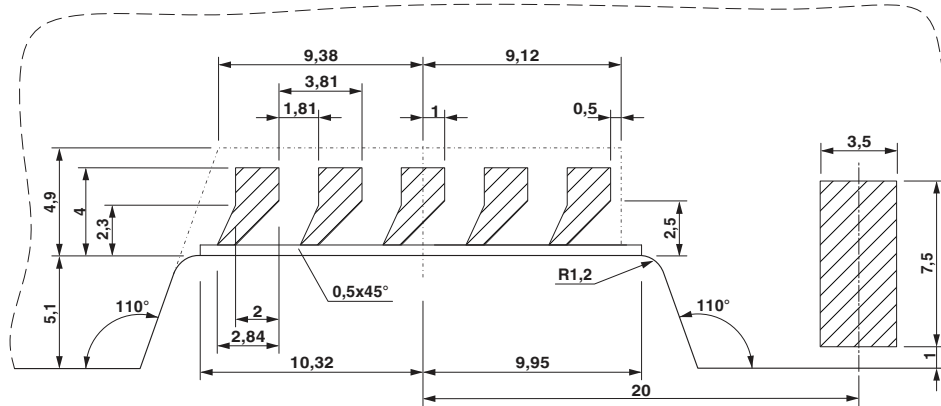

Detailed dimensional drawing of the DIN rail connector contact pads

Electronic housing - ME MAX 17,5 G U-U1 KMGY - 2713515

Explosion drawing

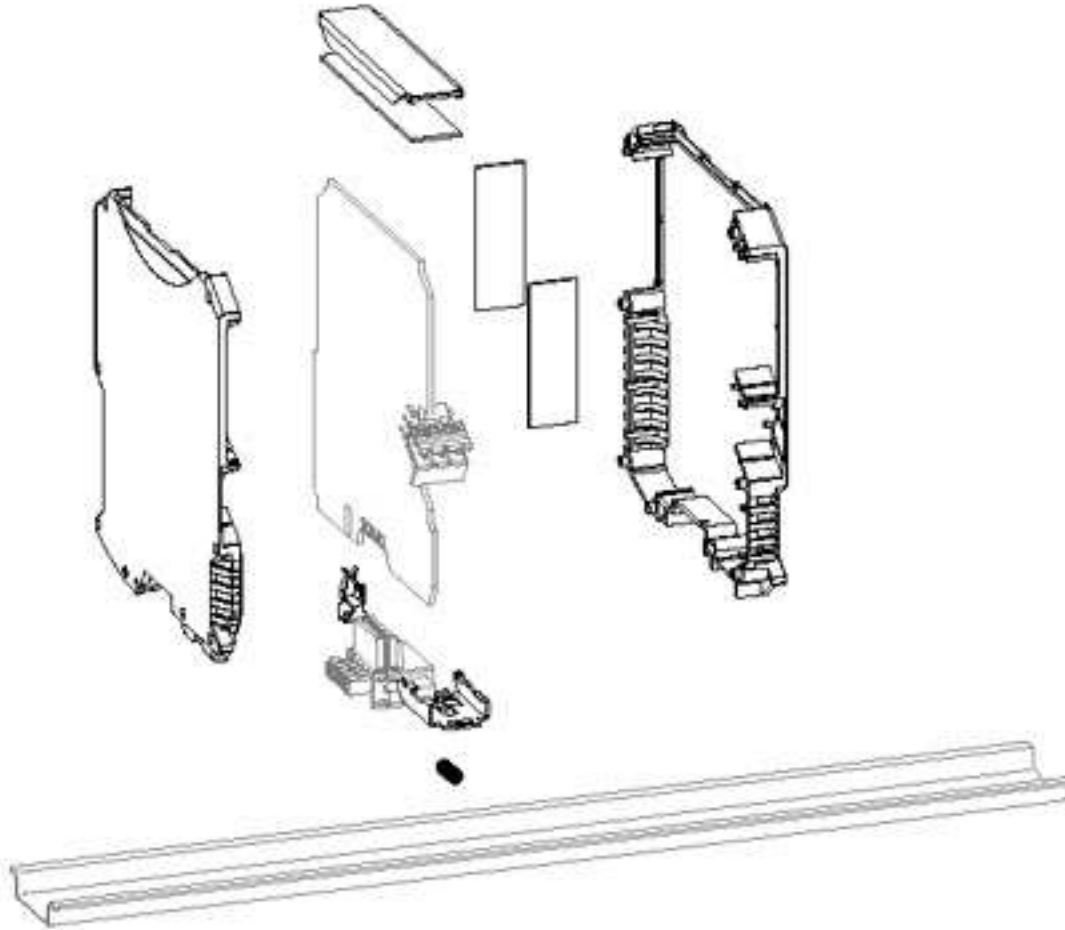

The illustration shows a version of the product (open housing) with accessories

Electronic housing - ME MAX 17,5 G U-U1 KMGY - 2713515

Dimensioned drawing

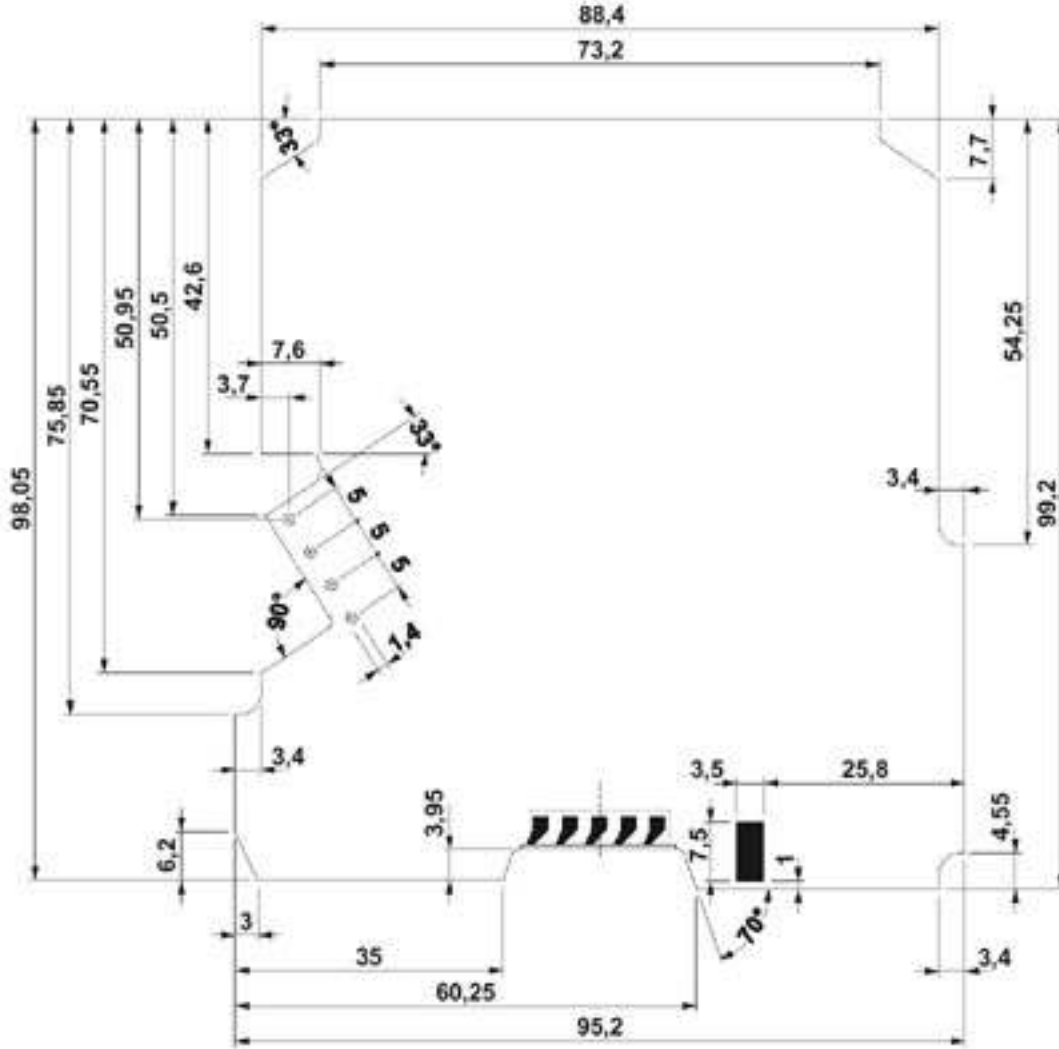

Dimensional drawing of the ME MAX U-U1 printed circuit board, for printed circuit terminal block connection (MKDSO), view: component side