

PART NUMBER	REV	TERMINATOR	FEED TYPE	DESCRIPTION
1528898-1	B	LEADMAKER	MECH POST FEED	CUTS CARRIER
1528898-2	B	BENCH	MECH PRE FEED	CUTS CARRIER
1528898-6	B	LEADMAKER	MECH POST FEED	CONTINUOUS CARRIER
7-1528898-1	B	LEADMAKER	MECH POST FEED	-1 AND SPARE PARTS
7-1528898-2	B	BENCH	MECH PRE FEED	-2 AND SPARE PARTS
7-1528898-6	B	LEADMAKER	MECH POST FEED	-6 AND SPARE PARTS
7-1528898-7	A	-	-	SPARE PARTS KIT

CRIMP	SIZE	TYPE	RANGE
WIRE	2.95 [1.116 IN]	F	1.00-2.00mm ²
INSUL	4.27 [1.168 IN]	O	3.96 MAX [1.156 IN MAX]
WIRE STRIP LENGTH	5.60 [1.220 IN]		

TE TERM PN	MANUF TERM PN	TE SEAL PN	MANUF SEAL PN
286510-1	12124580	286965-1	12015323
286638-1	12124582	286965-1	12015323

WIRE SIZE	CRIMP HEIGHT	REF SETTING
2.00mm ²	1.55 ± 0.05 [0.061 ± 0.002 IN]	C 3
1.50mm ²	1.45 ± 0.05 [0.057 ± 0.002 IN]	D 1
1.00mm ²	1.40 ± 0.05 [0.055 ± 0.002 IN]	D 3

- △ RECOMMENDED SPARE PARTS.
- 2. GREASE RAM, CAM, CAM FOLLOWER AND FEED ROD LIGHTLY.
- △ CERTAIN TERMINALS REQUIRE LUBRICATION. REFER TO THE APPLICATOR INSTRUCTION SHEET FOR MORE INFORMATION.
- 4. LUBRICATE DAILY PER THE APPLICATOR INSTRUCTION SHEET SUPPLIED WITH THE APPLICATOR.
- △ THIS APPLICATOR APPLIES TERMINAL WITH A SEAL. INSULATION DIA QUOTED IS THAT OF THE TERMINAL. WIRE INSULATION DIA IS DEPENDENT ON SEAL BEING APPLIED. SEAL PN 286965-1 INS. DIA RANGE IS 2.03-2.85 [0.080-.112 IN].
- △ APPLY TORQ-SEAL IN ALLEN SOCKET TO FILL HOLE AFTER FLAT HD HAS BEEN ADJUSTED TO CORRECT HEIGHT AT QUALIFICATION. APPLY #1-23419-5 LOC-TITE TO THREADS.
- △ ALL CRIMP DATA SUPPLIED BY THE TERMINAL MANUFACTURER.
- △ TERMINAL MANUFACTURERS INSULATION CRIMP HEIGHT IS NOT RECOMMENDED BY TYCO ELECTRONICS UK LTD.

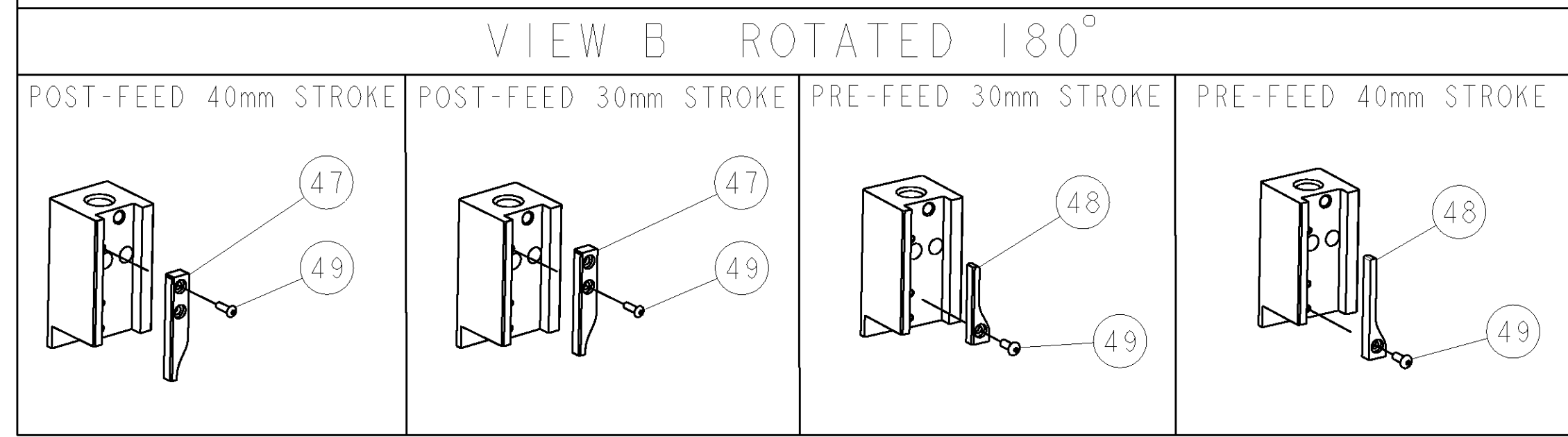
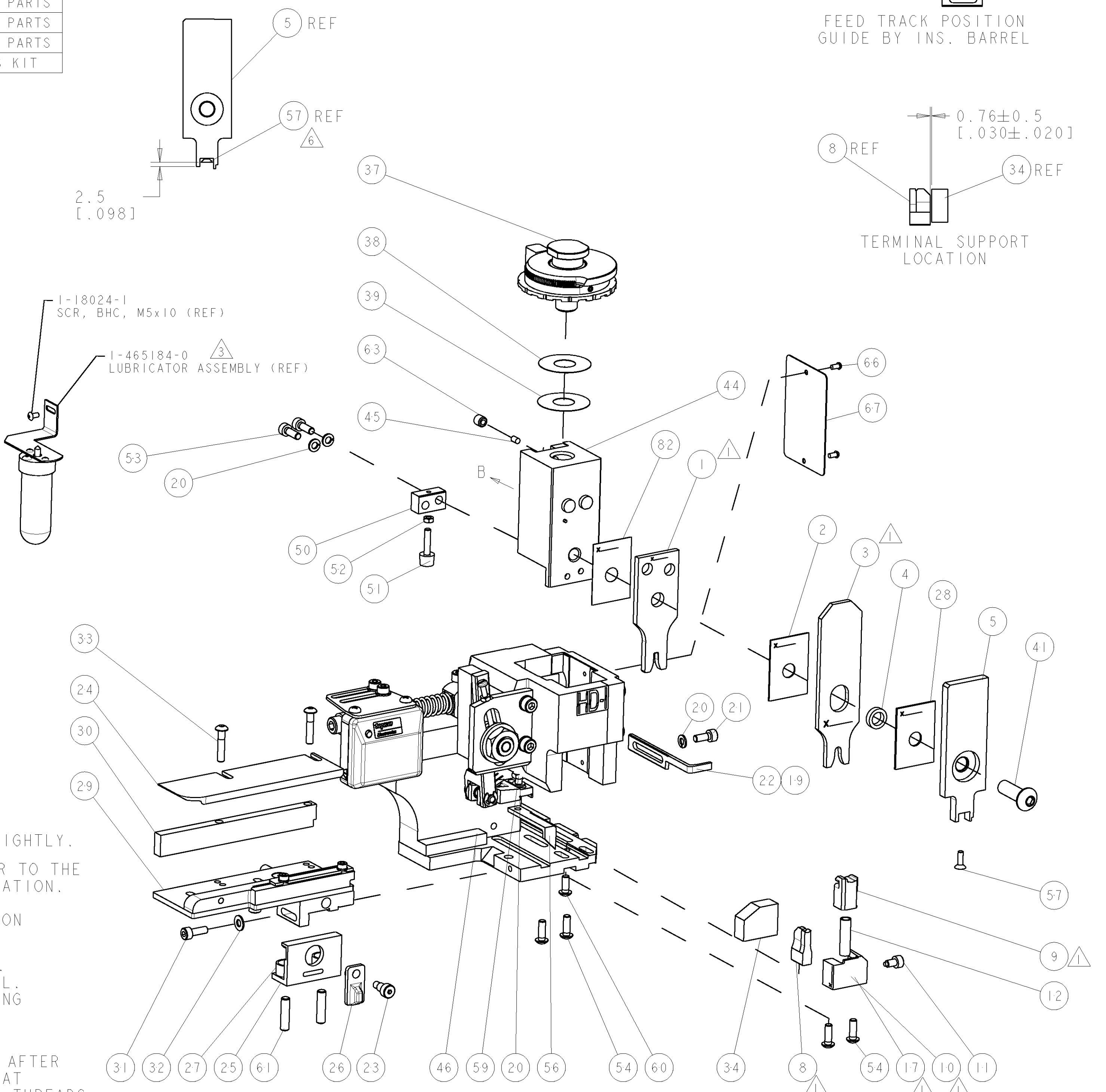

QTY	PART NO	DESCRIPTION	ITEM NO						
-	-	-	84						
-	-	-	83						
-	-	-	82						
-	-	-	81						
-	-	-	80						
-	-	-	79						
-	-	-	78						
-	-	-	77						
-	-	-	76						
-	-	-	75						
-	-	-	74						
-77	-76	-72	-71	-6	-2	-1	PART NO	DESCRIPTION	ITEM NO

SET UP GAGE 458637-3

LOC	DIST	REV	DATE	BY	APPV
A	66		05JUN2008	LJL	MC
B			11NOV2009	MY	TE

REV		DESCRIPTION	DATE	BY	APPV
A	SEE ECO-08-014080		05JUN2008	LJL	MC
B	ECR-09-024660		11NOV2009	MY	TE

QTY	PART NO	DESCRIPTION	ITEM NO						
-	-	-	73						
-	-	-	72						
-	-	-	71						
-	-	-	70						
-	-	-	69						
-	-	-	68						
-	-	-	67						
-	-	-	66						
-	-	-	65						
-	-	-	64						
-	-	-	63						
-	-	-	62						
-	-	-	61						
-	-	-	60						
-	-	-	59						
-	-	-	58						
-	-	-	57						
-	-	-	56						
-	-	-	55						
-	-	-	54						
-	-	-	53						
-	-	-	52						
-	-	-	51						
-	-	-	50						
-	-	-	49						
-	-	-	48						
-	-	-	47						
-	-	-	46						
-	-	-	45						
-	-	-	44						
-	-	-	43						
-	-	-	42						
-	-	-	41						
-	-	-	40						
-	-	-	39						
-	-	-	38						
-	-	-	37						
-	-	-	36						
-	-	-	35						
-	-	-	34						
-	-	-	33						
-	-	-	32						
-	-	-	31						
-	-	-	30						
-	-	-	29						
-	-	-	28						
-	-	-	27						
-	-	-	26						
-	-	-	25						
-	-	-	24						
-	-	-	23						
-	-	-	22						
-	-	-	21						
-	-	-	20						
-	-	-	19						
-	-	-	18						
-	-	-	17						
-	-	-	16						
-	-	-	15						
-	-	-	14						
-	-	-	13						
-	-	-	12						
-	-	-	11						
-	-	-	10						
-	-	-	9						
-	-	-	8						
-	-	-	7						
-	-	-	6						
-	-	-	5						
-	-	-	4						
-	-	-	3						
-	-	-	2						
-	-	-	1						
-77	-76	-72	-71	-6	-2	-1	PART NO	DESCRIPTION	ITEM NO

DIMENSIONS: mm [IN]		TOLERANCES UNLESS OTHERWISE SPECIFIED:	
Ø	PLC	±	
	PLC	±	
	PLC	±	
	PLC	±	
	ANGLES	±	

MATERIAL	FINISH	WEIGHT	SCALE	SHEET	OF	REV
			3:5	1	1	B

CUSTOMER ACCESSIBLE PRODUCTION DRAWING