

## HC-D 25-SML-57/M2PG16

Order No.: 1772489

The illustration shows version HC-D 25-SML-57/M 1 PG 16

<http://eshop.phoenixcontact.de/phoenix/treeViewClick.do?UID=1772489>

Box mounting base, with single locking latch, height 57 mm, with screw connection, 2x Pg16

### Commercial data

GTIN (EAN)	 4 017918 037154
Note	Made-to-order
sales group	D011
Pack	10 pcs.
Customs tariff	85389099
Catalog page information	Page 513 (PC-2009)

### Product notes

WEEE/RoHS-compliant since:  
03/01/2006



<http://www.download.phoenixcontact.com>  
Please note that the data given here has been taken from the online catalog. For comprehensive information and data, please refer to the user documentation. The General Terms and Conditions of Use apply to Internet downloads.

### Technical data

#### General data

Note	For contact inserts HC-D25, A16
Design	D25
Height	57 mm
Width	50 mm
Length	109.5 mm

Housing type	Box mounting bases
Locking type	With single locking latch
Type of the screw connection	2x Pg16
Pg screw connection	With
Wrench size, union nut	22 mm
External cable diameter	7.5 mm ... 15 mm
Degree of protection	IP65
Ambient temperature (operation)	-40 °C ... 125 °C
Housing material	Aluminum, die-cast
Housing surface material	Powder-coated, gray
Cable gland material	Nickel-plated brass
Cable seal material	NBR
Material lock	Steel, galvanized

### Certificates / Approvals



Certification

GOST

### Diagrams/Drawings

Dimensioned drawing

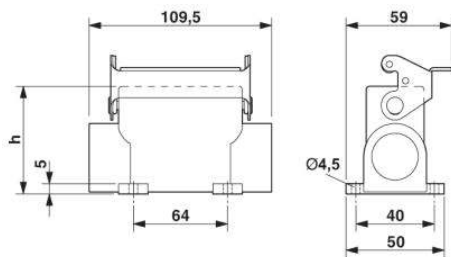

**Address**

PHOENIX CONTACT Inc., USA  
586 Fulling Mill Road  
Middletown, PA 17057, USA  
Phone (800) 888-7388  
Fax (717) 944-1625  
<http://www.phoenixcon.com>



© 2010 Phoenix Contact  
Technical modifications reserved;