

PART NUMBER	REV	FIRST USED
567901-1	A	854040-3

TERMINAL NAME:		CRIMPING DATA	
PLUG CONTACT,	POWER, POWER MIX	VISIBLE PAD LTR	WIRE SIZE
	786795	A	NOT USED
		B	.050 ±.002 0.8mm ² (18)
		C	NOT USED
		D	NOT USED
CRIMP	SIZE	TYPE	RANGE
WIRE	.080	F	0.8mm ²
INSUL	.100	0	1.52-2.03
FEED	APPL INST	SET UP GAGE	LAYOUT
.354	AI-	-	L1494
TERM APPL SPEC	-	WIRE STRIP LENGTH	-

SIM TO HDM 567493-2					
REF	QTY	DESCRIPTION	PART NO	ITEM NO	
				70	
				69	
				68	
				67	
				66	
				65	
				64	
				63	
				62	
				61	
				60	
				59	
				58	
				57	
REF	-	B	694433-8	PAWL, FEED	56
					55
					54
					53
					52
1	-	A	811242-2	BUMPER, HOLDDOWN	51
1	-	A	690753-1	SPACER, TONKER	50
1	-	A	7-21002-9	BOLT, CRIMPER (5/16x1.00)	49
1	-	A	690602-6	CAM, PRE-FEED 1.62 STROKE	48
					47
					46
1	-	A	690191-1	PLUG, NYLON	45
1	-	C	455673-1	RAM	44
1	-	A	690125-1	WASHER, LAMINATED	43
1	-	A	690124-1	WASHER, RAM	42
					41
1	-	A	23241-6	BALL, STEEL	40
1	-	A	690170-1	SPRING, COMPRESSION	39
1	-	C	690142-1	DISC, INSULATION	38
1	-	D	354777-1	WIRE DISC, PLASTIC	37
1	-	A	22480-5	WASHER, SPRING	36
1	-	B	690212-1	POST, RAM	35
1	-	B	690786-1	SUPPORT, TERMINAL	34
1	-	C	462544-1	PLATE, BASE SPECIAL	33
1	-	A	690432-3	SCREW, ADJUSTMENT	32
1	-	B	462543-1	BLOCK, SCREW SPECIAL	31
1	-	B	455689-1	BLOCK, STRIP GUIDE ADJ	30
1	-	C	455671-1	PLATE, STRIP GUIDE	29
1	-	C	2-455888-2	SPACER, FRONT SHEAR DEP	28
2	-	A	1-22284-0	SPRING, DRAG	27
1	-	B	690546-1	LEVER, DRAG RELEASE	26
1	-	B	240792-1	DRAG, TERMINAL	25
1	-	D	6-690504-0	GUIDE, STRIP (REAR)	24
1	-	A	690438-1	GUIDE, STRIP (FRONT)	23
					22
1	-	A	463756-1	GUIDE, SCRAP	21
					20
REF	-	C	462615-1	STRIPPER	19
					18
					17
					16
					15
					14
					13
1	-	A	5-22280-0	SPRING, SHEAR	12
1	-	B	690461-2	STOP, SHEAR (FRONT)	11
1	-	B	462548-1	HOLDER, SHEAR (FRONT) SP	10
1	-	B	462547-1	SHEAR, FLOAT (FRONT) SP	9
1	-	C	5-683403-9	ANVIL	8
					7
					6
1	-	A	462838-1	DEPRESSOR, SHEAR (FRONT) SP	5
1	-	B	238011-6	SPACER, BLOCK CRIMPER	4
1	-	C	4-456135-7	CRIMPER, INSULATION	3
1	-	C	455888-9	SPACER, CRIMPER	2
1	-	C	2-456405-3	CRIMPER, WIRE	1

QTY	REF	DESCRIPTION	PART NO	ITEM NO	
2	-	C	3-354779-8	PIN, WIRE DISC (.3180)D	129
				128	
				127	
				126	
1	-	A	986950-1	WASHER, FLAT PRECISION	125
				124	
1	-	B	690701-2	PLATE, SERIAL NO.	123
				122	
1	-	A	4-21028-0	PIN, SLT SPR (Ø.093x.75) ST GDE PL	121
				120	
2	-	A	21899-2	WASHER, FLAT (#10) S G ADJ BLK	119
				118	
2	-	A	21024-5	WASHER, LOCK (#10) ADJ BLOCK	117
				116	
				115	
2	-	A	21024-2	WASHER, LOCK (#4) FRONT STP GUIDE	114
REF	-	A	21024-4	WASHER, LOCK (#8) FEED FINGER	113
2	-	A	21024-4	WASHER, LOCK (#8) DEP-HOLD	112
REF	-	A	21024-4	WASHER, LOCK (#8) STRIPPER	111
				110	
				109	
1	-	A	21018-5	NUT, HEX (#6) HOLD DOWN	108
				107	
				106	
				105	
				104	
1	-	A	21009-2	SCR, SKT SET (1/4-20x.25 LW) RAM	103
				102	
4	-	A	21017-2	SCR, DRIVE (#2x.19) ID PLATE	101
1	-	B	819347-1	PLATE, IDENTIFICATION	100
2	-	A	3-21002-0	SCR, BHC (10-32x.88) DRAG	99
1	-	A	22733-8	SCR, BHC (8-32x.38 LW) ANVIL	98
				97	
1	-	A	3-21000-8	SCR, SHC (10-32x.88) MOUNTING	96
1	-	A	2-22733-1	SCR, BHC (10-32x.50) S G ADJ BLK	95
4	-	A	22733-9	SCR, BHC (8-32x.50) SHEAR-TERM SUP	94
2	-	A	2-21002-2	SCR, BHC (8-32x.50) R STP GDE	93
				92	
1	-	A	1-21002-7	SCR, SHC (6-32x.50) CAM	91
4	-	A	2-21000-7	SCR, SHC (8-32x.50) SCR BLK	90
				89	
				88	
				87	
REF	-	A	2-22603-0	SCR, HEX HD (8-32x.31) FEED FINGER	86
2	-	A	1-21000-3	SCR, SHC (4-40x.25) F ST GUIDE	85
REF	-	A	22733-9	SCR, BHC (8-32x.50 SL) STRIPPER	84
				83	
				82	
1	-	A	3-21000-4	SCR, SHC (10-32x.38) S G ADJ BL	81
				80	
				79	
				78	
2	-	B	463310-4	BLADE, STRIPPING (#18)	77
				76	
				75	
1	-	A	690603-1	SPRING, ASSIST	74
1	-	A	23030-1	SCR, SKT CAP (6-32x.25) CP DSC	73
				72	
				71	

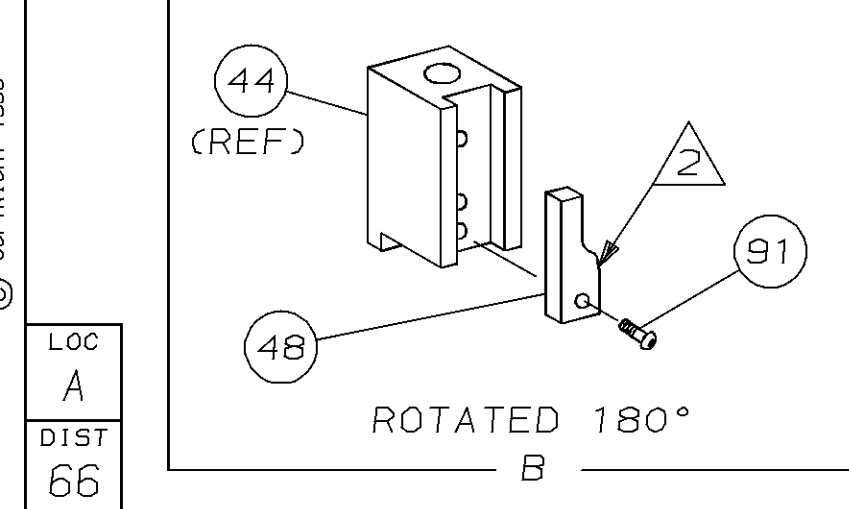
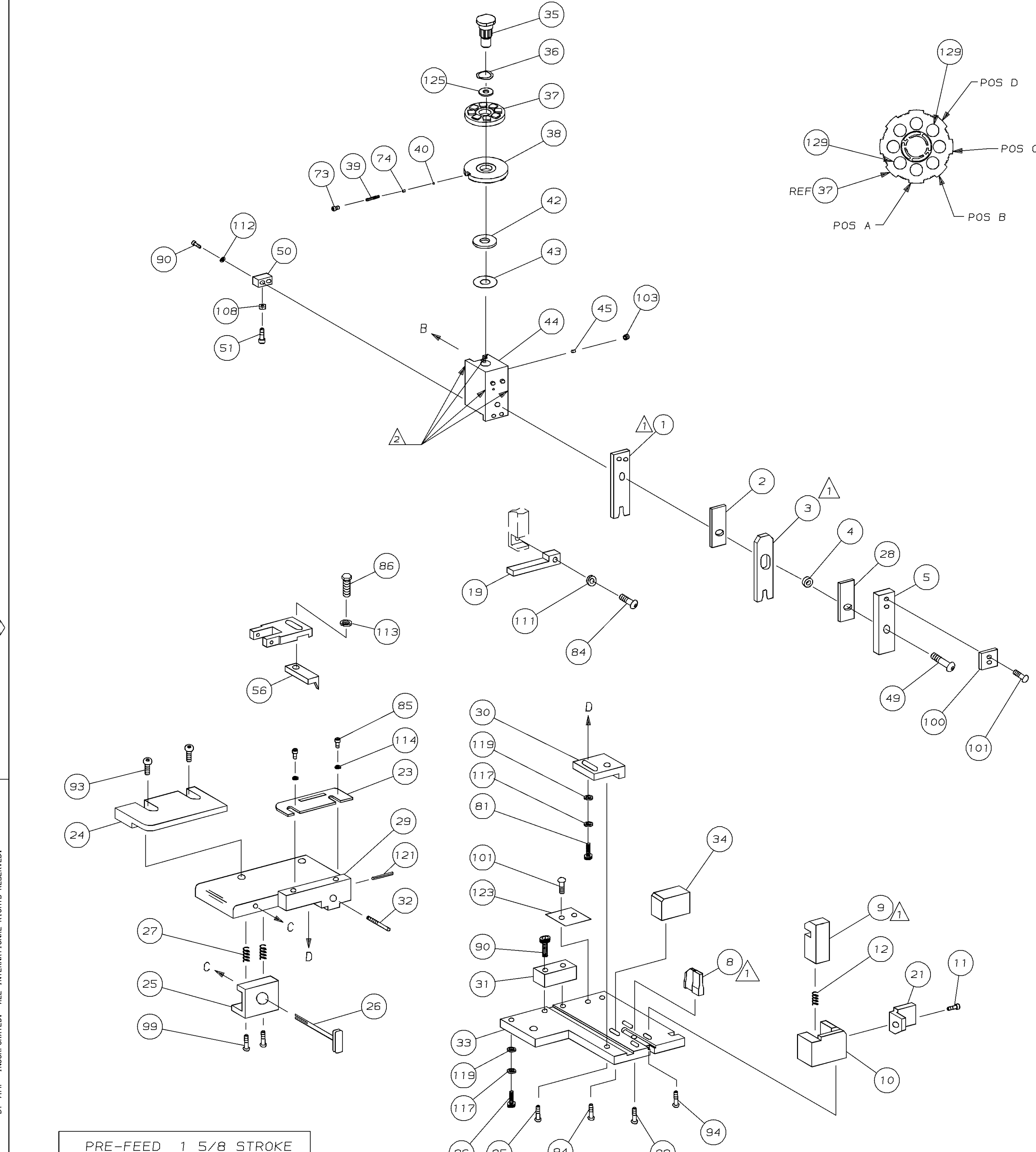

- 1 RECOMMENDED SPARE PARTS.
- 2 GREASE LIGHTLY.
- 3 ITEM NOT SHOWN

QTY REQD PER ASSY	U/M	DWG SIZE	PART NO	DESCRIPTION	ITEM NO
-1	U/M	DWG SIZE			
REVISION OF EACH ASSY NO (WHEN BLANK, USE DWG REVISION)					
PARTS LIST					

QTY REQD PER ASSY	U/M	DWG SIZE	PART NO	DESCRIPTION	ITEM NO
-1	U/M	DWG SIZE			
REVISION OF EACH ASSY NO (WHEN BLANK, USE DWG REVISION)					
PARTS LIST					

DIMENSIONS IN INCHES. DO NOT SCALE PRINT. TOLERANCES UNLESS OTHERWISE SPECIFIED.

2 PLC DEC ± -
3 PLC DEC ± -
4 PLC DEC ± -
ANGLES ± -
SURF TEXTURE: ✓
REMOVE BURRS, BREAK SHARP EDGES R.015 MAX

CAGE CODE 00779

MATL - HT TR - FIN -

DR JC BAKER 8/2/93 APP BA WOLFE 8/3/93
CHK C.ERISMAN 8/24/93 REL B. MORGAN 8/24/93

AMP Incorporated Harrisburg, PA 17105-3608

NAME STRIPPER CRIMPER APPLICATOR MACHINE REF STRIPPER CRIMPER

SCALE - DWG NO 567901 SHEET 1 OF 1 REV A

CUSTOMER AND ASSEMBLY DRAWING RESTRICTED TO

THIS DRAWING IS A CONTROLLED DOCUMENT

THIS DRAWING IS UNPUBLISHED. MAR 5, 1998 RELEASED FOR PUBLICATION BY AMP INCORPORATED. ALL INTERNATIONAL RIGHTS RESERVED. © COPYRIGHT 1998