



Copyright FCI.

A

B

C

D

A

B

C

D

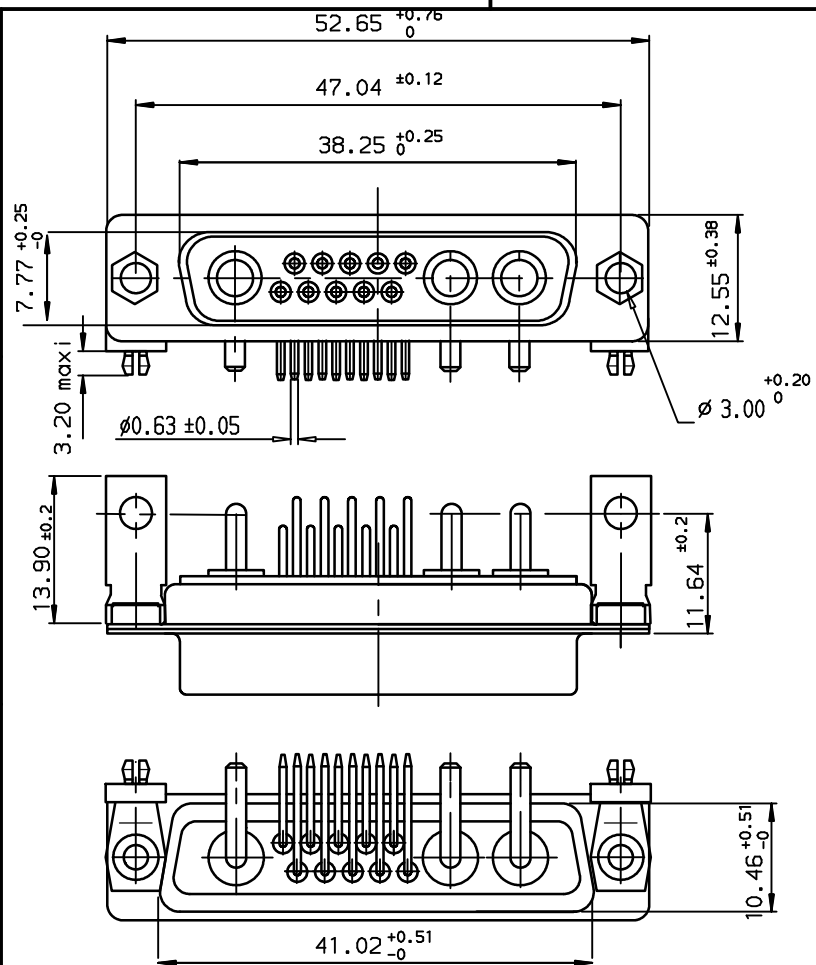

VIEW WITHOUT POWERS CONTACTS

VIEW WITH POWERS CONTACTS

TIN LEAD PART NUMBER

LEAD FREE PART NUMBER

DB13W3S500G30

DB13W3S500G30LF

PART NUMBER

PART NUMBER

LAYOUT DIMENSIONS (after plating)

CONNECTOR SIDE VIEW

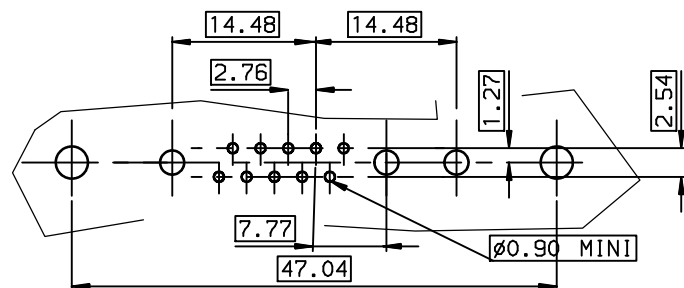

GENERAL CHARACTERISTICS AND ROHS INFORMATIONS:  
SEE DRAWING C01-8639-0000

European Views

www.fciconnect.com		surface ISO 1302 <input checked="" type="checkbox"/>	tolerance std ISO 406 ISO 1101	projection 	mm
TOLERANCES UNLESS OTHERWISE SPECIFIED					
Dr	JARRY	1995/10/16	ANGULAR	0.x $\pm 0.1$	size A3
Eng	PESSON	1995/10/16	LINEAR	0.xx $\pm 0.1$	Scale 2
Chr	LEGARE	1995/10/16	0.xx' $\pm 2'$	0.xxx $\pm 0.1$	ECN LS06-0095
Appr	LEGARE	1995/10/16	Product family	D-SUB	Spec ref -
FCI		title SOCKET CONNECTOR FOR POWERS CONTACTS		fig no C01-8639-0591	Rev. D
catalog no		-		CUSTOMER sheet 1 of 1	

rev	ecn no	dr	date
B	-	BAR	2003/10/29
C	LS05-001	MPE	2005/03/07
D	LS06-0095	LGO	2006/07/19
-	-	-	-
-	-	-	-
-	-	-	-

REV F - 2006-04-17