



1995 MHz Ceramic Bandpass Filter

Part Number: AM1995B1592



ANATECH ELECTRONICS INC
RF & Microwave Filters & Products

Electrical specifications

Center Frequency: 1995 MHz
Bandwidth(BW): 30 MHz
Insertion loss(Fo): 2.5 dB max
Ripple in Bw: 1.0 dB max
VSWR: 1.5:1 Min
Attenuation 1: 50 dB min @1672.8~1702.8 MHz
Attenuation 2: 38 dB min @1826.4~1856.4 MHz
Attenuation 3: 50 dB min @2170~2200 MHz
Group delay variation: 10 nsec max
In/Out Impedance: 50 Ohm
Input power: 3 Watt max

Mechanical

Mounting Method: SMT
Dimensions: 13 X 14 X 4.5 mm

Environmental

Operating Temperature: -45 to +85° C
Storage Temperature: -55 to +95° C
Shock: 20 G. 11ms
Vibration: 20 G. 5 to 200 MHz

This product is RoHs compliant.

Outline Drawing:

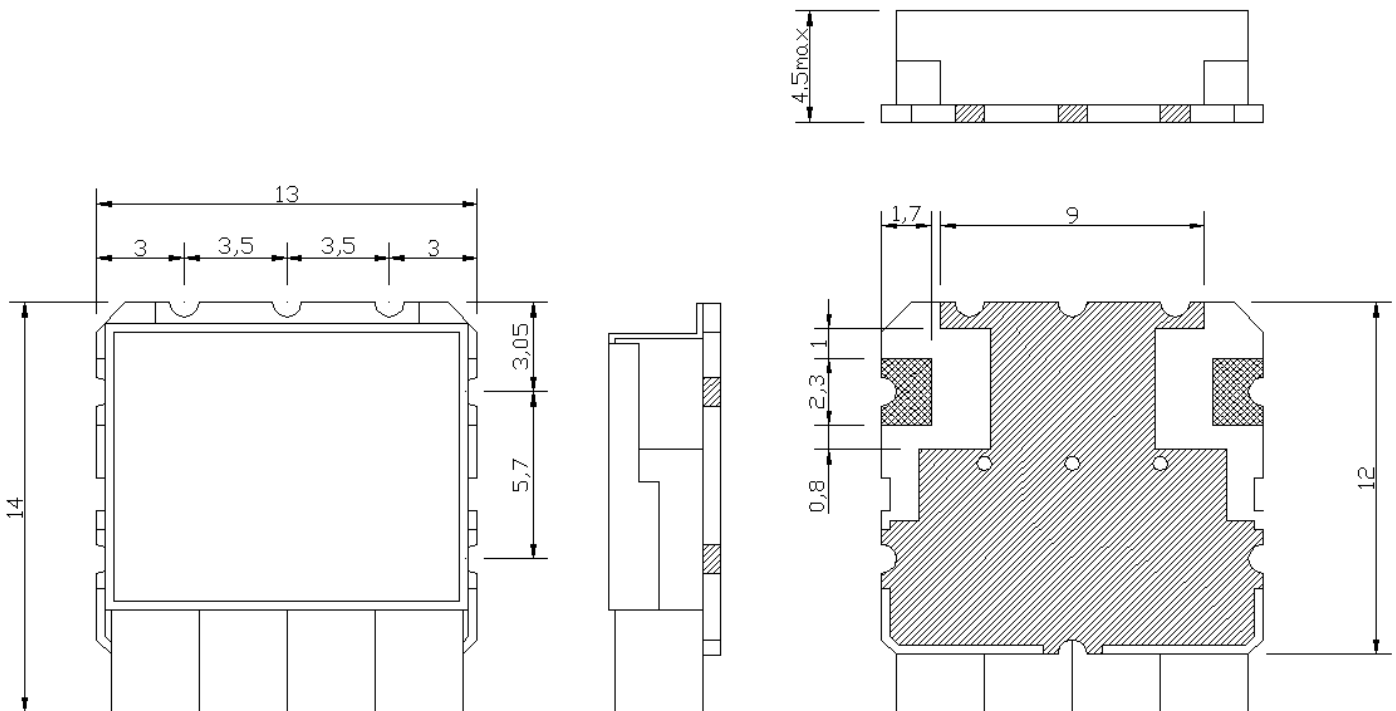

Unit:mm
Tolerance:±0.3