

TOP VIEW

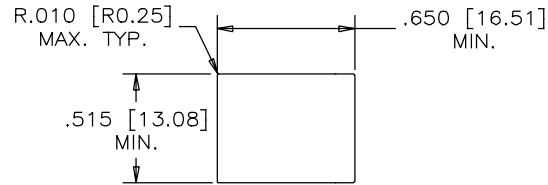

RECOMMENDED PANEL CUTOUT



REVISIONS				
SYM	ZONE	ECN, ERN NO.	DATE	APPRD.
B		REVISE	2005/07/17	L.CHAN
C		REVISE BOTTOM VIEW	2005/07/25	L.CHAN
D		CORRECT DIMENSION AND PACKAGING QUANTITY	2016/01/15	L.CHAN

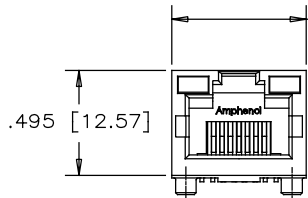

FRONT VIEW

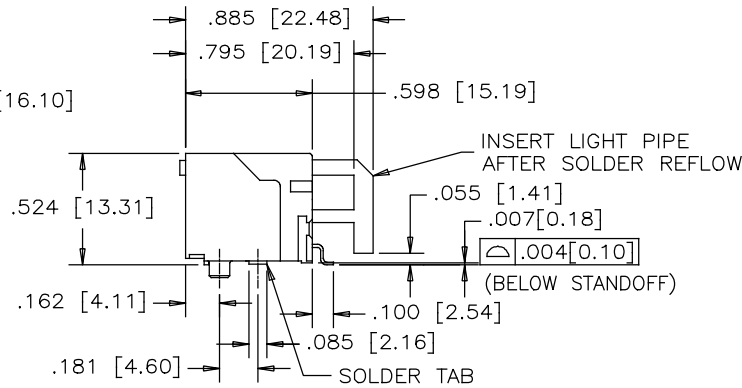

SIDE VIEW

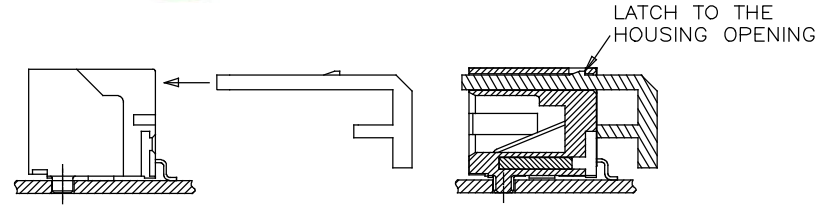

AFTER SOLDER REFLOW, LOAD LIGHT PIPE THROUGH THE CONNECTOR REAR ACCESS IN THE DIRECTION AS SHOWN

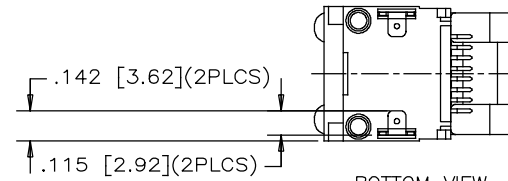

BOTTOM VIEW

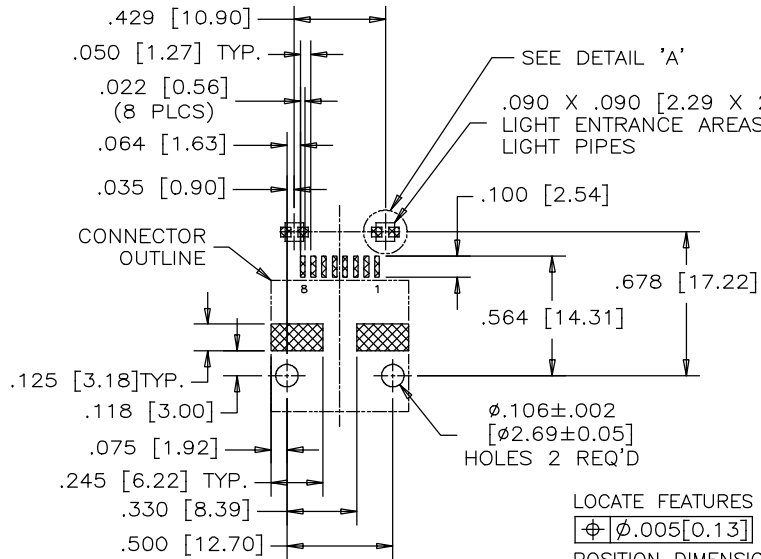

RECOMMENDED P.C.B. LAYOUT (COMPONENT SIDE OF BOARD)

SEE DETAIL 'A'
.090 X .090 [2.29 X 2.29] LIGHT ENTRANCE AREAS OF LIGHT PIPES

Ø.106±.002 [Ø2.69±0.05] HOLES 2 REQ'D

LOCATE FEATURES
⊕ Ø.005 [0.13]
POSITION DIMENSIONS ARE BASIC

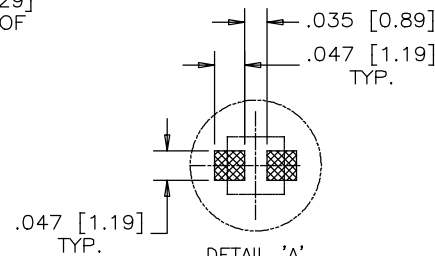

DETAIL 'A' (ENLARGED)
SMT LED SOLDER PAD (SMT LED TO BE PROVIDED BY THE CUSTOMER)

MATERIALS:
PLASTIC HOUSING: ENGINEERING THERMOPLASTIC
FLAMMABILITY RATING UL 94V-0
COLOR: BLACK

CONTACTS: PHOSPHOR BRONZE
PLATING: 20 μ" [0.51 MICRONS] MIN. GOLD ON MATING SURFACES.
50 μ" [1.27 MICRONS] MIN. NICKEL UNDERPLATE.
100 μ" [2.54 MICRONS] MIN. MATTE TIN ON CONTACT TAILS.

LIGHT PIPE: CLEAR POLYCARBONATE
FLAMMABILITY RATING UL 94V-0

PART NUMBER: RJSSE-5081-01T

MATERIAL	DESIGNED	Chigow	DATE	05/07/25	Amphenol Canada Corp. TITLE SURFACE MOUNT MODULAR JACK 8 POSITION, 8 CONTACTS, UNSHIELDED, WITH LIGHT PIPE, TAPE & REEL PACKAGING, RoHS COMPLIANT.
	CHECKED	L.CHAN	05/07/25		
FINISH	I. E. APPRD.				DWG. APPRD. DWG. DRAWING NO. P-RJSSE-5081-01T
	Q. A. APPRD.				
	ENG. REL. NO.				DWG. REF.
	DIMENSIONS ARE IN INCHES [mm]	CODE ID. NO.	03554	SCALE	NTS
					WT. _____
					SURF. _____
					SHEET 1 OF 2

THIS DOCUMENT CONTAINS PROPRIETARY INFORMATION AND SUCH INFORMATION MAY NOT BE DISCLOSED TO OTHERS FOR ANY PURPOSE OR USED FOR MANUFACTURING PURPOSES WITHOUT WRITTEN PERMISSION FROM AMPHENOL CANADA CORP.

REVISIONS				
SYM	ZONE	ECN, ERN NO.	DATE	APPRD.
B		REVISE	2005/07/17	L.CHAN
C		REVISE BOTTOM VIEW	2005/07/25	L.CHAN
D		CORRECT DIMENSION AND PACKAGING QUANTITY	2016/01/18	L.CHAN

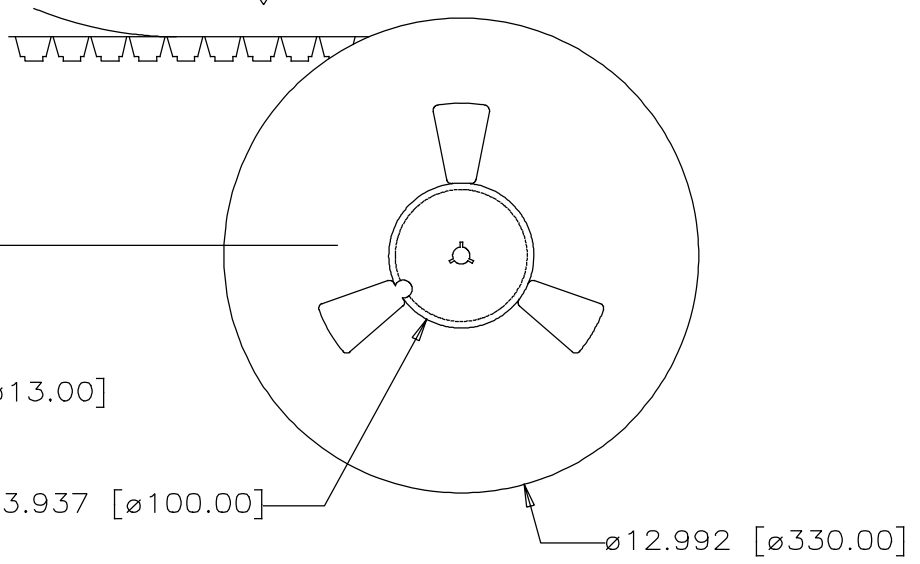
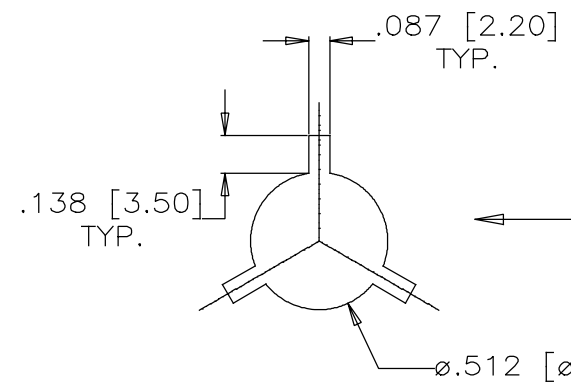
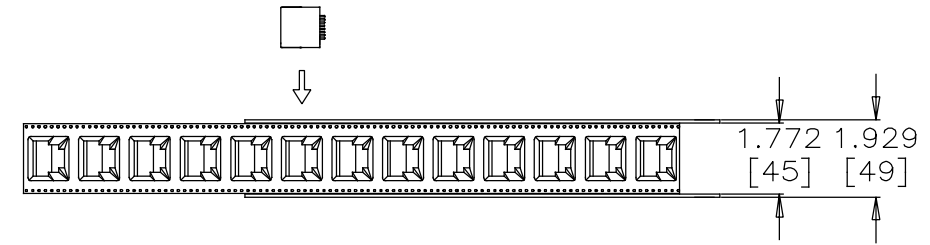
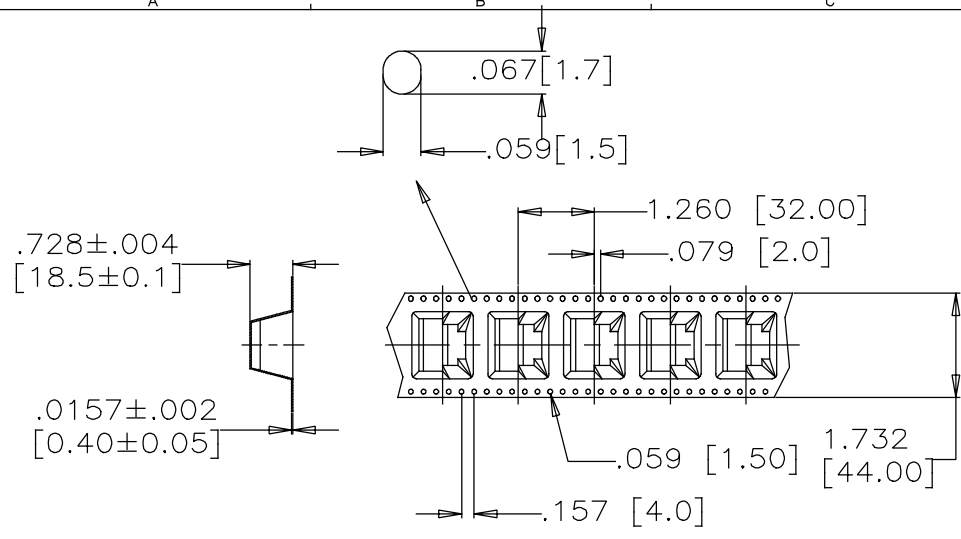

PACKAGING NOTES:

1. ONE REEL SHOULD HOLD 100 CONNECTORS.
2. 10 EMPTY CAVITIES FOR BOTH TOP AND BOTTOM OF THE CARRIER.
3. A FULLY LOADED CARTON SHOULD CONTAIN 5 REELS (500 PCS) OF CONNECTOR.

THIS DOCUMENT CONTAINS PROPRIETARY INFORMATION AND SUCH INFORMATION MAY NOT BE DISCLOSED TO OTHERS FOR ANY PURPOSE OR USED FOR MANUFACTURING PURPOSES WITHOUT WRITTEN PERMISSION FROM AMPHENOL CANADA CORP.

MATERIAL -----	DRAWN <i>Chigow</i>	DATE 05/07/25	Amphenol Canada Corp.		
	DESIGNED				
FINISH -----	CHECKED <i>L.CHAN</i>	05/07/25	TITLE SURFACE MOUNT MODULAR JACK		
	I. E. APPRD.		8 POSITION, 8 CONTACTS, UNSHIELDED, WITH LIGHT PIPE, TAPE & REEL PACKAGING, RoHS COMPLIANT.		
	Q. A. APPRD.		DWG. C	DRAWING NO. P-RJSSE-5081-01T	REV. D
	DWG. APPRD.		SCALE WT. _____ SURF. _____ SHEET 2 of 2		
	ENG. REL. NO.				
	REF.				
DIMENSIONS ARE IN INCHES [mm]		CODE ID. NO. 03554			