

REV.	ECN NO.	DESCRIPTION	SIGN	DATE
C1	N/A	INITIAL DRAWING	Liu	2020/04/29

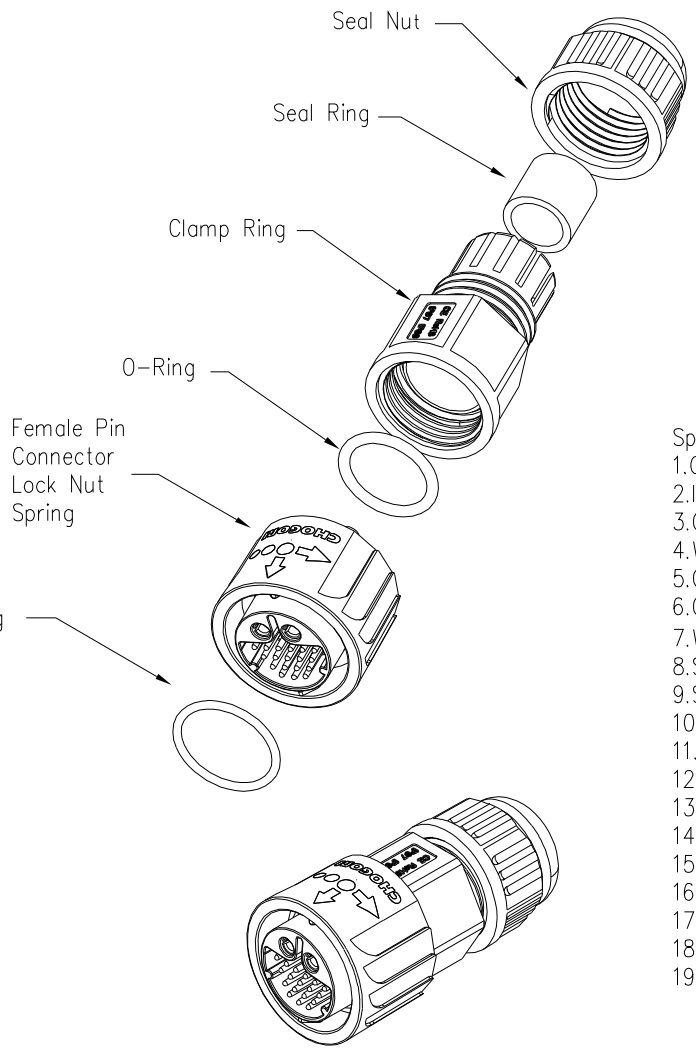

- Specification:
- 1.Operation Temperature: -45°C~105°C.
  - 2.Insulation Resistance:100MΩ at DC500V.
  - 3.Contact Resistance:<10mΩ.
  - 4.Withstand Voltage: 2000V AC
  - 5.Operating Current:20A+2A
  - 6.Operating Voltage:AC 300V
  - 7.Waterproof Rate:IP67 (Mated)
  - 8.Seal Nut:Nylon, Black
  - 9.Seal Ring:Silicon, Black.
  - 10.Clamp Ring:Nylon, Black
  - 11.O-Ring:Silicon, Red
  - 12.Male Pin:Copper Alloy, Gold Plated
  - 13.Female Pin:Copper Alloy, Gold Plated
  - 14.Connector:Nylon+GF, Black
  - 15.Lock Nut:Nylon, Orange
  - 16.Spring:SUS
  - 17.O-Ring:Silicon, Red
  - 18.RoHS Compliant.
  - 19.Mating Cap: 804-00008-00

24218131-01 Cable Range OD  
 01 OD: φ8.0mm~φ10.5mm  
 Pin Number

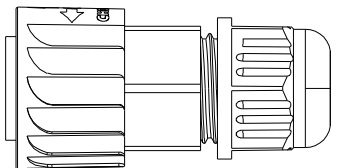
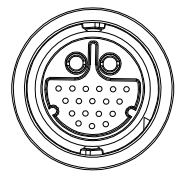
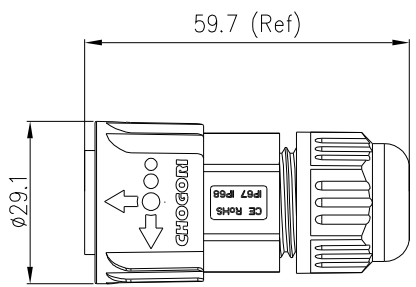
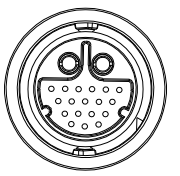

2+18 Pin

P/N: 24218231-01

Pin Assignments  
 Front View

UNIT:mm	DESCRIPTION	Part No	24218231-01	DRAWN BY	Liu	DATE	2020/04/29
TOLERANCE .X ±0.25 .XX ±0.15 .XXX ±0.05 ANGLES ±1°	Large Series Push Lock Male Plug With Male Pin	DWG NO		CHECKED BY	Mo	DATE	2020/04/29
SCALE: 1:1	SHEET 1 OF 1	CUSTOMER		APPROVED BY	Adley	DATE	2020/04/29
REV. C1	SIZE A4						



THIS INFORMATION IS CONFIDENTIAL AND IS DISCLOSED TO YOU ON CONDITION THAT NO FURTHER DISCLOSURE IS MADE BY YOU TO OTHER THAN CHOGORI PERSONNEL WITHOUT AUTHORIZATION FROM CHOGORI CORP.