

THIS DRAWING IS UNPUBLISHED. RELEASED FOR PUBLICATION 20
 © COPYRIGHT 20 ALL RIGHTS RESERVED.

LOC	DIST	REVISIONS			
P	LTR	DESCRIPTION	DATE	DWN	APVD
CE	00	F3	REVISED PER ECO-11-005139	27APR2011	RK HMR

1 MATERIAL:
 CONNECTOR ASSEMBLY:
 CONNECTOR HOUSING: PPSU, COLOR: BEIGE *
 REAR BODY: METAL
 COMPRESSION SPRING: METAL
 FERRULE SUB ASSEMBLY: ZIRCONIA/ METAL
 INTERNAL SPLICE: PEI *
 PLUNGER: METAL
 BOOT: TPE, SEE TABLE FOR COLOR *
 BUILD-UP TUBE: POLYMER
 TERMINATION COVER: PBT, COLOR: BLACK
 PROTECTIVE COVER: VINYL, COLOR: RED
 DUPLEX CLIP: PEI, COLOR: BLACK *

* UL94 V-0 RATED AT QUALIFYING THICKNESS.

2. INSTRUCTION SHEET: 408-8925 AVAILABLE FOR
 DOWNLOAD AT www.tycoelectronics.com/documents
 OR www.amphenolconnect.com/foguide.

3 MARK WITH "50" OR "62", LOCATED
 APPROXIMATELY AS SHOWN.

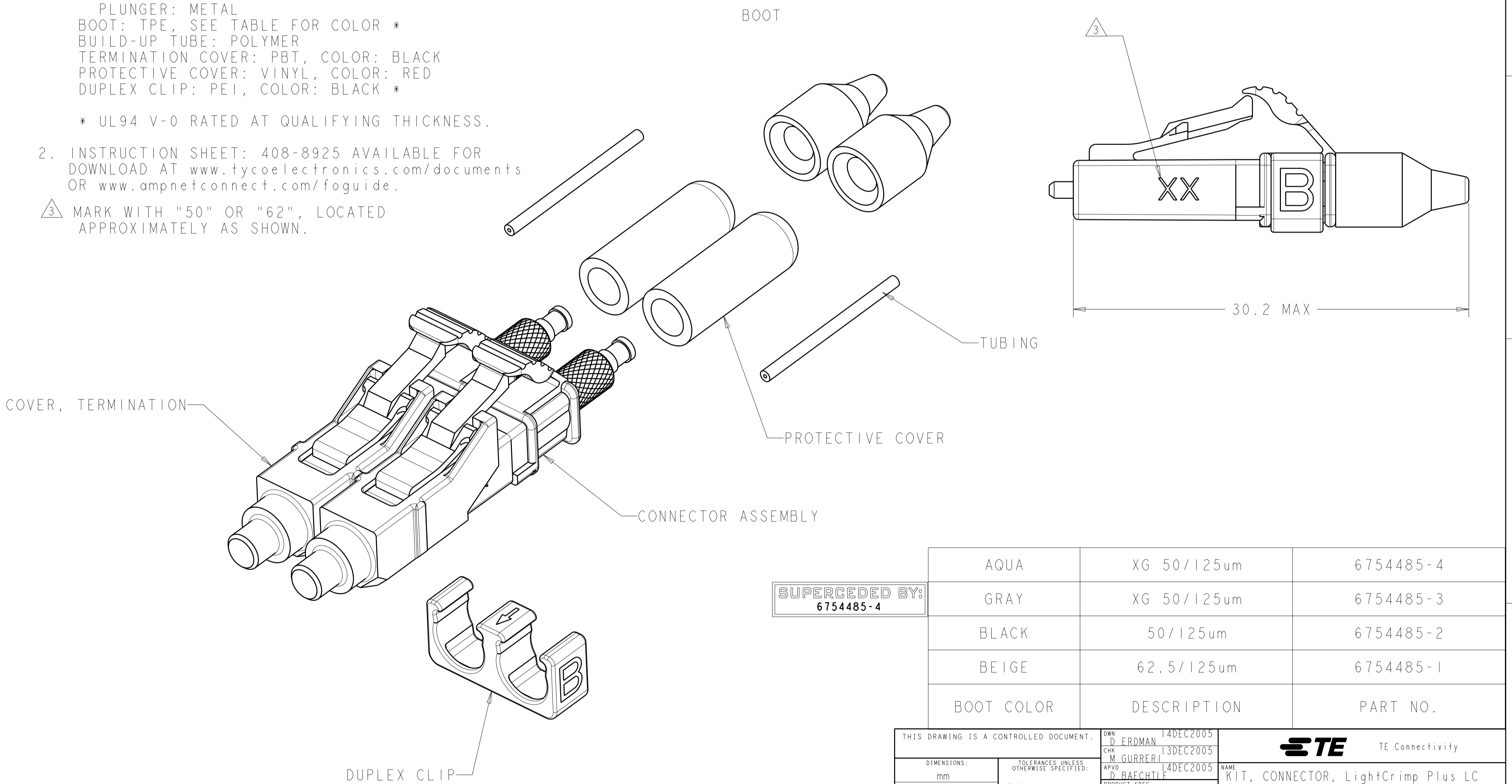

SUPERCEDED BY:
6754485-4

BOOT COLOR	DESCRIPTION	PART NO.
AQUA	XG 50/125um	6754485-4
GRAY	XG 50/125um	6754485-3
BLACK	50/125um	6754485-2
BEIGE	62.5/125um	6754485-1

THIS DRAWING IS A CONTROLLED DOCUMENT.		DWN D. ERDMAN 14DEC2005	STE TE Connectivity	
DIMENSIONS: mm		CHK M. GURRERI 13DEC2005		
TOLERANCES UNLESS OTHERWISE SPECIFIED: 0 PLC ±- 1 PLC ±0.5 2 PLC ±0.13 3 PLC ±0.013 4 PLC ±0.0001		APVD D. BAECHTLE 14DEC2005	NAME KIT, CONNECTOR, LightCrimp Plus LC DUPLEX, MM 250-900um BUFFER	
MATERIAL		PRODUCT SPEC -	SIZE A200779	CAGE CODE C-6754485
FINISH		APPLICATION SPEC -	DRAWING NO 6754485	RESTRICTED TO -
WEIGHT -		WEIGHT -	SCALE 4:1	SHEET 1 OF 1
CUSTOMER DRAWING		REV F3		