

INTERFACE KEY #1
MATING CONNECTOR : BLACK

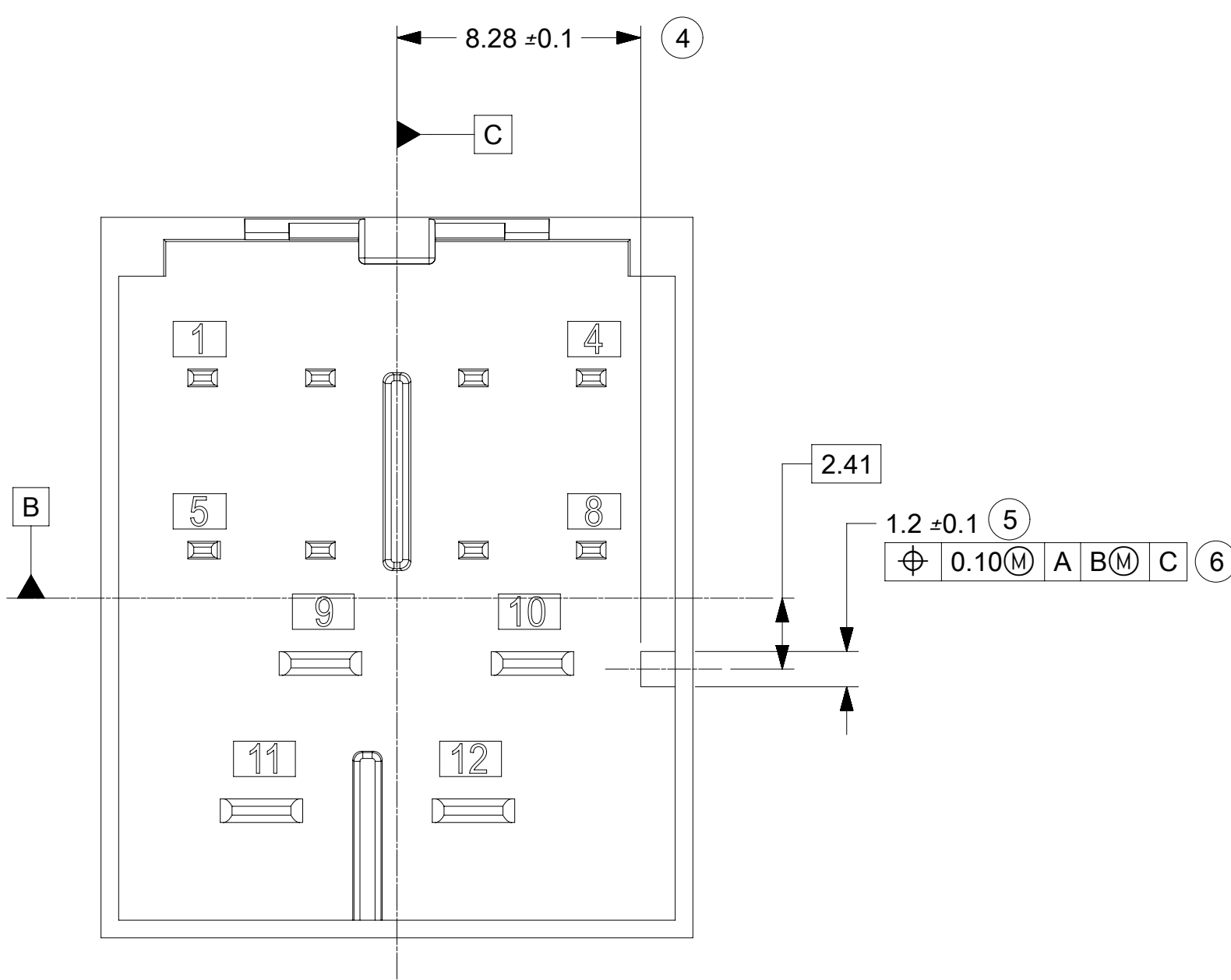

INTERFACE KEY #2
MATING CONNECTOR : LT GREEN B

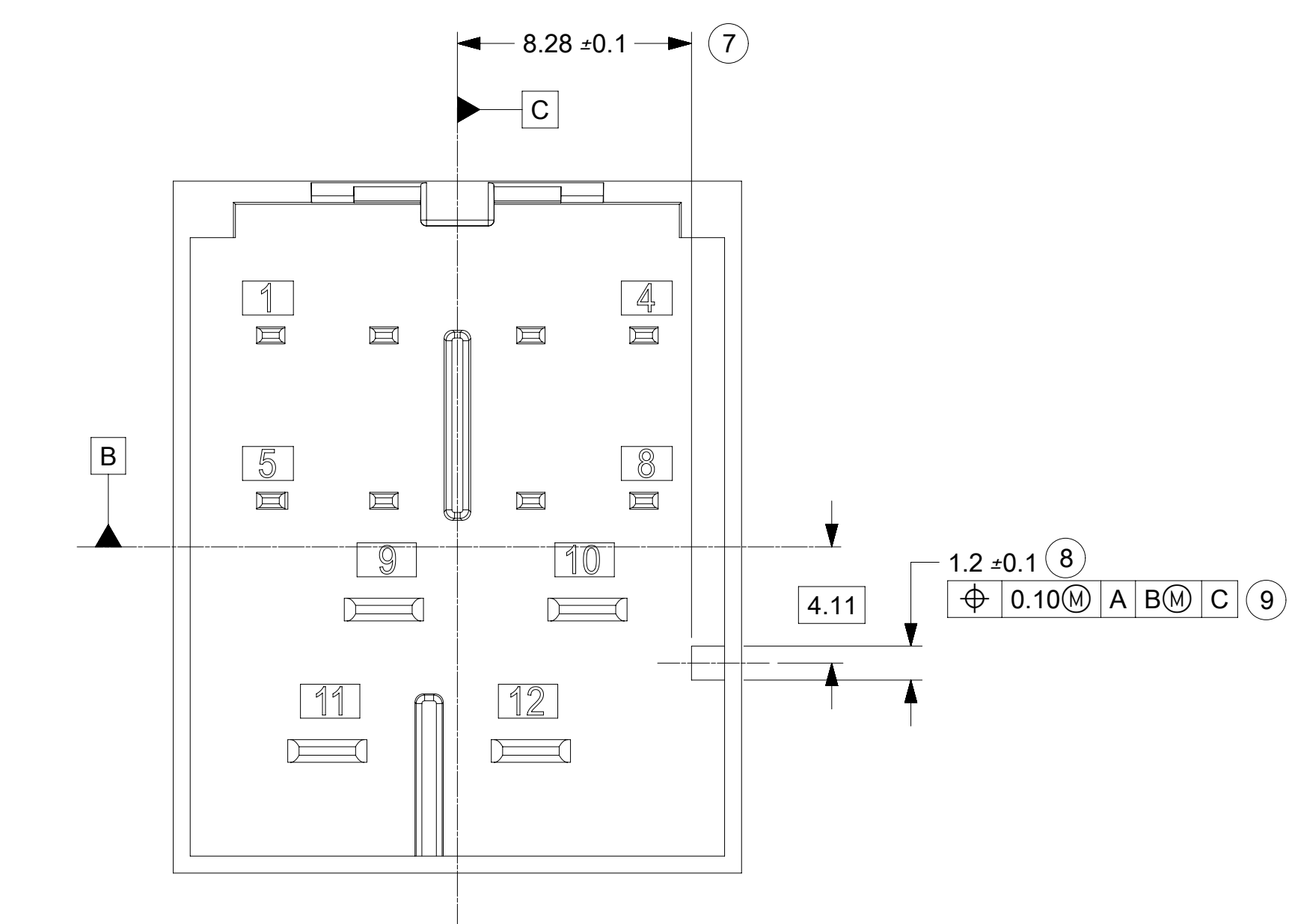

INTERFACE KEY #3
MATING CONNECTOR : LT PURPLE

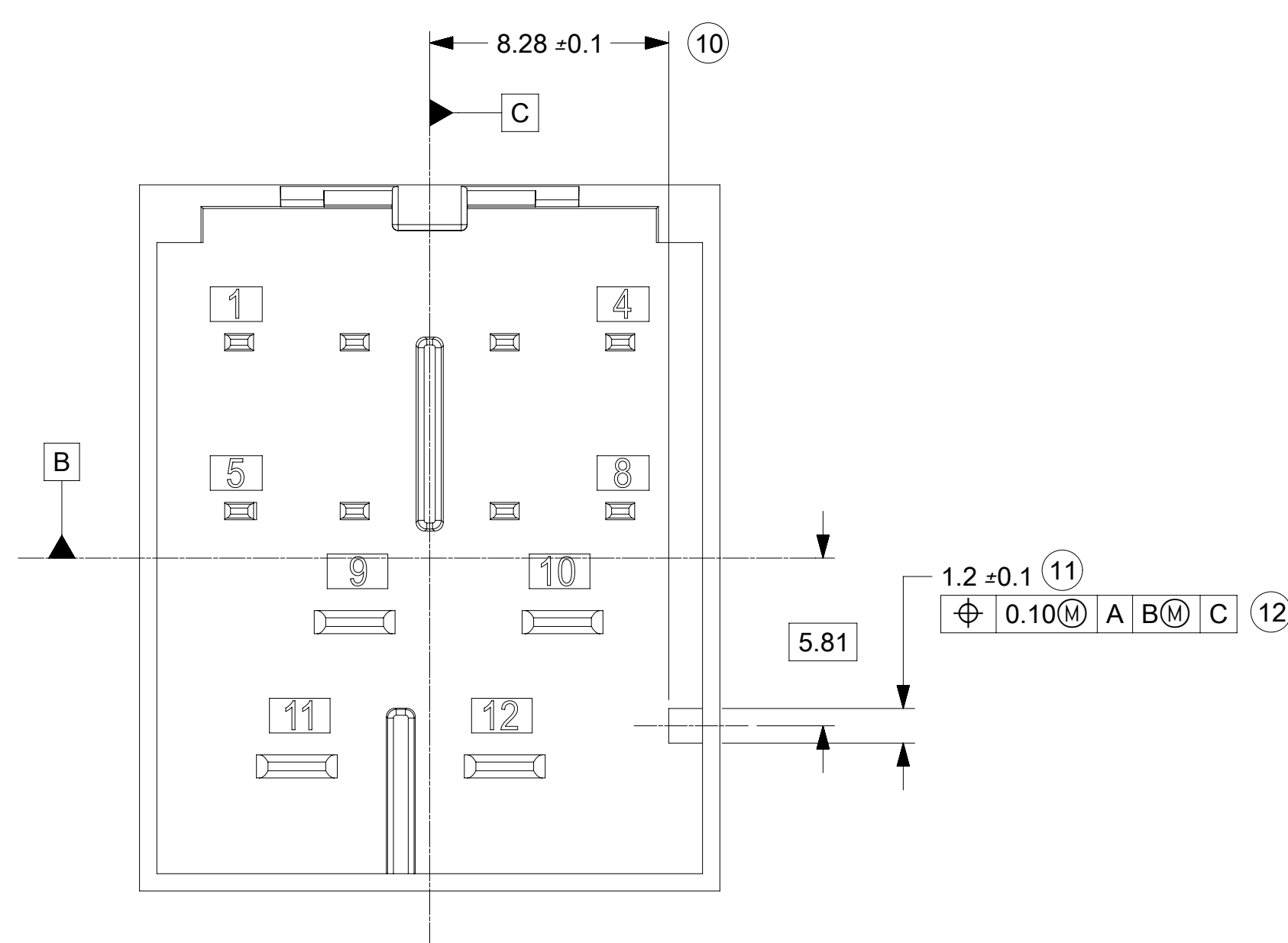

INTERFACE KEY #4
MATING CONNECTOR : LT GRAY

NOTES: VALID UNLESS OTHERWISE SPECIFIED

1. DESIGN - MATERIALS:
 - a. RESIN MATERIAL : PBT+GF30 OR SPS+GF30 OR EQUIVALENT
 - b. PIN/BLADE MATERIAL : ACCORDING TO USCAR DRAWING EWCAP-001 NOTE B2
 - c. PLATING: ACCORDING TO USCAR DRAWING EWCAP-001 TIN REFLOW WITH UNDERPLATE
 - d. PIN TIPS ACCORDING TO USCAR DRAWING EWCAP-001 (120-T002 & 280-T001)
 - e. DEVIATION TO EWCAP-001 ACCEPTABLE IF PERFORMANCE (ELECTRICAL/MECHANICAL) IS SHOWN TO BE EQUAL OR BETTER AS REQUIRED BY VALIDATION TESTING.
 1. DEVIATION TO TIN PLATING THICKNESS AS NECESSARY TO MEET MATING FORCE AND ALL VALIDATION REQUIREMENTS
2. DRAWING - GEOMETRY:
 - a. ALL GRAPHIC DATA IS BASIC (NO TOLERANCE) AND MUST BE TAKEN FROM THE DATA FILE AT ITS LATEST REVISION.
 - b. GEOMETRIC DIMENSIONS AND TOLERANCES PER ASME Y14.5M-2009.
 - c. GENERAL TOLERANCES:
 - LINEAR : PER DIN 16901 LINEAR CODE B FOR PRECISION ENGINEERING
 - ANGULAR : ±3°
 - d. EDGES AND UNDIMENSIONED DETAILS PER ISO13715
 - e. CORNERS SHOW AS SHARP TO BE R 0.2 MAX.
 - f. LETTERS SHALL BE 0.15MAX RAISED IN 0.25 MAX RECESSED PAD. THIS INCLUDES RECYCLING CODE, CAVITY ID, VENDOR IDENTIFICATION, AND CUSTOMER MATERIAL NUMBER. (for small parts : LETTERING SHALL BE 0.10 MAX RAISED IN 0.15 MAX RECESS PAD)
3. DESIGN - MANUFACTURING:
 - a. DRAFT TO BE WITHIN TOLERANCE.

C	ADDED 2.8MM BLADE LENGTH VARIANT FOR MATE FORCE REQUIREMENT ADDED NOTE 1.e.1 CHANGE RECORD: 626144 JPATE 10/22/2019
B1	ADDED BALLOONS JCONDON 07/31/2018
B	REMOVED 0.2MM FROM CONNECTOR LOCK TAB FEATURE
A3	DRAWING CLEANUP
A2	ADDED CIRCUIT IDs
A1	ADDED NOTE 1e, MKOWALSKY 7/7/2017
7	GEOMETRY UPDATED, SPEMMARAJU 02/18/2016
6	UAU2015-1446 , SAP#10681629 , JCONDON 03/25/2015

SYMBOLS	THIS DRAWING CONTAINS INFORMATION THAT IS PROPRIETARY TO MOLEX ELECTRONIC TECHNOLOGIES, LLC AND SHOULD NOT BE USED WITHOUT WRITTEN PERMISSION	
	DIMENSION UNITS	SCALE
▽ = 0	mm	CURRENT REV DESC: ADDED 2.8MM BLADE LENGTH VARIANT FOR MATE FORCE REQUIREMENT ADDED NOTE 1.E.1
▽ = 0	GENERAL TOLERANCES (UNLESS SPECIFIED)	
▽ = 0	ANGULAR TOL ± °	EC NO: 626144
▽ = 0	4 PLACES ±	DRWN: JCONDON 2019/10/08
▽ = 0	3 PLACES ±	CHK'D: DLANGOLF 2019/10/22
▽ = 0	2 PLACES ±	APPR: JCONDON 2019/10/23
▽ = 0	1 PLACE ±	INITIAL REVISION:
▽ = 0	0 PLACES ±	DRWN: SPEMMARAJU 2015/10/27
▽ = 0	DRAFT WHERE APPLICABLE MUST REMAIN WITHIN DIMENSIONS	APPR: KDEKOSKI 2016/03/24
▽ = 0	THIRD ANGLE PROJECTION	DRAWING SERIES
▽ = 0	D-DRAWING	D-SIZE 160026
DOCUMENT NUMBER		DOC TYPE DOC PART REVISION
SD-160026-002		PSD 000 C
MATERIAL NUMBER CUSTOMER		SHEET NUMBER
GENERAL MARKET		1 OF 3

PACKAGE SPACE
FOR UNMATED
CONNECTOR

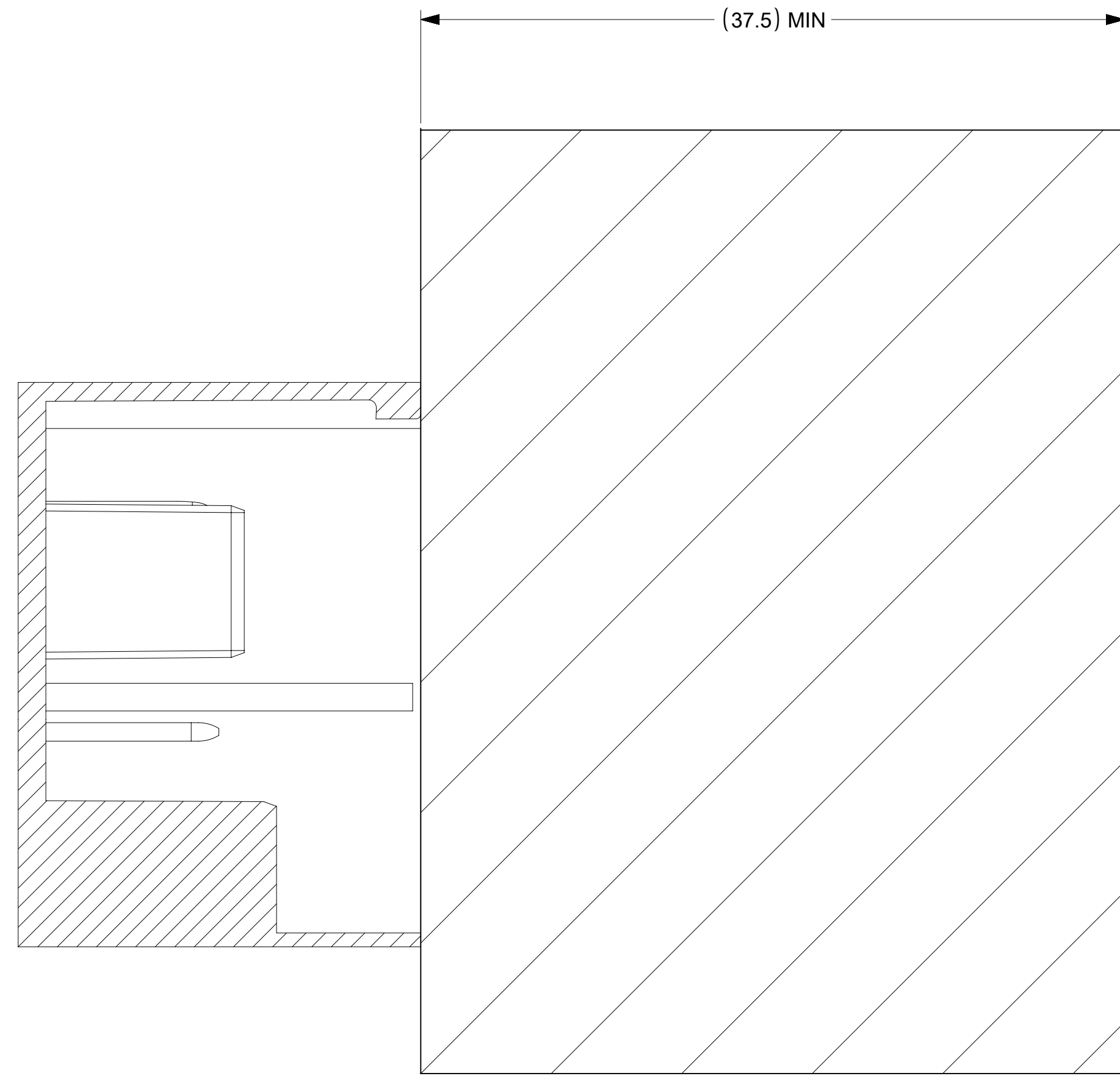

PACKAGE SPACE
FOR CONNECTOR

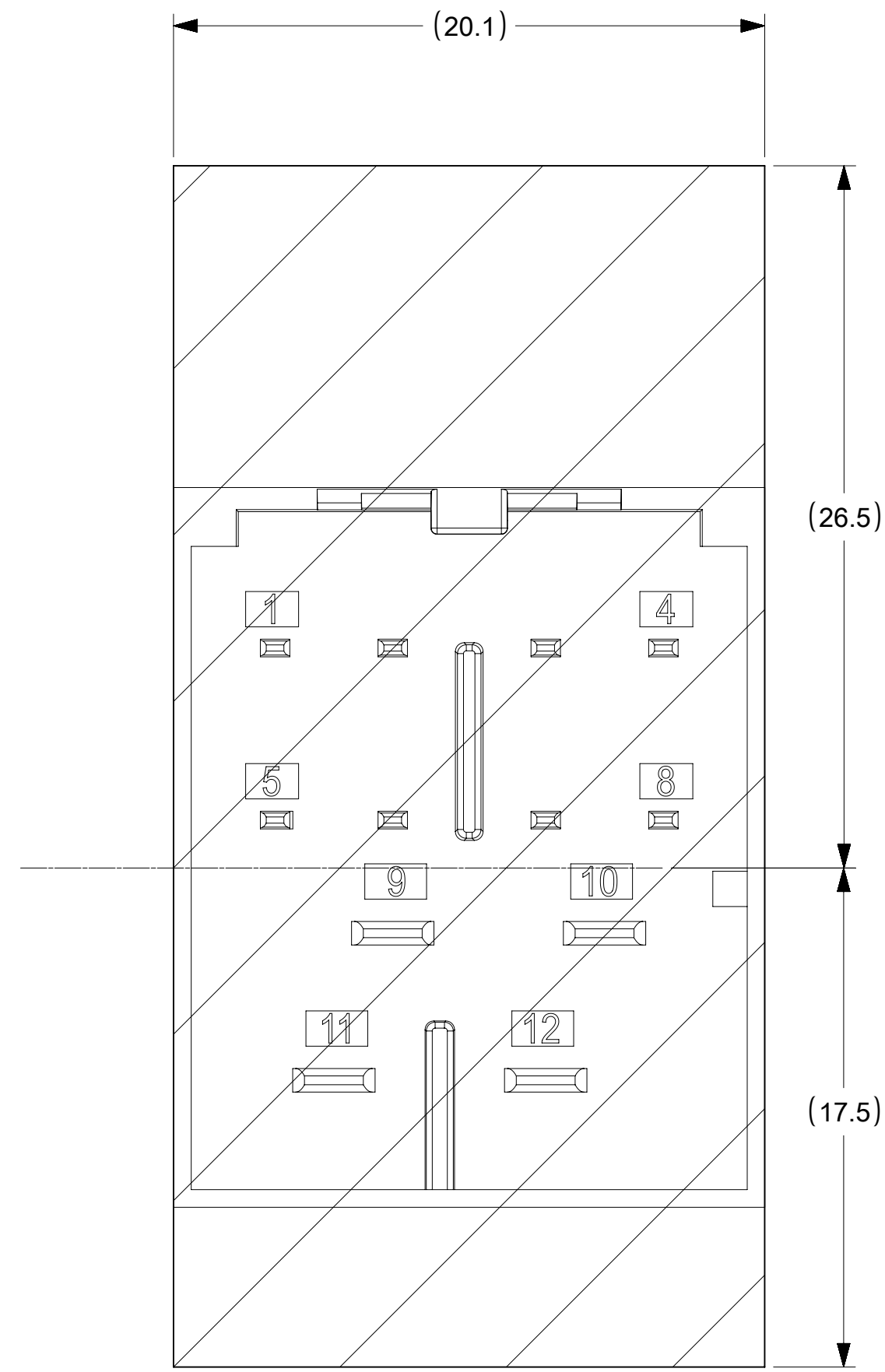

PACKAGE SPACE
FOR MATED
CONNECTOR
WITH COVER

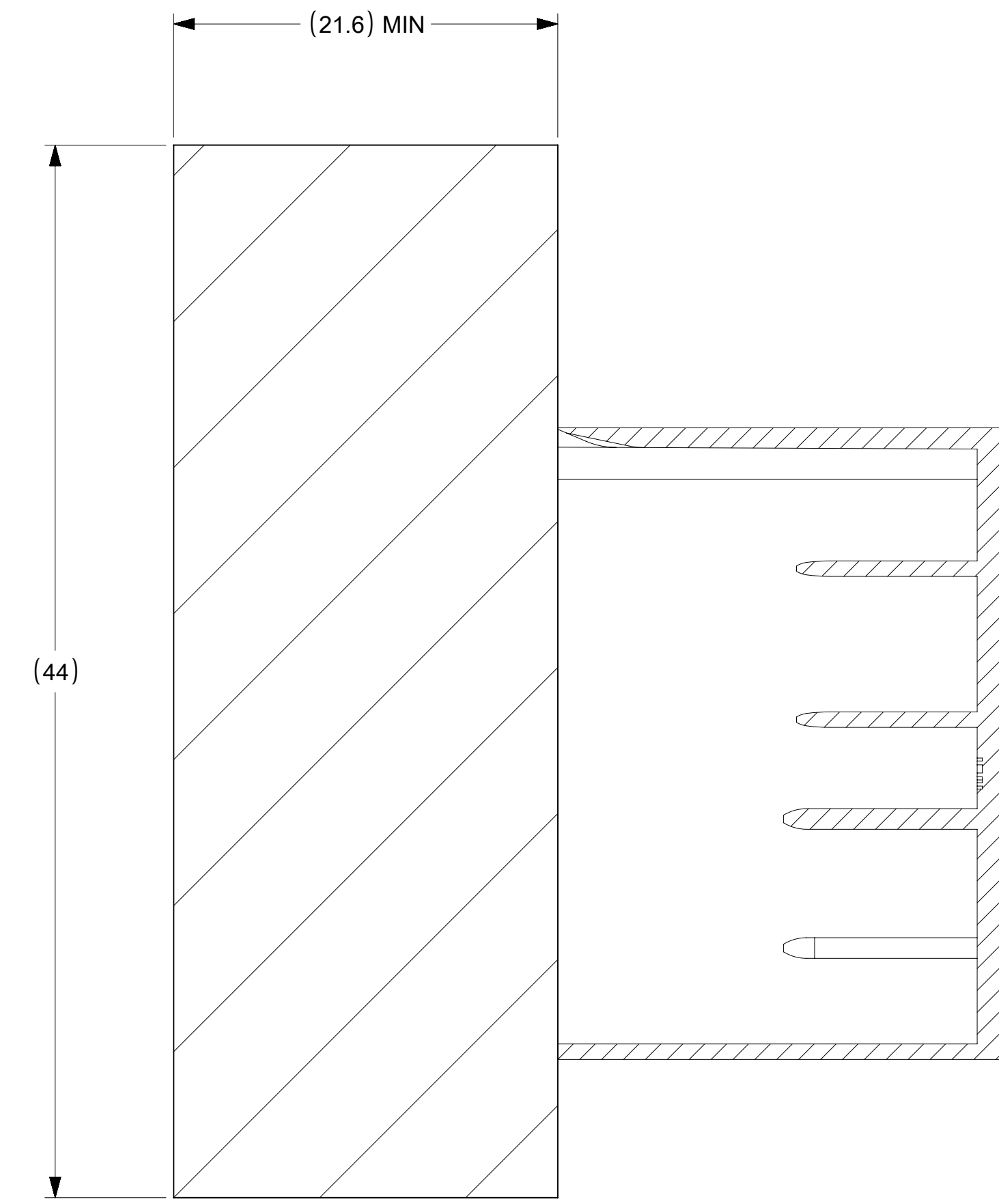

SYMBOLS	THIS DRAWING CONTAINS INFORMATION THAT IS PROPRIETARY TO MOLEX ELECTRONIC TECHNOLOGIES, LLC AND SHOULD NOT BE USED WITHOUT WRITTEN PERMISSION								
	DIMENSION UNITS	SCALE			DOCUMENT NUMBER	DOC TYPE	DOC PART	REVISION	
▽ = 0	mm		CURRENT REV DESC: ADDED 2.8MM BLADE LENGTH VARIANT FOR MATE FORCE REQUIREMENT ADDED NOTE 1.E.1			SD-160026-002	PSD	000	C
▽ = 0	GENERAL TOLERANCES (UNLESS SPECIFIED)		EC NO: 626144			12WAY STAK50H INTERFACE DRAWING			
▽ = 0	ANGULAR TOL ±		DRWN: JCONDON 2019/10/08			PRODUCT CUSTOMER DRAWING			
▽ = 0	4 PLACES		CHK'D: DLANGOLF 2019/10/22			DOCUMENT NUMBER			
▽ = 0	3 PLACES		APPR: JCONDON 2019/10/23			DOC TYPE			
▽ = 0	2 PLACES		INITIAL REVISION:			DOC PART			
▽ = 0	1 PLACE		DRWN: SPEMMARAJU 2015/10/27			REVISION			
▽ = 0	0 PLACES		APPR: KDEKOSKI 2016/03/24			SD-160026-002			
⊠ = 0	DRAFT WHERE APPLICABLE MUST REMAIN WITHIN DIMENSIONS		THIRD ANGLE PROJECTION		DRAWING		SERIES		MATERIAL NUMBER
■ = 0					D-SIZE		160026		CUSTOMER
▽ = 0							GENERAL MARKET		SHEET NUMBER
									3 OF 3