

REVISIONS					
P	LR	DESCRIPTION	DATE	DRN	APPD
J2		REVISED PER ECR-21-103273	13MAY2021	RZ	WK

- PARTS PACKAGED UNASSEMBLED
- THREE SAFETY WIRE HOLES $\phi 0.61$ [.024] MINIMUM, EQUALLY SPACED AROUND CIRCUMFERENCE
- BELDEN 9292 (WITH 95% BRAID COVERAGE)
- SEE I.S. 2028-1

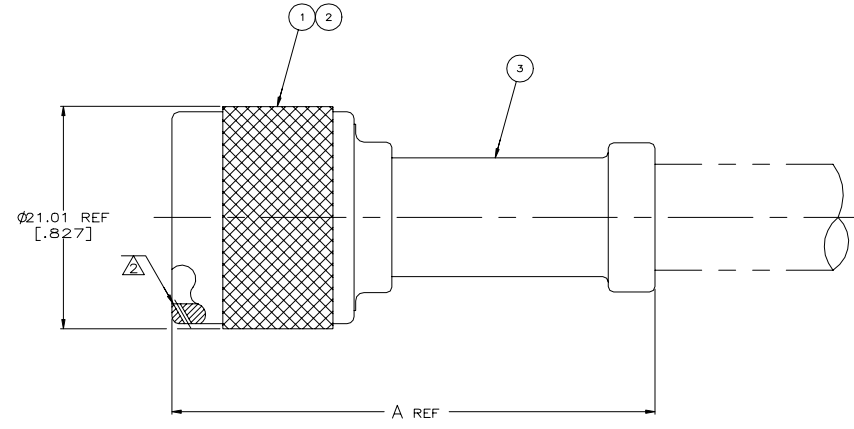
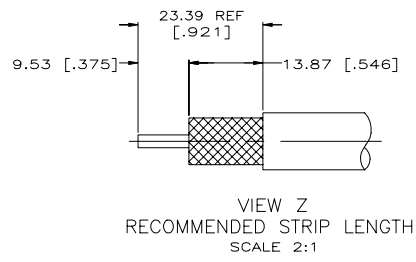
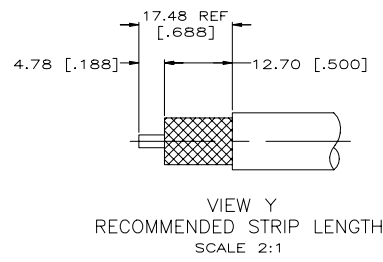
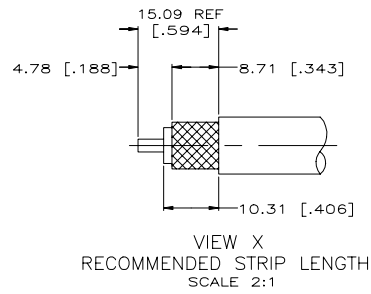
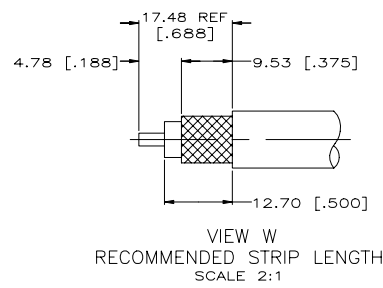

	BRAND REX T-13485	2-225662-2 AMP	220015-1	47.22	[1.859]	W	2-331987-0	2-51695-9	225081-3	2-225662-2
OBSELETE	ITT,NAB-61S-BAA	2-225662-0 AMP	220015-1	47.22	[1.859]	W	1-331987-5	2-51695-9	225081-3	2-225662-0
		1-225662-8 AMP	220015-1	47.22	[1.859]	W	1-331987-5	2-51695-6	225081-3	1-225662-8
OBSELETE	RG-226/U MODIFIED	1-225662-7 AMP	220065-1	61.11	[2.406]	Z	225801-2	225788-2	225776-2	1-225662-7
		1-225662-4 AMP	220045-2	42.85	[1.687]	X	225560-8	225343-4	225412-6	1-225662-4
SUPERSEDED BY 225392-1		1-225662-3 AMP	220045-2	42.85	[1.687]	X	225560-7	225343-2	225412-3	1-225662-3
SUPERSEDED BY 225392-7		1-225662-2 AMP	220045-2	42.85	[1.687]	X	225560-8	225343-2	225412-6	1-225662-2
		1-225662-1 AMP	220015-1	47.22	[1.859]	Y	225490-5	2-51695-3	225081-3	1-225662-1
OBSELETE	RG-11A/U & 144/U	225662-4 AMP	220015-1	47.22	[1.859]	W	1-331987-5	2-51695-2	225081-3	225662-4
OBSELETE	RG-213/U	225662-2 AMP	220015-1	47.22	[1.859]	W	1-331987-5	2-51695-1	225081-3	225662-2
	RG-9/U,9A/U,9B/U & 214/U	225662-1 AMP	220015-1	47.22	[1.859]	Y	1-331987-4	2-51695-1	225081-3	225662-1
	CABLE SIZE	STAMPING	CRIMP TOOL	A	VIEW	③ FERRULE QTY=1	② CONTACT QTY=1	① PLUG ASSY QTY=1		PART NUMBER

THIS DRAWING IS A CONTROLLED DOCUMENT. DRN: 08-31-91, GR: S. SCOTT, M: SNEED, DATE: 08-20-91

DIMENSIONS: INCHES. TOLERANCES UNLESS OTHERWISE SPECIFIED: 0 RLC ± .005, 1 RLC ± .005, 2 RLC ± .005, 3 RLC ± .005, 4 RLC ± .005. ANGLES: ± .5°. FINISH: -----

PRODUCT SPEC: 108-12019. APPLICATION SPEC: -----

WEIGHT: 0.000000. MATERIAL: -----

CUSTOMER DRAWING. SIZE: A1. DATE CODE: 00779. DRAWING NO: 225662. RESTRICTED TO: -----

SCALE: 4:1. SHEET: 1 OF 1. REV: J2