

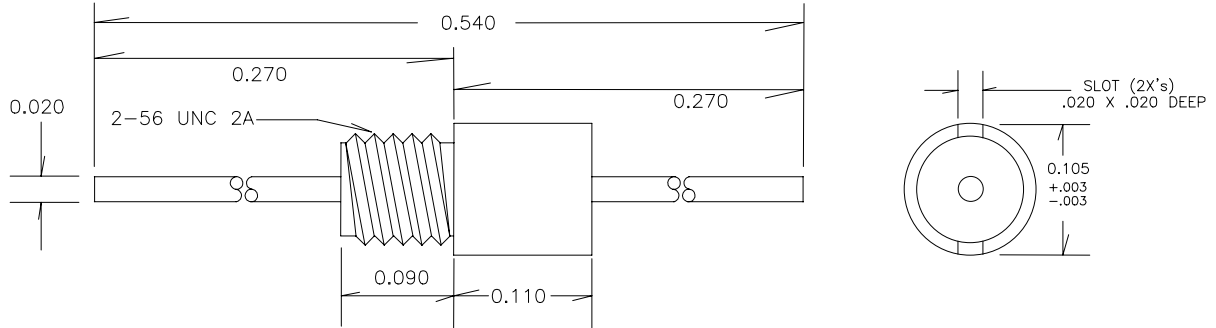

B2C103A
 2-56 THREAD NON-HERMETIC
 10,000pF Cap. FEED-THRU

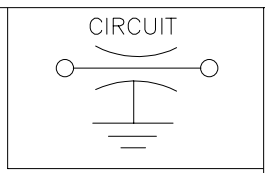

- * RoHS Compliant
- * Discoidal Capacitor Construction

PART NUMBER	EMI P/N	CAP. (pF)	COLOR DOT(S)*	MAX. WVDC	DC AMPS	MINIMUM NO LOAD INSERTION LOSS				
						1 MHz	10 MHz	100 MHz	1 GHz	10 GHz
B2C103A		10,000	2 WHITE	50	5	6	21	35	50	60

ELECTRICAL

CAPACITANCE TOLERANCE: +100/-0%
 DISSIPATION FACTOR: 3.5% MAX.
 INSULATION RESISTANCE:
 25° C=10,000 Mohm Min.
 125° C=1,000 Mohm Min.
 DIELECTRIC STRENGTH (DWV):
 250% of WVDC (5 seconds)
 TEMPERATURE CHARACTERISTIC:
 X7R or better

PHYSICAL

DIMENSION TOLERANCE:
 CASE LENGTH: +/- .005" (.123mm)
 LEAD LENGTH: +/- .030" (.762mm)
 LEAD DIAMETER: +/- .002" (.051mm)
 MATERIAL AND FINISH:
 CASE: Brass CASE FINISH: Gold
 LEAD: Brass, 3/4 Hard
 LEAD FINISH: Gold, Suitable For Wire Bond
 Per MIL-G-45204, Type III, Grade A, Class 1

IDENTIFICATION & LIMITS

*MARKING:
 NO MARKING STANDARD.
 Color dot marking option available.
 OPERATING TEMP: -55° C to +125° C
 INSTALLATION TEMP: N/A
 MAXIMUM MOUNTING TORQUE: 1.0 in*lbs

NOTE
 For a .024" diameter lead, append "24" to the end of the EMI P/N.

EMI Filter Company 12750 59th Way N. Clearwater, FL 33760 (727) 585-7990 (727) 586-5138 Fax www.emifiltercompany.com		FILTER, EMI, MINIATURE, 2-56 THREADED BODY	
FSCM NO.	DWG NO. B2C103A REVD	REV D	

