



**BOARD LEVEL COOLING – Channel 5040**

Channel 5040 is a series of narrow channel board level heat sinks designed to cool TO-220 devices. Representative image only.

**ORDERING INFORMATION**

| Part Number   | Device Type |
|---------------|-------------|
| 504102B00000G | TO-220      |
| 504202B00000G | TO-220      |

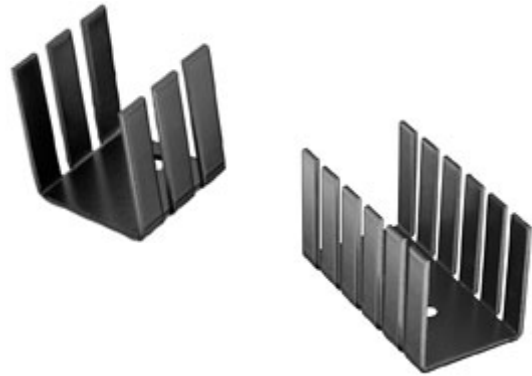

**HEAT SINK DETAILS**

| Property                   | Details               |
|----------------------------|-----------------------|
| Material                   | Aluminum              |
| Finish                     | Black Anodize         |
| Device Attachment Options  | Requires Mounting Kit |
| Thermal Interface Material | -                     |

| Property                     | Details              |
|------------------------------|----------------------|
| Heat Sink Width (mm)         | 19.80                |
| Heat Sink Length (mm)        | 21.59                |
| Heat Sink Height (mm)        | See "H" Dim below    |
| Heat Sink Mounting Direction | Vertical, Horizontal |

**MECHANICAL & PERFORMANCE**

Drawing dimensions are shown in mm, (in)

| Part Number   | "H" Dim |
|---------------|---------|
| 504102B00000G | 17.80   |
| 504202B00000G | 36.83   |

Part Number: 504102B00000G

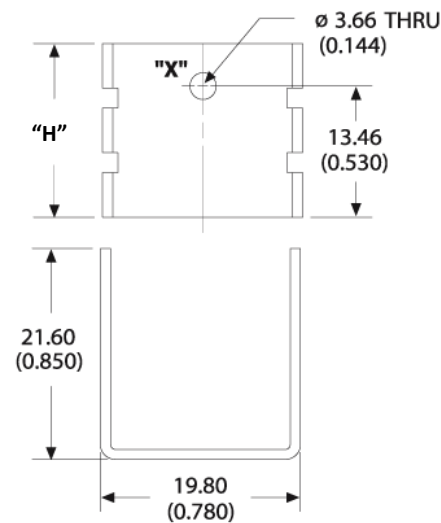

Part Number: 504202B00000G

