

REVISIONS			
REV	DESCRIPTION, ECN, EAR NO.	DATE	APP'D
A	PROPOSAL	MAR12/18	L.CHAN

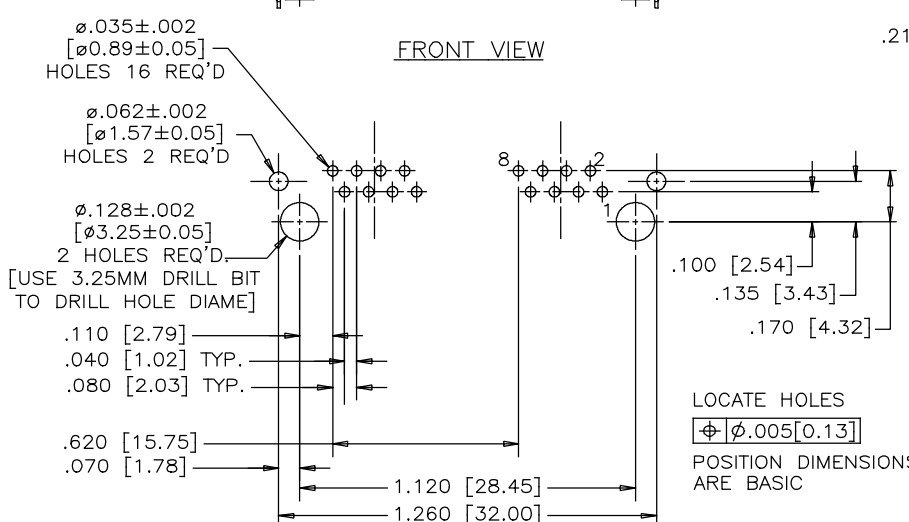

LOCATE HOLES  
 $\phi \pm 0.005 [0.13]$   
 POSITION DIMENSIONS ARE BASIC

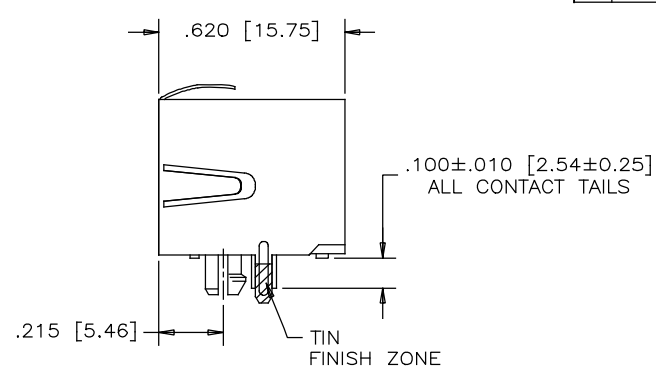
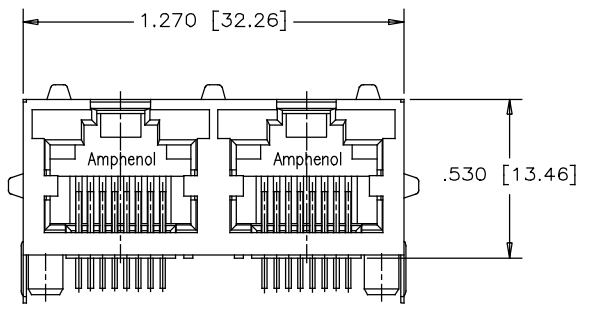

**MATERIALS:**  
 PLASTIC HOUSING: HIGH TEMPERATURE THERMOPLASTIC  
 FLAMMABILITY RATING UL 94V-0, COLOR BLACK

**CONTACTS:**  
 PHOSPHOR BRONZE  
 PLATING: GOLD PLATING ON MATING SURFACE.  
 [SEE PART NUMBER FOR THICKNESS]  
 50 μ" [1.27 MICRONS]  
 MIN. NICKEL UNDERPLATE  
 100 μ" [2.54 MICRONS]  
 MIN. MATTE TIN ON CONTACT TAILS.

**SHIELD:** STAINLESS STEEL WITH TIN FINISH ON SOLDER TAIL

**AMPHENOL PART NUMBER:** RJHSE-X380-02

**GOLD PLATING**  
 E=RJ45 FLAT CONTACT 6u"  
 G=RJ45 FLAT CONTACT 15u"  
 J=RJ45 FLAT CONTACT 30u"  
 5=RJ45 FLAT CONTACT 50u"

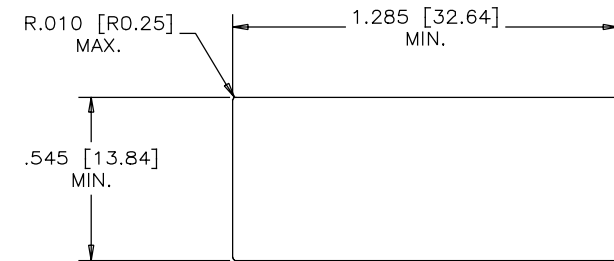

UNLESS SPECIFIED OTHERWISE		DRAWN <i>W.QIU</i>	DATE <i>MAR13/18</i>	<b>Amphenol Canada Corp.</b> www.amphenolcanada.com TITLE 2 PORT HIGH SPEED MODULAR JACK, 8P8C, SHIELDED, WITHOUT LED OPTIONS - RoHS COMPLIANT
PRIMARY UNITS	INCH	CHECKED <i>L.CHAN</i>	DATE <i>MAR13/18</i>	
SECONDARY	MILLIMETERS	M.E. APP'D		
REFERENCE IN PARENTHESES		Q.A. APP'D		
GENERAL TOLERANCES		DWG APPR.		
1 DECIMAL PLACE		ENG. REL. NO.		
2 DECIMAL PLACES	±0.020	REF.		DWG. NO.
3 DECIMAL PLACES	±0.015	THIRD ANGLE PROJECTION		P-RJHSE-X380-02
ANGULAR DEGREES	±1.0°			REV A

THIS DOCUMENT CONTAINS PROPRIETARY INFORMATION AND SUCH INFORMATION MAY NOT BE DISCLOSED TO OTHERS FOR ANY PURPOSE OR USED FOR MANUFACTURING PURPOSES WITHOUT WRITTEN PERMISSION FROM AMPHENOL CANADA CORP.