

SPECIFICATION CONTROL DRAWING

THIS DRAWING CONTAINS INFORMATION PROPRIETARY TO RF INDUSTRIES, LTD. ANY UNAUTHORIZED USE OF THIS DRAWING IS EXPRESSLY PROHIBITED. ANY VIOLATION IS PUNISHABLE UNDER U.S. COPYRIGHT LAWS.

| REV | DESCRIPTION | DWN | DATE | APPROVED |
|-----|---------------------|-----|--------|----------|
| A | ENGINEERING RELEASE | KMM | 3/6/99 | R. RICE |
| | | | | |
| | | | | |

ALL DIMENSIONS ARE REFERENCE ONLY

008974

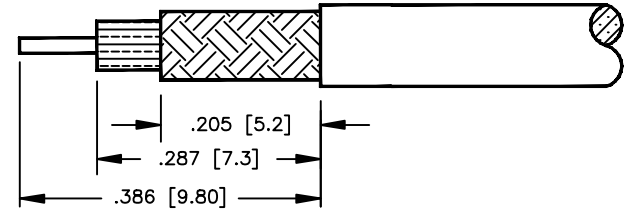
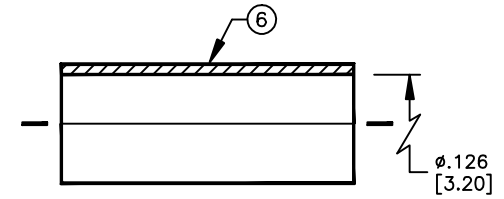
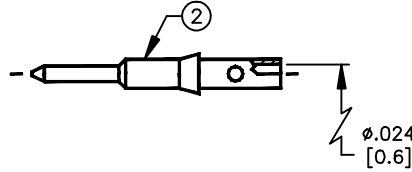
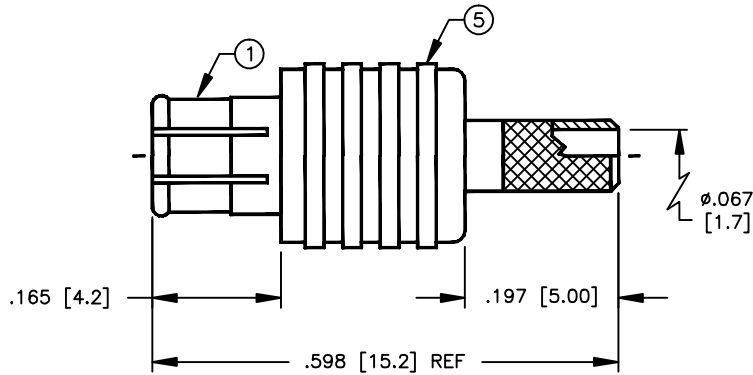

SUGGESTED STRIPPING INSTRUCTIONS

SUGGESTED CRIMP DIES: .130

PIN TO BE SOLDERED

SPECIFICATIONS:

IMPEDANCE: 50 OHMS
 WORKING VOLTAGE: 335 VRMS @ SEA LEVEL
 FREQUENCY RANGE: 0-6 GHz
 INSERTION LOSS: -.1 dB MAX @ 1 GHz
 VSWR MAX: 1.3:1 @ 6 GHz
 FOR RG-316/U DOUBLE SHIELD CABLE

DIMENSIONS ARE IN INCHES AND [MILLIMETERS]

UNLESS OTHERWISE NOTED TOLERANCES ARE:
 DECIMALS DIAMETER

RF connectors
 DIVISION OF RF INDUSTRIES, LTD.

7610 MIRAMAR RD
 SAN DIEGO, CA 92126
 (619)549-6340
 (619)549-6345 FAX

RMX-8000-B1

MCX CRIMP PLUG

| ITEM | DESCRIPTION | QTY | MATERIAL | FINISH |
|------|--------------------|-----|----------|--------|
| 6 | FERRULE [FER-1BKJ] | 1 | COPPER | NICKEL |
| 5 | HOUSING | 1 | BRASS | NICKEL |
| 4 | DIELECTRIC | 1 | PTFE | NONE |
| 3 | DIELECTRIC | 1 | PTFE | NONE |
| 2 | PIN | 1 | BRASS | GOLD |
| 1 | BODY | 1 | BeCu | NICKEL |

| | | |
|-----------|------------|--------|
| DRAWN | K. MAXWELL | 3/6/99 |
| CHECKED | | |
| ORJ DRAWN | K. MAXWELL | 3/6/99 |
| APPROVALS | | DATE |

| | | | |
|--------|-------------|----------|---------|
| SIZE | CABLE GROUP | DWG NO. | REV |
| A | B1 | 9051 | A |
| SCALE: | 4 : 1 | CAD FILE | 13ARC B |
| SHEET | | | 1 OF 1 |