

This document is the property of Amphenol Corporation and is delivered on the express condition that is not to be disclosed, reproduced or used, in whole or in part, for manufacture or sale by anyone other than Amphenol Corporation without its prior consent, and that no right is granted to disclose or to use any information in this document.

The marking on this product doesn't contain environmental hazardous materials per directive 2011/65/EU & 2015/863/EU for RoHS compliant & per IEC 61249-2-21 for Halogen-Free compliant.

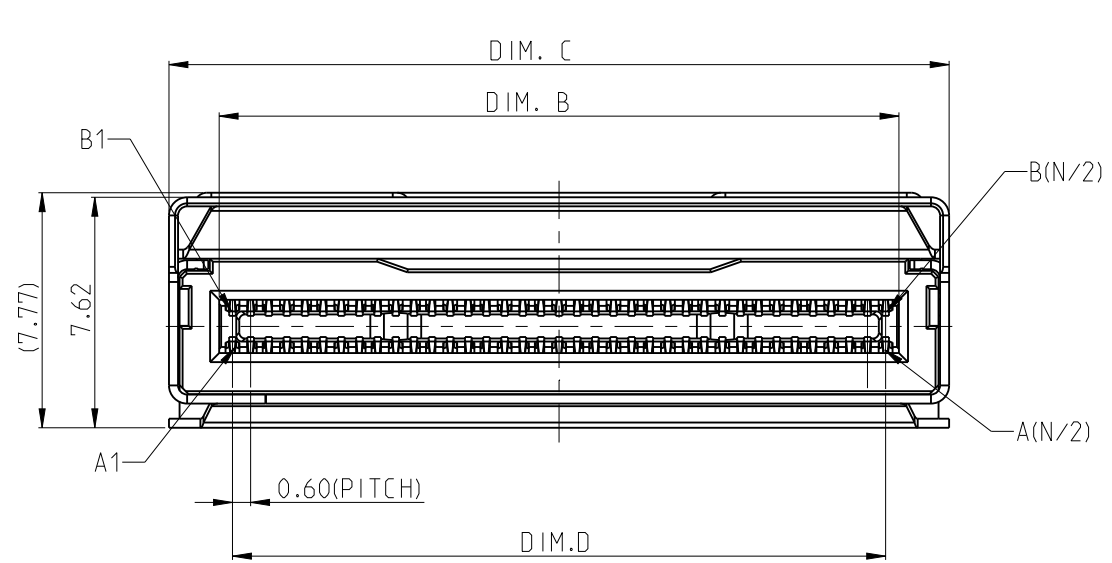

REVISIONS				
SYM	ECN No.	DESCRIPTION	DATE	BY
AX23	NA	UPDATED QTY OF PACKAGE	12/17/2019	JOAN LU
AX24	NA	1.CORRECT DIM J IN TABLE FOR G42VX6XXXXHR 2.REVISED LATCH HOLE DIMENSION FROM 1.10 TO 1.15MM	09/02/2020	JOAN LU
AX25	NA	RECOMMENDED AIC MATING CARD CHAMFER CHANGE FROM 0.75 TO 0.3	02/02/2021	JOAN LU
AX26	NA	ADDED NOTE ITEM 5	03/02/2021	JOAN LU
AX27	NA	CAP DESIGN CHANGE FOR BIGGER NOZZLE AREA	07/20/2021	JOAN LU



MINI COOL EDGE IO INTEGRATED CONNECTOR

VERTICAL TYPE

CONNECTOR SPEED
1 : PCIe Gen4

CHANNEL/PIN QTY
1: 38P(4X+SIDE BAND OR 6X)
2: 74P(8X+SIDE BAND OR 12X)
4: 124P(16X+SIDE BAND OR 20X)
5: 50P(6X+SIDE BAND OR 8X)
6: 148P(20X+SIDE BAND OR 24X)

CONTACT FINISH
2: 15u" GOLD
3: 30u" GOLD

G42 V 1 X X X X X XX

COMPLIANT CODE
HR: HALOGEN-FREE & RoHS

VARIATION CODE
BLANK: STANDARD

PACKING CODE
2: TAPE AND REEL(WITH CAP)
3: TAPE AND REEL(W/O PICK UP)

SHELL PIN LENGTH OPTION(DIM.A)
1: 1.50mm
2: 2.20mm
3: 3.00mm
4: 4.20mm
5: 1.20mm (SHELL PIN AND HOUSING POST)

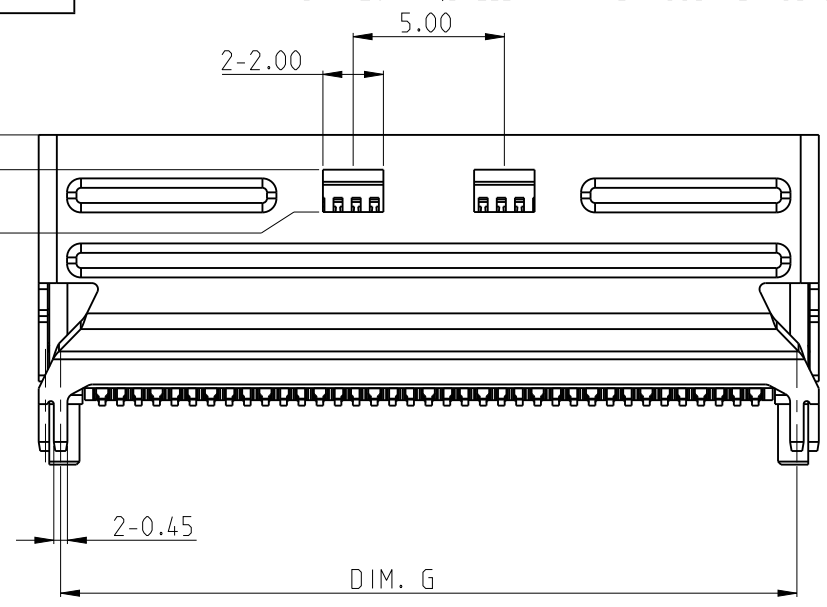
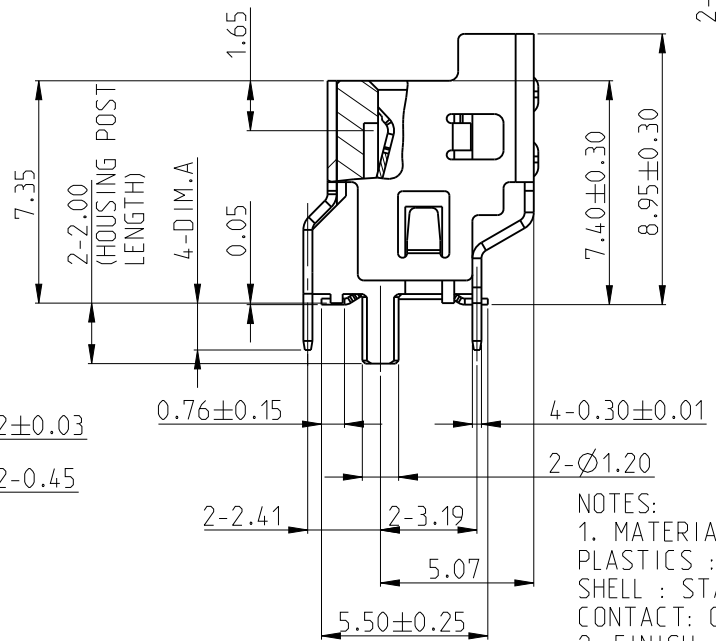
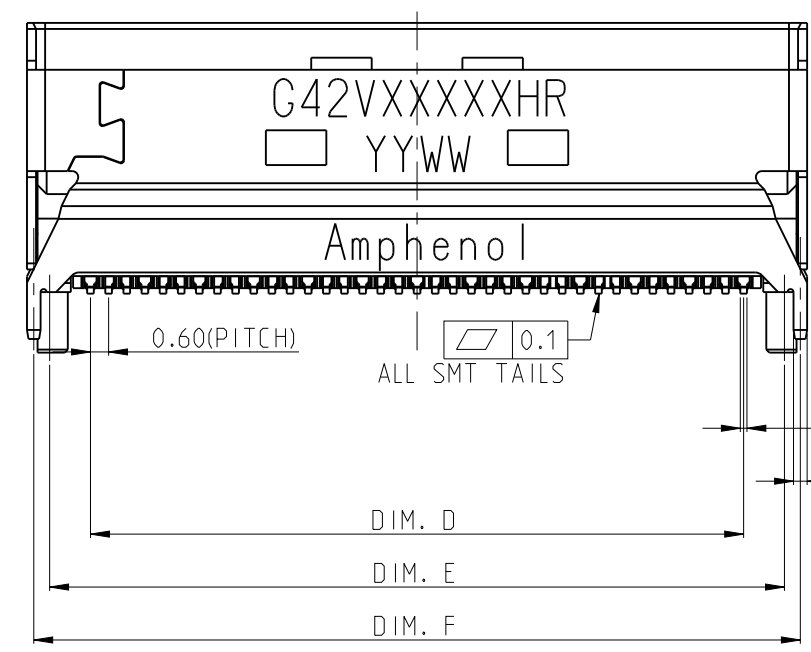

NOTES:
1. MATERIALS:
PLASTICS : HIGH TEMPERATURE THERMOPLASTIC UL94-0,COLOR: BLACK
SHELL : STAINLESS
CONTACT: COPPER ALLOY
2: FINISH
TERMINAL : CONTACT AREA : SELECTED GOLD PLATING.
SOLDER AREA : MATTE TIN PLATING 100u"
UNDER PLATING: NICKEL PLATING 50u"MIN OVER ALL
SHELL : UNDER PLATING: SOLDERABLE NICKEL PLATING 50u"MIN OVER ALL
3.THIS PRODUCT DOESN'T CONTAIN ENVIROMENTAL HAZARDOUS MATERIALS PER DERCTIVE 2011/65/EU & 2015/863/EU FOR RoHS AND PER IEC 61249-2-21 FOR HALOGEN FREE.
4.PRODUCT SPEC REFER TO PS-7681.
5.SUPPORT 92 OHM APPLICATION.

PART NUMBER	POS. (N)	DIM. B	DIM. C	DIM. D	DIM. E	DIM. F	DIM. G
G42VX1XXXXHR	38	11.68	15.00	10.80	13.50	14.55	13.55
G42VX5XXXXHR	50	15.28	18.60	14.40	17.10	18.15	17.15
G42VX2XXXXHR	74	22.48	25.80	21.60	24.30	25.35	24.35

TOLERANCE	DRAWN	APPROVALS	DATE	TITLE	UNIT	SIZE	PART No.
X. X.X ±0.30 X.XX ±0.20 X.XXX ±0.10	DESIGNED	JOAN LU	2021-07-20	MINI COOL EDGE IO INTEGRATED CONNECTOR 0.6 PITCH, VERTICAL STANDARD. SMT TYPE	mm	A3	G42V1XXXXHR
	CHECKED	Sondra Sang	2021-07-21				
	APPROVED	Hank Hsu	2021-07-21				
ANGULAR ±2°	DWG TYPE	CUST DWG	PROJECT CODE	TXXX	SCALE	SHEET	DWG No.
UNLESS OTHERW ISE SPECIFIED					NA	1 OF 8	G42V1XXXXHR

Amphenol®
Amphenol Corporation
Amphenol Taiwan Corporation

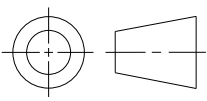

UNIT mm
SCALE NA
SHEET 1 OF 8

PART No. G42V1XXXXHR
REV. AX27

This document is the property of Amphenol Corporation and is delivered on the express condition that is not to be disclosed, reproduced or used, in whole or in part, for manufacture or sale by anyone other than Amphenol Corporation without its prior consent, and that no right is granted to disclose or to use any information in this document.

The marking on this product doesn't contain environmental hazardous materials per directive 2011/65/EU & 2015/863/EU for RoHS compliant & per IEC 61249-2-21 for Halogen-Free compliant.



REVISIONS				
SYM	ECN No.	DESCRIPTION	DATE	BY
AX23	NA	UPDATED QTY OF PACKACAGE	12/17/2019	JOAN LU
AX24	NA	1.CORRECT DIM J IN TABLE FOR G42VX6XXXHR 2.REVISED LATCH HOLE DIMENSION FROM 1.10 TO 1.15MM	09/02/2020	JOAN LU
AX25	NA	RECOMMENDED AIC MATING CARD CHAMFER CHANGE FROM C0.75 TO C0.3	02/02/2021	JOAN LU
AX26	NA	ADDED NOTE ITEM 5	03/02/2021	JOAN LU
AX27	NA	CAP DESIGN CHANGE FOR BIGGER NOZZLE AREA	07/20/2021	JOAN LU

G42VX1XXXHR

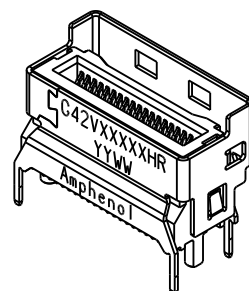
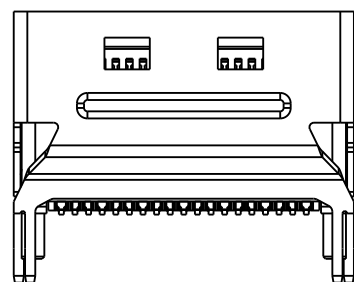
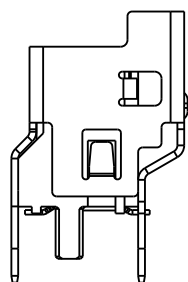
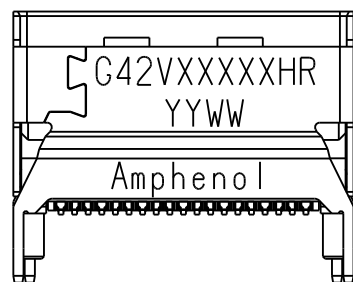

CAP DIMENSION
APPLICABLE PART NUMBER:
G42VX1XX2HR
G42VX2XX2HR
G42VX5XX2HR

G42VX5XXXHR

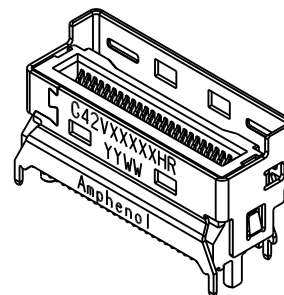
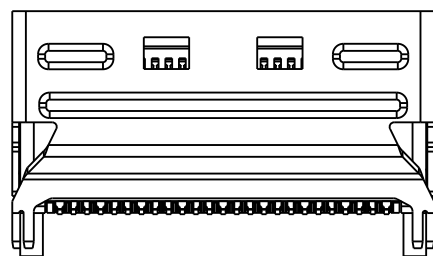
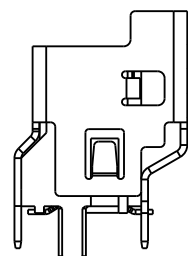
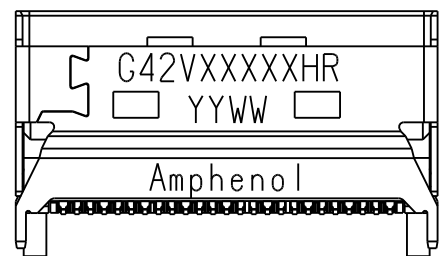

G42VX2XXXHR

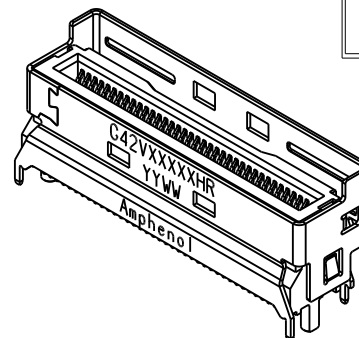
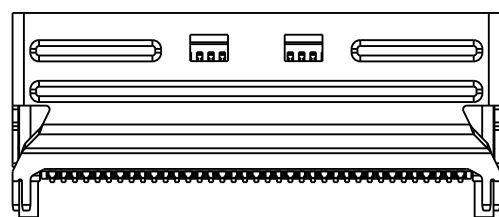
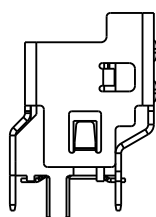
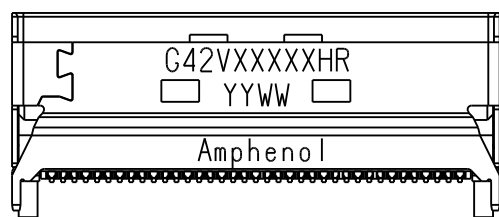

TOLERANCE	DRAWN	APPROVALS	DATE	TITLE			
X. X.X ±0.30 X.XX ±0.20 X.XXX ±0.10	DESIGNED	JOAN LU	2021-07-20	MINI COOL EDGE IO INTEGRATED CONNECTOR 0.6 PITCH, VERTICAL STANDARD. SMT TYPE	Amphenol® Amphenol Corporation Amphenol Taiwan Corporation		
ANGULAR ±2°	CHECKED	Sondra Sang	2021-07-21		UNIT	SIZE	PART No.
UNLESS OTHERWISE SPECIFIED	APPROVED	Hank Hsu	2021-07-21		mm	A3	G42V1XXXXHR
	DWG TYPE	CUST DWG	PROJECT CODE		SCALE	SHEET	DWG No.
			TXXX		NA	2 OF 8	G42V1XXXXHR REV. AX27

This document is the property of Amphenol Corporation and is delivered on the express condition that is not to be disclosed, reproduced or used, in whole or in part, for manufacture or sale by anyone other than Amphenol Corporation without its prior consent, and that no right is granted to disclose or to use any information in this document.

The marking on this product doesn't contain environmental hazardous materials per directive 2011/65/EU & 2015/863/EU for RoHS compliant & per IEC 61249-2-21 for Halogen-Free compliant.



REVISIONS				
SYM	ECN No.	DESCRIPTION	DATE	BY
AX23	NA	UPDATED QTY OF PACKAGE	12/17/2019	JOAN LU
AX24	NA	1.CORRECT DIM J IN TABLE FOR G42VX6XXXHR 2.REVISED LATCH HOLE DIMENSION FROM 1.10 TO 1.15MM	09/02/2020	JOAN LU
AX25	NA	RECOMMENDED AIC MATING CARD CHAMFER CHANGE FROM C0.75 TO C0.3	02/02/2021	JOAN LU
AX26	NA	ADDED NOTE ITEM 5	03/02/2021	JOAN LU
AX27	NA	CAP DESIGN CHANGE FOR BIGGER NOZZLE AREA	07/20/2021	JOAN LU

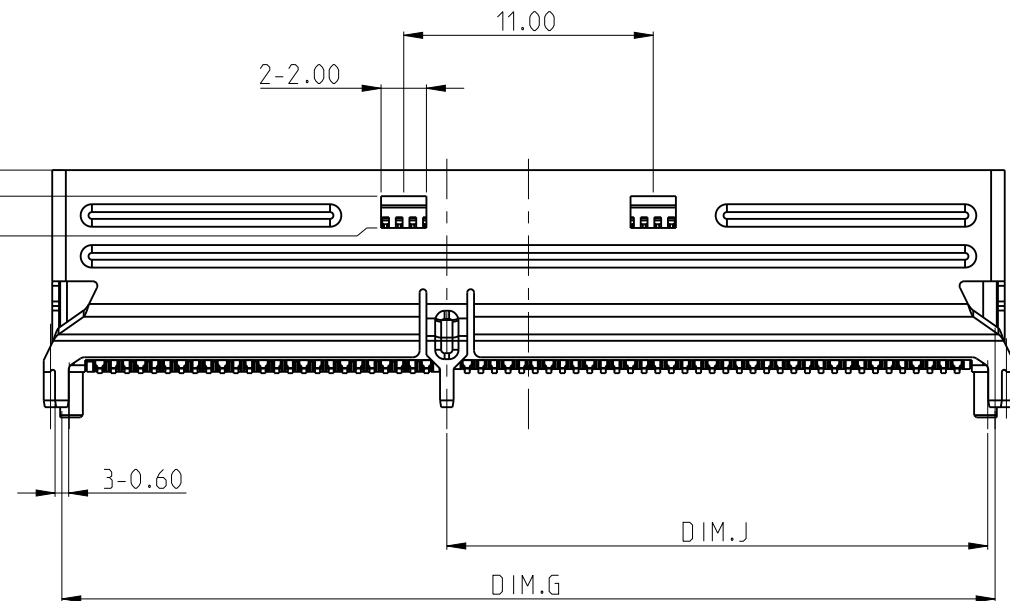
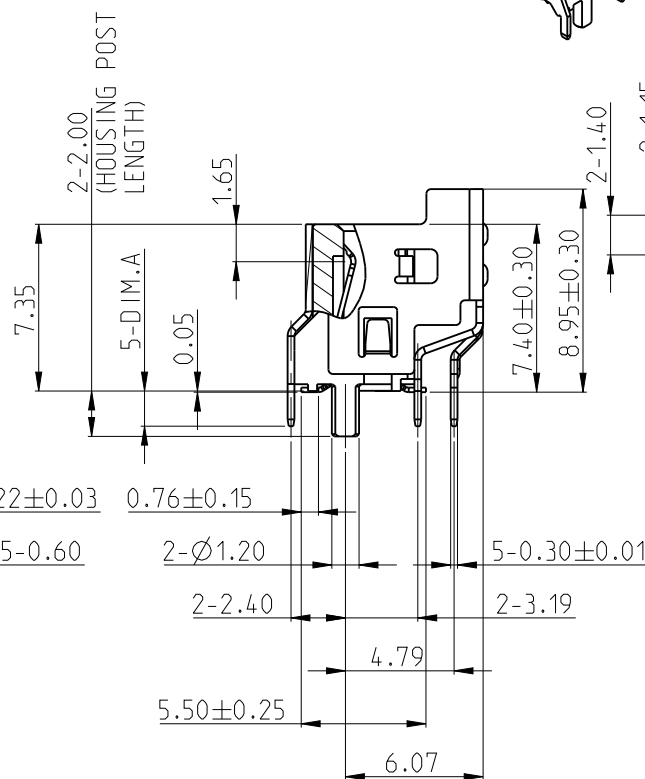
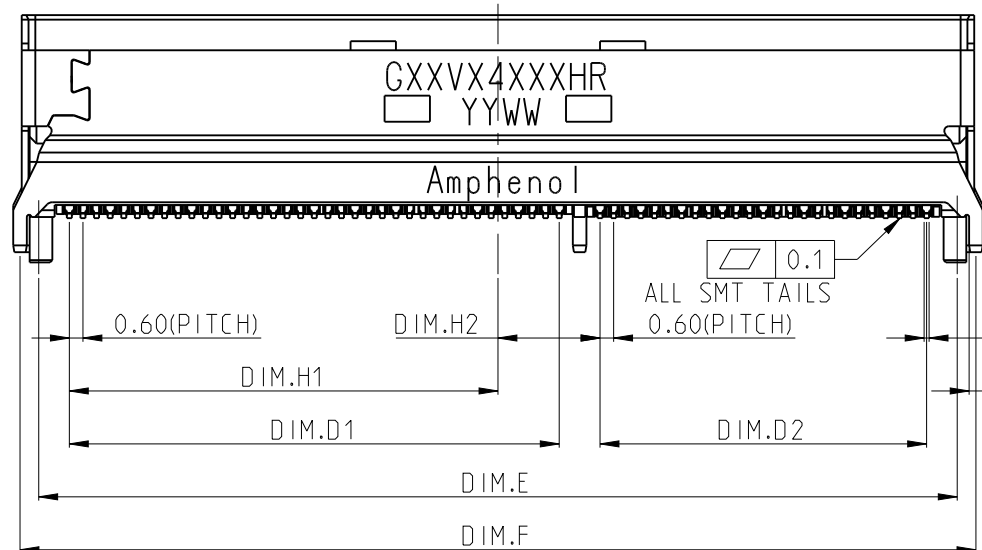
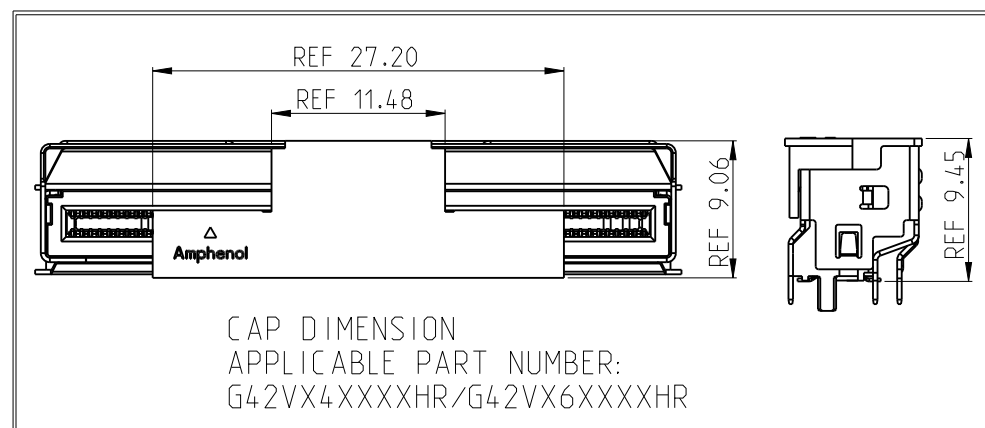
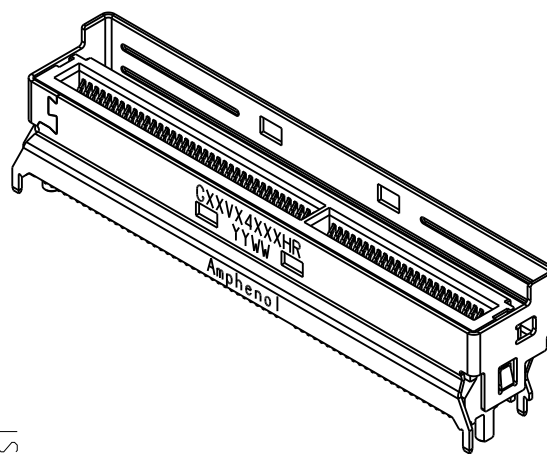
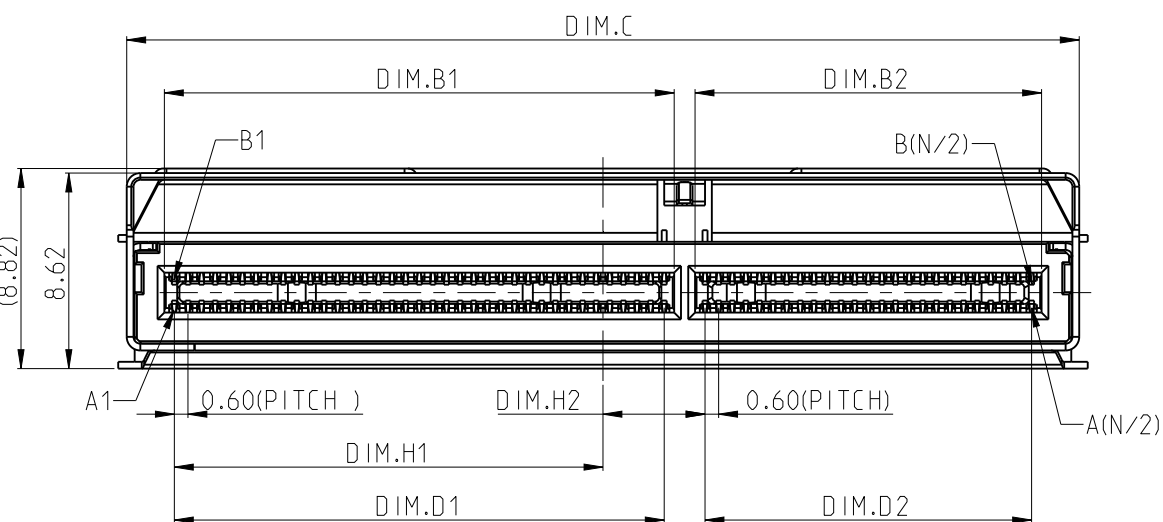

PART NUMBER	POS. (N)	DIM. B1	DIM. B2	DIM. C	DIM. D1	DIM. D2	DIM. E	DIM. F	DIM. G	DIM. H1	DIM. H2	DIM. J
G42VX4XXXHR	124	22.48	15.28	42.00	21.60	14.40	40.50	42.15	41.15	18.90	4.50	23.85
G42VX6XXXHR	148	22.48	22.48	49.20	21.60	21.60	47.70	49.35	48.35	22.50	0.90	23.85

TOLERANCE	DRAWN	APPROVALS	DATE	TITLE	Amphenol® Amphenol Corporation Amphenol Taiwan Corporation			
X. X.X ±0.30 X.XX ±0.20 X.XXX ±0.10	DESIGNED	JOAN LU	2021-07-20	MINI COOL EDGE IO INTEGRATED CONNECTOR 0.6 PITCH, VERTICAL STANDARD. SMT TYPE	UNIT mm	SIZE A3	PART No. G42V1XXXHR	REV. AX27
ANGULAR ±2°	CHECKED	Sondra Sang	2021-07-21					
UNLESS OTHERWISE SPECIFIED	APPROVED	Hank Hsu	2021-07-21					
	DWG TYPE	CUST DWG	PROJECT CODE TXXX		SCALE NA	SHEET 3 OF 8	DWG No. G42V1XXXHR	

This document is the property of Amphenol Corporation and is delivered on the express condition that is not to be disclosed, reproduced or used, in whole or in part, for manufacture or sale by anyone other than Amphenol Corporation without its prior consent, and that no right is granted to disclose or to use any information in this document.

The marking on this product doesn't contain environmental hazardous materials per directive 2011/65/EU & 2015/863/EU for RoHS compliant & per IEC 61249-2-21 for Halogen-Free compliant.



RECOMMENDED PCB LAYOUT
(GENERAL TOLERANCES :+/-0.05)

REVISIONS				
SYM	ECN No.	DESCRIPTION	DATE	BY
AX23	NA	UPDATED QTY OF PACKAGE	12/17/2019	JOAN LU
AX24	NA	1.CORRECT DIM J IN TABLE FOR G42VX6XXXXHR 2.REVISED LATCH HOLE DIMENSION FROM 1.10 TO 1.15MM	09/02/2020	JOAN LU
AX25	NA	RECOMMENDED AIC MATING CARD CHAMFER CHANGE FROM C0.75 TO C0.3	02/02/2021	JOAN LU
AX26	NA	ADDED NOTE ITEM 5	03/02/2021	JOAN LU
AX27	NA	CAP DESIGN CHANGE FOR BIGGER NOZZLE AREA	07/20/2021	JOAN LU

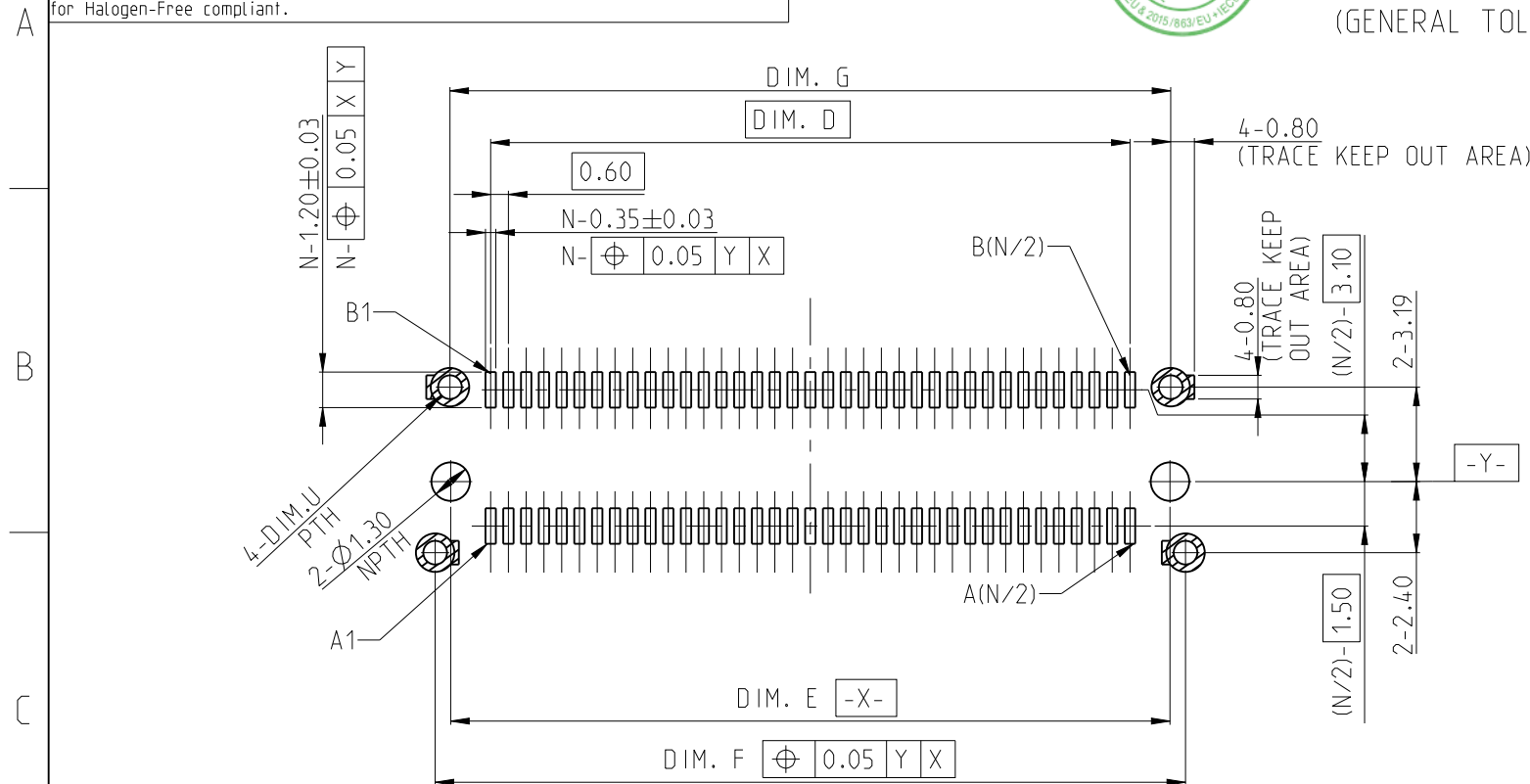

PART NUMBER	POS. (N)	DIM. D	DIM. E	DIM. F	DIM. G
G42VX1XXXXHR	38	10.80	13.50	14.55	13.55
G42VX5XXXXHR	50	14.40	17.10	18.15	17.15
G42VX2XXXXHR	74	21.60	24.30	25.35	24.35

PART NUMBER (APPLY TO 38P/74P/50P)	DIM. U
G42VXXXX1XHR	0.8
G42VXXXX2XHR	
G42VXXXX3XHR	
G42VXXXX4XHR	0.95

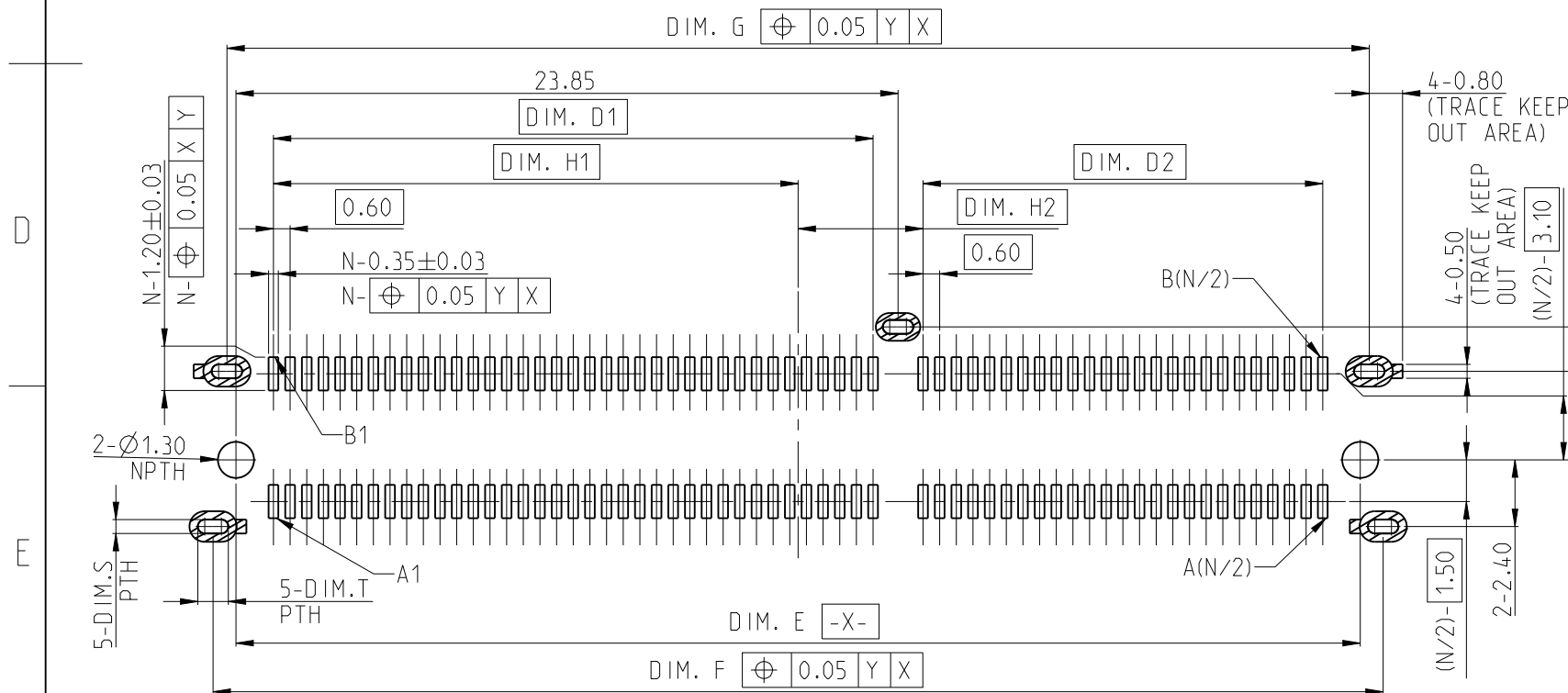

PART NUMBER	POS. (N)	DIM. D1	DIM. D2	DIM. E	DIM. F	DIM. G	DIM. H1	DIM. H2
G42VX4XXXXHR	124	21.60	14.40	40.50	42.15	41.15	18.90	4.50
G42VX6XXXXHR	148	21.60	21.60	47.70	49.35	48.35	22.50	0.90

PART NUMBER	POS. (N)	DIM. S	DIM. T
G42VX4XX1XHR	124	0.5	1.1
G42VX4XX2XHR			
G42VX4XX3XHR			
G42VX4XX4XHR	148	0.65	1.3
G42VX6XXXXHR			

TOLERANCE	DRAWN	APPROVALS	DATE	TITLE	Amphenol® Amphenol Corporation Amphenol Taiwan Corporation			
X. X.X ±0.30 X.XX ±0.20 X.XXX ±0.10	DESIGNED	JOAN LU	2021-07-20	MINI COOL EDGE IO INTEGRATED CONNECTOR 0.6 PITCH, VERTICAL STANDARD. SMT TYPE	UNIT mm	SIZE A3	PART No. G42V1XXXXHR	REV. AX27
ANGULAR ±2°	CHECKED	Sondra Sang	2021-07-21					
UNLESS OTHERWISE SPECIFIED	APPROVED	Hank Hsu	2021-07-21		SCALE NA	SHEET 4 OF 8	DWG No. G42V1XXXXHR	REV. AX27
	DWG TYPE	CUST DWG	PROJECT CODE TXXX					

This document is the property of Amphenol Corporation and is delivered on the express condition that is not to be disclosed, reproduced or used, in whole or in part, for manufacture or sale by anyone other than Amphenol Corporation without its prior consent, and that no right is granted to disclose or to use any information in this document.

The marking on this product doesn't contain environmental hazardous materials per directive 2011/65/EU & 2015/863/EU for RoHS compliant & per IEC 61249-2-21 for Halogen-Free compliant.



REVISIONS				
SYM	ECN No.	DESCRIPTION	DATE	BY
AX23	NA	UPDATED QTY OF PACKACAGE	12/17/2019	JOAN LU
AX24	NA	1.CORRECT DIM J IN TABLE FOR G42VX6XXXXHR 2.REVISED LATCH HOLE DIMENSION FROM 1.10 TO 1.15MM	09/02/2020	JOAN LU
AX25	NA	RECOMMENDED AIC MATING CARD CHAMFER CHANGE FROM C0.75 TO C0.3	02/02/2021	JOAN LU
AX26	NA	ADDED NOTE ITEM 5	03/02/2021	JOAN LU
AX27	NA	CAP DESIGN CHANGE FOR BIGGER NOZZLE AREA	07/20/2021	JOAN LU

RECOMMENDED AIC MATING CARD DIMENSIONS

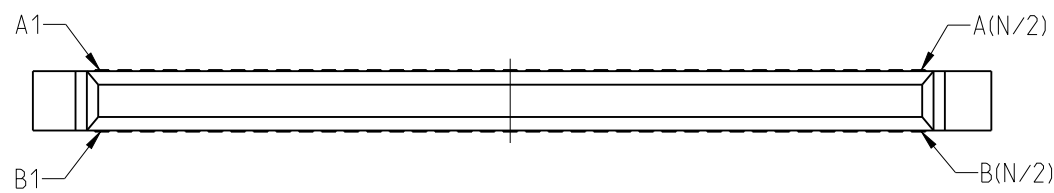
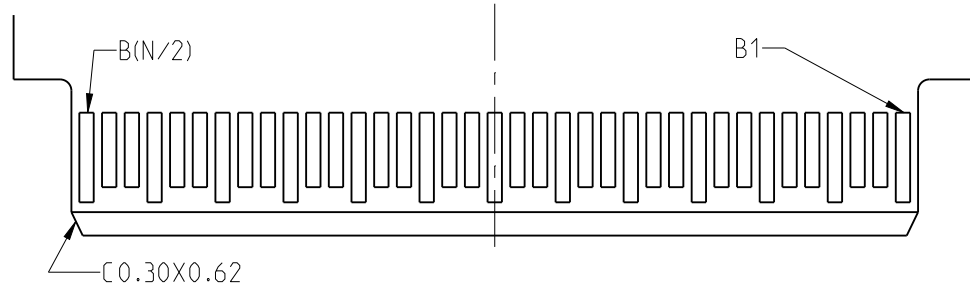
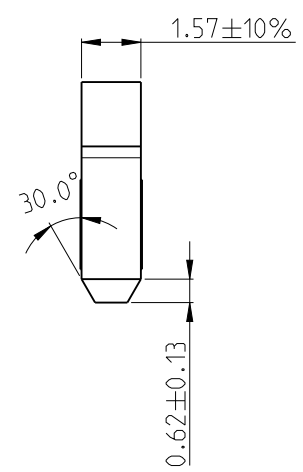
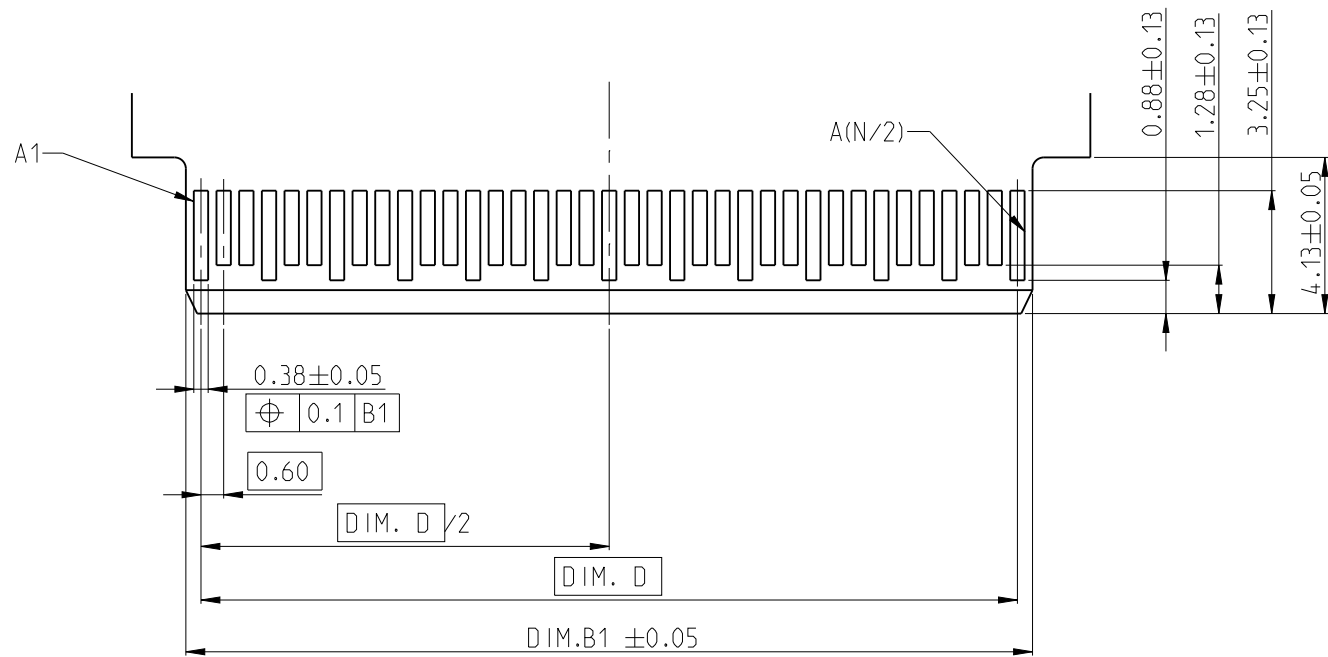

PART NUMBER	POS. (N)	DIM. B1	DIM. D
G42VX1XXXXHR	38	11.6	10.80
G42VX5XXXXHR	50	15.2	14.40
G42VX2XXXXHR	74	22.4	21.6

TOLERANCE	DRAWN	APPROVALS	DATE	TITLE	Amphenol® Amphenol Corporation Amphenol Taiwan Corporation			
X. X ±0.30	DESIGNED	JOAN LU	2021-07-20	MINI COOL EDGE IO INTEGRATED CONNECTOR 0.6 PITCH, VERTICAL STANDARD. SMT TYPE		UNIT	SIZE	PART No.
X.XX ±0.20	CHECKED	Sondra Sang	2021-07-21			mm	A3	G42V1XXXXHR
X.XXX ±0.10	APPROVED	Hank Hsu	2021-07-21			SCALE	SHEET	DWG No.
ANGULAR ±2°	DWG TYPE	CUST DWG	PROJECT CODE			NA	6 OF 8	G42V1XXXXHR
UNLESS OTHERWISE SPECIFIED			TXXX					REV. AX27

This document is the property of Amphenol Corporation and is delivered on the express condition that is not to be disclosed, reproduced or used, in whole or in part, for manufacture or sale by anyone other than Amphenol Corporation without its prior consent, and that no right is granted to disclose or to use any information in this document.

The marking on this product doesn't contain environmental hazardous materials per directive 2011/65/EU & 2015/863/EU for RoHS compliant & per IEC 61249-2-21 for Halogen-Free compliant.



REVISIONS				
SYM	ECN No.	DESCRIPTION	DATE	BY
AX23	NA	UPDATED QTY OF PACKACAGE	12/17/2019	JOAN LU
AX24	NA	1.CORRECT DIM J IN TABLE FOR G42VX6XXXXHR 2.REVISED LATCH HOLE DIMENSION FROM 1.10 TO 1.15MM	09/02/2020	JOAN LU
AX25	NA	RECOMMENDED AIC MATING CARD CHAMFER CHANGE FROM C0.75 TO C0.3	02/02/2021	JOAN LU
AX26	NA	ADDED NOTE ITEM 5	03/02/2021	JOAN LU
AX27	NA	CAP DESIGN CHANGE FOR BIGGER NOZZLE AREA	07/20/2021	JOAN LU

RECOMMENDED AIC MATING CARD DIMENSIONS

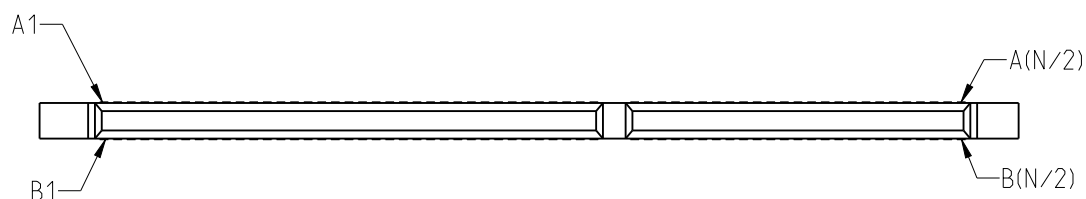
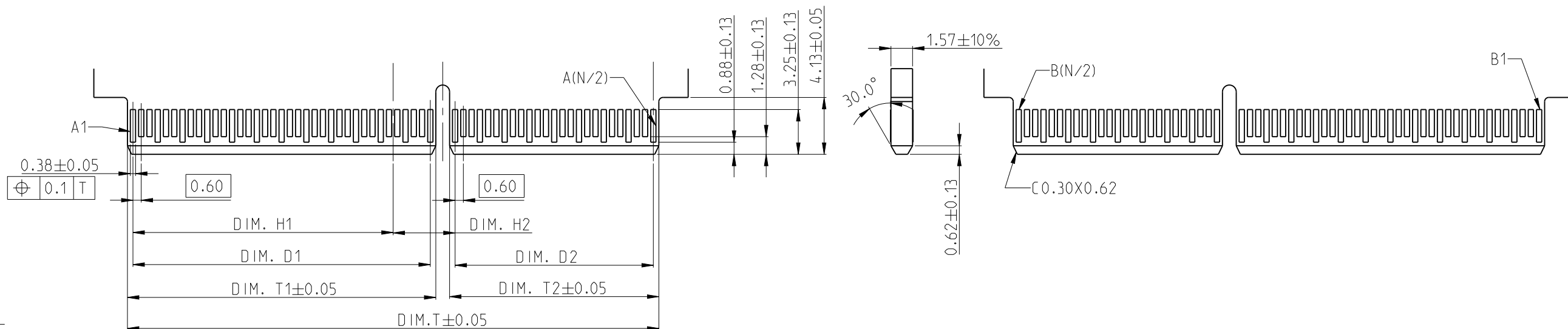

PART NUMBER	POS. (N)	DIM. D1	DIM. D2	DIM. H1	DIM. H2	DIM. T	DIM. T1	DIM. T2
G42VX4XXXXHR	124	21.60	14.40	18.90	4.50	38.6	22.4	15.2
G42VX6XXXXHR	148	21.60	21.60	22.50	0.90	45.8	22.4	22.4

TOLERANCE	DRAWN	APPROVALS	DATE	TITLE	Amphenol® Amphenol Corporation Amphenol Taiwan Corporation					
X. X.X ±0.30 X.XX ±0.20 X.XXX ±0.10	DESIGNED	JOAN LU	2021-07-20	MINI COOL EDGE IO INTEGRATED CONNECTOR 0.6 PITCH, VERTICAL STANDARD. SMT TYPE	UNIT mm	SIZE A3	PART No. G42V1XXXXHR			
ANGULAR ±2°	CHECKED	Sondra Sang	2021-07-21				SCALE NA	SHEET 7 OF 8	DWG No. G42V1XXXXHR	
UNLESS OTHERWISE SPECIFIED	APPROVED	Hank Hsu	2021-07-21						REV. AX27	
	DWG TYPE	CUST DWG	PROJECT CODE TXXX							

This document is the property of Amphenol Corporation and is delivered on the express condition that is not to be disclosed, reproduced or used, in whole or in part, for manufacture or sale by anyone other than Amphenol Corporation without its prior consent, and that no right is granted to disclose or to use any information in this document.

The marking on this product doesn't contain environmental hazardous materials per directive 2011/65/EU & 2015/863/EU for RoHS compliant & per IEC 61249-2-21 for Halogen-Free compliant.



REVISIONS				
SYM	ECN No.	DESCRIPTION	DATE	BY
AX23	NA	UPDATED QTY OF PACKAGE	12/17/2019	JOAN LU
AX24	NA	1.CORRECT DIM J IN TABLE FOR G42VX6XXXXHR 2.REVISED LATCH HOLE DIMENSION FROM 1.10 TO 1.15MM	09/02/2020	JOAN LU
AX25	NA	RECOMMENDED AIC MATING CARD CHAMFER CHANGE FROM C0.75 TO C0.3	02/02/2021	JOAN LU
AX26	NA	ADDED NOTE ITEM 5	03/02/2021	JOAN LU
AX27	NA	CAP DESIGN CHANGE FOR BIGGER NOZZLE AREA	07/20/2021	JOAN LU

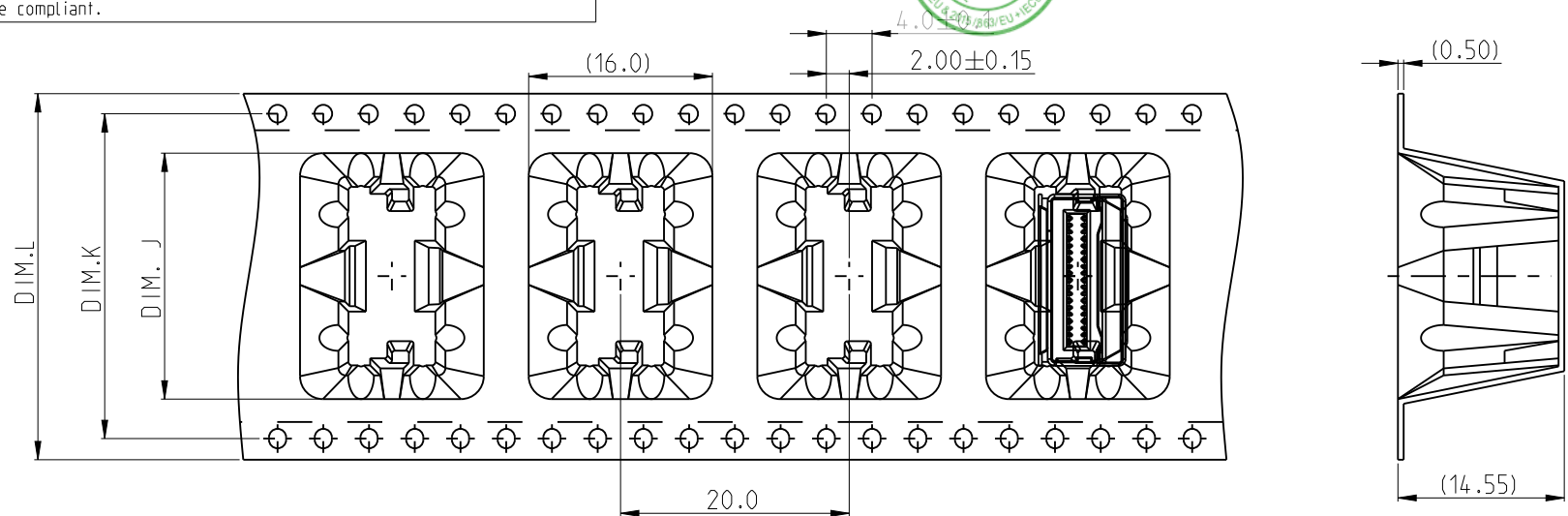

PART NUMBER	POS. (N)	DIM. J	DIM. K	DIM. L	REEL (Q'TY)	CARTON (PCS)
G42VX1XXXXHR	38	(21.5)	28.4±0.1	32.0±0.3	7	1400
G42VX5XXXXHR	50	(27.7)	40.4±0.1	44.0±0.3	5	1000
G42VX2XXXXHR	74	(34.0)	52.4±0.1	56.0±0.3	4	800
G42VX4XXXXHR	124	(39.5)	68.40±0.1	72.0±0.3	3	600
G42VX6XXXXHR	148	(57.9)	68.40±0.1	72.0±0.3	3	600

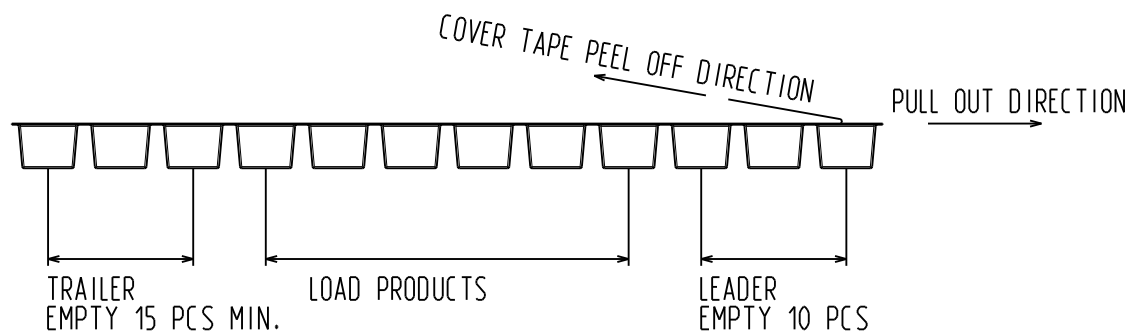
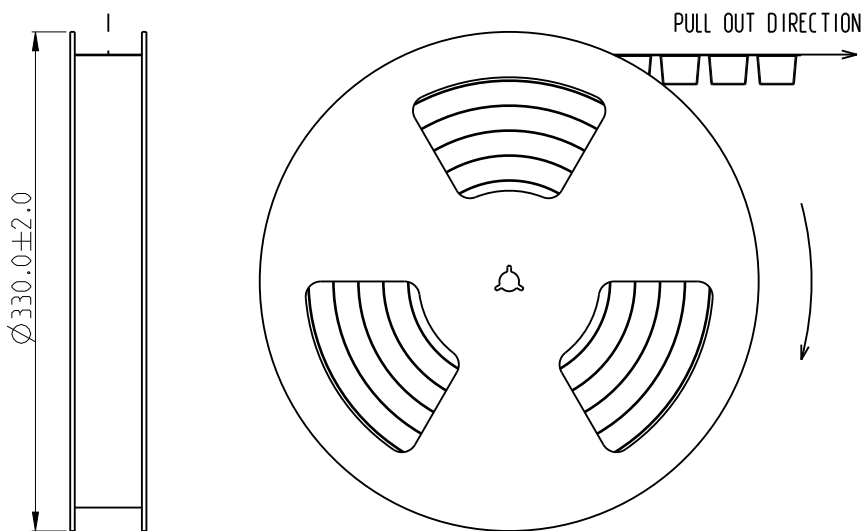
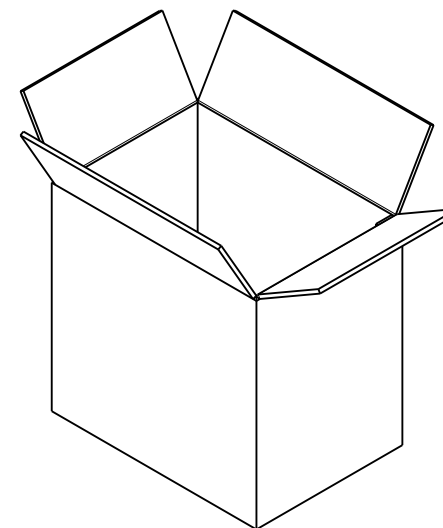
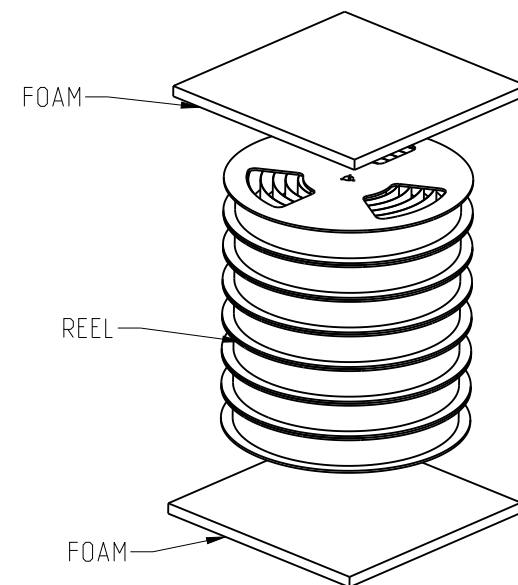

- NOTE 2:
- CARTON SIZE 340L X 340W X265H
 - PREFER TO AMTA LABELING STANDARD.
 - CARTON CLOSURES MUST BE SEALED WITH TAPE.

- NOTE 1:
- MATERIAL:
CARRIER TAPE: POLYSTYRENE, BLACK
COVER TAPE: TRANSPARENT POLYSTYRENE
REEL: POLYSTYRENE, BLACK
 - ALL TAPE AND REEL SPECIFICATION FOLLOW EIA-481 STANDARD.
 - THIS PRODUCT DOESN'T CONTAIN ENVIRONMENTAL HAZARDOUS MATERIALS PER DIRECTIVE 2011/65/EU & 2015/863/EU FOR RoHS AND PER IEC 61249-2-21 FOR HALOGEN FREE.

TOLERANCE	DRAWN	APPROVALS	DATE	TITLE						
X. ±0.30	DESIGNED	JOAN LU	2021-07-20	MINI COOL EDGE 10 INTEGRATED CONNECTOR 0.6 PITCH, VERTICAL STANDARD. SMT TYPE	 Amphenol Corporation Amphenol Taiwan Corporation					
X.XX ±0.20	CHECKED	Sondra Sang	2021-07-21							
X.XXX ±0.10	APPROVED	Hank Hsu	2021-07-21							
ANGULAR ±2°	DWG TYPE	CUST DWG	PROJECT CODE	TXXX	UNIT	mm	SIZE	A3	PART No.	G42V1XXXXHR
UNLESS OTHERWISE SPECIFIED					SCALE	NA	SHEET	8 OF 8	DWG No.	G42V1XXXXHR
									REV.	AX27