

PART NUMBER	REV	FIRST USED	TERMINATOR	FEED TYPE	DESCRIPTION
1426554-1	B		LEADMAKER	MECH POST FEED	CUTS CARRIER
1426554-2	B		BENCH	MECH PRE FEED	CUTS CARRIER
1426554-6	B		LEADMAKER	MECH POST FEED	CONTINUOUS CARRIER
7-1426554-1	B		LEADMAKER	MECH POST FEED	-1 AND SPARE PARTS
7-1426554-2	B		BENCH	MECH PRE FEED	-2 AND SPARE PARTS
7-1426554-6	B		LEADMAKER	MECH POST FEED	-6 AND SPARE PARTS
7-1426554-7	A		-	-	SPARE PARTS KIT

CRIMP DATA CY CO.LTD. TERMINAL AMP CRIMP SPECS

CRIMP	SIZE	TYPE	RANGE
WIRE	4.83 [1.190 IN]	F	3.75mm <sup>2</sup>
INSUL	7.11 [1.280 IN]	F	3.50-5.00 [1.138-.197 IN]
WIRE STRIP LENGTH		APPL INSTRUCTION	
4.37-5.13 [1.172-.202 IN]		408-8322	

TERMINAL APPL SPEC	FEED
NONE	19.00 [1.748 IN]

TERMINALS APPLIED	
AMP TERM PN	MFR TERM PN
1572707-1	805401-81
-	-
-	-
-	-
-	-
-	-
-	-
-	-

WIRE SIZE	CRIMP HEIGHT	PIN PN AND LENGTH [IN]
3.75mm <sup>2</sup>	2.97 ±0.05 [1.117 ±0.002 IN]	5-354778-3 [1.2760]
-	-	-
-	-	-
-	-	-
-	-	-
-	-	-
-	-	-
-	-	-
-	-	-
-	-	-

- 1. RECOMMENDED SPARE PARTS.
- 2. GREASE RAM, CAM, CAM FOLLOWER AND FEED ROD LIGHTLY.
- 3. LUBRICATE DAILY PER THE APPLICATOR INSTRUCTION SHEET SUPPLIED WITH THE APPLICATOR.
- 4. CUT TO LENGTH AT ASSY.
- 5. ALL CRIMP DATA CALCULATED BY TYCO ELECTRONICS UK LTD.

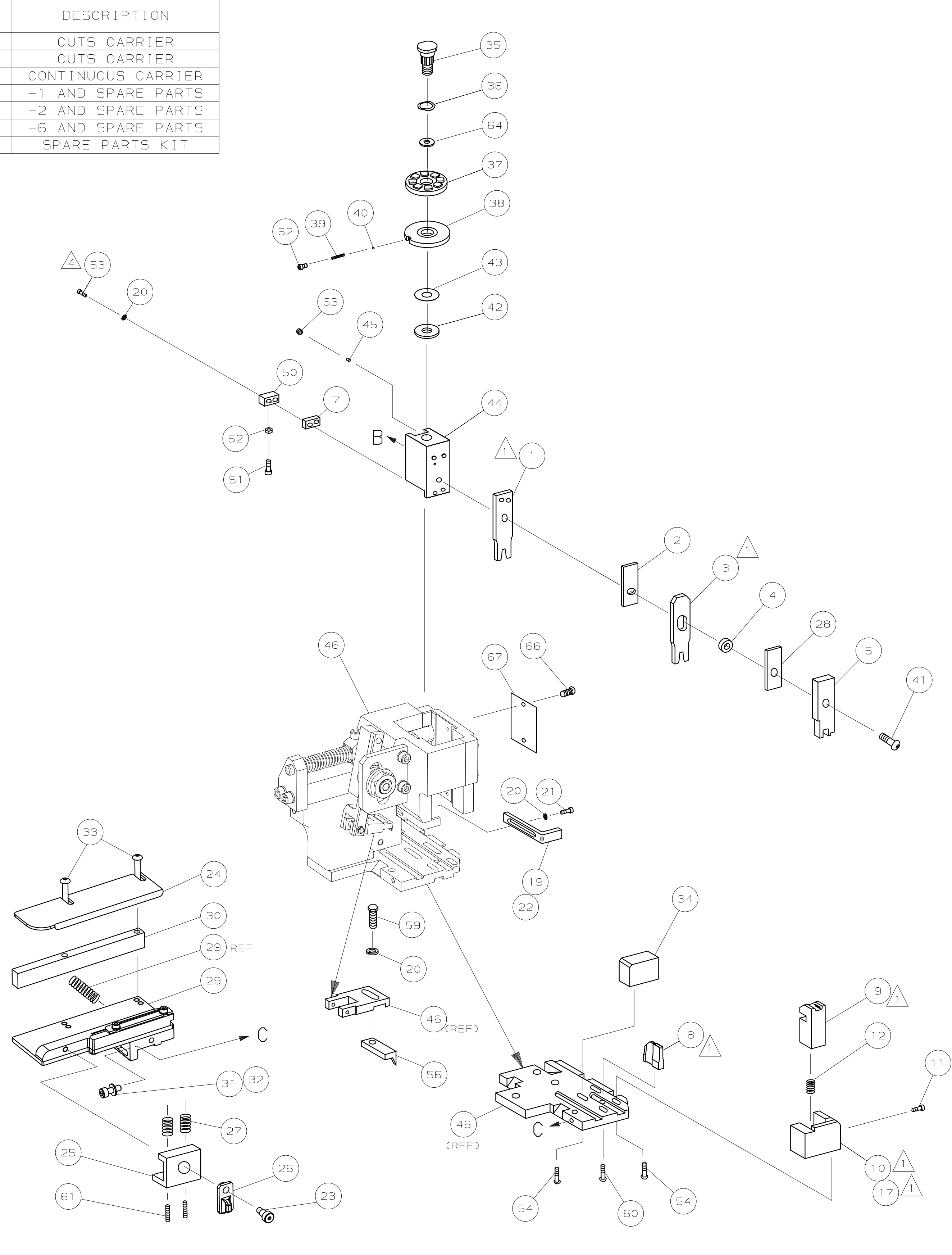

VIEW B ROTATED 180°

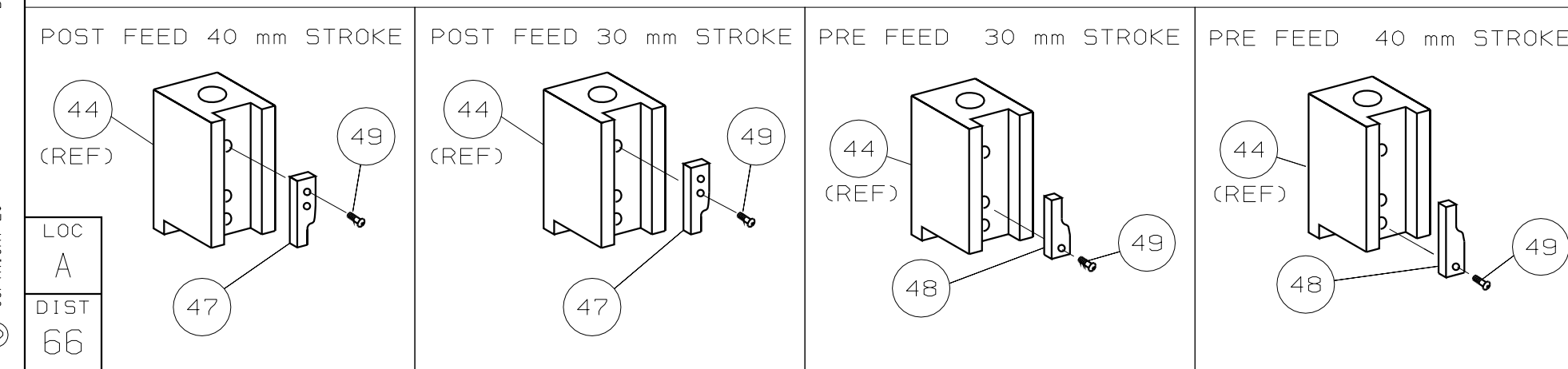

ITEM 34 LOCATION  
0.145 ± .020

QTY REQD PER ASSY							PARTS LIST		
-	1	1	1	1	1	1	1426554	PRINT, APPLICATOR LOG SHEET	73
-	1	1	1	1	1	1	1338705-1	DOCUMENTATION PACKAGE	71
									70
									69
									68
-	1	1	1	1	1	1	461264-1	PLATE, IDENTIFICATION	67
-	2	2	2	2	2	2	21017-2	SCR,DRIVE (#2x.19) ID PLATE	66
									65
-	1	1	1	1	1	1	986950-1	WASHER, FLAT PRECISION	64
-	1	1	1	1	1	1	3-18031-0	SCR,SKT SET (M6X6) RAM	63
-	1	1	1	1	1	1	18023-9	SCR,SHC (M4X6) INS DISC	62
-	2	2	2	2	2	2	2-18032-5	SCR,SKT SET (M5X20) DRAG	61
-	1	1	1	1	1	1	18024-7	SCR,BHC (M4X10) ANVIL	60
-	1	1	1	1	1	1	5-18022-2	SCR,HEX (M4X8) FEED FINGER	59
									58
									57
-	1	1	1	1	1	1	1338685-1	PAWL, FEED	56
									55
-	4	4	4	4	4	4	18024-8	SCR,BHC (M4X12) SHEAR HOLDER	54
-	2	2	2	2	2	2	1-18023-3	SCR,SHC (M4X16) TERM HLD DWN	53
-	1	1	1	1	1	1	18030-1	NUT, HEX (M3) HOLD DOWN	52
-	1	1	1	1	1	1	811242-5	BUMPER, HOLDDOWN	51
-	1	1	1	1	1	1	690753-2	SPACER, TONKER	50
-	1	1	1	1	1	1	18024-3	SCR,BHC (M3X10) CAM	49
-	-	1	-	-	-	-	1338675-1	CAM, PRE FEED 30 & 40 mm ST	48
-	1	-	1	-	1	-	1338676-1	CAM, POST FEED 30 & 40 mm ST	47
-	1	1	1	1	1	1	1320999-3	APPLICATOR BASIC SUBASSY	46
-	1	1	1	1	1	1	690191-1	PLUG, NYLON	45
-	1	1	1	1	1	1	1338660-1	RAM	44
-	1	1	1	1	1	1	690125-1	WASHER, LAMINATED	43
-	1	1	1	1	1	1	690124-7	WASHER, RAM	42
-	1	1	1	1	1	1	2-18024-6	SCR,BHC (M8X25) RAM	41
-	1	1	1	1	1	1	23241-1	BALL, STEEL	40
-	1	1	1	1	1	1	2-22278-7	SPRING, COMPRESSION	39
-	1	1	1	1	1	1	1320922-1	DISC, INSULATION	38
-	1	1	1	1	1	1	354777-1	WIRE DISC, PLASTIC	37
-	1	1	1	1	1	1	22480-5	WASHER, SPRING	36
-	1	1	1	1	1	1	690212-1	POST, RAM	35
-	1	1	1	1	1	1	1320934-1	SUPPORT, TERMINAL	34
-	2	2	2	2	2	2	1-18024-0	SCR,BHC (M4X20) STRIP GUIDE	33
-	1	1	1	1	1	1	18027-2	WASHER, FLAT (M4)	32
-	1	1	1	1	1	1	1-18023-2	SCR,SKT CAP (M4X12) MOUNT BLOCK	31
-	1	1	1	1	1	1	1320908-8	SPACER, STRIP GUIDE	30
-	1	1	1	1	1	1	1633073-1	STRIP GUIDE PLATE ASSY	29
-	1	1	1	1	1	1	1-455888-6	SPACER, FRONT SHEAR DEP	28
-	2	2	2	2	2	2	1-22284-0	SPRING, DRAG	27
-	1	1	1	1	1	1	356835-1	LEVER, DRAG RELEASE	26
-	1	1	1	1	1	1	240792-1	DRAG, TERMINAL	25
-	1	1	1	1	1	1	1320928-1	PLATE, STRIP GUIDE	24
-	1	1	1	1	1	1	980371-4	SCR,SHC SHLD	23
-	1	-	1	-	1	-	690472-2	STRIPPER	22
-	1	1	1	1	1	1	1-18023-1	SCR,SHC (M4X10) STRIPPER	21
-	4	4	4	4	4	4	18025-2	WASHER, LOCK (M4) STRIPPER	20
-	-	1	-	-	1	-	690472-1	STRIPPER	19
									18
-	1	-	-	1	-	-	1338684-2	HOLDER, SHEAR, FRONT (NO-CUT)	17
									16
									15
									14
									13
-	1	1	1	1	1	1	5-22280-0	SPRING, SHEAR	12
-	1	1	1	1	1	1	356885-5	STOP, SHEAR	11
-	-	1	1	-	1	1	1-1320921-0	HOLDER, SHEAR, FRONT (CUT)	10
-	1	1	1	1	1	1	454276-5	SHEAR, FLOAT (FRONT)	9
1	2	2	2	2	1	1	1-1333229-0	ANVIL	8
-	1	1	1	1	1	1	2-240641-4	SPACER, DEPRESSOR (REAR)	7
									6
-	1	1	1	1	1	1	4-455889-6	DEPRESSOR, SHEAR (FRONT)	5
-	1	1	1	1	1	1	238011-4	SPACER, BLOCK CRIMPER	4
1	2	2	2	1	1	1	5-1424909-7	CRIMPER, INSULATION	3
-	1	1	1	1	1	1	455888-7	SPACER, CRIMPER	2
1	2	2	2	1	1	1	8-568176-3	CRIMPER, WIRE	1

DIMENSIONS: mm [INCHES]				MATL	-	HT TR	-	FIN	-
DO NOT SCALE PRINT.									
TOLERANCES UNLESS OTHERWISE SPECIFIED:									
1 PLC DEC ±									
2 PLC DEC ±									
3 PLC DEC ±									
ANGLES ±									
SURF TEXTURE: ✓									
REMOVE BURRS, BREAK SHARP EDGES RO.38 MAX									
CAGE CODE 00779									
CUSTOMER AND ASSEMBLY DRAWING									

THIS DRAWING IS A CONTROLLED DOCUMENT.

LAYOUT L1426554  
SET UP GAGE 458637-3

THIS DRAWING IS UNRELEASED. RELEASE FOR PUBLICATION BY AMP INCORPORATED. ALL RIGHTS RESERVED.  
AMP 1756 REV 3-92  
105-OCT-05 10:54:03 us016926

1426554

D

C

B

A